

4840, solder terminal, Plug, 5.5 mm, 2-pole, DC Plug/Socket



Approvals and Compliances

Description

- Solder terminal :
for cable mounting
- Low Voltage DC Plug and Socket
- DC Plug: 2-pole , straight

Technical Data



Diameter	5.5 mm / 2.1 mm	Allowable Operation Temperature	-20 °C to 70 °C
Number of Poles	2-pole	Terminal	solder terminal nickel-plated
Ratings DC	0.5 A / 12 VDC	Style	straight
Dielectric Strength	500 VDC	Lifetime	5000 Insertions
Insulation Resistance	> 100 MΩ @ 500 VDC		

Approvals and Compliances

Detailed information on product approvals, code requirements, usage instructions and detailed test conditions can be looked up in [Details about Approvals](#)

Compliances

The product complies with following Guide Lines

Identification	Details	Initiator	Description
	RoHS	SCHURTER AG	EU Directive RoHS 2011/65/EU
	China RoHS	SCHURTER AG	The law SJ / T 11363-2006 (China RoHS) has been in force since 1 March 2007. It is similar to the EU directive RoHS.
	REACH	SCHURTER AG	On 1 June 2007, Regulation (EC) No 1907/2006 on the Registration, Evaluation, Authorization and Restriction of Chemicals 1 (abbreviated as "REACH") entered into force.

Dimensions [mm]

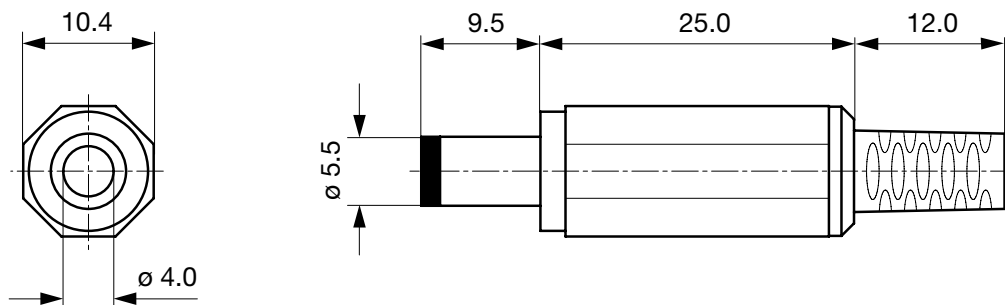

Cable diameter max. 4.0 mm

All Variants

Product group	Diameter [mm]	Number of Poles	Terminal	Order Number
DC Plug/Socket	5.5	2-pole	solder terminal	4840.1200

Most Popular.

Availability for all products can be searched real-time: <https://www.schurter.com/en/Stock-Check/Stock-Check-SCHURTER>

Packaging unit 100 Pcs

Mating Outlets/Connectors

Category / Description



[DC Plug/Socket Overview complete](#)

4840, solder terminal, Socket, 6.3 mm, 2-pole, DC Plug/Socket	4840.2200
4840, PCB terminals, Socket, 6.0 mm, 2-pole, DC Plug/Socket	4840.2201
4840, Cable, Plug, 5.5 mm, 2-pole, DC Plug/Socket	4840.5202

[DC Plug/Socket further types to 4840.1200](#)

Mouser Electronics

Authorized Distributor

Click to View Pricing, Inventory, Delivery & Lifecycle Information:

Schurter:

[4840.1201](#) [4840.5211](#) [4840.5201](#) [4840.1211](#) [4840.2211](#) [4840.2221](#) [4840.5202](#) [4840.5212](#) [4840.5221](#) [4840.5231](#)
[4840.12](#) [4840.121](#) [4840.123](#) [4840.22](#) [4840.221](#) [4840.222](#) [4840.52](#) [4840.521](#) [4840.522](#) [4840.523](#) [4840.2200](#)
[4840.1200](#) [4840.5220](#) [4840.1230](#) [4840.5210](#) [4840.5200](#) [4840.2220](#) [4840.5230](#) [4840.1210](#)