

THIS DRAWING IS UNPUBLISHED. RELEASED FOR PUBLICATION
 © COPYRIGHT - By - TE CONNECTIVITY ALL RIGHTS RESERVED.

| LOC | DIST | REVISIONS | | | |
|-----|------|-------------|---------------------------|-----------|--------|
| P | LTR | DESCRIPTION | DATE | DWN | APVD |
| CM | 54 | U2 | REVISED PER ECR-17-018200 | 09JAN2018 | BDA SG |

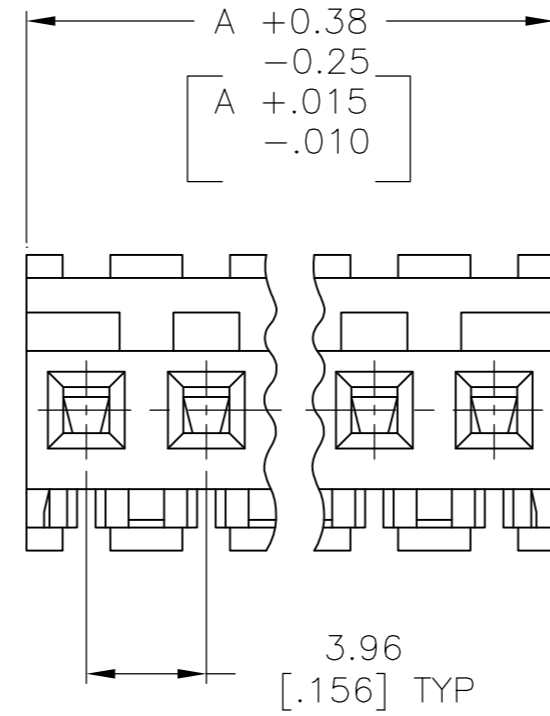
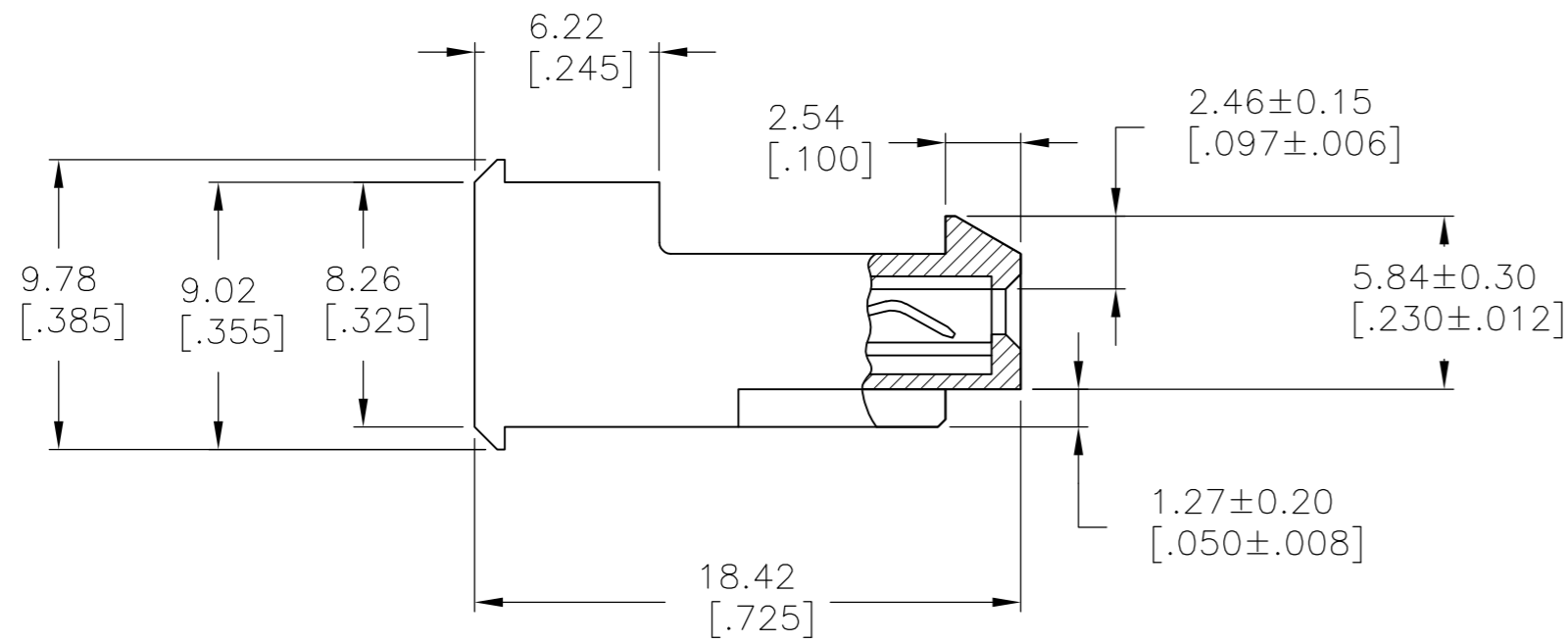
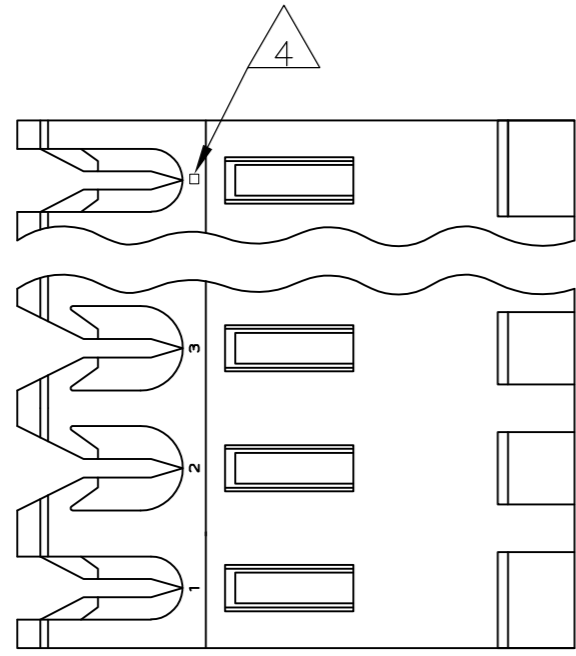

| | | | |
|-------|---------|----|-----------------------|
| 95.10 | [3.744] | 24 | 5-640600-4 |
| 91.14 | [3.588] | 23 | 5-640600-3 |
| 87.17 | [3.432] | 22 | 5-640600-2 |
| 83.21 | [3.276] | 21 | 5-640600-1 |
| 79.25 | [3.120] | 20 | 5-640600-0 |
| 75.29 | [2.964] | 19 | 4-640600-9 |
| 71.32 | [2.808] | 18 | 4-640600-8 |
| 67.36 | [2.652] | 17 | 4-640600-7 |
| 63.40 | [2.496] | 16 | 4-640600-6 |
| 59.44 | [2.340] | 15 | 4-640600-5 |
| 55.47 | [2.184] | 14 | 4-640600-4 |
| 51.51 | [2.028] | 13 | 4-640600-3 |
| 47.55 | [1.872] | 12 | 4-640600-2 |
| 43.59 | [1.716] | 11 | 4-640600-1 |
| 39.62 | [1.560] | 10 | 4-640600-0 |
| 35.66 | [1.404] | 9 | 3-640600-9 |
| 31.70 | [1.248] | 8 | 3-640600-8 |
| 27.74 | [1.092] | 7 | 3-640600-7 |
| 23.77 | [.936] | 6 | 3-640600-6 |
| 19.81 | [.780] | 5 | 3-640600-5 |
| 15.85 | [.624] | 4 | 3-640600-4 |
| 11.89 | [.468] | 3 | 3-640600-3 |
| 7.92 | [.312] | 2 | 3-640600-2 |
| 95.10 | [3.744] | 24 | 2-640600-4 |
| 91.14 | [3.588] | 23 | 2-640600-3 |
| 87.17 | [3.432] | 22 | 2-640600-2 |
| 83.21 | [3.276] | 21 | 2-640600-1 |
| 79.25 | [3.120] | 20 | 2-640600-0 |
| 75.29 | [2.964] | 19 | 1-640600-9 |
| 71.32 | [2.808] | 18 | 1-640600-8 |
| 67.36 | [2.652] | 17 | 1-640600-7 |
| 63.40 | [2.496] | 16 | 1-640600-6 |
| 59.44 | [2.340] | 15 | 1-640600-5 |
| 55.47 | [2.184] | 14 | 1-640600-4 |
| 51.51 | [2.028] | 13 | 1-640600-3 |
| 47.55 | [1.872] | 12 | 1-640600-2 |
| 43.59 | [1.716] | 11 | 1-640600-1 |
| 39.62 | [1.560] | 10 | 1-640600-0 |
| 35.66 | [1.404] | 9 | 640600-9 |
| 31.70 | [1.248] | 8 | 640600-8 |
| 27.74 | [1.092] | 7 | 640600-7 |
| 23.77 | [.936] | 6 | 640600-6 |
| 19.81 | [.780] | 5 | 640600-5 |
| 15.85 | [.624] | 4 | 640600-4 |
| 11.89 | [.468] | 3 | 640600-3 |
| 7.92 | [.312] | 2 | 640600-2 |

SUPERSEDED $\triangle 7$
 SUPERSEDED $\triangle 7$
 SUPERSEDED $\triangle 8$
 SUPERSEDED $\triangle 7$
 SUPERSEDED $\triangle 8$

- $\triangle 1$ MATERIAL: CONNECTOR - NYLON UL94V-2 (YELLOW).
 CONTACTS - 0.30[.012] THICK COPPER ALLOY (BRIGHT TIN-LEAD 0.00203[.000080] MIN. THICK FOR CONTACTS 640600-2 THRU 2-640600-4) (MATTE WHISKER MITIGATED TIN 0.00203[.000080] MIN THICKNESS OVER NICKEL UNDERPLATE FOR 3-640600-2 THRU 5-640600-4).
- 2 CONTACTS ACCEPT 20 AWG WIRE WITH 2.41[.095] MAX INSULATION DIAMETER.
- 3 CONTACTS MUST ACCEPT 1.14±0.03[.045±.001] SQUARE POST AND REMAIN LOCKED IN POSITION.
- $\triangle 4$ IDENTIFICATION NUMBER FOR LAST CIRCUIT MAY NOT APPEAR ON ALL ASSEMBLIES.
- 5 DIMENSIONS IN BRACKETS ARE IN INCHES.
- 6 HOUSING FEATURES ARE: FEED-THRU WITH LOCKING RAMP.
- $\triangle 7$ OBSOLETE PARTS: OBSOLETE CIS STREAMLINING PER D.RENAUD/D.SINISI
- $\triangle 8$ OBSOLETE PARTS

| | | | | |
|---|--|-----------------------------|---|--------------------|
| THIS DRAWING IS A CONTROLLED DOCUMENT. | | DWN B. LEWIS 12FEB91 | | |
| DIMENSIONS: mm [INCHES] | | CHK R. SWING 12FEB91 | | |
| TOLERANCES UNLESS OTHERWISE SPECIFIED: | | APVD D. CLARK 19FEB91 | NAME | |
| 0 PLC ± - 1 PLC ± - 2 PLC ± - 3 PLC ± 0.13 [.005] 4 PLC ± - ANGLES ± - | | PRODUCT SPEC 108-1051 | MTA-156 CONNECTOR ASSEMBLY, 20 AWG, STANDARD | |
| MATERIAL $\triangle 1$ | | FINISH $\triangle 1$ | SIZE A2 | CAGE CODE 00779 |
| | | WEIGHT | DRAWING NO C=640600 | RESTRICTED TO - |
| | | CUSTOMER DRAWING | SCALE 4:1 | SHEET 1 OF 1 |
| | | | REV U2 | |

Mouser Electronics

Authorized Distributor

Click to View Pricing, Inventory, Delivery & Lifecycle Information:

[TE Connectivity:](#)

[4-640600-0](#)