

LOC		DIST		REVISIONS			
P	LTR	DESCRIPTION	DATE	DMN	APVD		
B1		REVISED PER ECO-11-004835	11MAR11	RK	HMR		

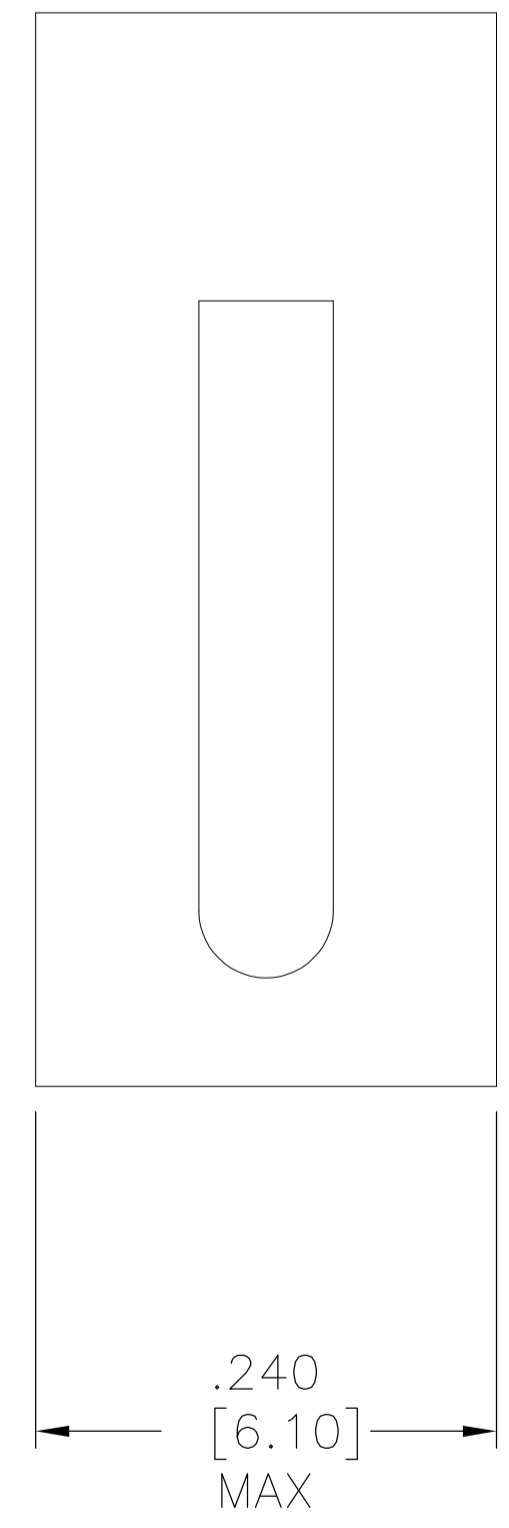
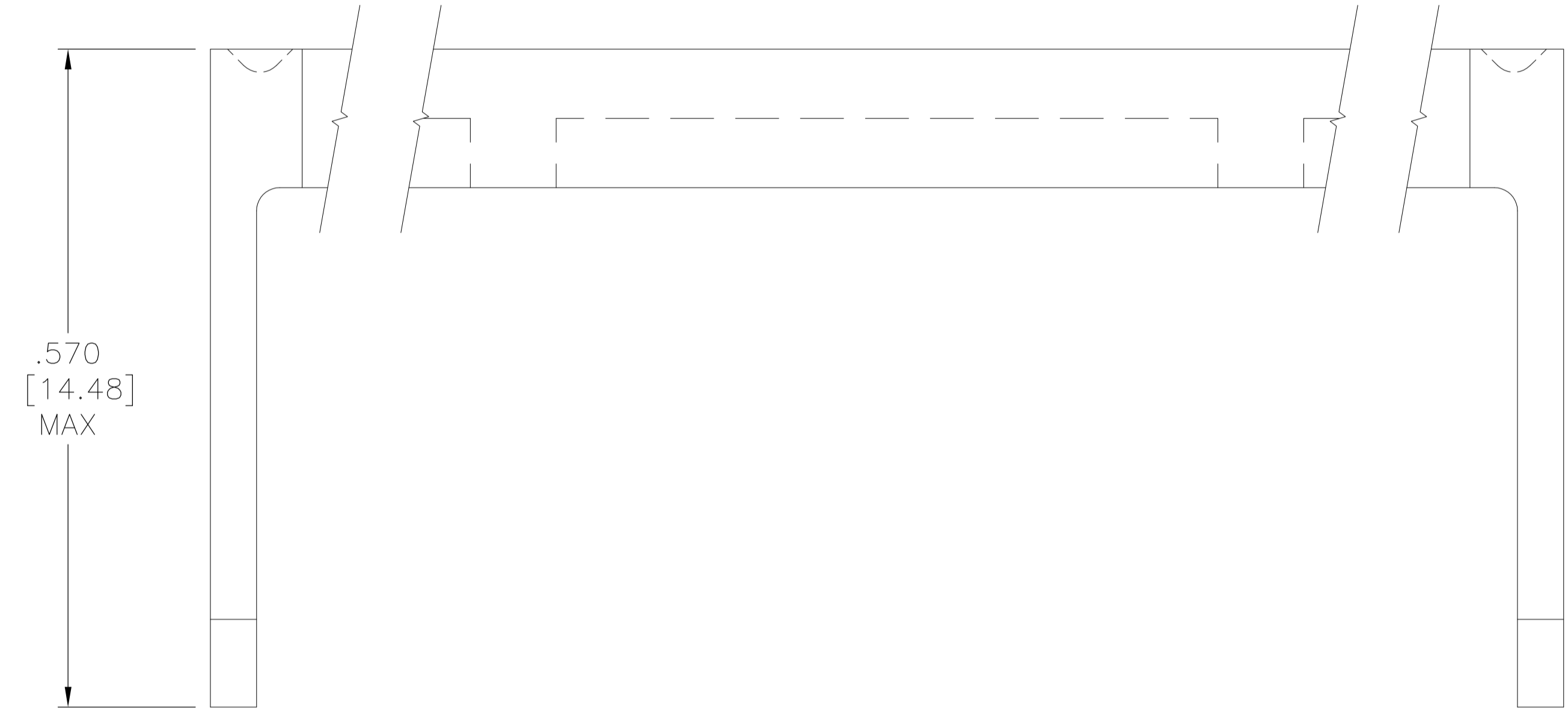
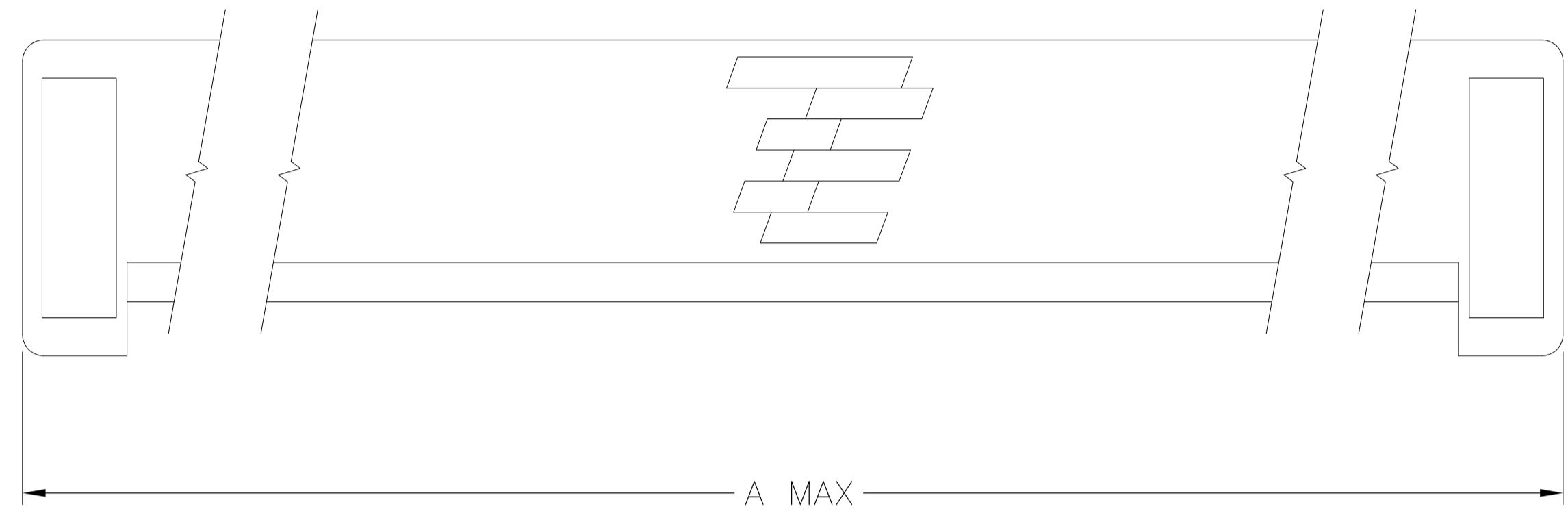

MATERIAL: GLASS REINFORCED THERMOPLASTIC RATED 94V-0.

2. COLOR: BLUE

609-6431HD	85.95	(3.384)	64	1-1437022-3
609-5031HD	68.17	(2.684)	50	8-1437021-1
609-4031HD	55.47	(2.184)	40	5-1437021-5
609-3431HD	47.85	(1.884)	34	3-1437021-2
609-2631HD	37.69	(1.484)	26	1-1437021-2
609-2031HD	30.07	(1.184)	20	8-1437020-6
609-1631HD	24.99	(0.984)	16	6-1437020-6
609-1431HD	22.45	(0.884)	14	5-1437020-1
609-1031HD	17.37	(0.684)	10	3-1437020-7
<b>T&amp;B PART NO (REF)</b>	<b>A</b>	<b>NO OF POSN</b>	<b>PART NO</b>	

THIS DRAWING IS A CONTROLLED DOCUMENT.

DIMENSIONS: mm [INCHES]	TOLERANCES UNLESS OTHERWISE SPECIFIED:	DIN W. DABULAS 3/25/83	CHK: G. KLEMM 3/25/83	APVD: R.R. 3/31/83	NAME: HEAVY DUTY STRAIN RELIEF FEMALE SOCKET CONNECTOR
0. PLC ± .01	1. PLC ± .01	APPLIC. SPEC: -		SIZE: A1	CAGE CODE: 3-1437020-7
2. PLC ± .01	3. PLC ± .01	APPLIC. SPEC: -		WEIGHT: -	RESTRICTED TO: -
4. PLC ± .01	ANGLES ± .5	APPLIC. SPEC: -		CUSTOMER DRAWING	SCALE: 10:1 SHEET: 1 OF 1 REV: B1

STE TE Connectivity

# Mouser Electronics

Authorized Distributor

Click to View Pricing, Inventory, Delivery & Lifecycle Information:

[TE Connectivity:](#)

[3-1437020-7](#)