

THIS DRAWING IS UNPUBLISHED.

RELEASED FOR PUBLICATION

© COPYRIGHT 2011 BY TYCO ELECTRONICS CORPORATION. ALL RIGHTS RESERVED.

LOC  
DW

DIST

REVISIONS

P	LTR	DESCRIPTION	DATE	DWN	APVD
C		REVISED (ECR-13-012457)	14AUG13	JL	WK

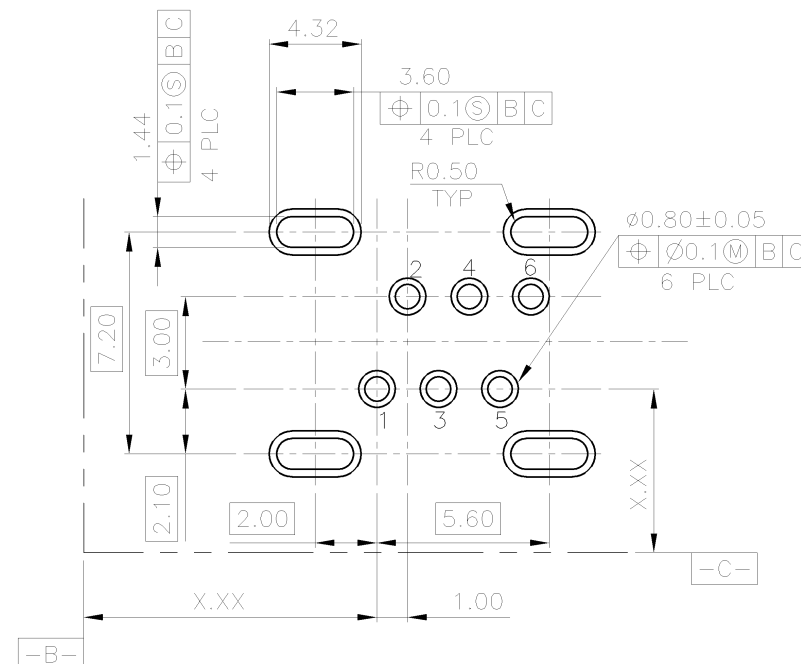
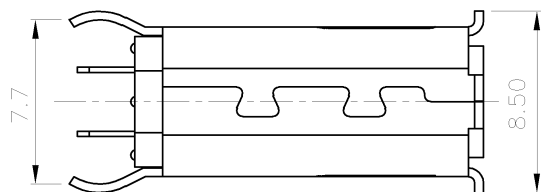
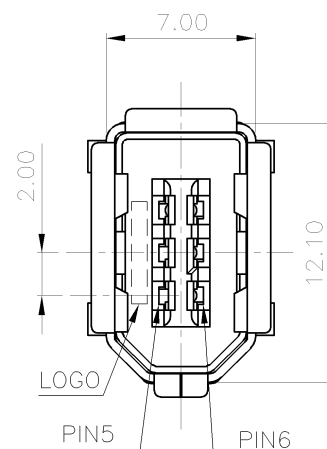
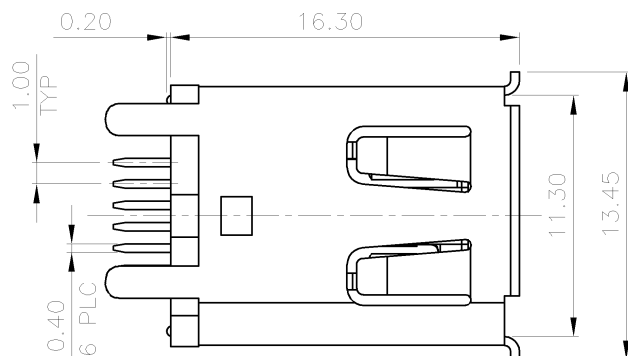
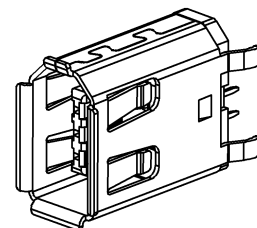
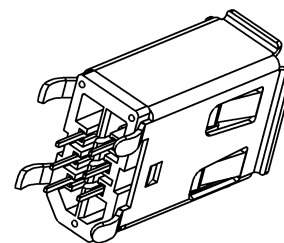
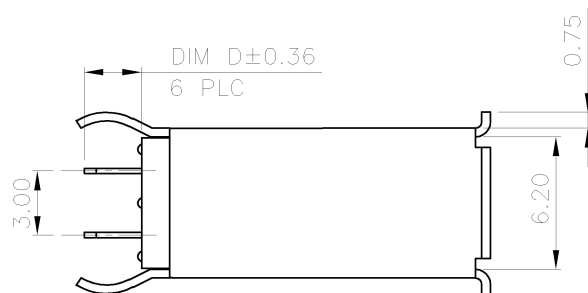

## RECOMMENDED PCB LAYOUT

## NOTE:

- MATERIAL:  
HOUSING: THERMOPLASTIC HIGH TEMP., UL 94V-0, BLACK COLOR.  
CONTACT: BRASS, THICKNESS=0.25mm.  
SHELL: PHOSPHOR BRONZE, THICKNESS=0.40mm
- FINISH:  
CONTACT: 0.762μm [30μ"] MIN. GOLD PLATED ON CONTACT AREA,  
2.54μm [100μ"] MIN. TIN-Cu PLATED ON SOLDER TAILS,  
1.27μm [50μ"] MIN. NICKEL UNDERPLATED ALL OVER.  
SHELL: 3.048μm [120μ"] MIN. NICKEL PLATED ALL OVER  
2.54μm [100μ"] MIN. Cu UNDERPLATED ALL OVER
- REFLOW SOLDER CAPABLE TO 260°C PER TEST SPEC.  
109-201, CONDITION B.

3.18	1734290-2
2.69	1734290-1
DIM D	PART NUMBER

THIS DRAWING IS A CONTROLLED DOCUMENT.

DIMENSIONS:	TOLERANCES UNLESS OTHERWISE SPECIFIED:
mm	
	0 PLC ± 0.38 1 PLC ± 0.25 2 PLC ± 0.13 3 PLC ± 0.05 4 PLC ± - ANGLES ± 3°
MATERIAL	FINISH
SEE NOTE	SEE NOTE

DWN	O. HU	23DEC2005
CHK	S. HOU	23DEC2005
APVD	W.J. KE	23DEC2005
PRODUCT SPEC	108-57599	
APPLICATION SPEC		
WEIGHT	2.62 GRAMS	
CUSTOMER DRAWING		

TE Connectivity

TE Connectivity

NAME			
IEEE 1394, RCPT, 6P VERTICAL, T/H			
SIZE	CAGE CODE	DRAWING NO	RESTRICTED TO
A3	00779	C=1734290	-
SCALE		SHEET	REV
-		1 OF 2	C

4

3

2

1

LOC		DIST		REVISIONS			
DW				P	LTR	DESCRIPTION	DATE
						SEE SHEET 1.	

TRAY

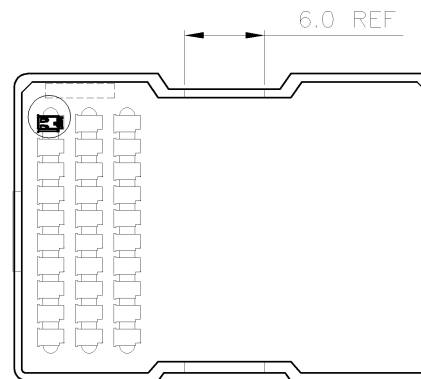
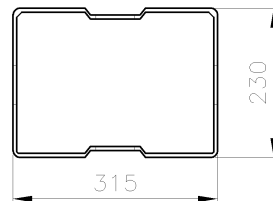

(BOTTOM COVER)

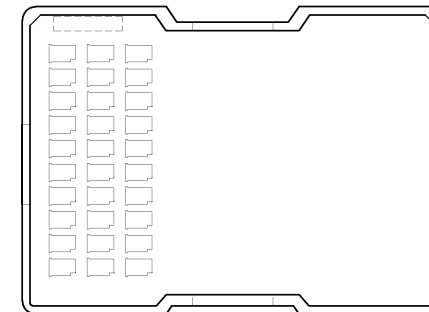

(TOP COVER)

- NOTES:
- MATERIAL:  
TRAY: PET  
SHIPPING BOX: CORRUGATED FIBER.
  - DIMENSION:  
TRAY: L=315mm, W=230mm, H=11.3mm  
SHIPPING BOX: 509mm\*345mm\*248mm
  - QUANTITY: SEE TABLE.
  - WEIGHT: SEE TABLE.

INNER BOX

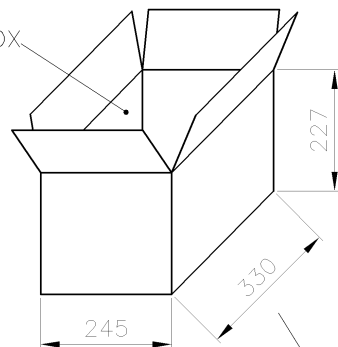

OUTER BOX

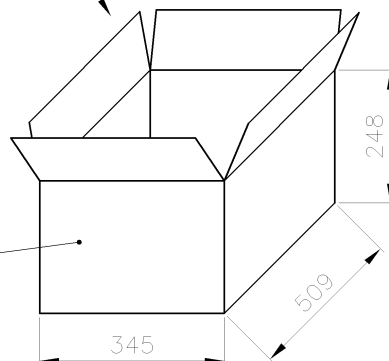

15.0	14.0	4000	2	20	100
N.W(KGS)	N.W(KGS)	PACKAGING QTY'S/ OUTER BOX	INNER BOX/ OUTER BOX	TRAYS/ INNER BOX	PCS/ TRAY

THIS DRAWING IS A CONTROLLED DOCUMENT.		DWN		-	
DIMENSIONS: mm		CHK		-	
TOLERANCES UNLESS OTHERWISE SPECIFIED:		APVD		-	
0 PLC ± -		PRODUCT SPEC		NAME	
1 PLC ± -		APPLICATION SPEC		IEEE 1394, RCPT, 6P VERTICAL, T/H	
2 PLC ± -		WEIGHT		SIZE CAGE CODE DRAWING NO	
3 PLC ± -		A3 00779		C=1734290	
4 PLC ± -		CUSTOMER DRAWING		RESTRICTED TO	
ANGLES ± -		SCALE		SHEET 2 of 2	
MATERIAL		FINISH		REV C	

# Mouser Electronics

Authorized Distributor

Click to View Pricing, Inventory, Delivery & Lifecycle Information:

[TE Connectivity:](#)

[1734290-2](#)