

MALE PCB PINS

WRAPOST TERMINALS

5275

5275-X-05-XX-00-00-01-0

Square press-fit in .035 plated through-hole

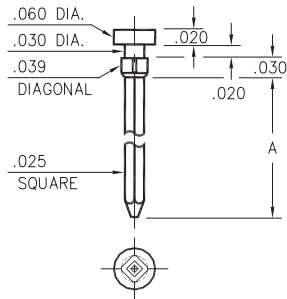

Basic Part Number	# of Wraps	Length A
5275-1	1	.370
5275-2	2	.470
5275-3	3	.610

1010 ⇔ 1012/1020 ⇔ 1022

10XX-X-05-XX-00-00-01-0

Press-fit in .057 mounting hole

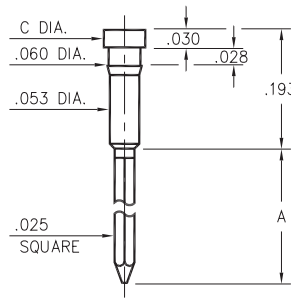

Basic Part Number	# of Wraps	Wrappost Length A	Head Dia. C
1012-1	1	.260	.072
1011-2	2	.360	
1010-3	3	.500	
1022-1	1	.260	.062
1021-2	2	.360	
1020-3	3	.500	

1215

1215-3-05-XX-00-00-01-0

Press-fit in .043 mounting hole

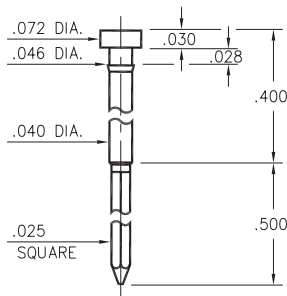

1124

1124-0-05-XX-00-00-01-0

Press-fit in .043 mounting hole

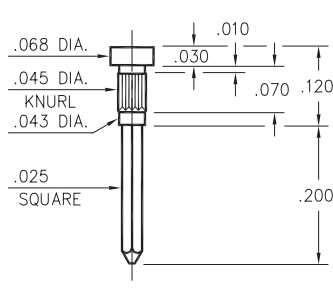

1210

1210-0-05-XX-00-00-01-0

Press-fit in .053 mounting hole

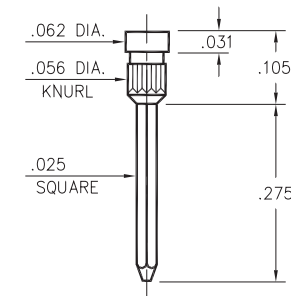

1222

1222-0-05-XX-00-00-01-0

Press-fit in .055 mounting hole

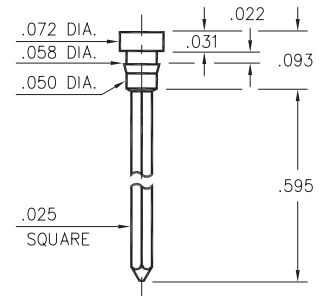

1221

1221-0-05-XX-00-00-01-0

Press-fit in .056 mounting hole

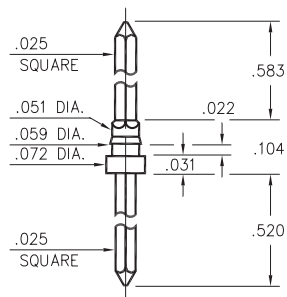

1110

1110-3-05-XX-00-00-01-0

Press-fit in .057 mounting hole

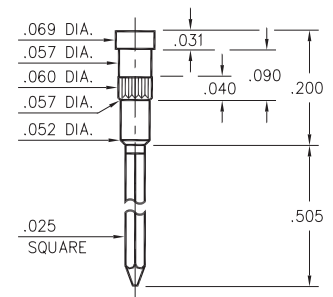

1094

1094-0-05-XX-00-00-01-0

Press-fit in .056 mounting hole

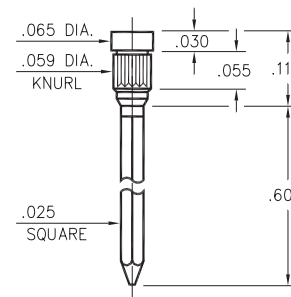

SPECIFICATIONS:

Pin Material: Brass Alloy 360, 1/2 Hard
(Except where noted)

Dimensions: Inches

Tolerances On: Lengths: ±.005
Diameters: ±.002
Angles: ± 2°



ORDER CODE: **XXXX - X - 05 - XX - 00 - 00 - 01 - 0**

BASIC PART #

SPECIFY PIN FINISH:

- 01 200 μ" TIN/LEAD OVER NICKEL
- ◆ 80 200 μ" TIN OVER NICKEL (RoHS)
- ◆ 15 10 μ" GOLD OVER NICKEL (RoHS)
- ◆ 21 20 μ" GOLD OVER NICKEL (RoHS)



Mouser Electronics

Authorized Distributor

Click to View Pricing, Inventory, Delivery & Lifecycle Information:

Mill-Max:

[5275-1-05-01-00-00-01-0](#) [5275-1-05-15-00-00-01-0](#) [1222-0-05-01-00-00-01-0](#) [1221-0-05-01-00-00-01-0](#) [1215-3-05-01-00-00-01-0](#) [1210-0-05-01-00-00-01-0](#) [1124-0-05-01-00-00-01-0](#) [1110-3-05-01-00-00-01-0](#) [1094-0-05-01-00-00-01-0](#) [1022-1-05-01-00-00-01-0](#) [1021-2-05-01-00-00-01-0](#) [1011-2-05-01-00-00-01-0](#) [1010-3-05-01-00-00-01-0](#) [1010-3-05-15-00-00-01-0](#) [1010-3-05-21-00-00-01-0](#) [1011-2-05-15-00-00-01-0](#) [1011-2-05-21-00-00-01-0](#) [1020-3-05-15-00-00-01-0](#) [1020-3-05-21-00-00-01-0](#) [1021-2-05-15-00-00-01-0](#) [1021-2-05-21-00-00-01-0](#) [1022-1-05-15-00-00-01-0](#) [1022-1-05-21-00-00-01-0](#) [1094-0-05-15-00-00-01-0](#) [1094-0-05-21-00-00-01-0](#) [1110-3-05-15-00-00-01-0](#) [1110-3-05-21-00-00-01-0](#) [1124-0-05-15-00-00-01-0](#) [1124-0-05-21-00-00-01-0](#) [1210-0-05-15-00-00-01-0](#) [1210-0-05-21-00-00-01-0](#) [1215-3-05-15-00-00-01-0](#) [1215-3-05-21-00-00-01-0](#) [1221-0-05-15-00-00-01-0](#) [1221-0-05-21-00-00-01-0](#) [1222-0-05-15-00-00-01-0](#) [1222-0-05-21-00-00-01-0](#) [1020-3-05-01-00-00-01-0](#) [1221-0-05-00-00-00-01-0](#) [1215-3-05-00-00-00-01-0](#) [1124-0-05-00-00-00-01-0](#) [1222-0-05-00-00-00-01-0](#) [1010-3-05-00-00-00-01-0](#) [1022-1-05-00-00-00-01-0](#) [1210-0-05-00-00-00-01-0](#) [1094-0-05-00-00-00-01-0](#) [1011-2-05-00-00-00-01-0](#) [1110-3-05-00-00-00-01-0](#) [5275-1-05-00-00-00-01-0](#) [1021-2-05-00-00-00-01-0](#)