

DESCRIPTION: MALE - DIP SOLDER / MACHINED - ECONOMY

No. OF PINS	DIMENSIONS							
	A	B	C	D	E	F	G	H
9	1.213	0.984	0.666	0.329	0.236	0.756	0.496	0.427
	30.80	24.99	16.92	8.36	5.99	19.20	12.60	10.85
15	1.541	1.312	0.994	0.329	0.236	1.091	0.496	0.427
	39.15	33.32	25.25	8.36	5.99	27.70	12.60	10.85
25	2.087	1.852	1.534	0.329	0.236	1.618	0.496	0.427
	53.00	47.04	38.96	8.36	5.99	41.10	12.60	10.85
37	2.728	2.500	2.182	0.329	0.236	2.256	0.496	0.427
	69.30	63.50	55.42	8.36	5.99	57.30	12.60	10.85
50	2.638	2.406	2.079	0.436	0.240	2.169	0.602	0.527
	67.00	61.11	52.80	11.07	6.10	55.10	15.30	13.39

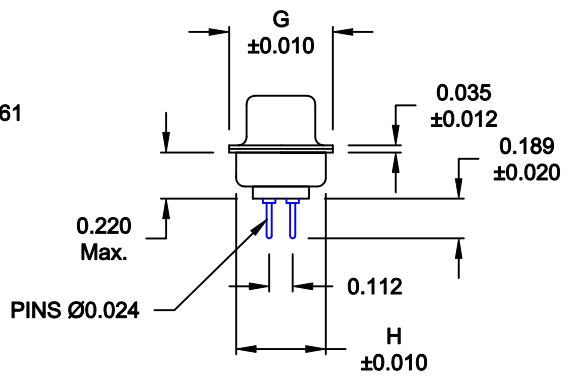
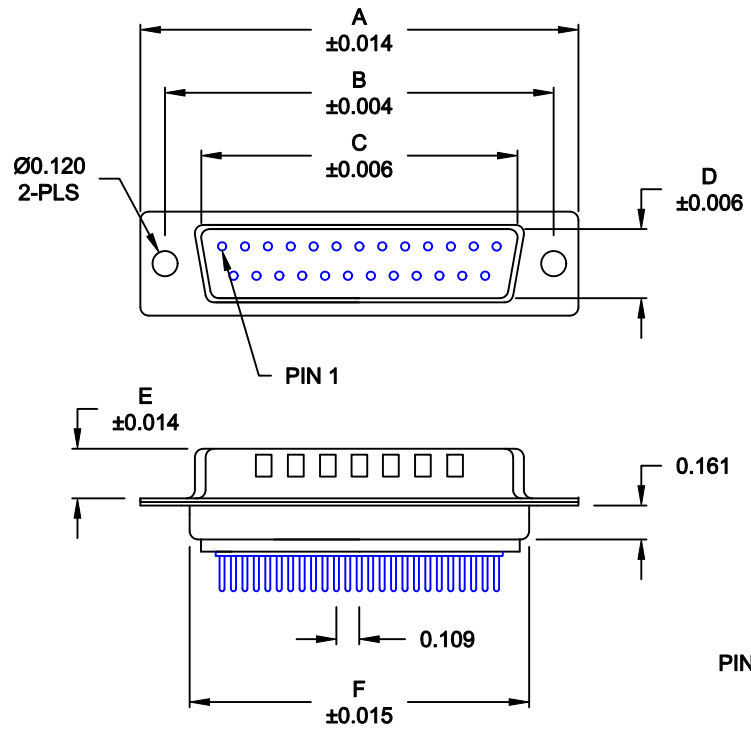

172-EYY-11YRYY1

- SERIES \_\_\_\_\_
- POSITIONS \_\_\_\_\_
- E09
  - E15
  - E25
  - E37
  - E50
- GENDER \_\_\_\_\_
- 1 = MALE
- TERMINATION \_\_\_\_\_
- 1 = DIP SOLDER
- SHELL PLATING \_\_\_\_\_
- 3 = NICKEL (GROUND INDENTS)
- RoHS COMPLIANT \_\_\_\_\_
- HARDWARE OPTIONS \_\_\_\_\_
- 00 = NO HARDWARE
  - 01 = .098" CLINCH NUT (BOARD SIDE)
  - 02 = .236" CLINCH NUT (BOARD SIDE)
  - 03 = .236" CLINCH NUT (MOUNTING SIDE)
  - 05 = .237" 4-40 BOARD LOCK
  - 08 = .228" 4-40 BOARD LOCK
  - 90 = .237" 4-40 BOARD LOCK
  - FOR 0.093" BOARD MAX.
  - 91 = .237" 4-40 SPACER/ BOARD LOCK
  - 92 = .237" 4-40 SPACER/ BOARD LOCK
  - FOR 0.093" BOARD MAX.
- PLATING OPTIONS \_\_\_\_\_
- 1 = GOLD FLASH
  - 2 = 30MICRO-INCH GOLD
  - 3 = 50 MICRO-INCH GOLD
  - 5 = 15 MICRO-INCH GOLD

**MATERIAL:**

- SHELL: STEEL, NICKEL PLATED
- INSULATOR: UL 94V-O RATED, WHITE PA6T
- PROCESS TEMP.: 260° PROCESS TEMPERATURE
- CONTACT: BRASS

**ELECTRICAL:**

- CURRENT RATING: 5 AMPS
- CONTACT RESISTANCE: 15 mOhms Max.
- INSULATION RESISTANCE: 1,000 MOhms min.
- VOLTAGE: 500VAC FOR 1 MINUTE
- TEMPERATURE: -50° C TO 100° C

DO NOT SCALE FROM DRAWING

	THESE DRAWINGS AND SPECIFICATIONS ARE THE PROPERTY OF NorComp AND SHALL NOT BE REPRODUCED, COPIED OR USED AS THE BASIS FOR THE MANUFACTURE OF SALE OF APPARATUS WITHOUT WRITTEN PERMISSION.		DRAWN: <b>PAM JENKINS</b>	DATE: <b>11-28-05</b>
			CHECKED:	DATE:
<h1>NorComp</h1>		SCALE: <b>1 : 1</b>	SHEET <b>1</b>	OF <b>3</b>
		DWG NO. <b>172-EYY-11YRYY1</b>		

RoHS COMPLIANT

DESCRIPTION: PCB LAYOUT - STANDARD "D" - MALE & FEMALE

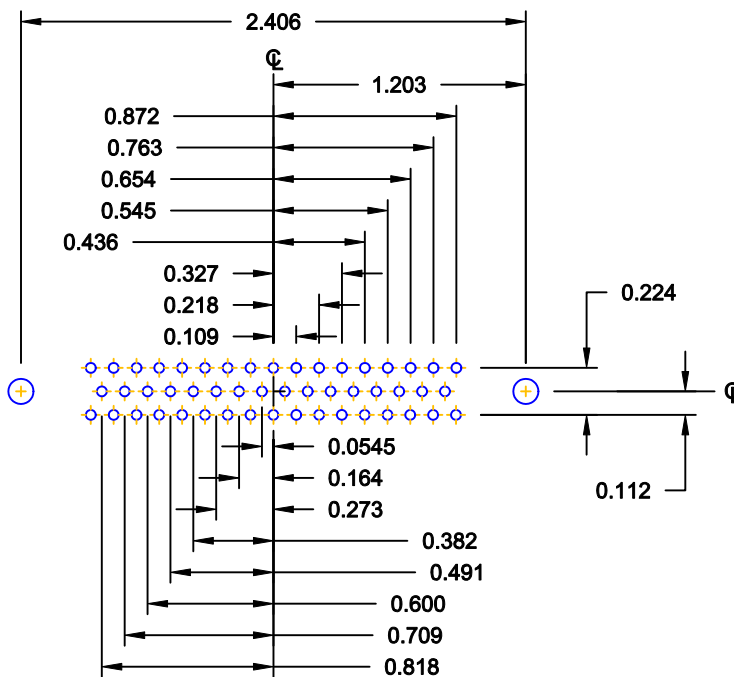
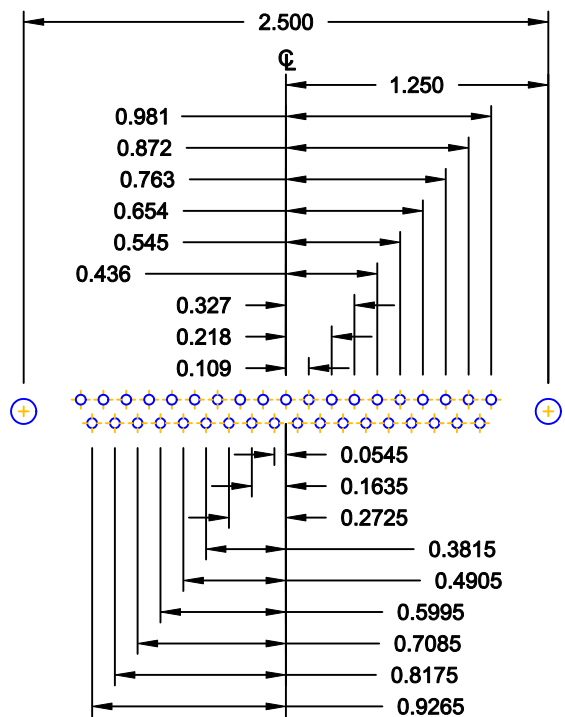
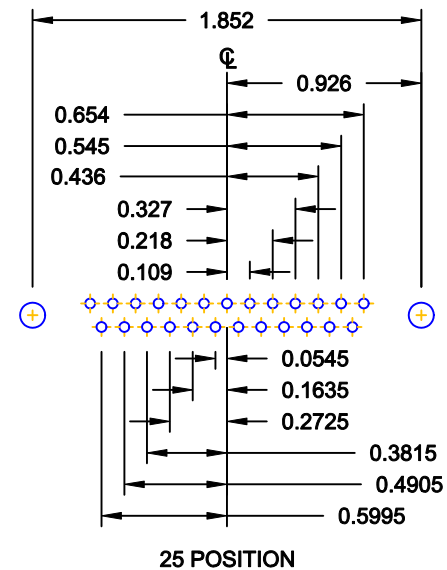
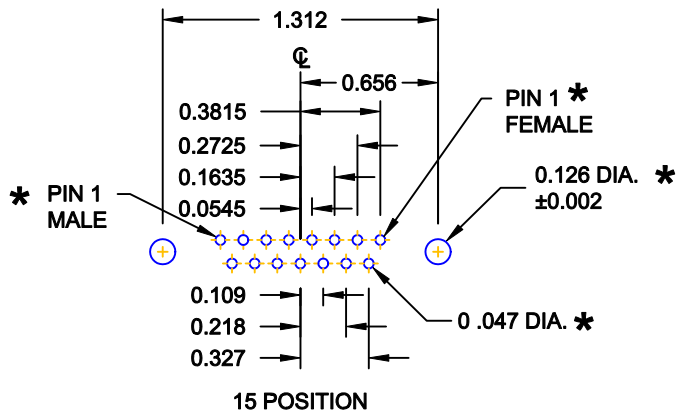
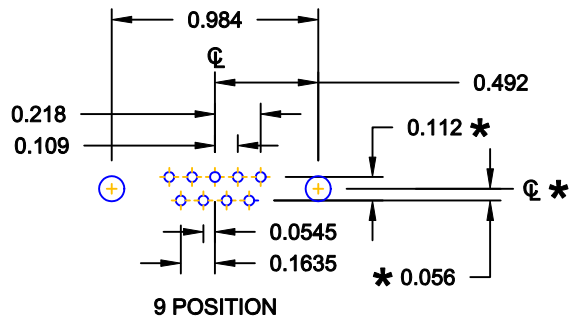

\* TYP. ON ALL SIZES

DO NOT SCALE FROM DRAWING

	THESE DRAWINGS AND SPECIFICATIONS ARE THE PROPERTY OF NorComp AND SHALL NOT BE REPRODUCED, COPIED OR USED AS THE BASIS FOR THE MANUFACTURE OF SALE OF APPARATUS WITHOUT WRITTEN PERMISSION.		DRAWN: <b>C. SMITH</b>	DATE: <b>03-08-06</b>
			CHECKED:	DATE:
<b>NorComp</b>	SCALE: <b>FULL</b>	SHEET <b>2</b> OF <b>3</b>	REV <b>15</b>	
	DWG NO. <b>172-EYY-11YRY1</b>			

ALL CLINCH-NUTS ARE 4-40 INTERNAL THREADS

**TOLERANCE:**  
ALL DIMENSIONS ARE ±0.010

01X ..... 0.098" (BOARD SIDE) - CN1

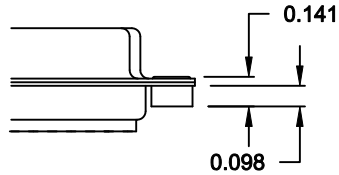

02X ..... 0.236" (BOARD SIDE) - CN2

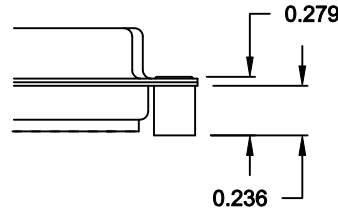

03X..... 0.236" (MATING SIDE) - CN8

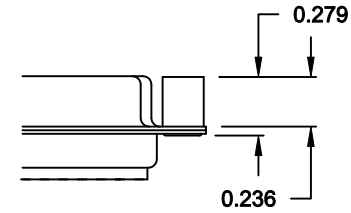

05X ..... 0.237" (BOARD SIDE) - CN10

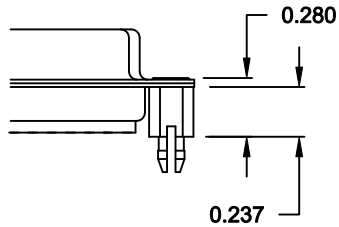

08X ..... 0.228" (BOARD SIDE) - CN3

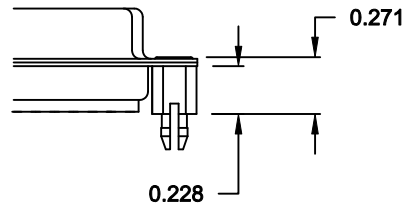

91X ..... 0.237" BOARD SIDE  
0.197 MATING SIDE  
CN10/SFSO4404

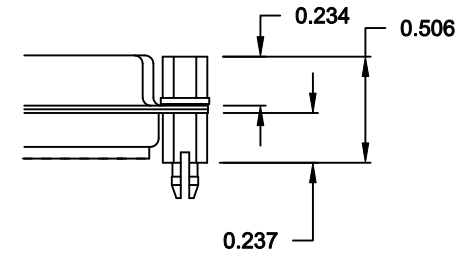

NOTE: 4-40 FEMALE SCREW LOCK IS REMOVABLE

90X ..... 0.237" (BOARD SIDE) - CN10-237-093

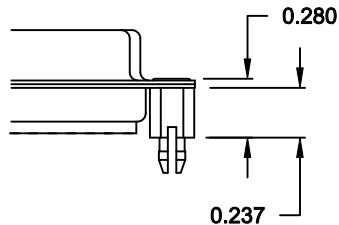

92X ..... 0.237" BOARD SIDE  
0.197 MATING SIDE  
CN10-237-093/SFSO4404

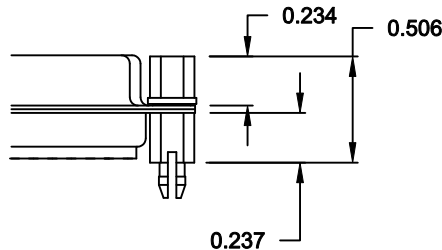

NOTE: 4-40 FEMALE SCREW LOCK IS REMOVABLE

NOTE: 90 & 92 OPTION FOR 0.093" MAX. BOARD THICKNESS

DO NOT SCALE FROM DRAWING

RoHS COMPLIANT

	THESE DRAWINGS AND SPECIFICATIONS ARE THE PROPERTY OF NorComp AND SHALL NOT BE REPRODUCED, COPIED OR USED AS THE BASIS FOR THE MANUFACTURE OF SALE OF APPARATUS WITHOUT WRITTEN PERMISSION.		DRAWN: <b>WAYNE ROBBINS</b>	DATE: <b>11-28-05</b>
			CHECKED:	DATE:
NorComp		SCALE:	SHEET <b>3</b> OF <b>3</b>	REV <b>15</b>
		DWG NO. <b>172-EYY-11YRY1</b>		

# Mouser Electronics

Authorized Distributor

Click to View Pricing, Inventory, Delivery & Lifecycle Information:

## NorComp:

<a href="#"><u>172-E37-113R021</u></a>	<a href="#"><u>172-E37-113R011</u></a>	<a href="#"><u>172-E37-113R031</u></a>	<a href="#"><u>172-E09-113R021</u></a>	<a href="#"><u>172-E09-113R011</u></a>	<a href="#"><u>172-E09-113R031</u></a>
<a href="#"><u>172-E15-113R911</u></a>	<a href="#"><u>172-E25-113R031</u></a>	<a href="#"><u>172-E25-113R011</u></a>	<a href="#"><u>172-E25-113R021</u></a>	<a href="#"><u>172-E50-113R021</u></a>	<a href="#"><u>172-E50-113R011</u></a>
<a href="#"><u>172-E50-113R031</u></a>	<a href="#"><u>172-E15-113R021</u></a>	<a href="#"><u>172-E15-113R031</u></a>	<a href="#"><u>172-E15-113R011</u></a>	<a href="#"><u>172-E37-113R001</u></a>	<a href="#"><u>172-E37-213R001</u></a>
<a href="#"><u>172-E09-113R001</u></a>	<a href="#"><u>172-E09-213R001</u></a>	<a href="#"><u>172-E25-113R001</u></a>	<a href="#"><u>172-E25-213R001</u></a>	<a href="#"><u>172-E50-213R001</u></a>	<a href="#"><u>172-E50-113R001</u></a>
<a href="#"><u>172-E15-113R001</u></a>	<a href="#"><u>172-E15-213R001</u></a>	<a href="#"><u>172-E09-113R911</u></a>	<a href="#"><u>172-E25-113R911</u></a>	<a href="#"><u>172-E37-113R911</u></a>	<a href="#"><u>172-E50-113R911</u></a>
<a href="#"><u>172-E15-113R051</u></a>	<a href="#"><u>172-E37-113R051</u></a>	<a href="#"><u>172-E50-113R051</u></a>	<a href="#"><u>172-E25-113R051</u></a>	<a href="#"><u>172-E09-113R051</u></a>	