

Hole according to product spec
65-12-445 (For press-fit) ,
65-12-446 (For STB)

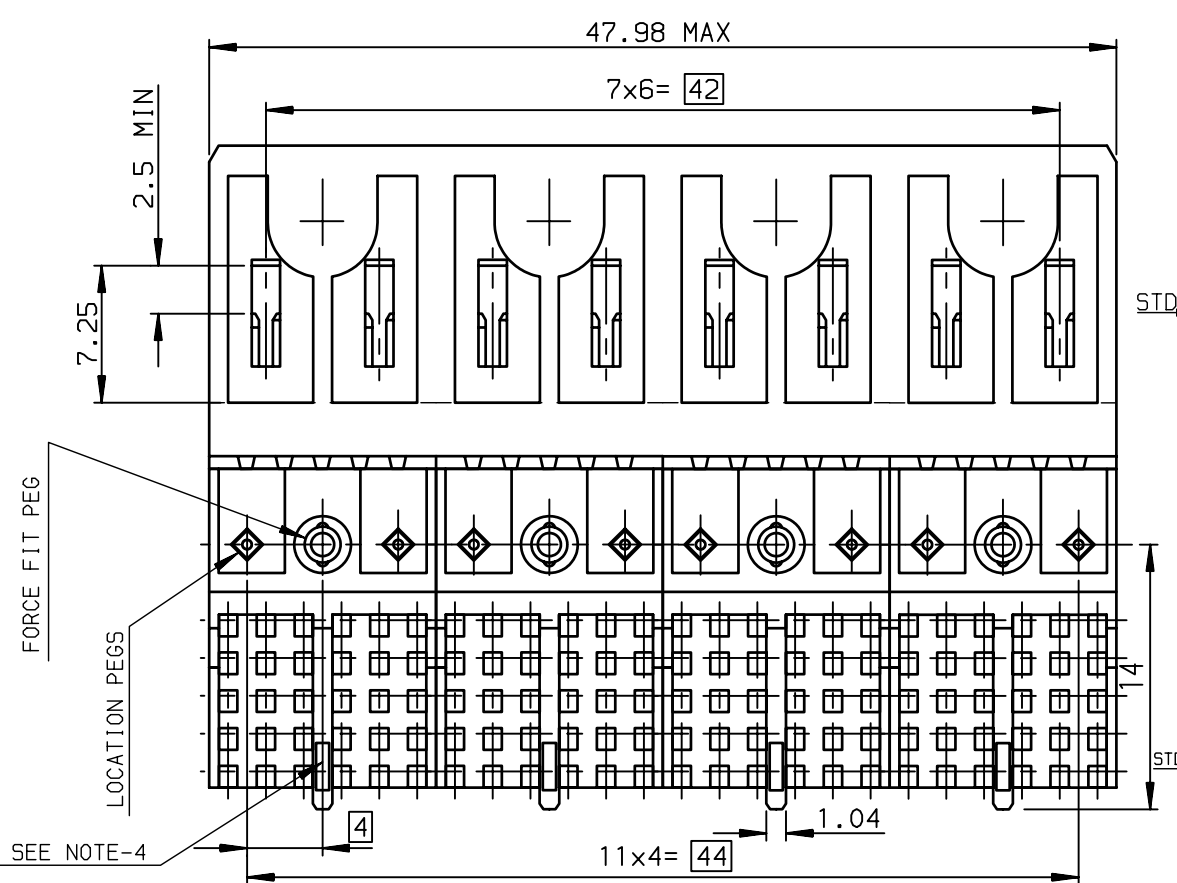
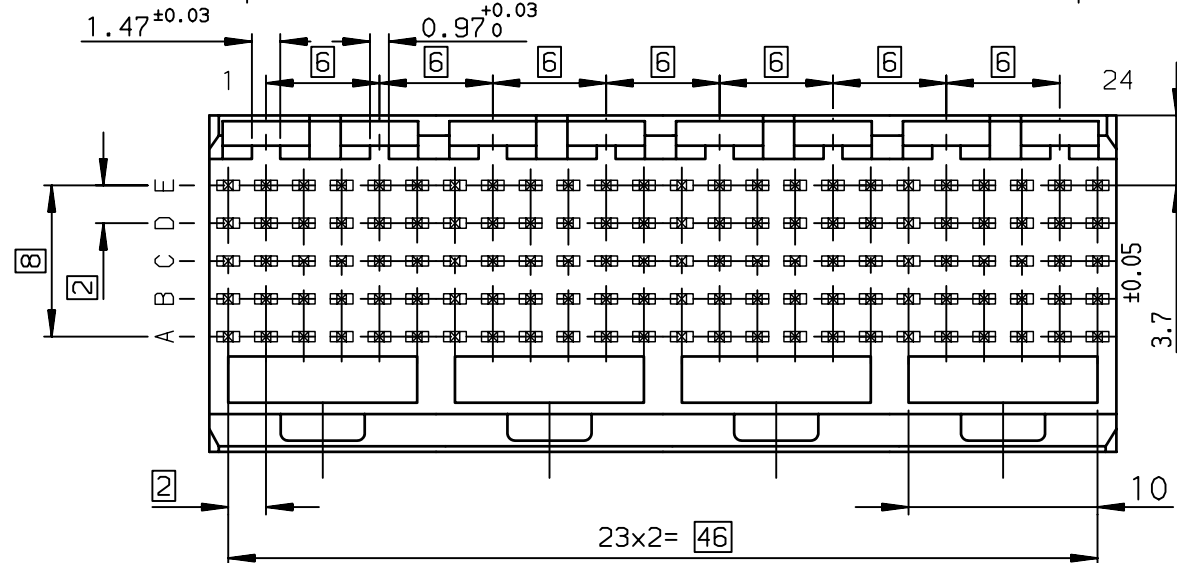
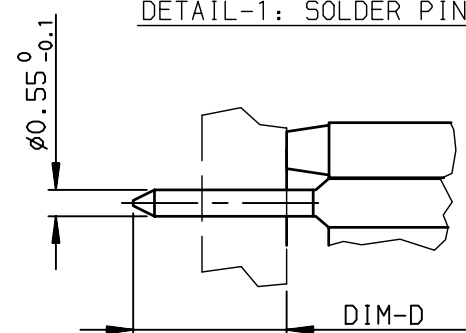

TIN LEAD PART NUMBER

Part Number: HM1L53xyP000Hz									
MATING LENGTH DIM-P / REPLACE 'x' BY:									
	ROW-A	ROW-B	ROW-C	ROW-D	ROW-E				
A =	5.00	5.00	5.00	5.00	5.00				
L =	5.75	5.75	5.75	5.75	5.75				
D =	6.50	6.50	6.50	6.50	6.50				
B =	6.50	5.00	5.00	5.00	5.00				
C =	6.50	5.75	5.75	6.50	5.75				
						TERMINATION LENGTH DIM-D	D=2.90 ±0.3,replace y by A		
							D=3.70 ±0.3,replace y by B		

LEAD FREE PART NUMBER

Part Number: HM1L53xyP000HzLF									
MATING LENGTH DIM-P / REPLACE 'x' BY:									
	ROW-A	ROW-B	ROW-C	ROW-D	ROW-E				
A =	5.00	5.00	5.00	5.00	5.00				
L =	5.75	5.75	5.75	5.75	5.75				
D =	6.50	6.50	6.50	6.50	6.50				
B =	6.50	5.00	5.00	5.00	5.00				
C =	6.50	5.75	5.75	6.50	5.75				
						TERMINATION LENGTH DIM-D	D=2.90 ±0.3,replace y by A		
							D=3.70 ±0.3,replace y by B		

GENERAL CHARACTERISTICS AND ROHS INFORMATIONS:

SEE PRODUCT SPECIFICATION 65-12-446

NOTE-2: INSERTION IN PCB, HANDLING OR BENCH PRESS
NOTE-3: IF SUFFIX "P" IS ADDED IN P/N PACKAGING IS IN TRAYS
BUT CONNECTOR MARKING IS WITHOUT "P"
EXAMPLE: HM1XXXXXXXXXH6P, MARKED HM1XXXXXXXXXH6
NOTE-4: REAR CENTRAL SUPPORT FOR BETTER ASSY ON PCB

<div>www.fciconnect.com</div>				surface		tolerance std		projection		<div>mm</div>							
				ISO 1302		ISO 406 ISO 1101		<div></div>									
				TOLERANCES UNLESS OTHERWISE SPECIFIED						<div></div>		<div></div>					
Dr	CHAMPION	1997/06/17		ANGULAR	LINEAR	0.X		±0.1		size	A3	Scale	2.5				
Eng	LENOIR	1997/06/17				0.XX		±0.1									
Chr	LEGARE	1997/06/17				0.XXX		±0.1									
Appr	LEGARE	1997/06/17		Product family						METRAL		ECN		LS07-0184			
												Spec ref -					
<div>FCI</div>				title						dwg no						Rev.	
				METRAL RA HEADER 5 ROW						CUSTOMER						sheet 1 of 1	
				catalog no													

Mouser Electronics

Authorized Distributor

Click to View Pricing, Inventory, Delivery & Lifecycle Information:

[FCI / Amphenol:](#)

[HM1L53AAP000H6PLF](#) [HM1L53DAP000H6PLF](#) [HM1L53LAP000H6PLF](#)