

| REVISIONS |     |                           |           |     |      |
|-----------|-----|---------------------------|-----------|-----|------|
| P         | LTR | DESCRIPTION               | DATE      | DWN | APVD |
|           | S2  | REVISED PER ECO-11-004587 | 11MAR11   | RK  | HMR  |
|           | T   | REVISED PER ECO-17-002584 | 11APR2017 | BDA | MM   |

1. .00038[.000015] GOLD IN THE CONTACT AREA, .00254[.000100] MATTE TIN-LEAD ON REMAINDER OF CONTACT, ALL OVER .00127[.000050] NICKEL.
2. POINT OF MEASUREMENT FOR PLATING THICKNESS.
3. THE NOTED DIMENSIONS APPLY AT THE INTERSECTION OF THE POST AND THE HOUSING.
4. ON ASSEMBLIES WITH FOUR OR MORE POSITIONS, TWO POLARIZATION SLOTS.  
ON ASSEMBLIES WITH TWO OR THREE POSITIONS, ONE POLARIZATION SLOT.
5. SELECT POST TAILS FORMED TO PROVIDE CONNECTOR HOLD DOWN UNTIL SOLDERED. CONFIGURATION ACCEPTS 0.69[.027]-2.03[.080] THICK PRINTED CIRCUIT BOARD. ( SEE DETAIL Z ).
6. OBSOLETE PARTS: OBSOLETE CIS STREAMLINING PER D.RENAUD/D.SINISI

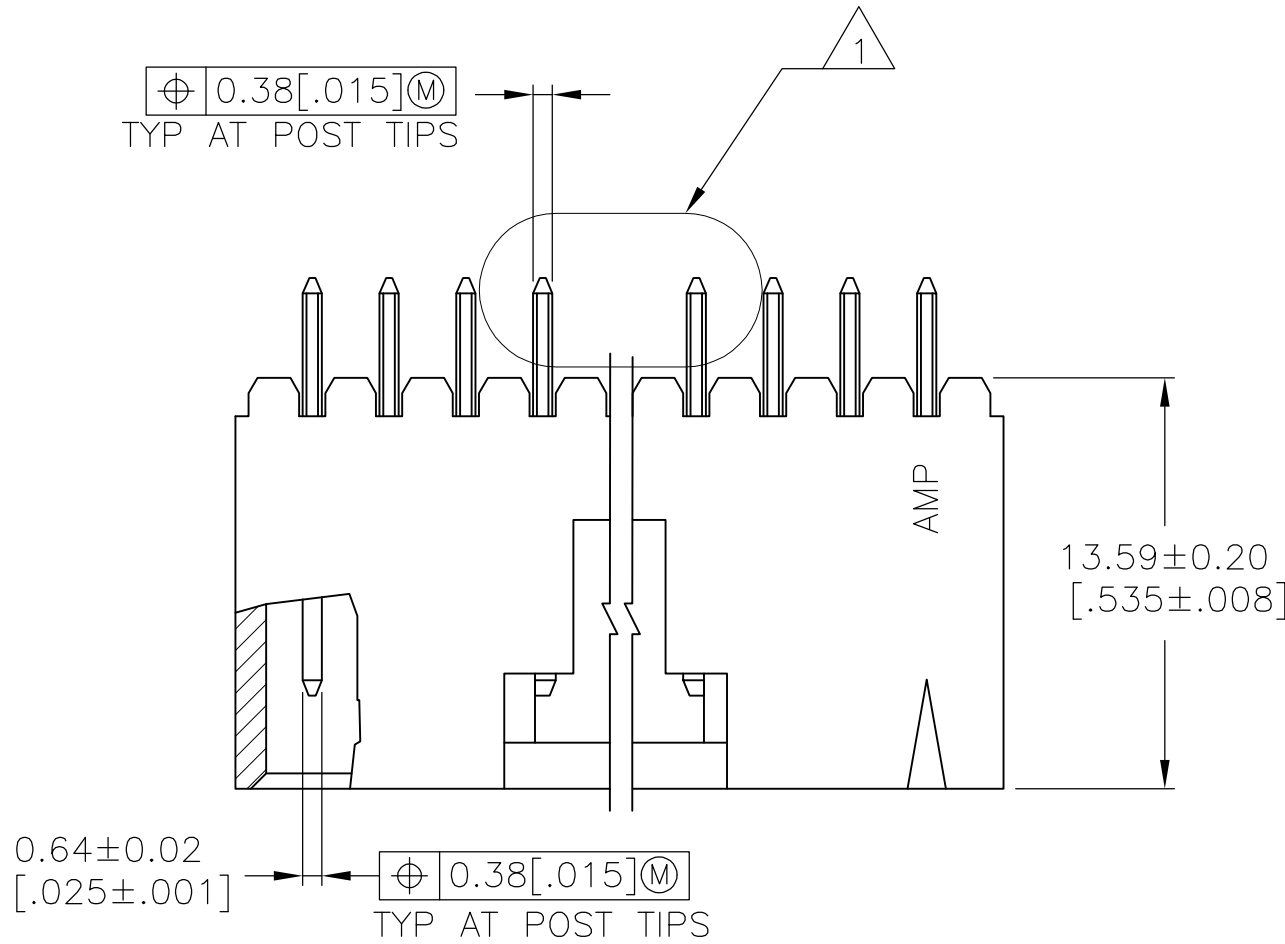

DETAIL Z  
POST DETAIL TYP  
2 POST MINIMUM

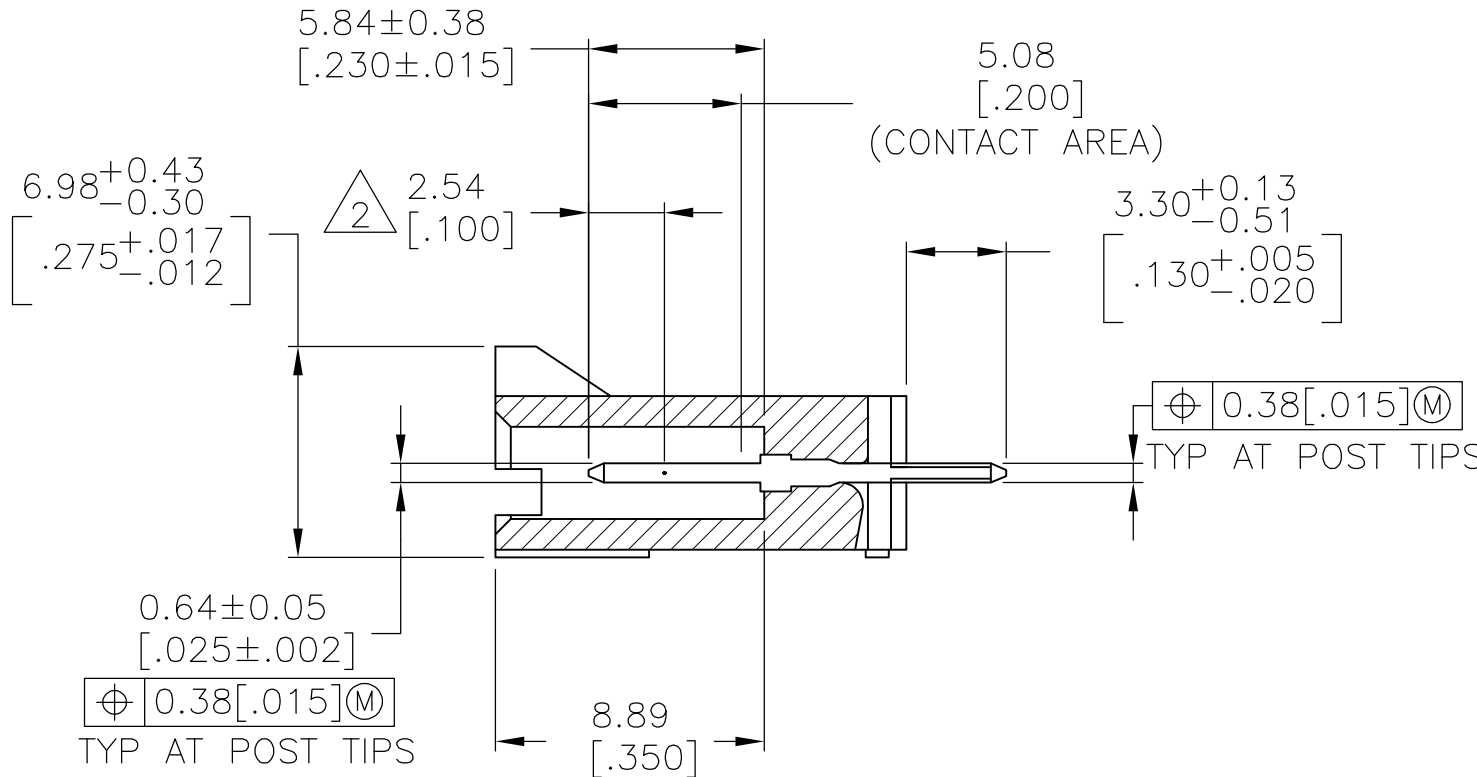
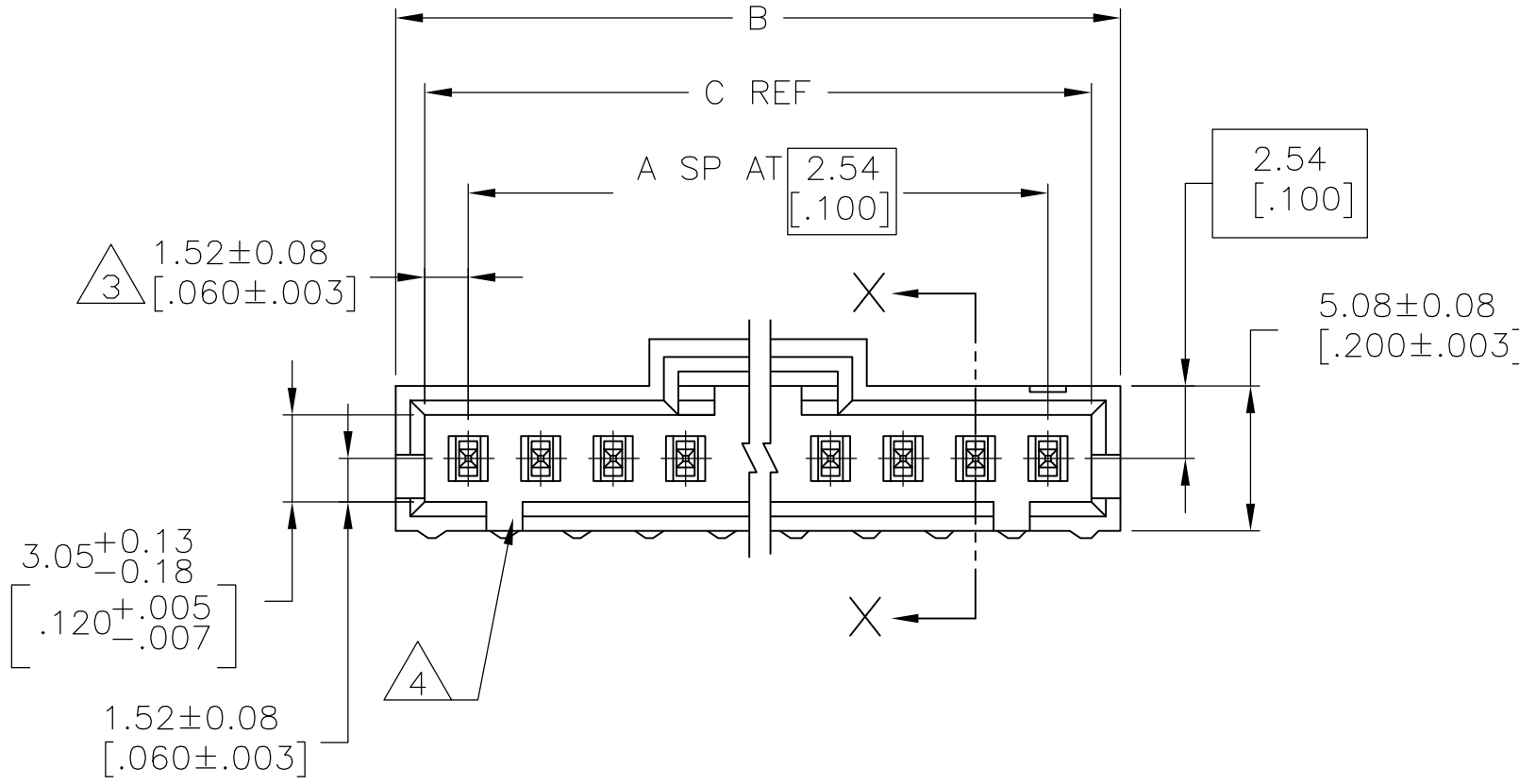

SECTION X-X

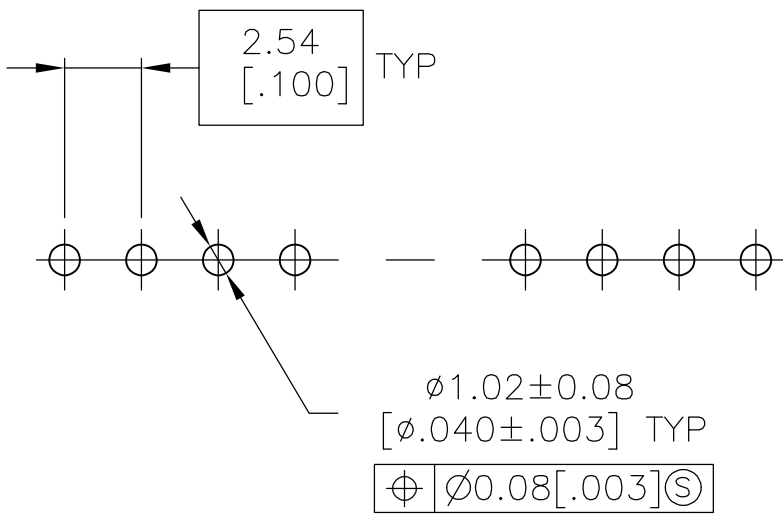

RECOMMENDED HOLE LAYOUT

|              |                          |                  |                  |    |    |            |                  |          |
|--------------|--------------------------|------------------|------------------|----|----|------------|------------------|----------|
| <div>6</div> | OBSOLETE                 | 64.01<br>[2.520] | 65.91<br>[2.595] | 24 | 25 | 2-103670-4 |                  |          |
|              |                          | 61.47<br>[2.420] | 63.37<br>[2.495] | 23 | 24 | 2-103670-3 |                  |          |
|              |                          | 58.93<br>[2.320] | 60.83<br>[2.395] | 22 | 23 | 2-103670-2 |                  |          |
| <div>6</div> | SUPERCEDED BY 7-104909-0 | 56.39<br>[2.220] | 58.29<br>[2.295] | 21 | 22 | 2-103670-1 |                  |          |
|              |                          | 53.85<br>[2.120] | 55.75<br>[2.195] | 20 | 21 | 2-103670-0 |                  |          |
| <div>6</div> | SUPERCEDED BY 6-104909-8 | 51.31<br>[2.020] | 53.21<br>[2.095] | 19 | 20 | 1-103670-9 |                  |          |
|              |                          | 48.77<br>[1.920] | 50.67<br>[1.995] | 18 | 19 | 1-103670-8 |                  |          |
| <div>6</div> |                          | 46.23<br>[1.820] | 48.13<br>[1.895] | 17 | 18 | 1-103670-7 |                  |          |
|              |                          | 43.69<br>[1.720] | 45.59<br>[1.795] | 16 | 17 | 1-103670-6 |                  |          |
|              |                          | 41.15<br>[1.620] | 43.05<br>[1.695] | 15 | 16 | 1-103670-5 |                  |          |
|              |                          | 38.61<br>[1.520] | 40.51<br>[1.595] | 14 | 15 | 1-103670-4 |                  |          |
|              |                          | 36.07<br>[1.420] | 37.97<br>[1.495] | 13 | 14 | 1-103670-3 |                  |          |
|              |                          | 33.53<br>[1.320] | 35.43<br>[1.395] | 12 | 13 | 1-103670-2 |                  |          |
|              |                          | 30.99<br>[1.220] | 32.89<br>[1.295] | 11 | 12 | 1-103670-1 |                  |          |
|              |                          | 28.45<br>[1.120] | 30.35<br>[1.195] | 10 | 11 | 1-103670-0 |                  |          |
|              |                          | 25.91<br>[1.020] | 27.81<br>[1.095] | 9  | 10 | 103670-9   |                  |          |
|              |                          | 23.37<br>[.920]  | 25.27<br>[.995]  | 8  | 9  | 103670-8   |                  |          |
|              |                          | 20.83<br>[.820]  | 22.73<br>[.895]  | 7  | 8  | 103670-7   |                  |          |
|              |                          | 18.29<br>[.720]  | 20.19<br>[.795]  | 6  | 7  | 103670-6   |                  |          |
|              |                          | 15.75<br>[.620]  | 17.65<br>[.695]  | 5  | 6  | 103670-5   |                  |          |
|              |                          | 13.21<br>[.520]  | 15.11<br>[.595]  | 4  | 5  | 103670-4   |                  |          |
|              |                          | 10.67<br>[.420]  | 12.57<br>[.495]  | 3  | 4  | 103670-3   |                  |          |
|              |                          | 8.13<br>[.320]   | 10.03<br>[.395]  | 2  | 3  | 103670-2   |                  |          |
|              |                          | 5.59<br>[.220]   | 7.49<br>[.295]   | 1  | 2  | 103670-1   |                  |          |
|              |                          |                  |                  | C  | B  | A          | NO<br>OF<br>POSN | PART NO. |

|   |  |  |                  |         |               |
|---|--|--|------------------|---------|---------------|
| THIS DRAWING IS A CONTROLLED DOCUMENT.            |  | DWN<br>S. SHUEY<br>3-5-91  | TE Connectivity  |         |               |
| CHK<br>M. RIDER<br>2-14-92                        |  | APVD<br>M. RIDER<br>2-14-92  |                  |         |               |
| DIMENSIONS:<br>mm [INCHES]                        | TOLERANCES UNLESS OTHERWISE SPECIFIED: | NAME<br>HDR ASSY, VERT, SINGLE ROW<br>2.54[1.00] CL, 0.64[.025] SQ POST,<br>WITH PLZN & RETENTIVE POSTS, AMPMODU MTE |                  |         |               |
|   | 0. PLC ± -                             | PRODUCT SPEC   | SIZE             |         | RESTRICTED TO |
|   | 1. PLC ± ± 0.13[.005]                  | 108-25034  | CAGE CODE        |         |               |
|   | 2. PLC ± ± 0.13[.005]                  | APPLICATION SPEC   | DRAWING NO       |         | REV           |
|   | 3. PLC ± ± 0.13[.005]                  | 114-25026  | 100779           |         |               |
| MATERIAL<br>MTP, COLOR = BLACK<br>CONTACTS: BRASS | FINISH<br>1                            | WEIGHT<br>-  | A1 100779 103670 |         |               |
| CUSTOMER DRAWING                                  |  | SCALE<br>4:1   | SHEET<br>1       | OF<br>1 |               |

# Mouser Electronics

Authorized Distributor

Click to View Pricing, Inventory, Delivery & Lifecycle Information:

[TE Connectivity:](#)

[1-103670-6](#)