

4

3

2

1

THIS DRAWING IS UNPUBLISHED.

RELEASED FOR PUBLICATION

© COPYRIGHT

ALL RIGHTS RESERVED.

LOC

DIST

REVISIONS

P	LTR	DESCRIPTION	DATE	DWN	APVD
	C1	ECR-14-002428	22FEB2014	GK	HMR

REPLACED BY OCEAN STYLE APPLICATOR PART  
NUMBER 2151041-1

FOR REPLACEMENT PARTS FOR APPLICATOR 1426420  
REFER TO ADDITIONAL PAGE(S). SPARE PARTS KIT (IF LISTED)  
WILL REMAIN AVAILABLE.

THE REPLACEMENT OCEAN STYLE APPLICATOR HAS THE  
SAME TERMINATOR/PRESS INTERFACE AS APPLICATOR  
1426420

THIS DRAWING IS A CONTROLLED DOCUMENT.		DWN	GOPALAKRISHNA HV			
		CHK	RAGHAVENDRA			
		APVD	RAGHAVENDRA			
		PRODUCT SPEC				
		APPLICATION SPEC				
		WEIGHT				
		CUSTOMER DRAWING		SCALE	SHEET 1 OF 2	
				REV	C1	

TE Connectivity			
SIDE FEED HD-I APPLICATOR			
SIZE	CAGE CODE	DRAWING NO	RESTRICTED TO
A3		©- 1426420	

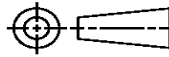
DIMENSIONS:	TOLERANCES UNLESS OTHERWISE SPECIFIED:
	0 PLC ± 1 PLC ± 2 PLC ± 3 PLC ± 4 PLC ± ANGLES ± FINISH
MATERIAL	

THIS DRAWING IS A CONTROLLED DOCUMENT

LAYOUT  
L1426411

SET UP GAGE  
458637-3





20

RELEASED FOR PUBLICATION  
BY AMP INCORPORATED. ALL RIGHTS RESERVED.

THIS DRAWING IS UNPUBLISHED.  
© COPYRIGHT 20

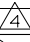
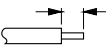
DRAWING MADE IN THIRD ANGLE PROJECTION

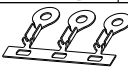
PART NUMBER	REV	FIRST USED	TERMINATOR	FEED TYPE	DESCRIPTION
1426420-1	C	-	LEADMAKER	MECH POST FEED	CUTS CARRIER
1426420-2	C	-	BENCH	MECH PRE FEED	CUTS CARRIER
1426420-6	C	-	LEADMAKER	MECH POST FEED	CONTINUOUS CARRIER
7-1426420-1	C	-	LEADMAKER	MECH POST FEED	-1 AND SPARE PARTS
7-1426420-2	C	-	BENCH	MECH PRE FEED	-2 AND SPARE PARTS
7-1426420-6	C	-	LEADMAKER	MECH POST FEED	-6 AND SPARE PARTS
7-1426420-7	A	-	-	-	SPARE PARTS KIT

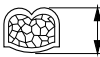
CRIMP DATA AMP TERMINAL AMP CRIMP SPECS				
TERMINAL NAME: AMP MCP 1.2-LL				
CRIMP	SIZE	TYPE	RANGE	
WIRE	1.27 [.050 IN]	F	0.25mm <sup>2</sup> -0.35mm <sup>2</sup> (24-22 AWG)	
INSUL	3.05 [.120 IN]	0	1.10-1.75 [.043-.069 IN] 	
WIRE STRIP LENGTH 3.00-3.60 [.118-.142 IN] 		APPL INSTRUCTION 408-8322		
TERMINAL -		-		FEED
APPL SPEC 114-18464		-		7.50 [.295 IN]
TERMINALS APPLIED				
TERMINAL	SEAL	-	-	-
1452665	967067-1	-	-	-
-	967067-2	-	-	-
-	963142-2	-	-	-
-	-	-	-	-
-	-	-	-	-
-	-	-	-	-
-	-	-	-	-
-	-	-	-	-
WIRE SIZE 		CRIMP HEIGHT 		PIN PN AND LENGTH [IN]
mm <sup>2</sup> AWG				
0.35mm <sup>2</sup>		0.84 ±0.03 [.033 ±.001 IN]		5-354779-0 [.3240]
22 AWG		0.83 ±0.03 [.033 ±.001 IN]		5-354779-0 [.3240]
0.25mm <sup>2</sup>		0.78 ±0.03 [.031 ±.001 IN]		5-354779-4 [.3260]
24 AWG		0.75 ±0.03 [.030 ±.001 IN]		5-354779-6 [.3270]
-		-		-
-		-		-
-		-		-
-		-		-
-		-		-
-		-		-
-		-		-
-		-		-
-		-		-
-		-		-

1. RECOMMENDED SPARE PARTS.
2. GREASE RAM, CAM, CAM FOLLOWER AND FEED ROD LIGHTLY.
3. LUBRICATE DAILY PER THE APPLICATOR INSTRUCTION SHEET SUPPLIED WITH THE APPLICATOR.
4. THIS APPLICATOR APPLIES TERMINAL WITH A SEAL. WIRE INSULATION DIA IS DEPENDENT ON SEAL BEING APPLIED. CHOICE OF SEAL IS DEPENDENT ON HOUSING CAVITY DIA. & WIRE APPLIED. REFER TO APPL. SPEC. FOR DETAILS.
5. APPLY TORQ-SEAL IN ALLEN SOCKET TO FILL HOLE AFTER FLAT HD HAS BEEN ADJUSTED TO CORRECT HEIGHT AT QUALIFICATION. APPLY #1-23419-5 LOC-TITE TO THREADS.
6. DUE TO THE DEMANDS OF APPLICATION SPEC 114-18464 IT IS IMPORTANT, IF THE ANVIL IS MOVED OR REPLACED, THAT IT IS BIASED TOWARDS THE OPERATOR'S POSITION AS FAR AS POSSIBLE WHEN RE-SECURING TO THE BASE PLATE.

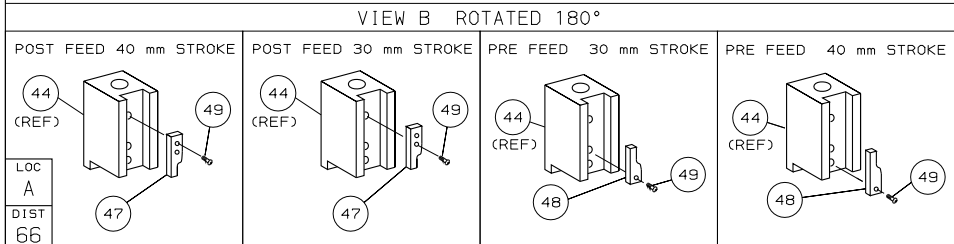

AMP 1756 REV 3-92 29-AUG-06 11:25:29 us024474

1426420 1426420

/home/us024474/tecm0d

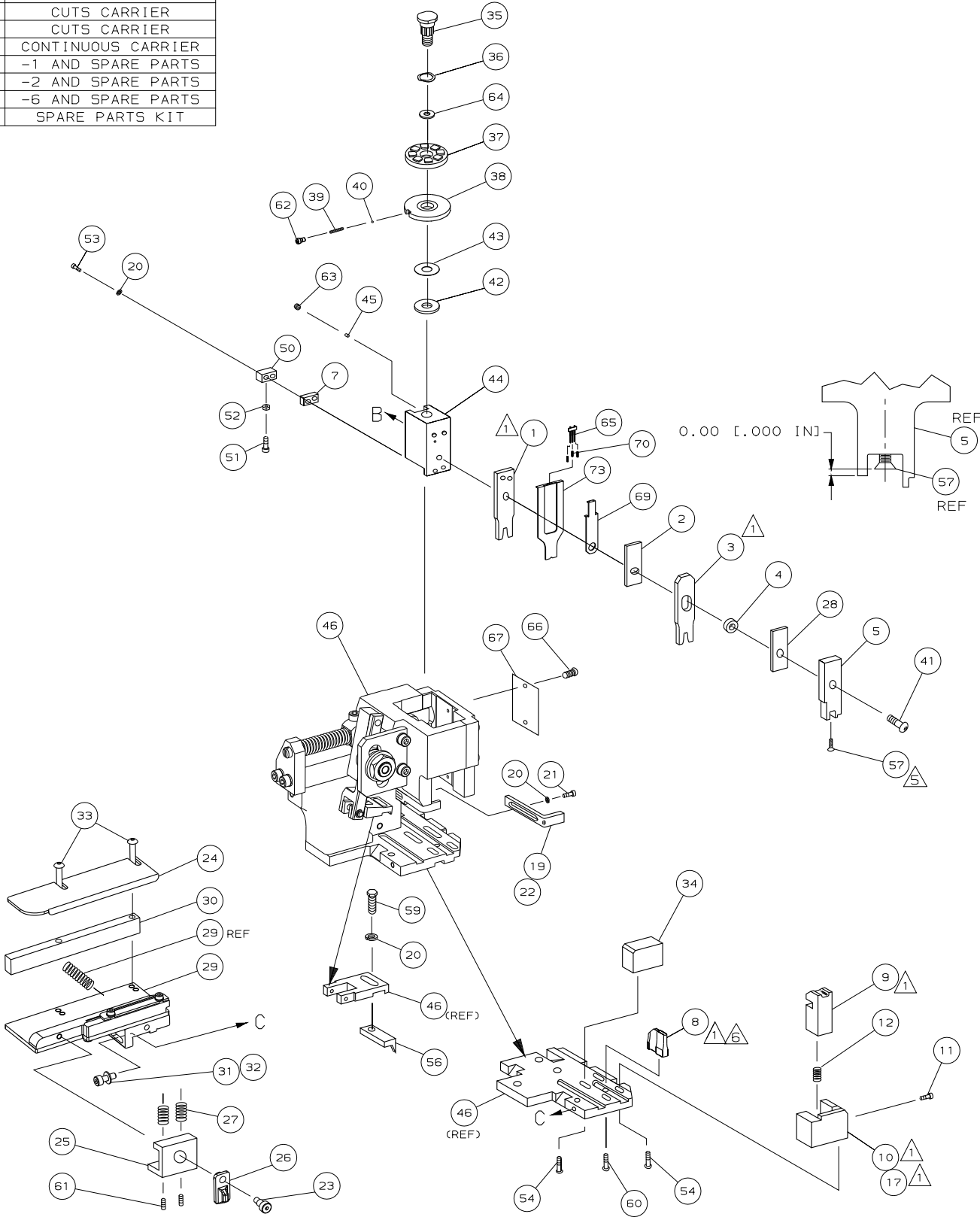

TOOLING APPROVED BY  
GB GATD & TERMINAL  
PRODUCT ENGINEERING  
GERMANY.

QTY REQD PER ASSY	PART NO	DESCRIPTION	ITEM NO
-77	-76	-72	-71
-6	-2	-1	

-	1	1	1	1	1	1	1490525-1	DEPRESSOR, WIRE	73
-	1	1	1	1	1	1	1426420	PRINT, APPLICATOR LOG SHEET	72
-	1	1	1	1	1	1	1338705-1	DOCUMENTATION PACKAGE	71
-	3	3	3	3	3	3	2-23147-2	SPRING, DEPRESSOR	70
-	1	1	1	1	1	1	1490524-2	SPACER, DEPRESSOR	69
-	1	1	1	1	1	1			68
-	1	1	1	1	1	1	461264-1	PLATE, IDENTIFICATION	67
-	2	2	2	2	2	2	21017-2	SCR, DRIVE (#2X.19) ID PLATE	66
-	1	1	1	1	1	1	1424350-1	HOLDER, PIN, WIRED	65
-	1	1	1	1	1	1	986950-1	WASHER, FLAT PRECISION	64
-	1	1	1	1	1	1	3-18031-0	SCR, SKT SET (M6X6) RAM	63
-	1	1	1	1	1	1	18023-9	SCR, SHC (M4X6) INS DISC	62
-	2	2	2	2	2	2	2-18032-5	SCR, SET (M5X20) DRAG	61
-	1	1	1	1	1	1	18024-7	SCR, BHC (M4X10) ANVIL	60
-	1	1	1	1	1	1	5-18022-2	SCR, HEX (M4X8) FEED FINGER	59
-	1	1	1	1	1	1			58
-	1	1	1	1	1	1	985575-3	SCR, FHC (M3X10) DEP	57
-	1	1	1	1	1	1	1338685-1	PAWL, FEED	56
-	4	4	4	4	4	4			55
-	2	2	2	2	2	2	18024-8	SCR, BHC (M4X12) SHEAR HOLDER	54
-	1	1	1	1	1	1	1-18023-3	SCR, SHC (M4X16) TERM HLD DWN	53
-	1	1	1	1	1	1	18030-1	NUT, HEX (M3) HOLD DOWN	52
-	1	1	1	1	1	1	811242-5	BUMPER, HOLDDOWN	51
-	1	1	1	1	1	1	690753-2	SPACER, TONKER	50
-	1	1	1	1	1	1	18024-3	SCR, BHC (M3X10) CAM	49
-	1	1	1	1	1	1	1338675-1	CAM, PRE FEED 30 & 40 mm ST	48
-	1	1	1	1	1	1	1338676-1	CAM, POST FEED 30 & 40 mm ST	47
-	1	1	1	1	1	1	1320999-3	APPLICATOR BASIC SUBASSY	46
-	1	1	1	1	1	1	690191-1	PLUG, NYLON	45
-	1	1	1	1	1	1	1338660-1	RAM	44
-	1	1	1	1	1	1	690125-1	WASHER, LAMINATED	43
-	1	1	1	1	1	1	690124-1	WASHER, RAM	42
-	1	1	1	1	1	1	2-18024-6	SCR, BHC (M8X25) RAM	41
-	1	1	1	1	1	1	23241-1	BALL, STEEL	40
-	1	1	1	1	1	1	2-22278-7	SPRING, COMPRESSION	39
-	1	1	1	1	1	1	1320922-1	DISC, INSULATION	38
-	1	1	1	1	1	1	354777-1	WIRE DISC, PLASTIC	37
-	1	1	1	1	1	1	22480-5	WASHER, SPRING	36
-	1	1	1	1	1	1	690212-1	POST, RAM	35
-	1	1	1	1	1	1	1-1320934-6	SUPPORT, TERMINAL	34
-	2	2	2	2	2	2	1-18024-0	SCR, BHC (M4X20) STRIP GUIDE	33
-	1	1	1	1	1	1	18027-2	WASHER, FLAT (M4)	32
-	1	1	1	1	1	1	1-18023-2	SCR, SKT CAP (M4X12) MOUNT BLOCK	31
-	1	1	1	1	1	1	1320908-3	SPACER, STRIP GUIDE	30
-	1	1	1	1	1	1	1633073-2	STRIP GUIDE PLATE ASSY	29
-	1	1	1	1	1	1	455888-7	SPACER, FRONT SHEAR DEP	28
-	2	2	2	2	2	2	1-22284-0	SPRING, DRAG	27
-	1	1	1	1	1	1	356835-1	LEVER, DRAG RELEASE	26
-	1	1	1	1	1	1	240792-1	DRAG, TERMINAL	25
-	1	1	1	1	1	1	1320928-2	PLATE, STRIP GUIDE	24
-	1	1	1	1	1	1	980371-4	SCR, SHC 5HLD	23
-	1	1	1	1	1	1	690472-2	STRIPPER	22
-	1	1	1	1	1	1	1-18023-1	SCR, SHC (M4X10) STRIPPER	21
-	4	4	4	4	4	4	18025-2	WASHER, LOCK (M4) STRIPPER	20
-	1	1	1	1	1	1	1424364-1	STRIPPER	19
-	1	1	1	1	1	1			18
-	1	1	1	1	1	1			16
-	1	1	1	1	1	1			15
-	1	1	1	1	1	1			14
-	1	1	1	1	1	1			13
-	1	1	1	1	1	1	3-22280-3	SPRING, SHEAR	12
-	1	1	1	1	1	1	356885-5	STOP, SHEAR	11
-	1	1	1	1	1	1	1-1320921-0	HOLDER, SHEAR, FRONT (CUT)	10
-	1	1	1	1	1	1	318707-9	SHEAR, FLOAT (FRONT)	9
-	1	2	2	2	1	1	3-1333225-9	ANVIL	8
-	1	1	1	1	1	1	240641-1	SPACER, DEPRESSOR (REAR)	7
-	1	1	1	1	1	1			6
-	1	1	1	1	1	1	1338680-1	DEPRESSOR, SHEAR (FRONT)	5
-	1	1	1	1	1	1	238011-4	SPACER, BLOCK CRIMPER	4
-	1	2	2	2	1	1	1-1583690-1	CRIMPER, INSULATION	3
-	1	1	1	1	1	1	455888-1	SPACER, CRIMPER	2
-	1	2	2	2	1	1	1-1673600-0	CRIMPER, WIRE	1
-	77	-76	-72	-71	-6	-2	-1		
PART NO								DESCRIPTION	ITEM NO
REVISION OF EACH ASSY NO (WHEN BLANK, USE DWG REVISION)									
QTY REQD PER ASSY								PARTS LIST	
DIMENSIONS, mm [INCHES]								MATL	
DO NOT SCALE PRINT.								HT TR	
TOLERANCES UNLESS OTHERWISE SPECIFIED:								FIN	
1. PLC DEC ±									
2. PLC DEC ±									
3. PLC DEC ±									
ANGLES ±									
SURF TEXTURE:									
REMOVE BURRS, BREAK SHARP EDGES RO.36 MAX									
C ECR-06-020605									
REVISION RECORD									
RK AUG06									
APP DATE									
SCALE									
D									
DWG NO									
1426420									
SHEET									
1 of 1									
REV									
C									
CUSTOMER AND ASSEMBLY DRAWING									
RESTRICTED TO									

# Mouser Electronics

Authorized Distributor

Click to View Pricing, Inventory, Delivery & Lifecycle Information:

[TE Connectivity:](#)

[1426420-6](#)