

## PCB terminal block - MKDS 5/ 2-9,5 - 1714971

Please be informed that the data shown in this PDF Document is generated from our Online Catalog. Please find the complete data in the user's documentation. Our General Terms of Use for Downloads are valid (<http://phoenixcontact.com/download>)



PCB terminal block, Nominal current: 32 A, Nom. voltage: 1000 V, Pitch: 9.52 mm, Number of positions: 2, Connection method: Screw connection with tension sleeve, Mounting: Wave soldering, Conductor/PCB connection direction: 0 °, Color: green, The article can be aligned to create different nos. of positions!

### Product Features

- Well-known connection principle allows worldwide use
- Low temperature rise, thanks to maximum contact force
- Allows connection of two conductors

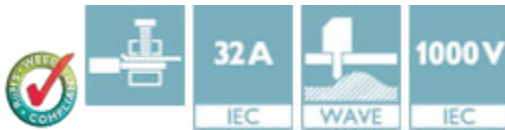

### Key Commercial Data

|                                      |   |
|--------------------------------------|---|
| Packing unit                         | 1 pc  |
| Minimum order quantity               | 50 pc   |
| GTIN                                 | <br>4 017918 024116 |
| Weight per Piece (excluding packing) | 6.49 g  |
| Custom tariff number                 | 85369010  |
| Country of origin                    | Germany   |

### Technical data

#### Dimensions

|                          |          |
|--------------------------|----------|
| Length                   | 19.05 mm |
| Pitch                    | 9.52 mm  |
| Dimension a              | 9.52 mm  |
| Width                    | 12.5 mm  |
| Constructional height    | 22 mm    |
| Height                   | 21.5 mm  |
| Length of the solder pin | 5 mm     |

# PCB terminal block - MKDS 5/ 2-9,5 - 1714971

## Technical data

### Dimensions

|                |              |
|----------------|--------------|
| Pin dimensions | 0,9 x 0,9 mm |
| Hole diameter  | 1.3 mm       |

### General

|  |   |
|--|---|
| Range of articles                      | MKDS 5  |
| Insulating material group              | I   |
| Rated surge voltage (III/3)            | 6 kV  |
| Rated surge voltage (III/2)            | 6 kV  |
| Rated surge voltage (II/2)             | 6 kV  |
| Rated voltage (III/3)                  | 690 V   |
| Rated voltage (III/2)                  | 1000 V  |
| Rated voltage (II/2)                   | 1000 V  |
| Connection in acc. with standard       | EN-VDE  |
| Nominal current $I_N$                  | 32 A  |
| Nominal cross section                  | 4 mm <sup>2</sup>                                     |
| Maximum load current                   | 32 A (with 6 mm <sup>2</sup> conductor cross section) |
| Insulating material                    | PA  |
| Solder pin surface                     | Sn  |
| Flammability rating according to UL 94 | V0  |
| Internal cylindrical gage              | A4  |
| Stripping length                       | 8 mm  |
| Number of positions                    | 2   |
| Screw thread                           | M3  |
| Tightening torque, min                 | 0.5 Nm  |
| Tightening torque max                  | 0.6 Nm  |

### Connection data

|  |                      |
|--|----------------------|
| Conductor cross section solid min.   | 0.2 mm <sup>2</sup>  |
| Conductor cross section solid max.   | 6 mm <sup>2</sup>    |
| Conductor cross section flexible min.                                      | 0.2 mm <sup>2</sup>  |
| Conductor cross section flexible max.                                      | 4 mm <sup>2</sup>    |
| Conductor cross section flexible, with ferrule without plastic sleeve min. | 0.25 mm <sup>2</sup> |
| Conductor cross section flexible, with ferrule without plastic sleeve max. | 4 mm <sup>2</sup>    |
| Conductor cross section flexible, with ferrule with plastic sleeve min.    | 0.25 mm <sup>2</sup> |
| Conductor cross section flexible, with ferrule with plastic sleeve max.    | 4 mm <sup>2</sup>    |
| Conductor cross section AWG min.   | 24                   |
| Conductor cross section AWG max.   | 10                   |
| 2 conductors with same cross section, solid min.                           | 0.2 mm <sup>2</sup>  |

## PCB terminal block - MKDS 5/ 2-9,5 - 1714971

### Technical data

#### Connection data

|   |                      |
|---|----------------------|
| 2 conductors with same cross section, solid max.  | 1.5 mm <sup>2</sup>  |
| 2 conductors with same cross section, stranded min.                                     | 0.2 mm <sup>2</sup>  |
| 2 conductors with same cross section, stranded max.                                     | 1.5 mm <sup>2</sup>  |
| 2 conductors with same cross section, stranded, ferrules without plastic sleeve, min.   | 0.25 mm <sup>2</sup> |
| 2 conductors with same cross section, stranded, ferrules without plastic sleeve, max.   | 0.75 mm <sup>2</sup> |
| 2 conductors with same cross section, stranded, TWIN ferrules with plastic sleeve, min. | 0.5 mm <sup>2</sup>  |
| 2 conductors with same cross section, stranded, TWIN ferrules with plastic sleeve, max. | 2.5 mm <sup>2</sup>  |

#### Standards and Regulations

|  |        |
|--|--------|
| Connection in acc. with standard       | EN-VDE |
|  | CSA    |
| Flammability rating according to UL 94 | V0     |

### Classifications

#### eCl@ss

|            |          |
|------------|----------|
| eCl@ss 4.0 | 27141109 |
| eCl@ss 4.1 | 27141109 |
| eCl@ss 5.0 | 27141190 |
| eCl@ss 5.1 | 27141190 |
| eCl@ss 6.0 | 27261101 |
| eCl@ss 7.0 | 27440401 |
| eCl@ss 8.0 | 27440401 |
| eCl@ss 9.0 | 27440401 |

#### ETIM

|          |          |
|----------|----------|
| ETIM 3.0 | EC001121 |
| ETIM 4.0 | EC002643 |
| ETIM 5.0 | EC002643 |

#### UNSPSC

|               |          |
|---------------|----------|
| UNSPSC 6.01   | 30211801 |
| UNSPSC 7.0901 | 39121432 |
| UNSPSC 11     | 39121432 |
| UNSPSC 12.01  | 39121432 |
| UNSPSC 13.2   | 39121432 |

# PCB terminal block - MKDS 5/ 2-9,5 - 1714971

## Approvals

### Approvals

#### Approvals

CSA / SEV / GL / RS / CCA / EAC / EAC / cULus Recognized

#### Ex Approvals

#### Approvals submitted

### Approval details

|  |       |       |
|--|-------|-------|
| CSA  |       |       |
|  | B     | C     |
| mm <sup>2</sup> /AWG/kcmil   | 28-10 | 28-10 |
| Nominal current IN   | 30 A  | 30 A  |
| Nominal voltage UN   | 300 V | 300 V |

|                            |       |
|----------------------------|-------|
| SEV                        |       |
| mm <sup>2</sup> /AWG/kcmil | 6     |
| Nominal voltage UN         | 690 V |

|    |
|----|
| GL |
|----|

|    |
|----|
| RS |
|----|

|                            |       |
|----------------------------|-------|
| CCA                        |       |
| mm <sup>2</sup> /AWG/kcmil | 6     |
| Nominal voltage UN         | 690 V |

|     |
|-----|
| EAC |
|-----|

# PCB terminal block - MKDS 5/ 2-9,5 - 1714971

## Approvals

|     |
|-----|
| EAC |
|-----|

| cULus Recognized               |       |       |       |
|--------------------------------|-------|-------|-------|
|                                | B     | C     | D     |
| mm <sup>2</sup> /AWG/kcmil     | 30-10 | 30-10 | 30-10 |
| Nominal current I <sub>N</sub> | 30 A  | 30 A  | 5 A   |
| Nominal voltage U <sub>N</sub> | 300 V | 300 V | 600 V |

## Accessories

### Accessories

#### Screwdriver tools

Screwdriver - SZS 0,6X3,5 - 1205053



Actuation tool, for ST terminal blocks, insulated, also suitable for use as a bladed screwdriver, size: 0.6 x 3.5 x 100 mm, 2-component grip, with non-slip grip

## Additional products

PCB terminal block - MKDS 5/ 3-9,5 - 1714984



PCB terminal block, Nominal current: 32 A, Nom. voltage: 1000 V, Pitch: 9.52 mm, Number of positions: 3, Connection method: Screw connection with tension sleeve, Mounting: Wave soldering, Conductor/PCB connection direction: 0 °, Color: green, The article can be aligned to create different nos. of positions!

## Drawings

# PCB terminal block - MKDS 5/ 2-9,5 - 1714971

Drilling diagram

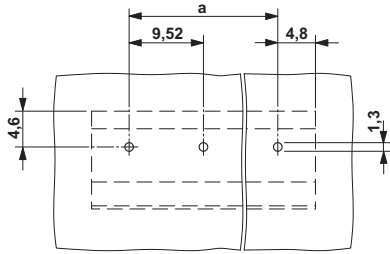

Dimensional drawing

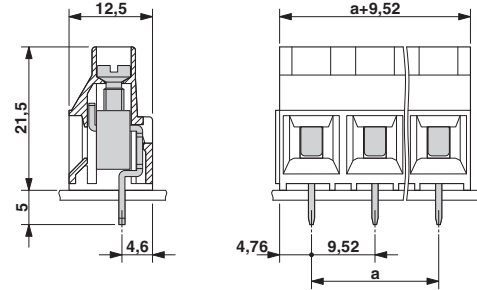

# Mouser Electronics

Authorized Distributor

Click to View Pricing, Inventory, Delivery & Lifecycle Information:

[Phoenix Contact:](#)

[1714971](#)