

LOC	DIST	P	F	ZONE	LTR	DESCRIPTION	DATE	APPD
DF	50				C	REACTIVATE;OH14-0329-05 CT	7-21-05	DE

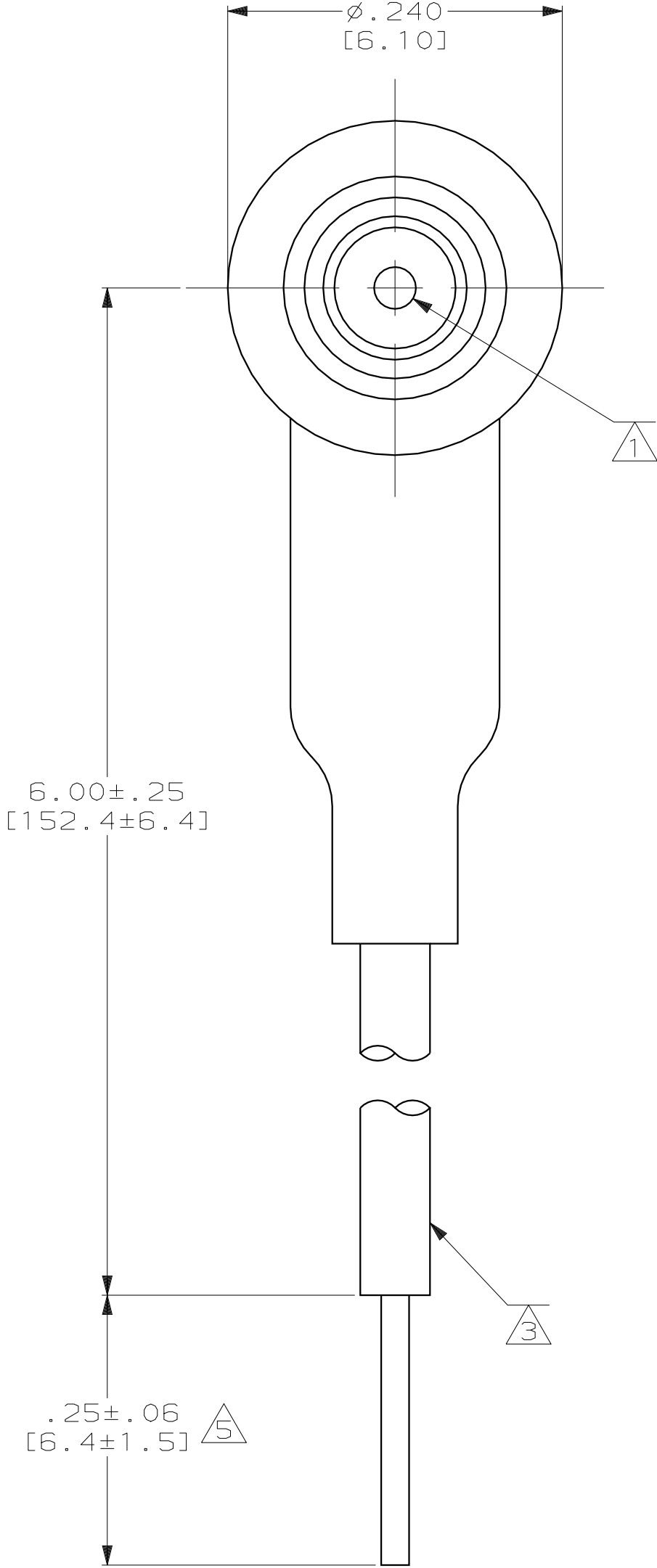
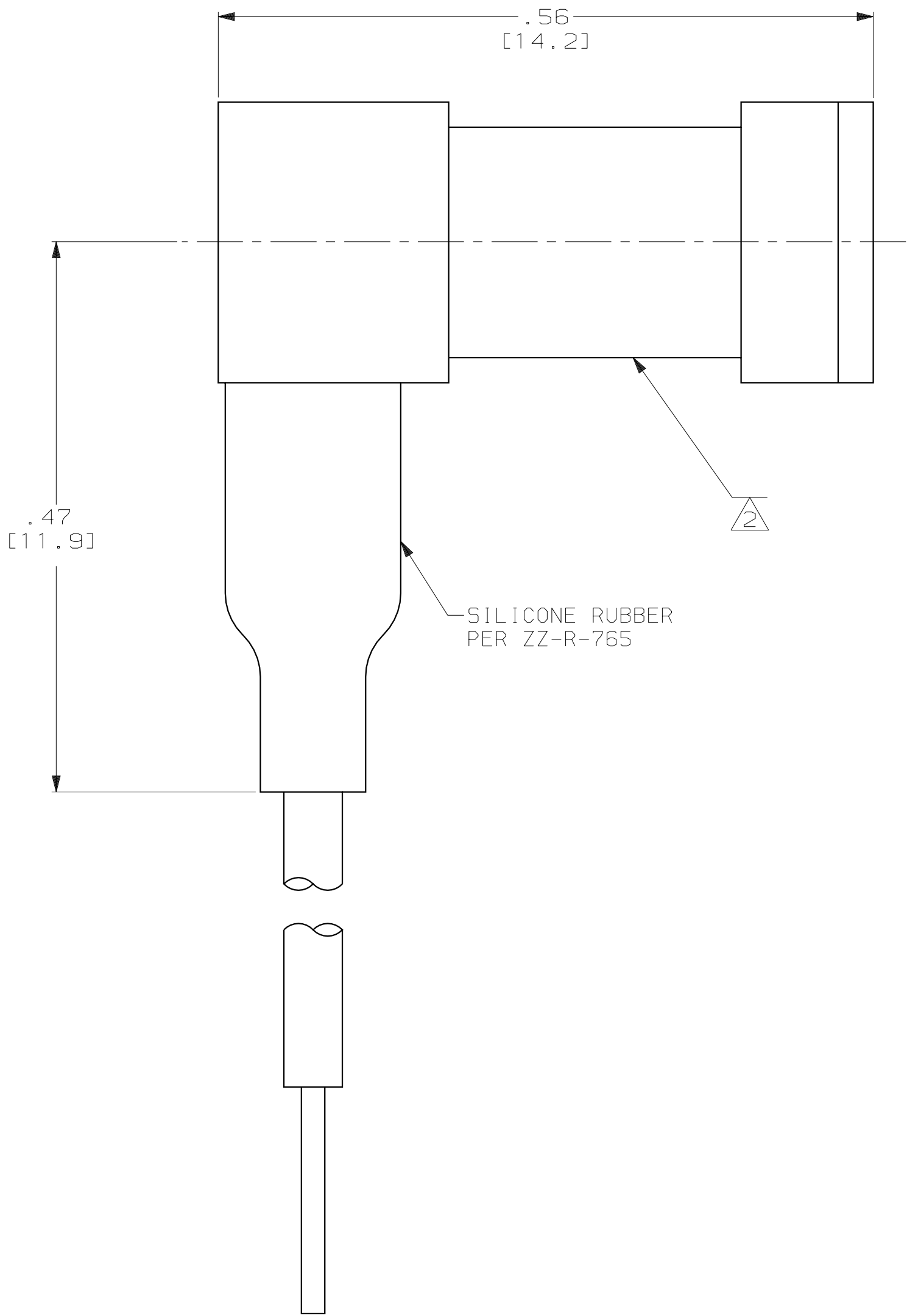

- 1 SIZE 22 PIN CONTACT: .030 [0.76] DIA
MAT'L: BRASS PER QQ-B-626.
- 2 RECEPTACLE HOUSING:
MAT'L: GLASS FILLED POLYETHERIMIDE RESIN.
- 3 CONDUCTOR:
24 (19/36) AWG SILVER PLATED COPPER
INSULATION: SILICONE COATED FEP; $\phi .060 \pm .005$ [1.52 \pm 0.13]
4. OPERATING TEMP: -55°C TO +125°C
TEST VOLTAGE: 18 KVDC AT 70,000 FT. ALTITUDE.
OPERATING VOLTAGE: 12 KVDC AT 70,000 FT ALTITUDE.
- 5 PIGTAIL IS SOLDER DIPPED.

THIS DRAWING IS A CONTROLLED DOCUMENT FOR
AMP INCORPORATED. IT IS SUBJECT TO CHANGE
AND THE CONTROLLING ENGINEERING ORGANIZATION
SHOULD BE CONTACTED FOR THE LATEST REVISION.

DO NOT SCALE PRINT. UNLESS SPECIFIED DIMENSIONS IN INCHES [mm] TOLERANCES ON : 2 PLC DEC ± .02 [0.5] 3 PLC DEC ± .005 [0.13] ANGLES ± -	DR 5-3-93 C.C.THOMAS	<div>AMP</div> <div>AMP Incorporated Harrisburg, PA 17105-3608</div>		
	CHK 1-11-95 D.EABY			
	APPD 1-11-95 D.EABY	NAME RCPT. ASSY,MICRO SUB-MINIATURE, RIGHT ANGLE,LGH		
RLSE 9-3-02 C.C.THOMAS				
PRODUCT SPEC -				
MATERIAL SEE CALLOUTS	APPLICATION SPEC -	SIZE C	CAGE CODE 00779	DRAWING NO C-448659
FINISH SEE CALLOUTS	WEIGHT -	SCALE 10:1	SHEET 1 OF 1	

Mouser Electronics

Authorized Distributor

Click to View Pricing, Inventory, Delivery & Lifecycle Information:

[TE Connectivity:](#)

[448659-1](#)