

THIS DOCUMENT IS THE PROPERTY OF
KEYSTONE ELECTRONICS CORP. AND
SHALL NOT BE REPRODUCED, DISTRIBUTED
OR USED AS A BASIS FOR MANUFACTURE
WITHOUT PRIOR WRITTEN PERMISSION
FROM KEYSTONE ELECTRONICS CORP.

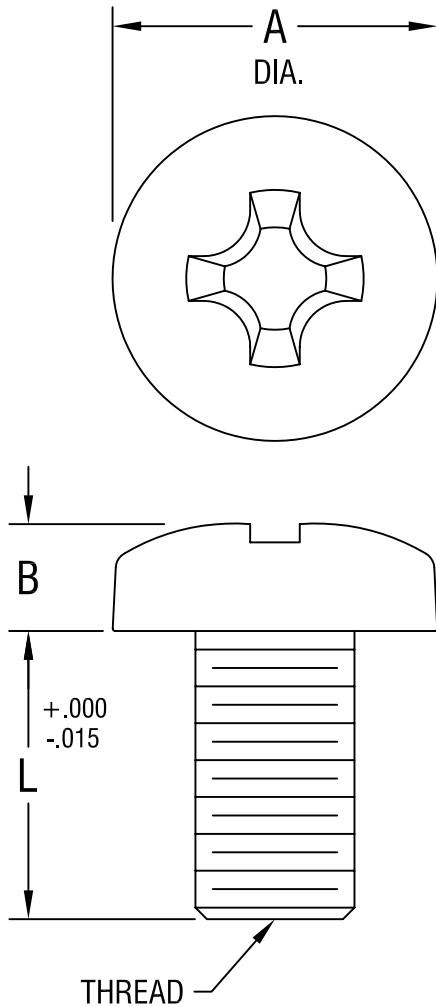

PART NO.	'L' DIM.	THREAD	'A' DIM.	'B' DIM.	DRIVER
9900	1/4 (.250)	4-40	.212	.075	1
9901	3/8 (.375)				
9902	1/2 (.500)				
9903	1/4 (.250)	6-32	.263	.092	2
9904	3/8 (.375)				
9905	1/2 (.500)				
9906	3/8 (.375)	8-32	.314	.110	2
9907	1/2 (.500)				
9908	3/4 (.750)				
9909	3/8 (.375)	10-32	.365	.128	2
9910	1/2 (.500)				
9911	3/4 (.750)				

KEYSTONE ELECTRONICS CORP.

ASTORIA, N.Y. 11105-2017

PART NAME

PHILIPS PAN HEAD SCREW

MATERIAL

STAINLESS STEEL

FINISH

-

DRN BY

BOONE

DATE

4.23.99

APPD

LN

SCALE

6X

TOLERANCES

INCH [MM]

DECIMAL $\pm .010$ [± 0.25]

ANGULAR $\pm 1^\circ$

UNLESS OTHERWISE SPECIFIED

CODE

C/M

DWG NO.

9900-9911

DATE

DESCRIPTION

REV.

Mouser Electronics

Authorized Distributor

Click to View Pricing, Inventory, Delivery & Lifecycle Information:

[Keystone Electronics:](#)

[9907](#)