

## Cable lug - HC-M-MHR-PE16 - 1636981

Please be informed that the data shown in this PDF Document is generated from our Online Catalog. Please find the complete data in the user's documentation. Our General Terms of Use for Downloads are valid (<http://phoenixcontact.com/download>)



Cable lug for HEAVYCON-MODULAR; PE connection extension to 16 mm<sup>2</sup>, for crimping with crimp pliers



### Key Commercial Data

Packing unit	1 pc
Weight per Piece (excluding packing)	5.1 g
Custom tariff number	85369010
Country of origin	Germany

### Technical data

#### General

Material	Nickel-plated brass
Assembly instructions	Crimping with crimping pliers for non-insulated cable connections according to DIN 46230 (crimping area 16 mm <sup>2</sup> ), e.g., Klauke type K25

### Classifications

#### eCl@ss

eCl@ss 4.0	272607xx
eCl@ss 4.1	27260701
eCl@ss 5.0	27143424
eCl@ss 5.1	27143424
eCl@ss 6.0	27143424
eCl@ss 7.0	27440209
eCl@ss 8.0	27400216

# Cable lug - HC-M-MHR-PE16 - 1636981

## Classifications

### ETIM

ETIM 3.0	EC001048
ETIM 4.0	EC001048
ETIM 5.0	EC001048

### UNSPSC

UNSPSC 6.01	30211923
UNSPSC 7.0901	39121522
UNSPSC 11	39121522
UNSPSC 12.01	39121522
UNSPSC 13.2	39121522

## Approvals

### Approvals

---

Approvals

EAC

---

Ex Approvals

---

Approvals submitted

---

### Approval details

EAC
-----

## Drawings

Dimensional drawing

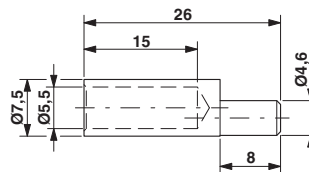



# Mouser Electronics

Authorized Distributor

Click to View Pricing, Inventory, Delivery & Lifecycle Information:

[Phoenix Contact:](#)

[1636981](#)