

DESCRIPTION: HIGH DENSITY MALE - VERTICAL DIP SOLDER

DIMENSIONS

No. OF PINS	A	B	C	D	E	F	G	H
15	1.213	0.984	0.666	0.329	0.090	0.756	0.496	0.429
	30.80	24.99	16.92	8.36	2.29	19.20	12.60	10.90
26	1.541	1.312	0.970	0.329	0.090	1.091	0.496	0.429
	39.15	33.32	24.65	8.36	2.29	27.70	12.60	10.90
44	2.087	1.852	1.512	0.329	0.090	1.618	0.496	0.429
	53.00	47.04	38.40	8.36	2.29	41.10	12.60	10.90
62	2.728	2.500	2.157	0.329	0.095	2.256	0.496	0.429
	69.30	63.50	54.80	8.36	2.41	57.30	12.60	10.90
78	2.638	2.406	2.079	0.436	0.095	2.169	0.606	0.526
	67.00	61.10	52.80	11.07	2.41	55.10	15.40	13.35

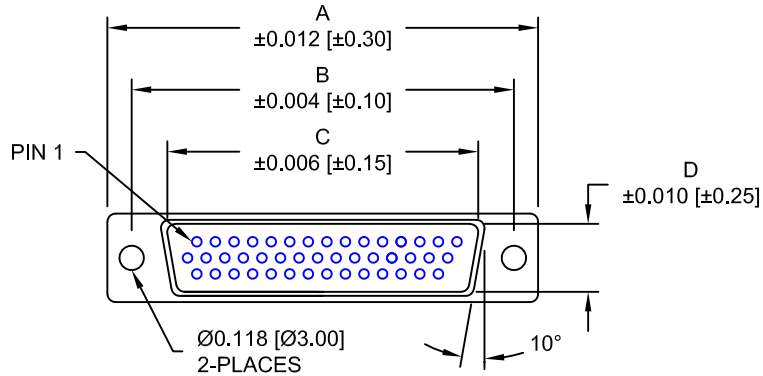

4 ROWS

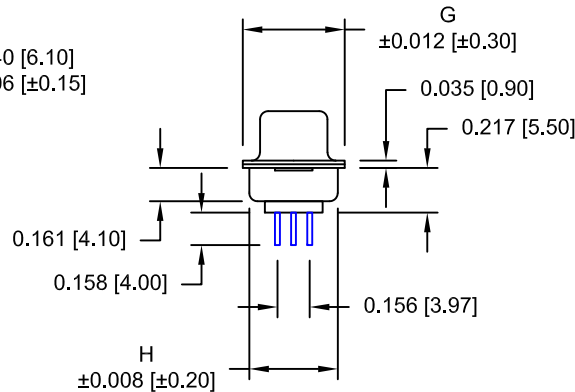
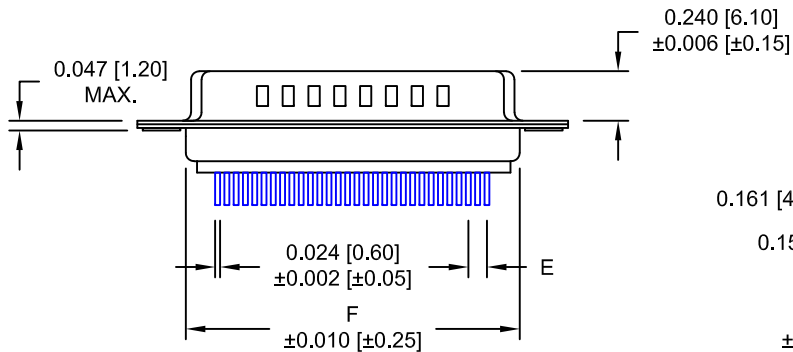

180-YYY-113RYY1

SERIES  
POSITIONS  
015  
026  
044  
062  
078  
GENDER  
1 = MALE  
TERMINATION  
1 = VERTICAL DIP SOLDER  
SHELL PLATING  
3 = NICKEL (GROUND INDENTS)  
RoHS COMPLIANT (260°C)  
HARDWARE OPTIONS  
00 = NO HARDWARE  
01 = .098" CLINCH NUT (BOARD SIDE)  
02 = .236" CLINCH NUT (BOARD SIDE)  
03 = .236" CLINCH NUT (MATING SIDE)  
05 = .237 4-40 BOARD LOCK  
90 = .237 4-40 BOARD LOCK  
FOR 0.093" BOARD MAX.  
91 = .237 4-40 SPACER/BOARD LOCK  
92 = .237 4-40 SPACER/BOARD LOCK  
FOR 0.093" BOARD MAX.  
PLATING OPTIONS  
1 = GOLD FLASH  
A = 30u" GOLD MATING AREA, GOLD  
FLASH OVERALL

MATERIAL:

SHELL: STEEL, NICKEL PLATED  
INSULATOR: PBT, UL 94V-O RATED,  
+30% FIBER-GLASS OR NYLON-66  
CONTACT: BRASS, GOLD PLATED OVER NICKEL

ELECTRICAL:

CURRENT RATING: 3 AMPS  
CONTACT RESISTANCE: 15 mOhms Max.  
INSULATION RESISTANCE: 1,000 MOhms min.  
VOLTAGE: 500VAC FOR 1 MINUTE  
TEMPERATURE: -50° C TO 100° C

DO NOT SCALE FROM DRAWING

RoHS COMPLIANT

	THESE DRAWINGS AND SPECIFICATIONS ARE THE PROPERTY OF NorComp AND SHALL NOT BE REPRODUCED, COPIED OR USED AS THE BASIS FOR THE MANUFACTURE OF SALE OF APPARATUS WITHOUT WRITTEN PERMISSION.	DRAWN: PAM JENKINS	DATE: 09-12-05	
	CHECKED:	DATE:	SCALE: 1 : 1	SHEET 1 OF 3
<h1>NorComp</h1>		DWG NO. 180-YYY-113RYY1		

DESCRIPTION: PCB LAYOUT - VERTICAL - MALE

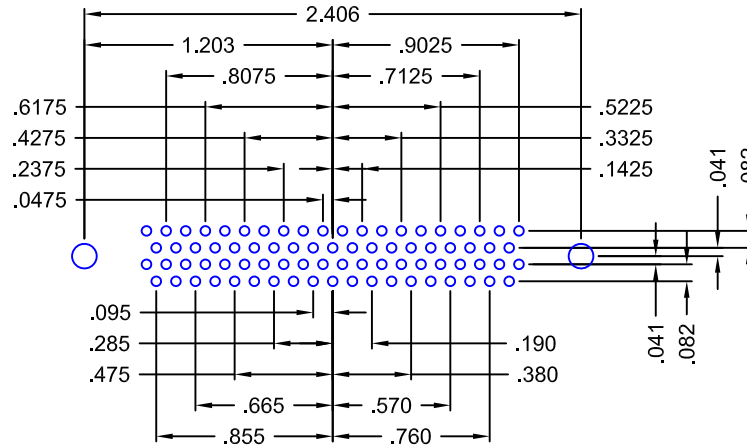
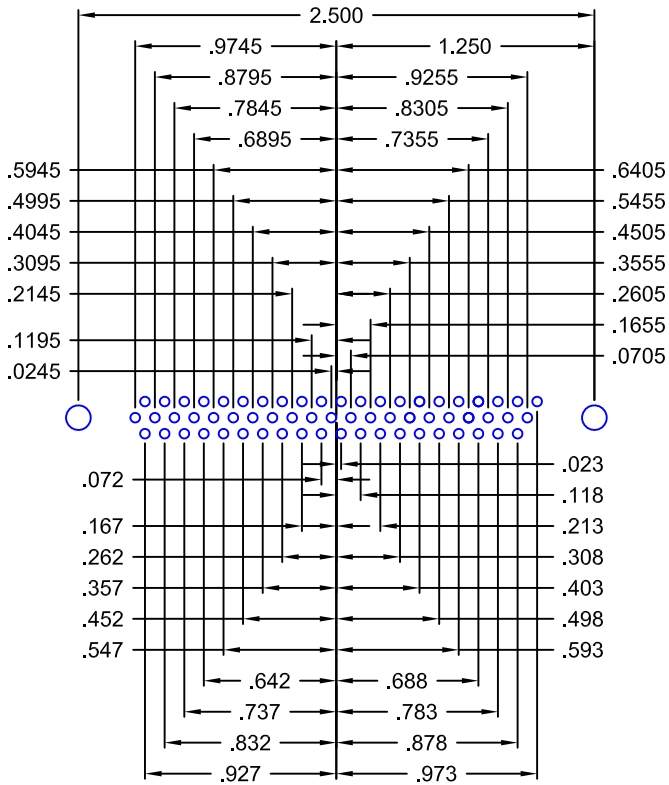
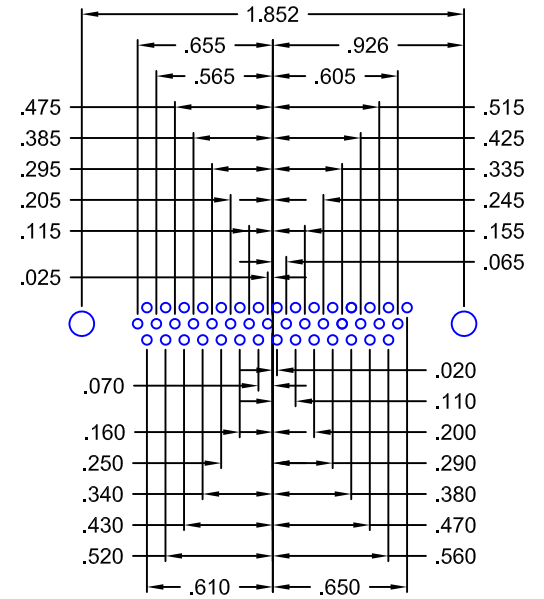
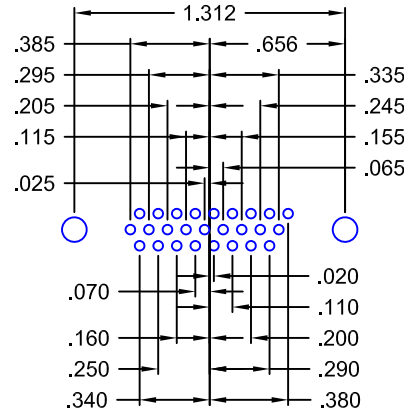
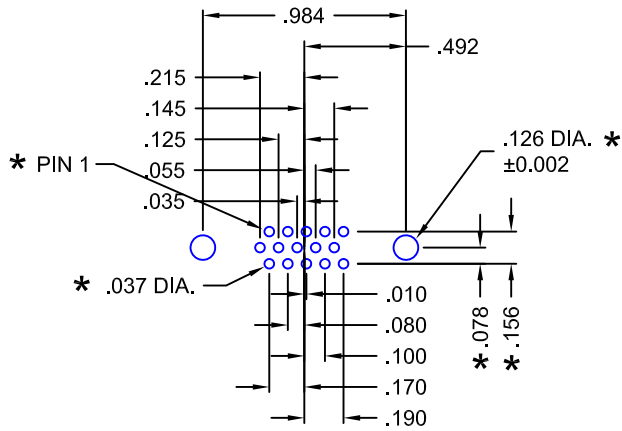

180 SERIES  
HIGH DENSITY  
VERTICAL

HOLE PATTERN SHOWN  
ARE FOR MALE

\* TYP. ON ALL SIZES

DO NOT SCALE FROM DRAWING



THESE DRAWINGS AND SPECIFICATIONS ARE THE PROPERTY OF NorComp AND SHALL NOT BE REPRODUCED, COPIED OR USED AS THE BASIS FOR THE MANUFACTURE OF SALE OF APPARATUS WITHOUT WRITTEN PERMISSION.

NorComp

DRAWN: PAM JENKINS		DATE: 09-12-05	
CHECKED:		DATE:	
SCALE:	SHEET 2	OF 3	REV 15
DWG NO. 180-YYY-113RYY1			

DESCRIPTION: CLINCH NUT HARDWARE

ALL CLINCH-NUTS ARE 4-40 INTERNAL THREADS

TOLERANCE:

ALL DIMENSIONS ARE  $\pm 0.010$

01X ..... 0.098" (BOARD SIDE) - CN1

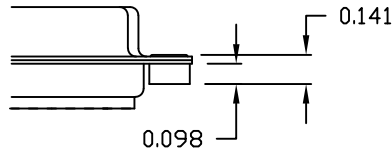

02X ..... 0.236" (BOARD SIDE) - CN2

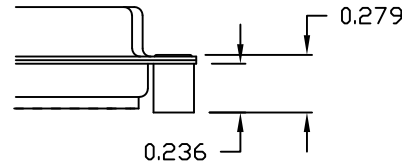

03X..... 0.236" (MATING SIDE) - CN8

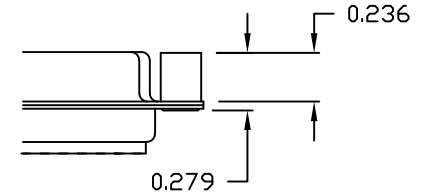

05X ..... 0.237" (BOARD SIDE) - CN10

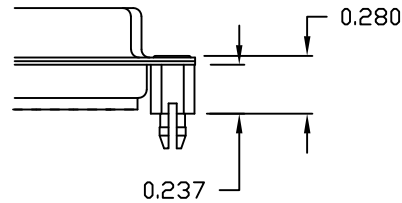

91X ..... 0.237" BOARD SIDE  
0.197 MATING SIDE  
CN10/SFSO4404

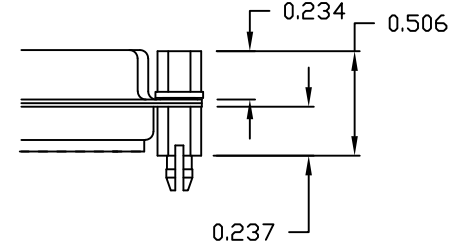

NOTE: 4-40 FEMALE SCREW LOCK IS REMOVABLE

90X ..... 0.237" (BOARD SIDE) - CN10-237-093

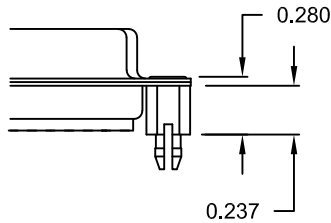

92X ..... 0.237" BOARD SIDE  
0.197 MATING SIDE  
CN10-237-093/SFSO4404

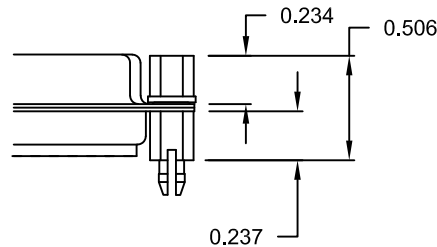

NOTE: 4-40 FEMALE SCREW LOCK IS REMOVABLE

NOTE: 90 & 92 OPTION FOR 0.093" MAX. BOARD THICKNESS

DO NOT SCALE FROM DRAWING

RoHS COMPLIANT



THESE DRAWINGS AND SPECIFICATIONS ARE THE PROPERTY OF NorComp AND SHALL NOT BE REPRODUCED, COPIED OR USED AS THE BASIS FOR THE MANUFACTURE OF SALE OF APPARATUS WITHOUT WRITTEN PERMISSION.

NorComp

DRAWN: WAYNE ROBBINS		DATE: 11-28-05	
CHECKED:		DATE:	
SCALE:	SHEET 3	OF 3	REV 15
DWG NO. 180-YYY-113RYY1			

# Mouser Electronics

Authorized Distributor

Click to View Pricing, Inventory, Delivery & Lifecycle Information:

## NorComp:

[180-015-113R011](#) [180-015-113R021](#) [180-015-113R031](#) [180-015-113R911](#) [180-026-113R011](#) [180-026-113R021](#)  
[180-026-113R031](#) [180-026-113R911](#) [180-044-113R011](#) [180-044-113R021](#) [180-044-113R031](#) [180-044-113R911](#)  
[180-062-113R011](#) [180-062-113R021](#) [180-062-113R031](#) [180-062-113R911](#) [180-078-113R011](#) [180-078-113R021](#)  
[180-078-113R031](#) [180-078-113R911](#) [180-026-113R001](#) [180-062-113R001](#) [180-015-113R001](#) [180-044-113R001](#)  
[180-078-113R001](#) [180-078-113R051](#)