

**MARKETING SALES DRAWING**

**DIMENSIONS IN INCHES - DO NOT SCALE THIS DRAWING**  
**DIMENSIONS IN METRIC - [ ]**

Electrical Testing  
 per Tusonix standard  
 test plans and Mil-Std-202  
 Test Methods.

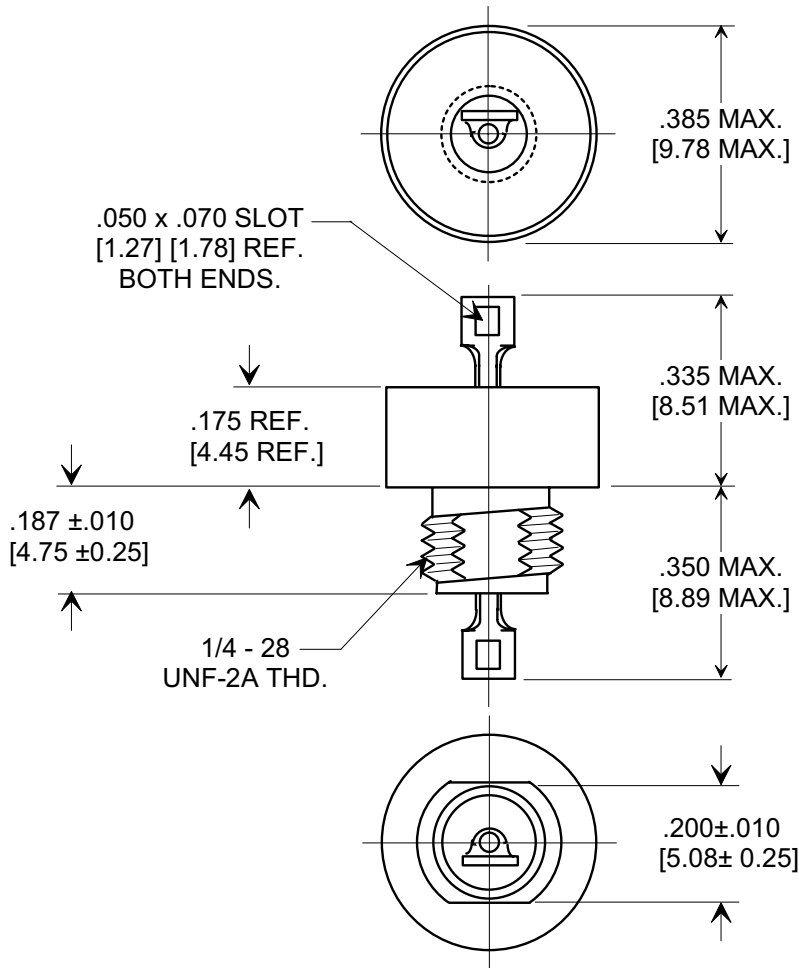
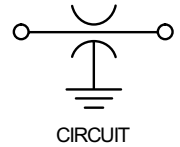
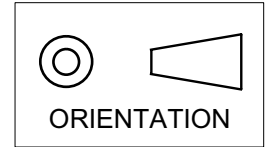

MOUNTING HARDWARE

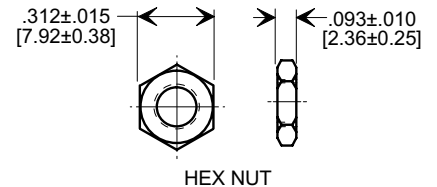
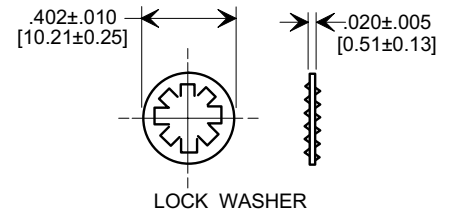

NOTES:

- MATERIALS:  
 BUSHING - TIN PLATED STEEL  
 LEAD - SOLDER PLATED COPPER  
 NUT - TIN PLATED BRASS  
 L'WASHER - TIN PLATED PHOSPHOR BRONZE
- MOUNTING TORQUE: 8 lb - ins. max  
 SEAL TESTED PER MIL-STD-202  
 METHOD 112 CONDITION A.
- DCR - .01Ω max.
- MAX. SOLDER TEMPERATURE 500°F

MIN. CAP. (μF)	WORKING VOLTAGE DC		CURRENT	IR (MIN.) @ 100 VDC	DWW	MINIMUM NO LOAD INSERTION LOSS (dB) AT 25°C PER MIL-STD-220					
	+85°C	+125°C				30 KHz	100 KHz	300 KHz	1 MHz	10 MHz	1 GHz
1.4	100	70	15 A	500 M Ω	300 VDC	15	25	34	44	60	70

X-2015 Rev-0 <b>REVISION RECORD</b> Original Release C.O. <b>6769</b> METRIC DIM'S & NOTES ADDED. E.C. 7-17-92 <b>6789</b> WVDC REVISED 100 & 70 WERE 80 & 50. L.E. 10-26-92 <b>6992</b> RDN TO COMP FMP. STYLE DWG SPLIT FOR EACH VAR. S.M. 06-19-02 <b>20020604-3-07</b> NOTE 1 LEAD WAS SILVER. S.M. 02-02-04 <b>20040202-2-01</b>	<b>0</b>	--TOLERANCES-- Unless Otherwise Specified DECIMAL ± // // // ANGLES ± // // // <b>TUSONIX</b> TUCSON, ARIZONA	Title " <b>C</b> " TYPE COAXIAL <b>BROADBAND FILTER -</b> <b>HERMETICALLY SEALED</b>			
	<b>1</b>		Drawn <b>S.M. 06-19-02</b>	Scale <b>X 3</b>		
	<b>2</b>		Approved <b>J.Mc 06-19-02</b>			
	<b>3</b>		<b>A</b>		<b>4601-000</b>	
	<b>4</b>					

# Mouser Electronics

Authorized Distributor

Click to View Pricing, Inventory, Delivery & Lifecycle Information:

[Tusonix / CTS:](#)

[4601-000LF](#)