

TABLE 1		
GROUP NO	CABLE ACCOMMODATED	ASSEMBLE PER
-301	GC875GCI, GRUMMAN	TAI-229
-302	GC875GBI, GRUMMAN	
-303	7528A5314, RAYCHEM	
-304	-----	
-305	MI7/177-00001	
-306	MI7/134-00001 TRCH-50-2	
-307	TRC-75-1	
-308	TRC-75-2	
-309	TRC-50-1	

TABLE 2		
MODEL NO	PART NO	DESCRIPTION
PL74MC	3-0309-1	2 LUG TRB
PL75MC	3-0309-2	3 LUG TRB

TABLE 3				
POLARIZATION CHART (PL75MC)				
KEY LETTER	A°	B°	C°	COLOR BAND
NONE	120°	120°	120°	NONE
T	100°	150°	110°	RED
U	120°	130°	110°	ORANGE
V	115°	130°	115°	YELLOW
W	125°	110°	125°	GREEN
X	130°	100°	130°	BLUE
Y	110°	140°	110°	VIOLET
Z	100°	160°	100°	GRAY
S	135°	135°	90°	WHITE

3. EXAMPLE OF COMPLETE MODEL NUMBER:

PL75MC T - 306

BASIC MODEL NO.
(SEE TABLE 2)

CABLE GROUP
DASH NO.
(SEE TABLE 1)

POLARIZATION LETTER,
PL75MC ONLY, NOT REQ
FOR STD (SEE TABLE 3)

2. FINISH: TFS-1A (NICKEL)

1. CONCENTRIC TRIAX 2 OR 3 LUG TRB TYPE MILITARY FULL CRIMP CABLE PLUG

NOTES: UNLESS OTHERWISE SPECIFIED.

DATA CONTAINED IN THIS DOCUMENT IS
PROPRIETARY TO TROMPETER-ELECTRONICS INC.
AND SHALL NOT BE DISCLOSED, COPIED OR USED
FOR PROCUREMENT OR MANUFACTURE WITHOUT
EXPRESS WRITTEN PERMISSION.

REVISIONS

REV	DESCRIPTIONS	DATE	APPROVED
B	REVISED PER ECO #16477	10/16/07	NAME

RED INDICATES ORIGINAL

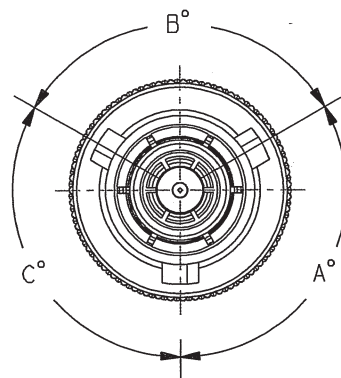

COLOR BAND

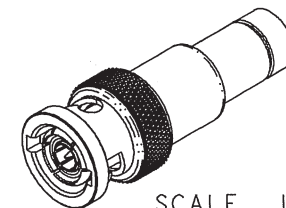

SCALE 1/1

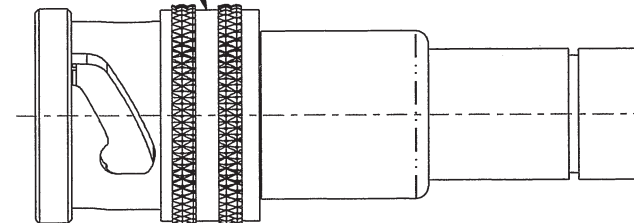

PL75MC SHOWN

Ø.593 MAX

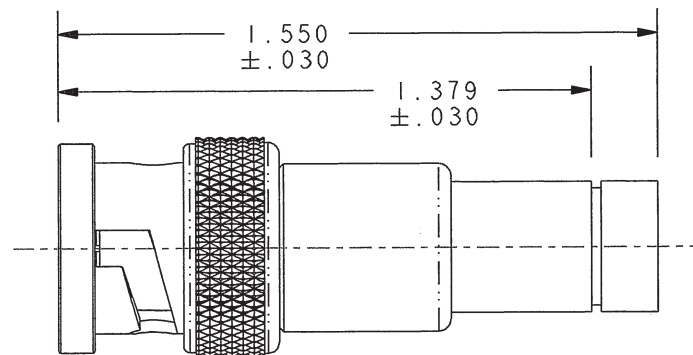
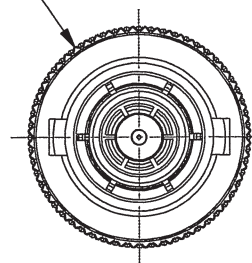

PL74MC SHOWN

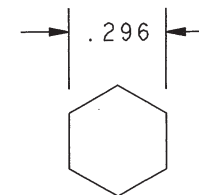

RECOMMENDED
HEX CRIMP

INTERPRET DRAWING PER MIL-STD-100. DIMENSIONS ARE IN INCHES AND INCLUDE FINISH THICKNESS UNLESS OTHERWISE SPECIFIED.		TOL: UNLESS SPECIFIED. .XX ± .02 .XXX ± .010 ANGLE ± 1°		TROMPETER RF connectivity <small>a cinch connectivity solutions brand</small>	
DRN CJJ CHK 9L QUNLITY MANUF APPROVED LM	9-27-07 10-12-07 10/12/07	MATERIAL: FINISH:	TITLE: PL74MC/PL75MC		
SIZE A		CAGE CODE 14949	DRAWING NO. 3-0309	REV. B	SHEET IC
SCALE 2/1		DATE 3-13-00			

NEXT ASSY

PROJ FILE NO.
3-0309

DO NOT SCALE DWG

Mouser Electronics

Authorized Distributor

Click to View Pricing, Inventory, Delivery & Lifecycle Information:

[Cinch Connectivity Solutions:](#)

[PL74MC-306](#)