

DESCRIPTION: MALE - SOLDER CUP / MACHINED - ECONOMY

WILL ACCEPT 26-20 AWG WIRE

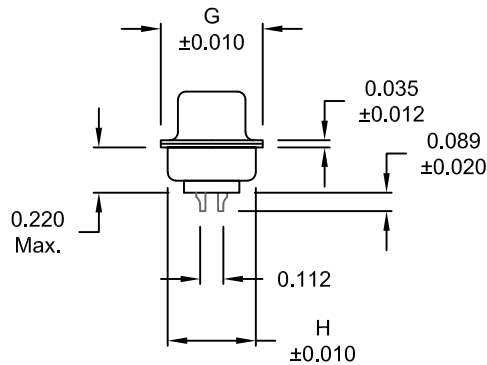
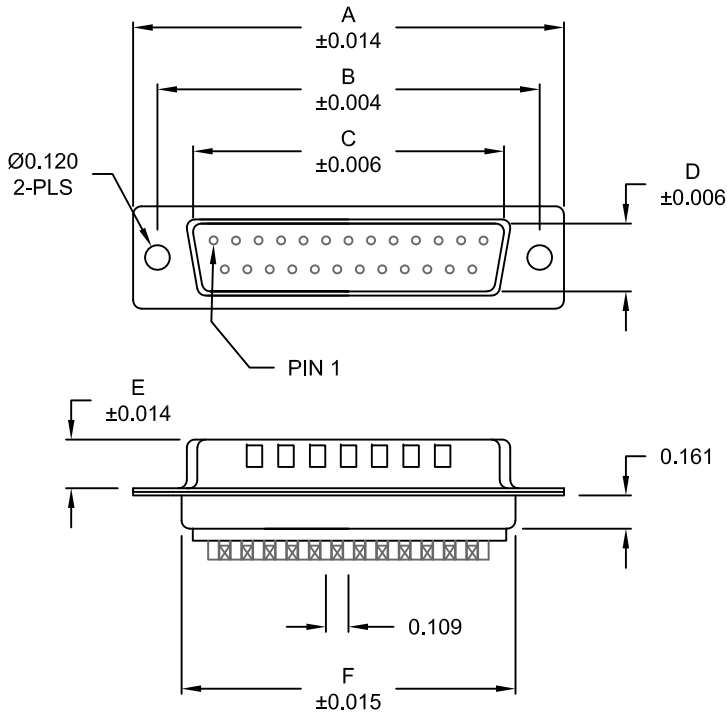

No. OF PINS	DIMENSIONS							
	A	B	C	D	E	F	G	H
9	1.213	0.984	0.666	0.329	0.236	0.756	0.496	0.427
	30.80	24.99	16.92	8.36	5.99	19.20	12.60	10.85
15	1.541	1.312	0.994	0.329	0.236	1.091	0.496	0.427
	39.15	33.32	25.25	8.36	5.99	27.70	12.60	10.85
25	2.087	1.852	1.534	0.329	0.236	1.618	0.496	0.427
	53.00	47.04	38.96	8.36	5.99	41.10	12.60	10.85
37	2.728	2.500	2.182	0.329	0.236	2.256	0.496	0.427
	69.30	63.50	55.42	8.36	5.99	57.30	12.60	10.85
50	2.638	2.406	2.079	0.436	0.240	2.169	0.602	0.527
	67.00	61.11	52.80	11.07	6.10	55.10	15.30	13.39

172-EYY-10YRYY1

- SERIES _____
- POSITIONS _____
- E09
 - E15
 - E25
 - E37
 - E50
- GENDER _____
- 1 = MALE
- TERMINATION _____
- 0 = SOLDER CUP
- SHELL PLATING _____
- 2 = TIN (GROUND INDENTS)
 - 3 = NICKEL (GROUND INDENTS)
- RoHS COMPLIANT _____
- HARDWARE OPTIONS _____
- 00 = NO HARDWARE
 - 01 = .098" CLINCH NUT (BOARD SIDE)
 - 02 = .236" CLINCH NUT (BOARD SIDE)
 - 03 = .236" CLINCH NUT (MOUNTING SIDE)
 - 05 = .237" 4-40 BOARD LOCK
 - 91 = .237" 4-40 SPACER/ BOARD LOCK
- PLATING OPTIONS _____
- 1 = GOLD FLASH
 - 2 = 30MICRO-INCH GOLD

MATERIAL:

SHELL: STEEL, NICKEL OR TIN PLATED
 INSULATOR: UL 94V-O RATED PA6T
 PROCESS TEMP.: 260°C
 CONTACT: BRASS

ELECTRICAL:

CURRENT RATING: 5 AMPS
 CONTACT RESISTANCE: 15 mOhms Max.
 INSULATION RESISTANCE: 1,000 MOhms min.
 VOLTAGE: 500VAC FOR 1 MINUTE
 TEMPERATURE: -50° C TO 100° C

DO NOT SCALE FROM DRAWING



THESE DRAWINGS AND SPECIFICATIONS ARE THE PROPERTY OF NorComp AND SHALL NOT BE REPRODUCED, COPIED OR USED AS THE BASIS FOR THE MANUFACTURE OF SALE OF APPARATUS WITHOUT WRITTEN PERMISSION.

DRAWN: PAM JENKINS		DATE: 11-28-05	
SCALE: NTS	SHEET 1	OF 2	REV 11
DWG NO. 172-EYY-10YRYY1			

RoHS COMPLIANT

NorComp

DESCRIPTION: CLINCH NUT HARDWARE

TOLERANCE:
ALL DIMENSIONS ARE ± 0.010

ALL CLINCH-NUTS ARE 4-40 INTERNAL THREADS

01X 0.098" (BOARD SIDE) - CN1

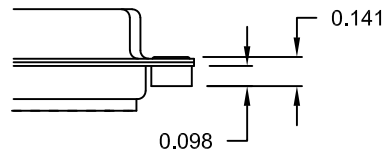

02X 0.236" (BOARD SIDE) - CN2

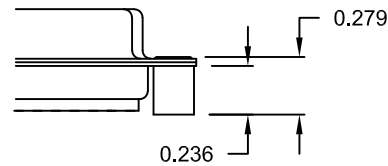

03X..... 0.236" (MATING SIDE) - CN8

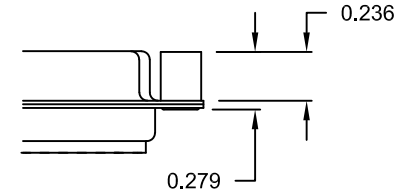

05X 0.237" (BOARD SIDE) - CN10

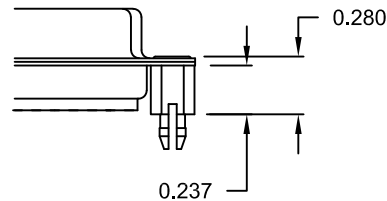

91X 0.237" BOARD SIDE
0.197" MATING SIDE
CN10/SFSO4404

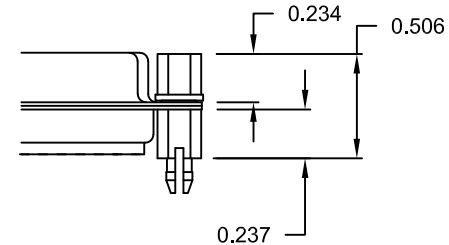

NOTE: 4-40 FEMALE SCREW LOCK IS REMOVABLE

DO NOT SCALE FROM DRAWING

RoHS COMPLIANT



THESE DRAWINGS AND SPECIFICATIONS ARE THE PROPERTY OF NorComp AND SHALL NOT BE REPRODUCED, COPIED OR USED AS THE BASIS FOR THE MANUFACTURE OF SALE OF APPARATUS WITHOUT WRITTEN PERMISSION.

DRAWN: PAM JENKINS		DATE: 11-28-05	
SCALE: NTS	SHEET 2	OF 2	REV 11
DWG NO. 172-EYY-10YRY1			

NorComp

Mouser Electronics

Authorized Distributor

Click to View Pricing, Inventory, Delivery & Lifecycle Information:

NorComp:

<u>172-E50-103R021</u>	<u>172-E50-103R011</u>	<u>172-E50-103R031</u>	<u>172-E25-103R021</u>	<u>172-E25-103R011</u>	<u>172-E25-103R031</u>
<u>172-E15-103R031</u>	<u>172-E15-103R011</u>	<u>172-E15-103R021</u>	<u>172-E25-103R911</u>	<u>172-E37-103R911</u>	<u>172-E50-103R911</u>
<u>172-E09-103R011</u>	<u>172-E09-103R031</u>	<u>172-E09-103R021</u>	<u>172-E37-103R021</u>	<u>172-E37-103R011</u>	<u>172-E37-103R031</u>
<u>172-E50-203R001</u>	<u>172-E50-103R001</u>	<u>172-E25-203R001</u>	<u>172-E25-103R001</u>	<u>172-E15-103R001</u>	<u>172-E15-203R001</u>
<u>172-E09-103R001</u>	<u>172-E37-203R001</u>	<u>172-E37-103R001</u>	<u>172-E09-103R911</u>	<u>172-E09-102R001</u>	<u>172-E09-102R011</u>
<u>172-E09-102R021</u>	<u>172-E09-102R031</u>	<u>172-E09-202R001</u>	<u>172-E15-102R001</u>	<u>172-E15-102R011</u>	<u>172-E15-102R021</u>
<u>172-E15-102R031</u>	<u>172-E15-202R001</u>	<u>172-E25-102R001</u>	<u>172-E25-102R011</u>	<u>172-E25-102R021</u>	<u>172-E25-102R031</u>
<u>172-E25-202R001</u>	<u>172-E37-102R001</u>	<u>172-E37-102R011</u>	<u>172-E37-102R021</u>	<u>172-E37-102R031</u>	<u>172-E37-202R001</u>
<u>172-E50-102R001</u>	<u>172-E50-102R011</u>	<u>172-E50-102R021</u>	<u>172-E50-102R031</u>	<u>172-E50-202R001</u>	