

## Model 1166 & 6357 Kit Alligator Clip To Multi-Stacking Banana Plug Patch Cord

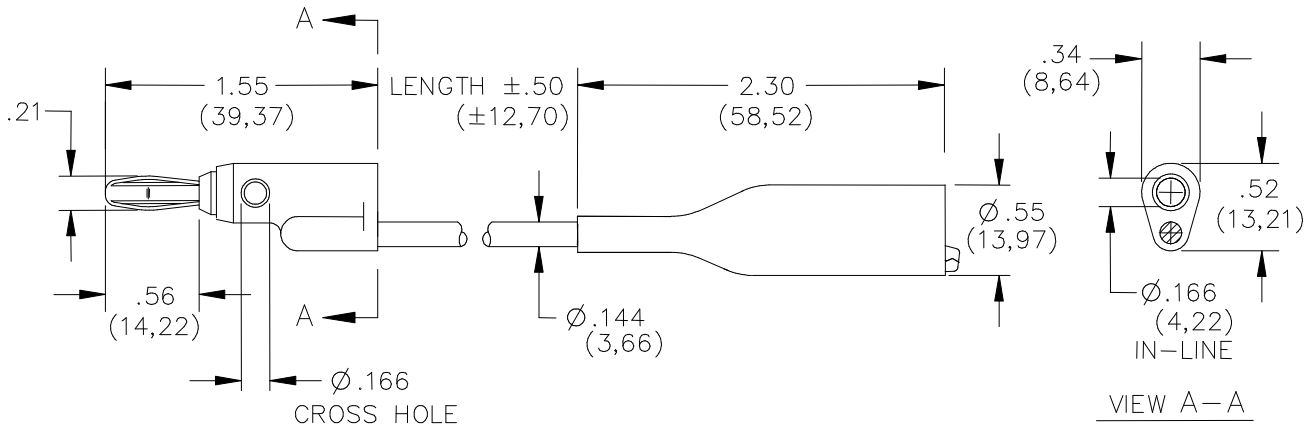

### FEATURES:

- Pomona's Alligator Clip to Stacking Banana Plug Patch Cord offers quick attachment to terminals up to .300" O.D.
- The patch cord features a medium size alligator clip with a flex boot for insulation protection. The banana plug spring is Beryllium Copper for long insertion life.
- The banana plug has vertical and horizontal stacking capability.
- The wire conductor has a high number of strands for excellent wire flexibility.
- The banana plug is molded directly to the wire for added pull strength.

### MATERIALS:

Insulated Alligator:

Body: Steel, Nickel Plated

Insulator Boot: Vinyl, Color matches wire color

Wire: 18 AWG, Stranding 65 x 36 t.c., PVC

Insulated, 0.144" (3.66 mm) O.D.

Marking: Pomona 1166-XX-\*

Body - Brass, Nickel Plated

Color: Referenced by Part Number

Banana Plug:

Spring - Beryllium Copper, Nickel Plated

Insulation: Polypropylene Molded to the Plug Body and Wire. Color Matches Color of Wire.

### RATINGS:

Operating Temperature: +50°C Max.

Operating Voltage: Hand-held testing: 30VAC/ .30 VAC Max.

Hands Free Testing in controlled voltage environments: 150 WVDC

Current: 5 Amperes

**ORDERING INFORMATION:** Model 1166-XX-\*  
XX = Wire Length, Standard Lengths: 12" (30.48cm), 24" (60.96cm), 36" (91.44cm), 48" (121.92cm) & 60" (152.4cm).

Additional lengths and colors can be quoted upon request.

\* = Colors, -0 Black, -2 Red

Ordering Example: 1166-12-2, Patch cord is 12" (30.48cm), color is red.

6357-XX Kit contains 10 patch cords, one each of 10 colors.

All dimensions are in inches. Tolerances (except noted): .xx = ±.02" (.51 mm), .xxx = ±.005" (.127 mm).

All specifications are to the latest revisions. Specifications are subject to change without notice.

Registered trademarks are the property of their respective companies. Made in USA

# Mouser Electronics

Authorized Distributor

Click to View Pricing, Inventory, Delivery & Lifecycle Information:

Pomona:

[1166-24-0](#) [1166-24-2](#) [1166-36-2](#) [1166-36-0](#) [1166-12-0](#) [1166-12-2](#) [1166-60-0](#) [1166-60-2](#) [1166-48-2](#) [1166-48-0](#)