

THIS DOCUMENT IS THE PROPERTY OF  
KEYSTONE ELECTRONICS CORP. AND  
SHALL NOT BE REPRODUCED, DISTRIBUTED  
OR USED AS A BASIS FOR MANUFACTURE  
WITHOUT PRIOR WRITTEN PERMISSION  
FROM KEYSTONE ELECTRONICS CORP.

<b>4-40 THREAD STANDOFF ENGINEERING KIT CAT. NO. STR-440</b>				
HEX. = .250 [6.35]	Threaded Female		Threaded Male/Female	
	Aluminum	Nylon	Aluminum	Nylon
Length	Cat. No.	Cat. No.	Cat. No.	Cat. No.
.250 [6.35]	<b>2201</b>	<b>1902A</b>	<b>8714</b>	<b>4800</b>
.500 [12.70]	<b>2203</b>	<b>1902C</b>	<b>8401</b>	<b>4802</b>
.750 [19.05]	<b>2204</b>	<b>1902D</b>	<b>8403</b>	<b>4804</b>
1.00 [25.40]	<b>2205</b>	<b>1902E</b>	<b>8405</b>	<b>4806</b>
Cat. No. 9900 4-40 x 1/4" Phillips Drive Machine Screw				

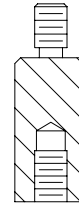
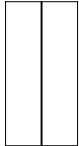

<b>6-32 THREAD STANDOFF ENGINEERING KIT CAT. NO. STR-632</b>				
HEX. = .250 [6.35]	Threaded Female		Threaded Male/Female	
	Aluminum	Nylon	Aluminum	Nylon
Length	Cat. No.	Cat. No.	Cat. No.	Cat. No.
.250 [6.35]	<b>2208</b>	<b>1903A</b>	<b>8717</b>	<b>4814</b>
.500 [12.70]	<b>2210</b>	<b>1903C</b>	<b>8414</b>	<b>4816</b>
.750 [19.05]	<b>2211</b>	<b>1903D</b>	<b>8416</b>	<b>4818</b>
1.00 [25.40]	<b>2212</b>	<b>1903E</b>	<b>8418</b>	<b>4820</b>
Cat. No. 9903 6-32 x 1/4" Phillips Drive Machine Screw				

<b>8-32 THREAD STANDOFF ENGINEERING KIT CAT. NO. STR-832</b>				
HEX. = .250 [6.35]	Threaded Female		Threaded Male/Female	
	Aluminum	Nylon	Aluminum	Nylon
Length	Cat. No.	Cat. No.	Cat. No.	Cat. No.
.375 [9.53]	<b>2216</b>	<b>1904B</b>	<b>8426</b>	<b>4829</b>
.500 [12.70]	<b>2217</b>	<b>1904C</b>	<b>8427</b>	<b>4830</b>
.750 [19.05]	<b>2218</b>	<b>1904D</b>	<b>8429</b>	<b>4832</b>
1.00 [25.40]	<b>2219</b>	<b>1904E</b>	<b>8431</b>	<b>4834</b>
Cat. No. 9906 8-32 x 3/8" Phillips Drive Machine Screw				

**NOTES:**

1. A KIT HAS 25 PIECES OF EACH CAT.NO. FOR A TOTAL QUANTITY OF 425 PIECES AND IS HOUSED IN A 16 TRAY, LABELED ENCLOSURE.
2. MAT'L - ALUMINUM, CLEAR IRIDITE  
MAT'L - NYLON 6/6
3. DRAWS WILL BE ASSEMBLED WITH PLASTIC DIVIDER INSTALLED AND PRODUCT PLACED IN THE FRONT PORTION OF EACH DRAW.
4. SCREWS TO BE PLACED IN THE BACK PORTION OF THE UPPER LEFT MOST DRAW BEHIND THE 1/4" OR 3/8" L. ALUMINUM STANDOFFS.

<b>KEYSTONE ELECTRONICS CORP.</b>			
ASTORIA, N.Y. 11105-2017			
PART NAME .250 HEX. STANDOFF HARDWARE KITS			
MATERIAL AS NOTED			
FINISH AS NOTED		DRN BY BOONE	DATE 11.18.05
		APP'D LN	SCALE -
TOLERANCES INCH [MM] DECIMAL ± [±] ANGULAR ± UNLESS OTHERWISE SPECIFIED		CODE C/M	DWG NO. <b>STR-</b>

DATE	DESCRIPTION	REV.

# Mouser Electronics

Authorized Distributor

Click to View Pricing, Inventory, Delivery & Lifecycle Information:

[Keystone Electronics:](#)

[STR-632](#)