

Surge protection plug - CTM 2X1-180DC-GS - 2838636

Please be informed that the data shown in this PDF Document is generated from our Online Catalog. Please find the complete data in the user's documentation. Our General Terms of Use for Downloads are valid (<http://phoenixcontact.com/download>)



LSA-PLUS protective plug (COMTRAB CTM) with coarse surge protection for 2 signal wires from analog and digital telecommunications interfaces (up to 44 Mbps). Nominal voltage: 180 V DC

Product Features

- The CTM 10-MAG surge protection magazine can be freely fitted with various protective plugs
- Can be used in LSA-PLUS disconnect and control strips or CT-TERMIBLOCK
- Typical installation locations include marshalling distributors
- Space-saving LSA-PLUS connection technology
- Modular compact protection for high-density networks



Key Commercial Data

| | |
|--------------------------------------|----------|
| Packing unit | 1 pc |
| Weight per Piece (excluding packing) | 7.79 g |
| Custom tariff number | 85363010 |
| Country of origin | Germany |

Technical data

Dimensions

| | |
|--------|---------|
| Height | 21 mm |
| Width | 9.5 mm |
| Depth | 53.5 mm |

Ambient conditions

| | |
|---------------------------------|------------------|
| Ambient temperature (operation) | -40 °C ... 85 °C |
| Degree of protection | IP20 |

General

Surge protection plug - CTM 2X1-180DC-GS - 2838636

Technical data

General

| | |
|--|--|
| Housing material | PA |
| Flammability rating according to UL 94 | V0 |
| Color | black |
| Standards for clearances and creepage distances | DIN VDE 0110-1 |
| | IEC 60664-1 |
| Overvoltage category | II |
| Degree of pollution | 2 |
| Mounting type | On CT-TERMIBLOCK and LSA-PLUS disconnect strip |
| Type | LSA-PLUS module |
| Direction of action | Line-Line & Line-Earth Ground |
| Arrester can be tested with CHECKMASTER from software version: | From SW rev. 2.12 |
| Near-end crosstalk attenuation aN between adjacent articles | 70 dB (up to 1 MHz 100 Ω system) |
| | 50 dB (up to 10 MHz 100 Ω system) |
| | 30 dB (up to 100 MHz, 100 Ω system) |
| Transmission speed | 44 MBit/s |

Protective circuit

| | |
|--|----------------|
| IEC test classification | A2 |
| | B1 |
| | B2 |
| | B3 |
| | C1 |
| | C2 |
| | C3 |
| | D1 |
| | D2 |
| VDE requirement class | A2 |
| | B1 |
| | B2 |
| | B3 |
| | C1 |
| | C2 |
| | C3 |
| | D1 |
| | D2 |
| Nominal voltage U_N | 180 V DC |
| Maximum continuous voltage U_C | ± 180 V DC |
| Maximum continuous voltage U_C (wire-ground) | ± 180 V DC |

Surge protection plug - CTM 2X1-180DC-GS - 2838636

Technical data

Protective circuit

| | |
|--|--|
| Nominal current I_N | 1.5 A (25 °C) |
| Operating effective current I_C at U_C | $\leq 2 \mu A$ |
| Residual current I_{PE} | $\leq 2 \mu A$ |
| Nominal discharge current I_n (8/20) μs (Core-Earth) | 5 kA |
| Total surge current (8/20) μs | 10 kA |
| Total surge current (10/350) μs | 2.5 kA |
| Max. discharge current I_{max} (8/20) μs maximum (Core-Earth) | 10 kA (in total) |
| Nominal pulse current I_{an} (10/1000) μs (Core-Earth) | 200 A |
| Impulse discharge current (10/350) μs , peak value I_{imp} | 1 kA |
| Output voltage limitation at 1 kV/ μs (Core-Earth) spike | $\leq 800 V$ |
| Output voltage limitation at 1 kV/ μs (Core-Earth) static | $\leq 800 V$ |
| Residual voltage at I_n (conductor-ground) | $\leq 70 V$ |
| Residual voltage with I_{an} (10/1000) μs (conductor-ground) | $\leq 28 V$ |
| Voltage protection level U_p (core-ground) | $\leq 900 V$ (C2 - 10 kV/5 kA, spike) |
| | $\leq 70 V$ (C2 - 10 kV/5 kA, static) |
| | $\leq 1 kV$ (C3, 7.5 kV/100 A, spike) |
| | $\leq 30 V$ (C3, 7.5 kV/100 A, static) |
| Response time t_A (Core-Earth) | $\leq 100 ns$ |
| Input attenuation a_E , asym. | 0.1 dB ($\leq 10 MHz$) |
| | 0.2 dB ($\leq 60 MHz$) |
| | 0.5 dB ($\leq 100 MHz$) |
| Cut-off frequency f_g (3 dB), asym. (PE) in 100 Ohm system | $> 100 MHz$ |
| Capacity (Core-Earth) | 5 pF ($f=1 MHz / V_R=0 V$) |
| Impulse durability (conductor-ground) | C2 - 4 kV/2 kA |
| | C3 - 100 A |
| | B2 - 4 kV/100 A |
| | D1 - 1 kA |
| Alternating current carrying capacity (conductor-ground) | 5 A - 1 s |

Connection data

| | |
|---------------------|--|
| Connection method | can be plugged into COMTRAB-TERMI BLOCK and LSA-PLUS disconnect and switching strips |
| Connection type IN | COMTRAB plug-in system |
| Connection type OUT | COMTRAB plug-in system |
| Connection method | LSA-PLUS |

Connection, equipotential bonding

| | |
|-------------------|----------------|
| Connection method | Spring contact |
|-------------------|----------------|

Surge protection plug - CTM 2X1-180DC-GS - 2838636

Technical data

Standards and Regulations

| | |
|-----------------------|--------------|
| Standards/regulations | IEC 61643-21 |
|-----------------------|--------------|

Classifications

eCl@ss

| | |
|------------|----------|
| eCl@ss 4.0 | 27140201 |
| eCl@ss 4.1 | 27130801 |
| eCl@ss 5.0 | 27130801 |
| eCl@ss 5.1 | 27130801 |
| eCl@ss 6.0 | 27130807 |
| eCl@ss 7.0 | 27130807 |
| eCl@ss 8.0 | 27130807 |
| eCl@ss 9.0 | 27130807 |

ETIM

| | |
|----------|----------|
| ETIM 2.0 | EC000943 |
| ETIM 3.0 | EC000943 |
| ETIM 4.0 | EC000943 |
| ETIM 5.0 | EC000943 |

UNSPSC

| | |
|---------------|----------|
| UNSPSC 6.01 | 30212010 |
| UNSPSC 7.0901 | 39121610 |
| UNSPSC 11 | 39121610 |
| UNSPSC 12.01 | 39121610 |
| UNSPSC 13.2 | 39121620 |

Approvals

Approvals

Approvals

UL Listed / EAC / EAC

Ex Approvals

Surge protection plug - CTM 2X1-180DC-GS - 2838636

Approvals

Approvals submitted

Approval details

UL Listed 

EAC

EAC

Accessories

Required add-on products

Disconnect strip - CT 10-TL - 2765356



LSA-PLUS disconnect strip to hold the CTM and CT 10 protection modules. Version: 10 double conductors, dimension A: 124 mm.

Grounding rail - CT 1-10-ES - 2765547



Ground rail for CTM protective plug when used in combination with LSA-PLUS disconnect strip. Version: 10 double conductors

Screw termination block - CT-TERMIBLOCK 10 DA - 0441711



Screw termination block with disconnect contacts for accommodating protective plugs CT and CTM. Use in MCR and telecommunications systems. Design: 10 double wires

Surge protection plug - CTM 2X1-180DC-GS - 2838636

Accessories

Magazine - CTM 10-MAG - 2838610



Magazine with a grounding rail to accommodate up to 10 LSA-PLUS protective plugs (COMTRAB CTM), to insert in CT-TERMIBLOCK or LSA-PLUS disconnect strip

Additional products

Mounting clip - CT 10-MB/ 3 - 2765372



Mounting clip, for holding 3 disconnect or ground wire strips. Version: 10 double conductors, dimensions: A 104.5 mm, B 65 mm.

Mounting clip - CT 10-MB/10 - 2765385



Mounting clip, for holding 10 disconnect or ground wire strips. Version: 10 double conductors, dimensions: A 104.5 mm, dimensions B 245.5 mm

Cable feed-through sleeve - CT-KDT - 2765518



Cable bush for assembly troughs, for protection of the lines guided through the laminated frame

Short-circuit connector - CTM EST - 2838649



LSA-PLUS grounding plug (COMTRAB CTM) to short-circuit and ground potentials in CT-TERMIBLOCK... and disconnect strip CT 10...

Surge protection plug - CTM 2X1-180DC-GS - 2838636

Accessories

Shield connection - SSA 3-6 - 2839295



shield fast connections for conductor diameter 3 - 6 mm. Potential connection cable: 200 mm, black

Shield connection - SSA 5-10 - 2839512



Shield fast connection for conductor diameters 5 - 10 mm. Potential connection cable: 200 mm, black

Drawings

Dimensional drawing

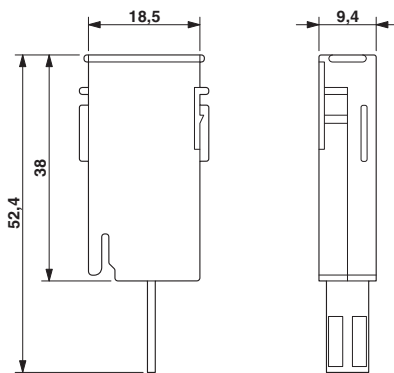

Circuit diagram

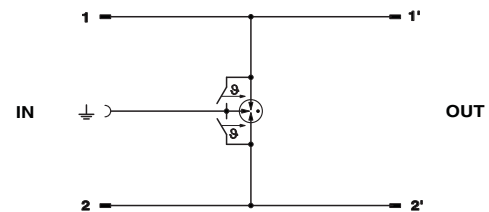

Mouser Electronics

Authorized Distributor

Click to View Pricing, Inventory, Delivery & Lifecycle Information:

Phoenix Contact:

2838636