

CX2024NL

- Balun Transformer, 1:1
- IMPEDANCE = 75 OHMS
- 50-1000MHz
- Surface Mount

NOTES: UNLESS OTHERWISE SPECIFIED

1. OPERATING TEMPERATURE: -40°C TO +85°C
2. STORAGE TEMPERATURE: -50°C TO +125°C
3. JEDEC MOISTURE: LEVEL 1.
4. DIMENSIONS ARE IN INCHES WITH THE FOLLOWING TOLERANCE:
.XX= ±.01
.XXX= ±.005
5. OPTIONAL TAPE & REEL PACKAGING CAN BE ORDERED
BY ADDING A "T" SUFFIX TO THE PART NUMBER(EX: CX2024NLT)
6. ROHS COMPLIANT



ELECTRICAL SPECIFICATIONS: @ 25°C

INSERTION LOSS:

FREQUENCY	ATTENUATION
10 MHz	-1.0 dB MAX
50 MHz	-0.5 dB MAX
150 MHz	-0.5 dB MAX
300 MHz	-0.5 dB MAX
450 MHz	-0.5 dB MAX

FREQUENCY	ATTENUATION
600 MHz	-0.5 dB MAX
750 MHz	-0.5 dB MAX
1000 MHz	-0.6 dB MAX

RETURN LOSS:

FREQUENCY	ATTENUATION
10 MHz	-20.0 dB MIN
50 MHz	-20.0 dB MIN
150 MHz	-20.0 dB MIN
300 MHz	-20.0 dB MIN
450 MHz	-20.0 dB MIN

FREQUENCY	ATTENUATION
600 MHz	-20.0 dB MIN
750 MHz	-20.0 dB MIN
1000 MHz	-16.0 dB MIN

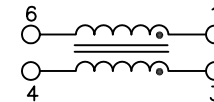

SCHEMATIC

© Copyright, 2014. Pulse Electronics Corp. All rights reserved. Drawing specifications subject to change without notice. (03/13/14)

PULSE CONFIDENTIAL
&
PROPRIETARY

PRODUCT SPECIFICATION:
XFMR, RF, 1:1, 50-1000MHz

DWG. NO./ PART NO.	SHEET:	REV.
CX2024NL	1	M11

MECHANICAL SPECIFICATIONS:

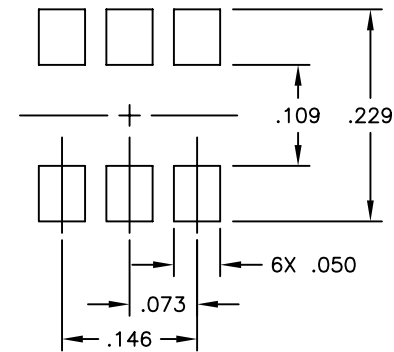
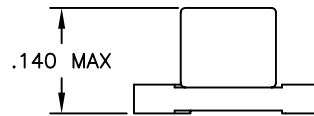
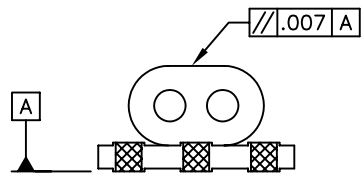
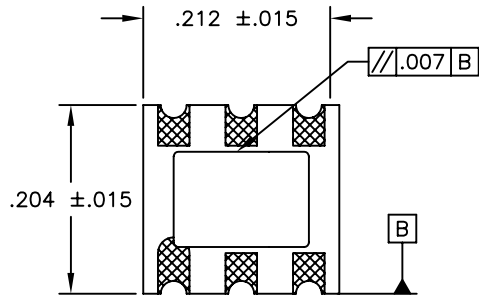

SUGGESTED LAND PATTERN

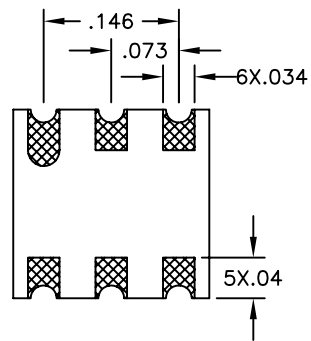

© Copyright, 2014. Pulse Electronics Corp. All rights reserved. Drawing specifications subject to change without notice. (03/13/14)

PULSE CONFIDENTIAL
 &
 PROPRIETARY

PRODUCT SPECIFICATION:
 XFMR, RF, 1:1, 50-1000MHz

DWG. NO./ PART NO.	SHEET:	REV.
CX2024NL	2	M11

Mouser Electronics

Authorized Distributor

Click to View Pricing, Inventory, Delivery & Lifecycle Information:

Pulse:

[CX2024NL](#)