

LOC		DIST		REVISIONS						
ES		00		P	LTR	DESCRIPTION	DATE	DWN	APVD	
					A	DESIGN INITIAL	26SEP2011	ML	SZ	
					A1	ADDED NEW DASH NUMBER -2	30AUG2012	CZ	SZ	
					A2	REV PER ECR-12-015720	06SEP2012	CZ	SZ	

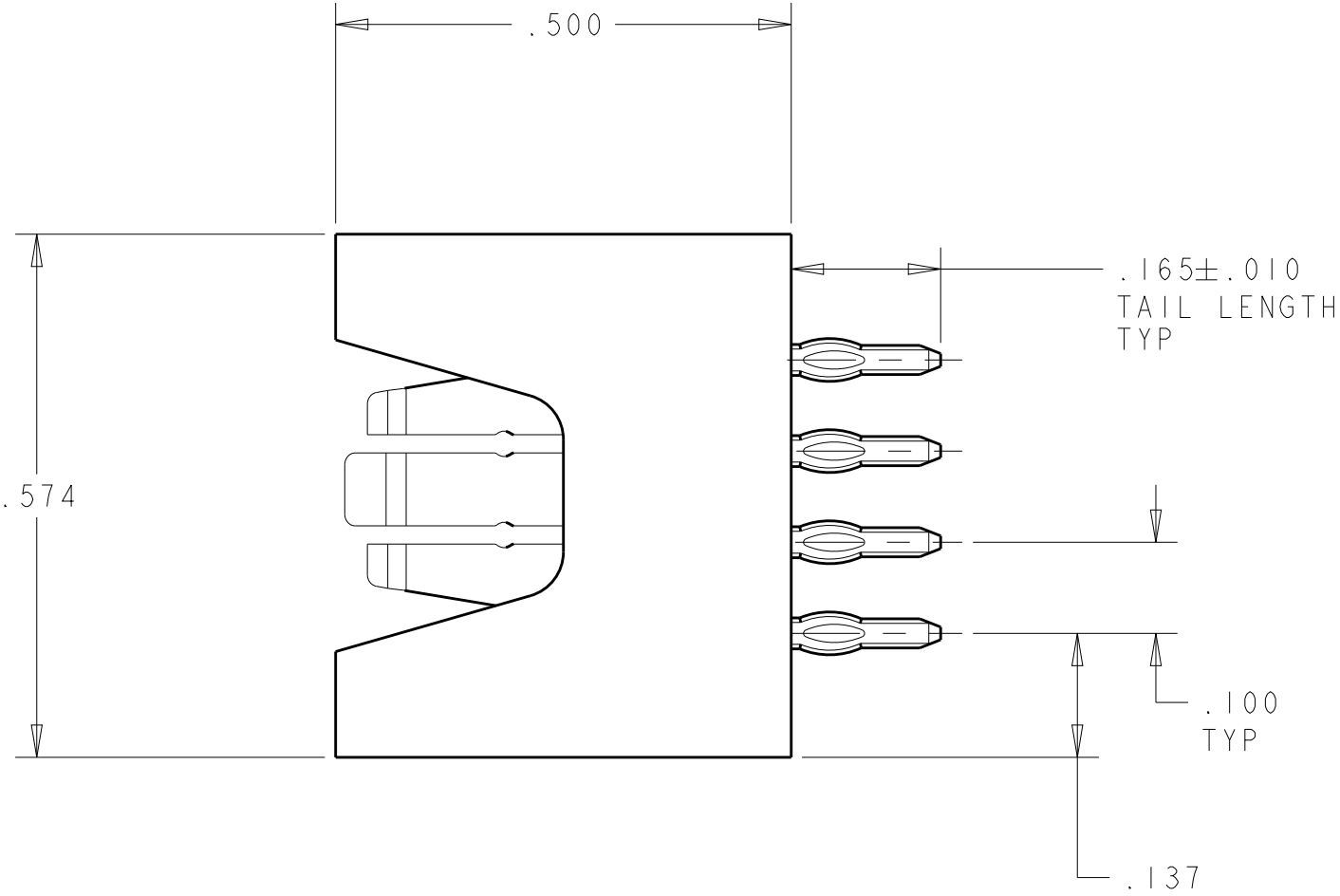
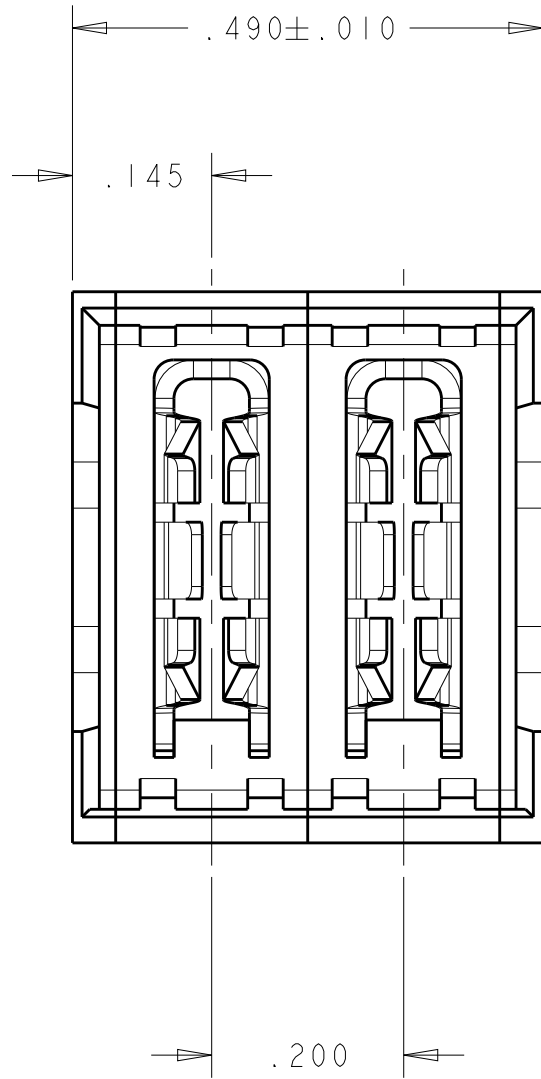
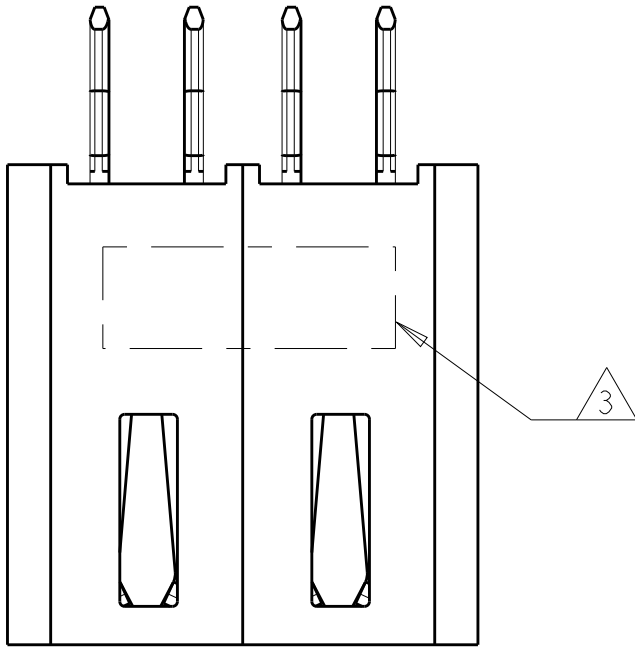
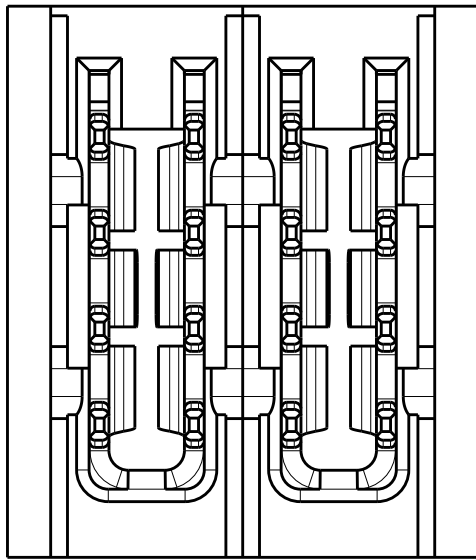

- 1

HEADER HOUSING: THERMO PLASTIC, BLACK, UL94 V-0; CONTACTS AND RETENTION CLIPS: COPPER ALLOY.
- 2

CONTACT FINISHE:
CONFORMS TO THE REQUIREMENTS OF TE CONNECTIVITY PRODUCT SPECIFICATION 108-2292 ON THE MATING INTERFACE, TIN AT PCB INTERFACE
- 3

"AMP", PART NUMBER AND DATE CODE MARKED IN THIS AREA. PARTS UNDER 2.50 LONG MAY BE MARKED ON BOTH SIDES.
- 4

DATUM AND BASIC DIMENSIONS ESTABLISHED BY CUSTOMER.
- 5

PCB - ALL HOLE DIAMETERS ARE FINISHED HOLE SIZES.
- 6

A SEATING TOOL IS REQUIRED TO SEAT THE HEADER ON THE P.C. BOARD. PLEASE REFER TO THE 114-13038 APPLICATION SPEC.
- 7

MECHANICAL CONNECTOR KEEP OUT ZONE.
- 8

FOR CONFRIGURATION LP/S/LP, DIMENSIONS PLEASE SEE PAGE 2.

1.2675	.260	-	.1025	1.370	ILP + 40S + ILP	6450829-2 / 8
-	-	.200	.145	.490	2HDP	6450829-1
DIM R	DIM W	DIM S	DIM K	DIM L	DESCRIPTION	PART NUMBER

THIS DRAWING IS A CONTROLLED DOCUMENT.

DWN
MAC LIU
CHK
S.ZHAO
APVD
S.ZHAO

26SEP2011
26SEP2011
-

DIMENSIONS:
INCHES

TOLERANCES UNLESS OTHERWISE SPECIFIED:
0 PLC ±"
1 PLC ±.01
2 PLC ±.01
3 PLC ±.005
4 PLC ±.0020
ANGLES ±2°
FINISH

PRODUCT SPEC
108-2292
APPLICATION SPEC
114-13251
WEIGHT
-

MATERIAL
:

1

2

CUSTOMER DRAWING

NAME
VERTICAL HEADER W/O END MODULES
PRESS FIT, MULTI-BEAM XLE
-

SIZE
A1

CAGE CODE
00779

DRAWING NO
6450829

RESTRICTED TO
-

SCALE
5:1

SHEET
1

OF
3

REV
A2

LOC	DIST	REVISIONS					
ES	00	P	LTR	DESCRIPTION	DATE	DWN	APVD
		-	-	SEE SHEET 1	-	-	-

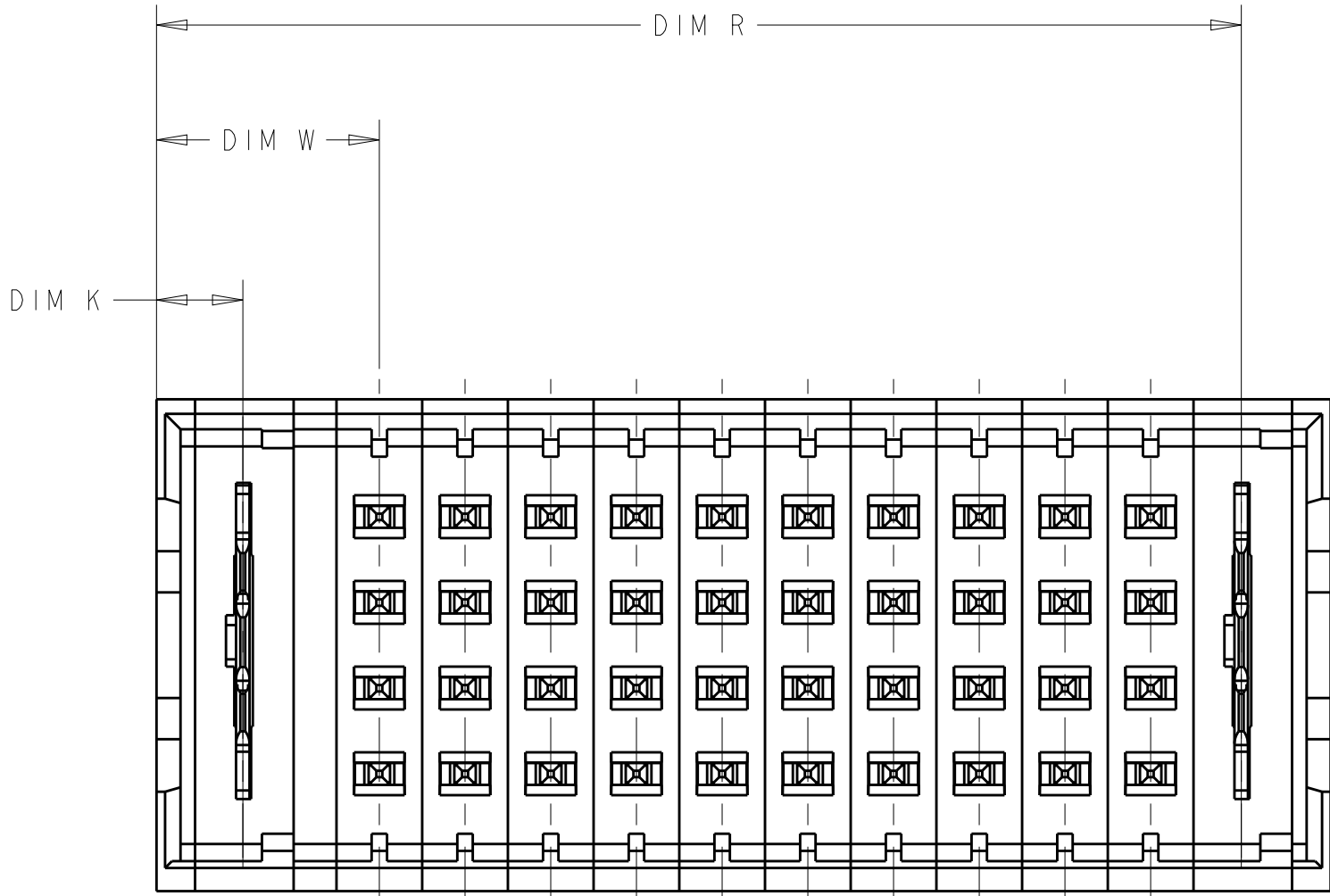
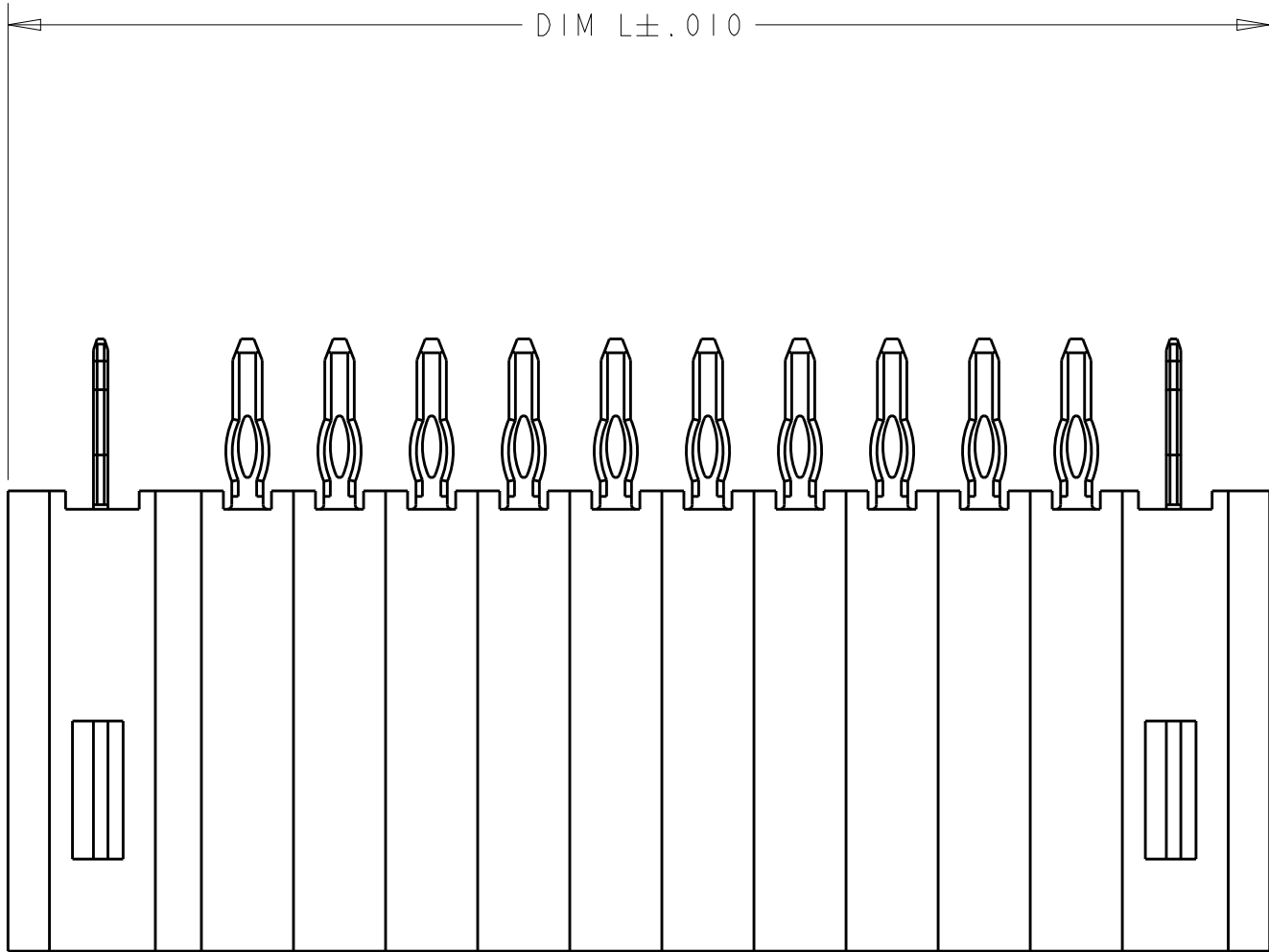

6450829-2 VIEW
FOR CONFIGURATION "LP/S/LP",
OTHER DIMENSIONS PLEASE REFER TO PAGE 1

THIS DRAWING IS A CONTROLLED DOCUMENT.		DWN MAC LIU CHK S. ZHAO APVD S. ZHAO	26SEP2011 26SEP2011 -	TE Connectivity	
DIMENSIONS: INCHES		TOLERANCES UNLESS OTHERWISE SPECIFIED:	PRODUCT SPEC 108-2292 APPLICATION SPEC 114-13251	NAME VERTICAL HEADER W/O END MODULES PRESS FIT, MULTI-BEAM XLE -	
MATERIAL -		0 PLC ±" 1 PLC ±.01 2 PLC ±.01 3 PLC ±.005 4 PLC ±.0020 ANGLES ±2° FINISH -	SIZE A100779 WEIGHT -	RESTRICTED TO -	
CUSTOMER DRAWING		SCALE 5:1	SHEET 2	OF 3	REV A2

PART NUMBER	ROWS	LOW POWER	SIGNAL												LOW POWER
		LP1													LP2
6450829-2	D	LZ	EV	EV	EV	EV	EV	EV	EV	EV	EV	EV	EV	LZ	
	C		EV	EV	EV	EV	EV	EV	EV	EV	EV	EV			
	B		EV	EV	EV	EV	EV	EV	EV	EV	EV	EV			
	A		EV	EV	EV	EV	EV	EV	EV	EV	EV	EV			
ILP + 40S + ILP															

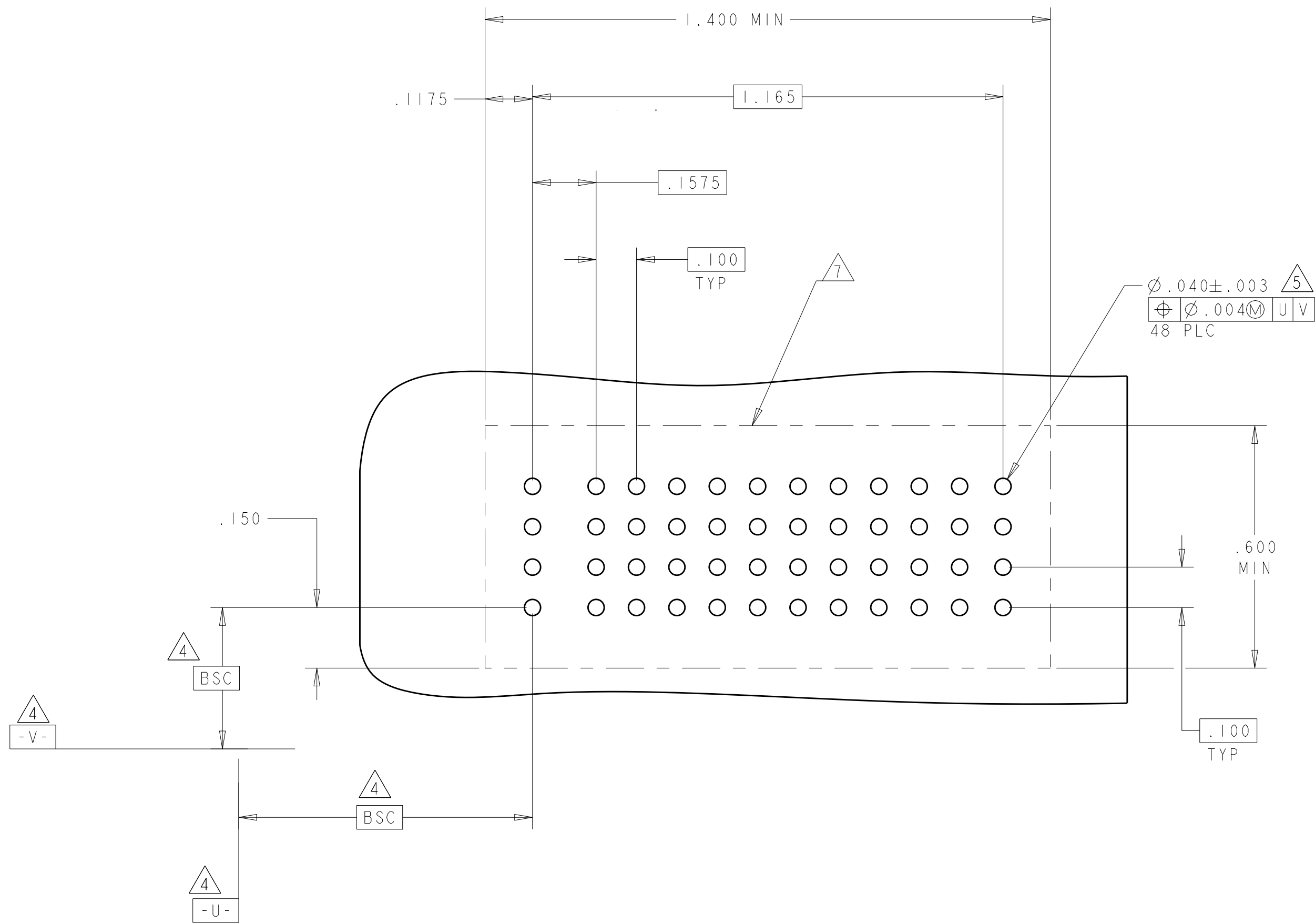

LOW POWER CONTACT	LZ
SIGNAL CONTACT MLBF	ES
SIGNAL CONTACT STD	EV
POWER CONTACT	VM
DESCRIPTION	CODE

4805 (3/11)

Mouser Electronics

Authorized Distributor

Click to View Pricing, Inventory, Delivery & Lifecycle Information:

[TE Connectivity:](#)

[6450829-1](#)