

THIS DRAWING IS UNPUBLISHED. RELEASED FOR PUBLICATION ,19 .

© COPYRIGHT 19 BY AMP INCORPORATED. ALL RIGHTS RESERVED.

| LOC | DIST | REVISIONS | | | |
|-----|------|-------------|--------------------|---------|-------|
| P | LTR | DESCRIPTION | DATE | DWN | APVD |
| G | 14 | H | REV / 0L20-0014-96 | 28OCT96 | ME TM |

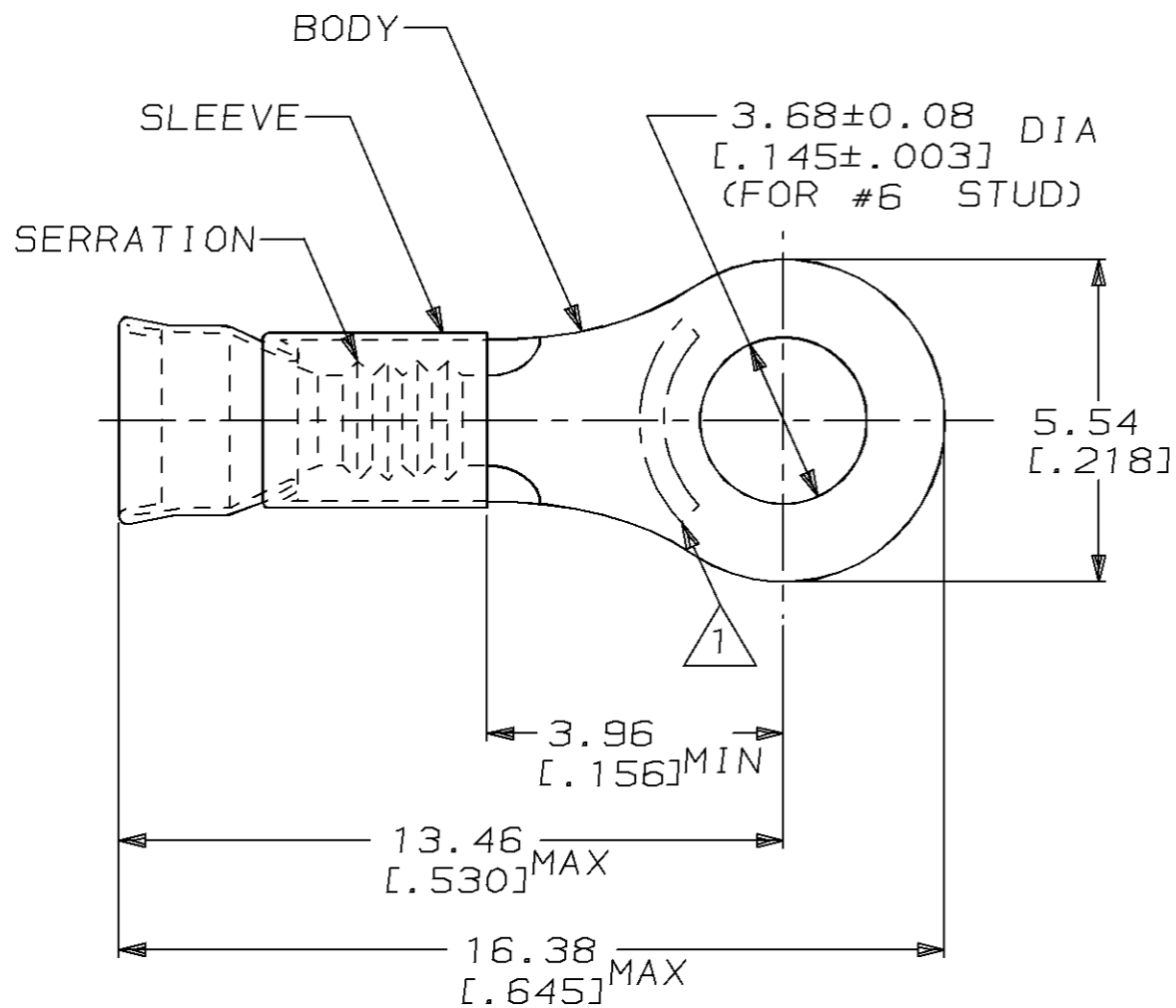

- 1 STAMP AMP 22-18* APPROX AS SHOWN
22-16 TERMINALS ARE STAMPED 22-18 IN ACCORDANCE WITH MILITARY SPEC MIL-T-7928 COMMERCIAL WIRE RANGE IS 22-16
- 2. WIRE INSUL DIA, 1.30-2.79 [.051-.110]
- 3. TONGUE MATL THK, 0.79±0.05 [.031±.002]
- 4 NICKEL PL PER QQ-N-290
- 5 GOLD PL PER MIL-G-45204 OVER NICKEL PL PER QQ-N-290

| 1000 | LOOSE PIECE | △ 323151-1 |
|------|--------------|------------|
| 1000 | LOOSE PIECE | △ 323151 |
| QTY | PACKAGE TYPE | PART NO |

| | | | | | | | | | |
|--|--|---|--|---|--|---|--|---|--|
| AMP INCORPORATED CUSTOMER SERVICE SYSTEM | | MAX RECOMMENDED OPERATING TEMPERATURE: 343°C [650°F] | | THIS DRAWING IS A CONTROLLED DOCUMENT FOR AMP INCORPORATED. IT IS SUBJECT TO CHANGE AND THE CONTROLLING ENGINEERING ORGANIZATION SHOULD BE CONTACTED FOR THE LATEST REVISION. | | DWN L OLMEDA 10OCT94 | | AMP Incorporated | |
| FOR ADDITIONAL PRODUCT INFORMATION OR COPIES OF DRAWINGS AND TECHNICAL DOCUMENTS | | PRODUCT INFORMATION CENTER 1-800-522-6752 | | DIMENSIONS: mm [in] | | TOLERANCES UNLESS OTHERWISE SPECIFIED: | | Harrisburg, PA 17105-3608 | |
| FOR APPLICATION TOOLING INFORMATION | | TOOLING ASSISTANCE CENTER 1-800-722-1111 | | VOLTAGE RATING: - | | 0 PLC ±- 1 PLC ±- 2 PLC ±0.20 [.008] 3 PLC ±- 4 PLC ±- ANGLES ±- | | NAME TERMINAL, RING TONGUE, STRATOTHERM, DIAMOND GRIP, WIRE SIZE, 22-16 AWG | |
| FOR ORDER ENTRY | | 1-800-526-5142 | | CIRCULAR MIL AREA: 0.26mm²-1.65mm² [509-3260] | | MATERIAL BODY, CU PER ASTM B152 SLEEVE, NI SIL PER ASTM B122 | | DRAWING NO C-323151 | |
| | | STRANDED WIRE | | | | FINISH SEE TABLE | | SIZE A3 CAGE CODE 00779 | |
| | | | | | | WEIGHT - | | SCALE 6:1 SHEET 1 OF 1 REV H | |
| | | | | | | CUSTOMER DRAWING | | | |

Mouser Electronics

Authorized Distributor

Click to View Pricing, Inventory, Delivery & Lifecycle Information:

[TE Connectivity:](#)

[323151](#)