

THIS DRAWING IS UNPUBLISHED. RELEASED FOR PUBLICATION  
 © COPYRIGHT - By - TE CONNECTIVITY ALL RIGHTS RESERVED.

| LOC | DIST | REVISIONS   |               |           |       |
|-----|------|-------------|---------------|-----------|-------|
| P   | LTR  | DESCRIPTION | DATE          | DWN       | APVD  |
| CM  | 00   | N1          | ECO-14-010907 | 10SEP2014 | KR OC |

- 1 MATERIAL: CONNECTOR-NYLON UL94V-2 (RED).  
CONTACTS-0.30 [.012] THICK COPPER ALLOY 0.00038 [.000015] GOLD OR 0.00038 [.000015] TOTAL GOLD FLASH OVER PALLADIUM NICKEL, PER TE CONNECTIVITY'S DISCRETION, IN CONTACT AREA WITH MATTE TIN FOR 641190-2 THRU 2-641190-8, MATTE WHISKER MITIGATED TIN FOR 3-641190-2 THRU 5-641190-8 OVER NICKEL UNDERPLATE.
- 2 CONTACTS ACCEPT 22 AWG WIRE WITH 1.52[.060] MAX INSULATION DIAMETER.
- 3 CONTACTS MUST ACCEPT 0.64#0.03[.025] POST AND REMAIN LOCKED IN POSITION.
- 4 IDENTIFICATION NUMBER FOR LAST CIRCUIT MAY NOT APPEAR ON ALL ASSEMBLIES.
- 5 DIMENSIONS IN BRACKETS ARE IN INCHES.
- 6 HOUSING FEATURES ARE: CLOSED END WITH LOCKING RAMP AND WITH POLARIZING TAB.
- 7 OBSOLETE PARTS: OBSOLETE CIS STREAMLINING PER D.RENAUD/D.SINISI

|    |              |    |            |
|----|--------------|----|------------|
| NO | 60.96[2.400] | 24 | 5-644038-4 |
| NO | 58.42[2.300] | 23 | 5-644038-3 |
| NO | 55.88[2.200] | 22 | 5-644038-2 |
| NO | 53.34[2.100] | 21 | 5-644038-1 |
| NO | 50.80[2.000] | 20 | 5-644038-0 |
| NO | 48.26[1.900] | 19 | 4-644038-9 |
| NO | 45.72[1.800] | 18 | 4-644038-8 |
| NO | 43.18[1.700] | 17 | 4-644038-7 |
| NO | 40.64[1.600] | 16 | 4-644038-6 |
| NO | 38.10[1.500] | 15 | 4-644038-5 |
| NO | 35.56[1.400] | 14 | 4-644038-4 |
| NO | 33.02[1.300] | 13 | 4-644038-3 |
| NO | 30.48[1.200] | 12 | 4-644038-2 |
| NO | 27.94[1.100] | 11 | 4-644038-1 |
| NO | 25.40[1.000] | 10 | 4-644038-0 |
| NO | 22.86[.900]  | 9  | 3-644038-9 |
| NO | 20.32[.800]  | 8  | 3-644038-8 |
| NO | 17.78[.700]  | 7  | 3-644038-7 |
| NO | 15.24[.600]  | 6  | 3-644038-6 |
| NO | 12.70[.500]  | 5  | 3-644038-5 |
| NO | 10.16[.400]  | 4  | 3-644038-4 |
| NO | 7.62[.300]   | 3  | 3-644038-3 |
| NO | 5.08[.200]   | 2  | 3-644038-2 |

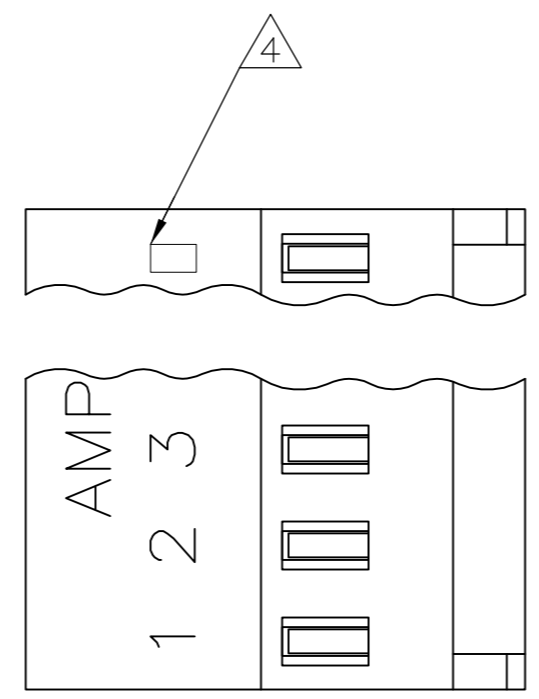

|          |              |                 |            |            |   |
|----------|--------------|-----------------|------------|------------|---|
| NO       | 60.96[2.400] | 24              | 2-644038-4 | SUPERSEDED | 7 |
| NO       | 50.80[2.000] | 20              | 2-644038-0 | SUPERSEDED | 7 |
| NO       | 40.64[1.600] | 16              | 1-644038-6 |            |   |
| NO       | 38.10[1.500] | 15              | 1-644038-5 |            |   |
| NO       | 35.56[1.400] | 14              | 1-644038-4 |            |   |
| NO       | 33.02[1.300] | 13              | 1-644038-3 |            |   |
| NO       | 30.48[1.200] | 12              | 1-644038-2 |            |   |
| NO       | 27.94[1.100] | 11              | 1-644038-1 |            |   |
| NO       | 25.40[1.000] | 10              | 1-644038-0 |            |   |
| NO       | 22.86[.900]  | 9               | 644038-9   |            |   |
| NO       | 20.32[.800]  | 8               | 644038-8   |            |   |
| NO       | 17.78[.700]  | 7               | 644038-7   |            |   |
| NO       | 15.24[.600]  | 6               | 644038-6   |            |   |
| NO       | 12.70[.500]  | 5               | 644038-5   |            |   |
| NO       | 10.16[.400]  | 4               | 644038-4   |            |   |
| NO       | 7.62[.300]   | 3               | 644038-3   |            |   |
| NO       | 5.08[.200]   | 2               | 644038-2   |            |   |
| LEADFREE | DIM A        | NO. OF CIRCUITS | PART NO.   |            |   |

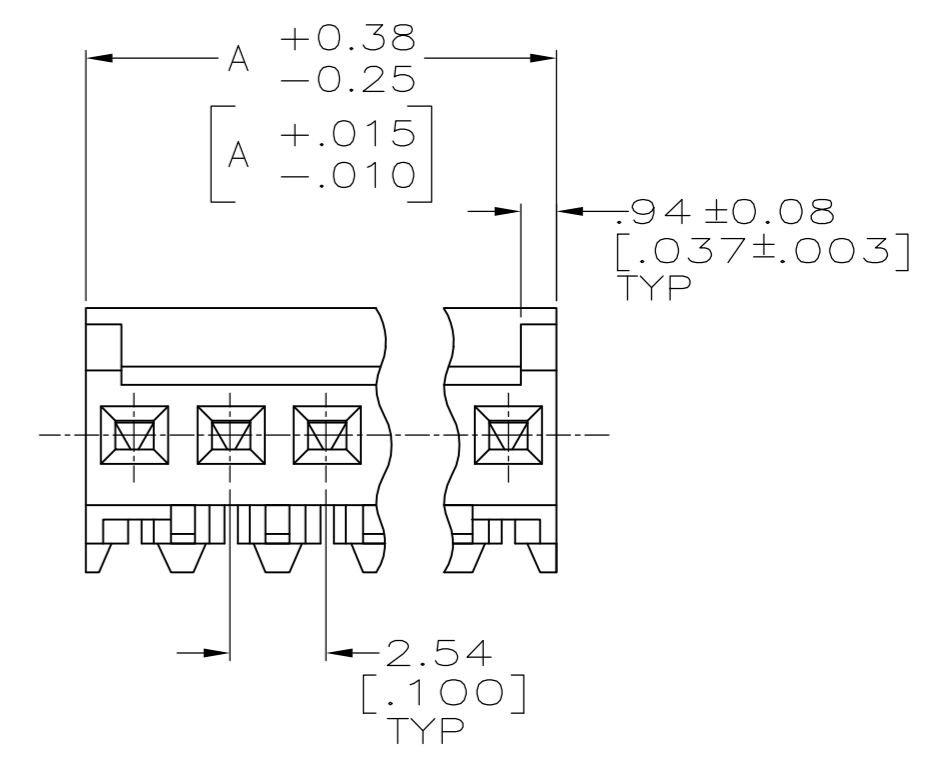
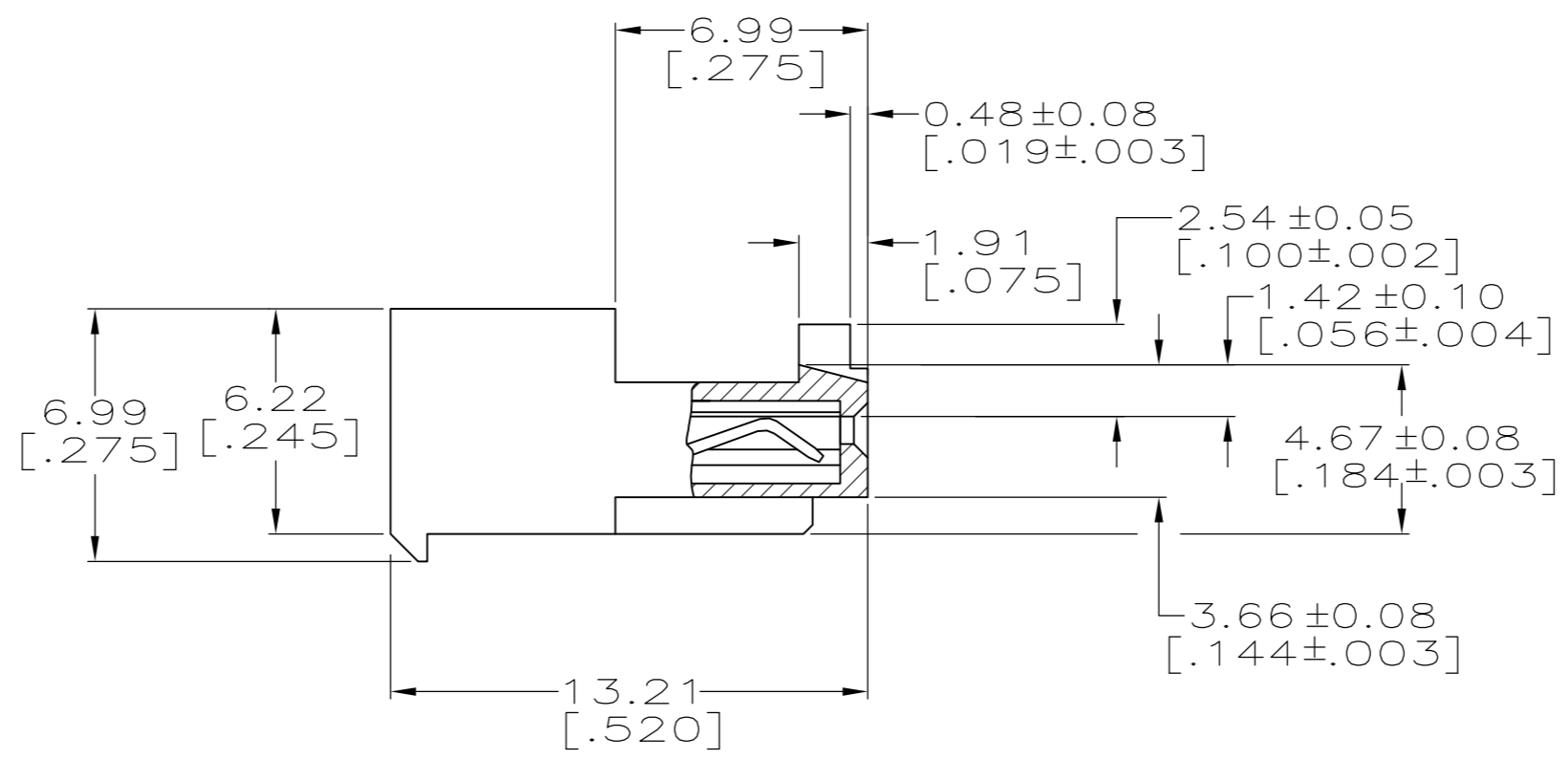

METRIC

|  |  |                  |              |           |       |  |           |            |
|--|--|------------------|--------------|-----------|-------|--|-----------|------------|
| THIS DRAWING IS A CONTROLLED DOCUMENT. |  | DWN              | S. CARPENTER | 12JUN2003 |       | TE Connectivity                              |           |            |
| DIMENSIONS: mm [INCHES]                |  | CHK              | D. BOSSI     | 12JUN2003 |       | NAME   |           |            |
| TOLERANCES UNLESS OTHERWISE SPECIFIED: |  | APVD             | D. BOSSI     | 12JUN2003 |       | MTA-100 CONNECTOR ASSEMBLY, 22 AWG, STANDARD |           |            |
| 0 PLC ±                                |  | PRODUCT SPEC     | 108-1050     |           |       | SIZE   | CAGE CODE | DRAWING NO |
| 1 PLC ±                                |  | APPLICATION SPEC | 114-1019     |           | A2    | 00779  | C=644038  |            |
| 2 PLC ±                                |  | WEIGHT           |              |           | SCALE | SHEET  | REV       |            |
| 3 PLC ± 0.13 [.005]                    |  | CUSTOMER DRAWING |              |           | 5:1   | 1 of 1                                       | N1        |            |
| 4 PLC ±                                |  |                  |              |           |       |  |           |            |
| ANGLES ±                               |  |                  |              |           |       |  |           |            |
| FINISH                                 |  |                  |              |           |       |  |           |            |