

Dimensions: mm (in.)

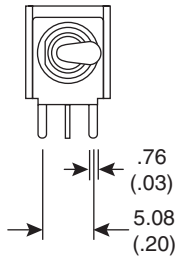

SWITCH FUNCTION

POS.1	POS.2
ON	ON
2-3,5-6	2-1,5-4
5 Comm. 1-4	5 Comm. 1-4

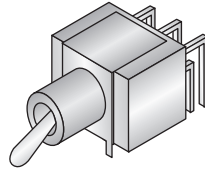
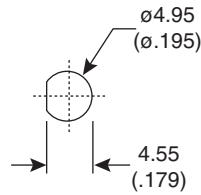
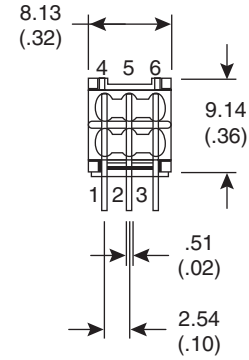
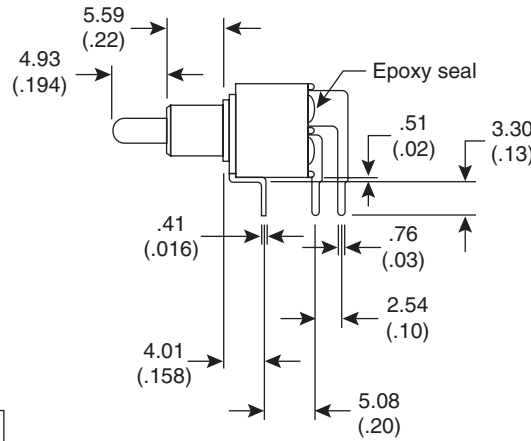

Without locking ring

PANEL MOUNTING

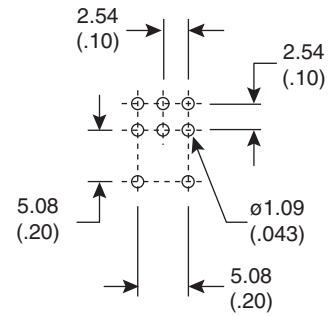

P.C. MOUNTING

Electrical Specifications:

- Contact resistance: 20m Ω max. initial @ 2-4VDC100mA
- Insulation resistance: 1,000M Ω min.
- Dielectric strength: 1,000 V RMS@sea level
- Rating: 1A/250VAC
3A/120VAC or 28VDC

Materials:

- Case: Diallyl phthalate (DAP)
- Actuator: Brass, chrome plated
- Brushing: Brass, nickel plated
- Housing: Stainless Steel
- Switch Support: Brass, tin plated
- Terminals/Contact: Brass, Silver plated

Mechanical Specifications:

- Operating temperature: -30°C to +85°C

Note:

- RoHS compliant by exemption

Toggle Switch
108-2MD1T2B2M6QE-EVX



Mouser Electronics

Authorized Distributor

Click to View Pricing, Inventory, Delivery & Lifecycle Information:

[Mountain Switch:](#)

[108-2MD1T2B2M6QE-EVX](#)