

## Model 3014 Stacking Banana Plug To Miniature Stacking Banana Plug

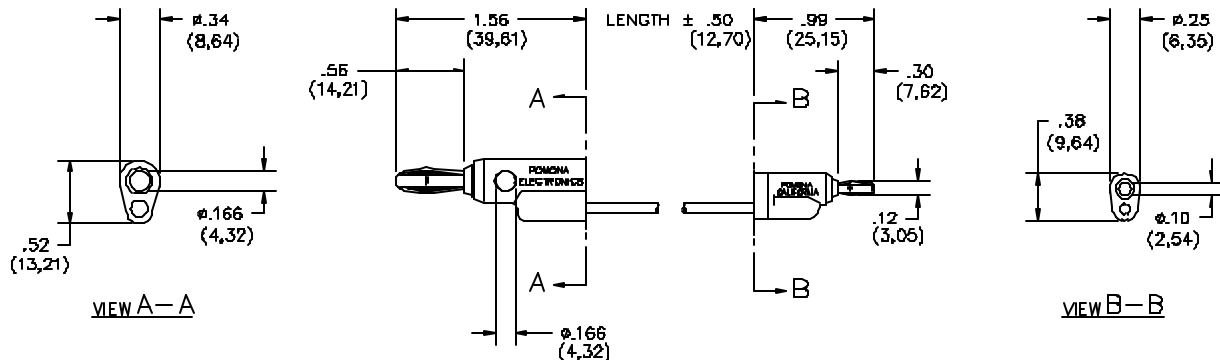

### FEATURES:

- Converts a standard Banana Jack to a Mini Banana Plug or converts a Mini Banana Jack to a standard Banana Plug.
- Cross stacking type Banana Jack, vertical stacking Banana and Mini Banana Plug.

### MATERIALS:

Conn: Stacking Banana Plug

Material: Spring, Beryllium Copper per QQ-C-533, Alloy 172, Cond. HT.

Plug Body – Brass per QQ-B-626, Alloy 360, ½ Hard.

Finish: Nickel plated per QQ-N-290, Class 2, 200/300 microinches.

Insulation: Polypropylene molded to plug body and wire. Color matches color of wire.

Marking: “POMONA ELECTRONICS POMONA CALIFORNIA.”

Wire: 20 AWG, stranding 41 x 36 t.c., PVC insulated, 2.1 (.087) O.D.

Color: See Ordering Information.

Marking: “POMONA 3014-XX-”

Conn: Miniature Stacking Banana Plug

Material: Spring - Beryllium Copper per QQ-C-533, Alloy 172, Cond. HT.

Plug Body – Brass per QQ-B-626, Alloy 360, ½ Hard.

Finish: Gold plated per MIL-G-45204, Type II, Class 00 over electroless nickel

Insulation: Polypropylene molded to plug body and wire. Color matches color of wire.

Marking: “POMONA ELECTRONICS POMONA CALIFORNIA.”

### RATINGS:

Operating Temperature: + 55°C. (+131°F.) Max.

Operating Voltage: Hand-held testing: 30VAC/60VDC Max.

Hands free testing in controlled voltage environments: 3000 WVDC Max.

Current: 5 Amperes

### ORDERING INFORMATION: Model 3014-XX-\*

XX = Cable Lengths, Standard Lengths. 12” (305), 18” (457), 24” (610), 36” (914), 48” (1219) & 60” (1524).

Additional lengths can be quoted upon request. \*= Color, -0 Black, -2 Red.

All dimensions are in inches. Tolerances (except noted): .xx = ±.02” (.51 mm), .xxx = ± .005” (.127 mm).

All specifications are to the latest revisions. Specifications are subject to change without notice.

Registered trademarks are the property of their respective companies. Made in USA

# Mouser Electronics

Authorized Distributor

Click to View Pricing, Inventory, Delivery & Lifecycle Information:

Pomona:

[3014-60-0](#) [3014-60-2](#) [3014-36-2](#) [3014-36-0](#)