

JUF / SWS

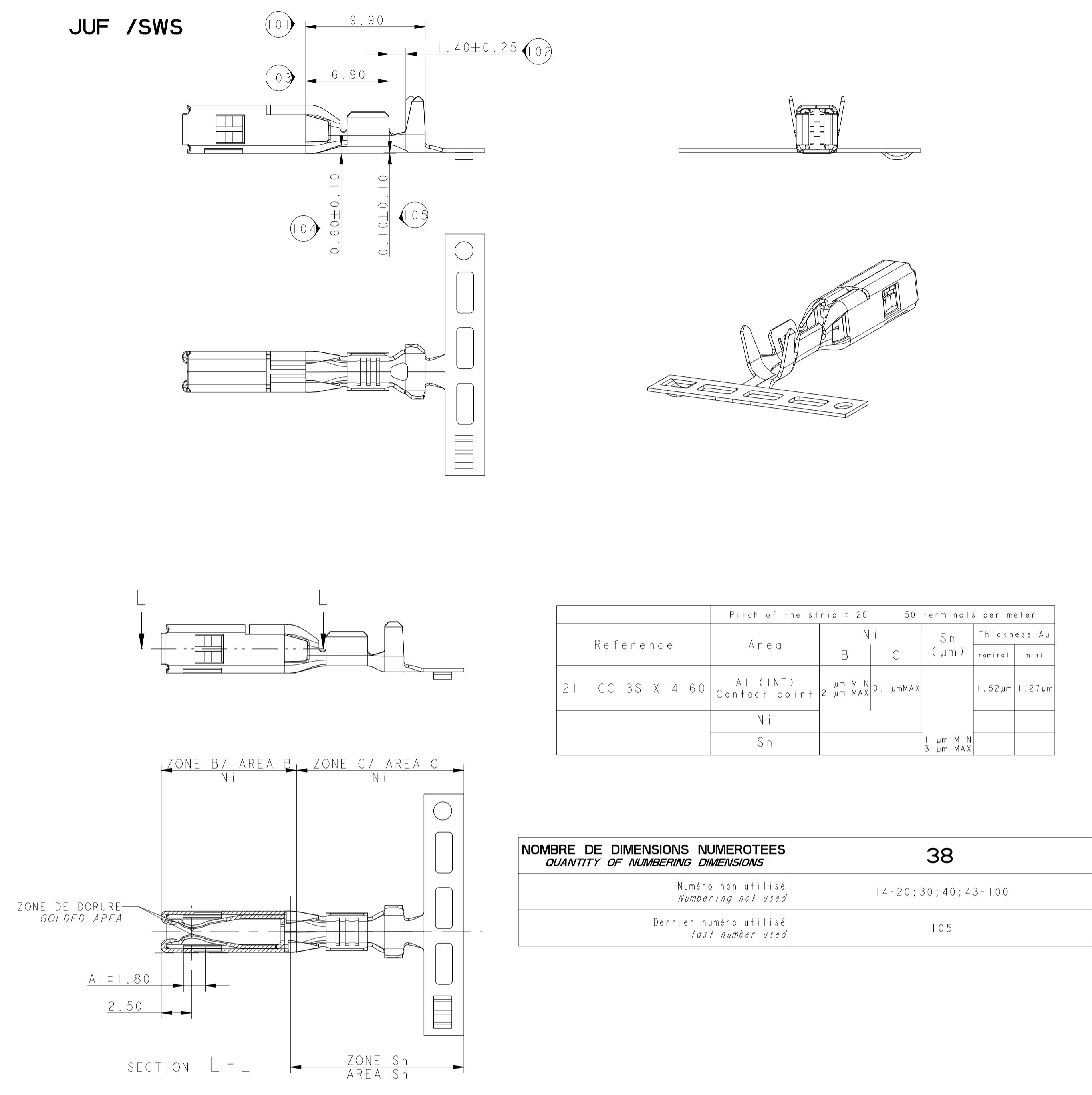

NOMBRE DE DIMENSIONS NUMEROTEES / QUANTITY OF NUMBERING DIMENSIONS	38
Numéro non utilisé / Numbering not used	14-20; 30; 40; 43-100
Dernier numéro utilisé / Last number used	105

ETAT STATE	Références																				Material	Classe								
	⑥				JUF / SWS ⑥				⑥				JUF / SWS ⑥				⑥													
	MVL	REV.	DELPHI	REV.	MVL	REV.	DELPHI	REV.	MVL	REV.	DELPHI	REV.	MVL	REV.	DELPHI	REV.	MVL	REV.	DELPHI	REV.	MVL	REV.	DELPHI	REV.						
Pré-étamé / Pretinned	21ICC3S1150	D	10776116	01					21ICC3S4150	D	33510893	01					21ICC3S2150	D	10776330	01						Cu Zn 15	85°			
Pré-étamé / Pre-tinned	21ICC3S1160	D	10781041	01	21ICC3S1161	D	10740375	01	21ICC3S4160	D	15522621	01	21ICC3S4161	D	13873373	01	21ICC3S2160	D	10726549	01	21ICC3S2161	D	10740376	01	F866700	D	33510896	01	Cu Fe 2P	125°
Pré-piste / Pre-tracked	21ICC3S1460	D	13567906	01					21ICC3S4460	D	33510894	01					21ICC3S2460	D	33501949	01							Cu Fe 2P	125°		
Pré-étamé / Pre-tinned	21ICC3S1190	D	33501947	01					21ICC3S4190	D	33501951	01					21ICC3S2190	D	33501948	01							Cu Cr Ag Fe Ti Si	150°		
Section Gauge	0.35 to 0.70				0.75 to 1.30				1.35 to 2.50				3.00 to 4.00																	
Isolant / Insulation	⑥ 1.25 to 1.80				⑥ 1.60 to 2.40				2.1 to 3				3 to 4																	
A				2.9								3.1																4.65		
B				2.2								2.8																5.05		
R=C				0.9								0.9																1.3		
D ± 0.3			4				4.3				4.35																	6		
E			3.3				4.1				4.15																	6.35		
R=F			1.4				1.4				1.4																	1.7		

14-01621

- 24.95; 12.35 BECOME 12.95; 13.10
- UPDATE INSULATION
- MODIFY CARRIER STRIP DESIGN AND FRONT SHAPE
- 0.80 BECOMES 0.60;
- DELPHI P/N ADDED; REV BECOME D

ECN-NO. / NUMERO ECN	POSITION	CHANGE DESCRIPTION / MODIFICATION

DELPHI ELECTRICAL/ELECTRONIC ARCHITECTURE  
EPIRON, FRANCE

28 x 08 FEMALE TERMINAL

211FT0437

SICMA 3

FBA-0332

211FT0437

CONTACTS FEMALE TERMINAL		SECTION GAUGE	CUIVRE WIRE		ISOLANT INSULATION				CENTREUR CONNEXION CONNEXION TOP TERMINAL GUIDING																					
REFERENCES REFERENCES			POINCON PUNCH		ENCLUME ANVIL		FRETAGE PAR RECOUVREMENT INSULATION BARREL WITH OVERLAPPING		FRETAGE AVEC JOINT UNITAIRE SUR FIL INSULATION BARREL WITH SINGLE SEAL		LARGEUR WIDTH (F)	EPAISSEUR THICKNESS (G)	HAUTEUR HEIGHT (H)	COURSE DISPLACEMENT (I)																
MVL	DELPHI	C	D	L1	RI	A1	L2	(L3)	L4	L5	R2	D1	D2	A	B	L1	RI	A1	L2	(L3)	L4	R2	(F)	(G)	(H)	(I)				
211 CC 3S 1150 / 1160	10776116 / 10781041	0.35 to 0.70	3.50	7.90	1.60	0.43	2	1.60	(0.20)	0.21	3.46	0.96	0.85	0.75	3.60	8.10	2.50	0.93	0.50	0.65	(0.87)	4	2.50	(0.21)	0.42	1.50	(3.45 mini)	(5)	(3.50)	(9)
211 CC 3S 1460 / 1490	13567906 / 33510895		2.93	7.65	1.86	0.50	2	1.86	(0.23)	0.24	3.37	1.16	1.00	0.50	3.00	8.00	2.95	1.10	0.59	0.77	(1.02)	4	2.95	(0.25)	0.49	1.77				
211 CC 3S 1161	10740375		3.70	8.20	2.85	0.77	4	2.85	(0.36)	0.44	3.79	1.50	1.00	0.20	4.40	8.60	3.85	1.42	0.77	1.00	1.32	4	3.85	(0.30)	0.67	2.31				
211 CC 3S 4150 / 4160	33510893 / 15522621	0.75 to 130	2.93	7.65	1.86	0.50	2	1.86	(0.23)	0.24	3.37	1.16	1.00	0.50	3.00	8.00	2.95	1.10	0.59	0.77	(1.02)	4	2.95	(0.25)	0.49	1.77	(3.45 mini)	(5)	(3.50)	(9)
211 CC 3S 4460 / 4190	33510894 / 33501951		3.70	8.20	2.85	0.77	4	2.85	(0.36)	0.44	3.79	1.50	1.00	0.20	4.40	8.60	3.85	1.42	0.77	1.00	1.32	4	3.85	(0.30)	0.67	2.31				
211 CC 3S 4161	13873373	135 to 250	3.70	8.20	2.85	0.77	4	2.85	(0.36)	0.44	3.79	1.50	1.00	0.20	4.40	8.60	3.85	1.42	0.77	1.00	1.32	4	3.85	(0.30)	0.67	2.31	(3.45 mini)	(5)	(3.50)	(9)
211 CC 3S 2150 / 2160	10776330 / 10726549		4.10	9.10	3.20	0.87	4	3.20	(0.40)	0.50	3.89	1.70	0.60	0.20	5.50	9.50	4.10	1.52	0.82	1.07	(1.41)	4	4.10	(0.34)	0.69	2.46				
211 CC 3S 2460 / 2190	33501949 / 33501948	300 to 400	4.10	9.10	3.20	0.87	4	3.20	(0.40)	0.50	3.89	1.70	0.60	0.20	5.50	9.50	4.10	1.52	0.82	1.07	(1.41)	4	4.10	(0.34)	0.69	2.46	(3.45 mini)	(5)	(3.50)	(9)
211 CC 3S 2161	10740376																													
F866700	33510896																													

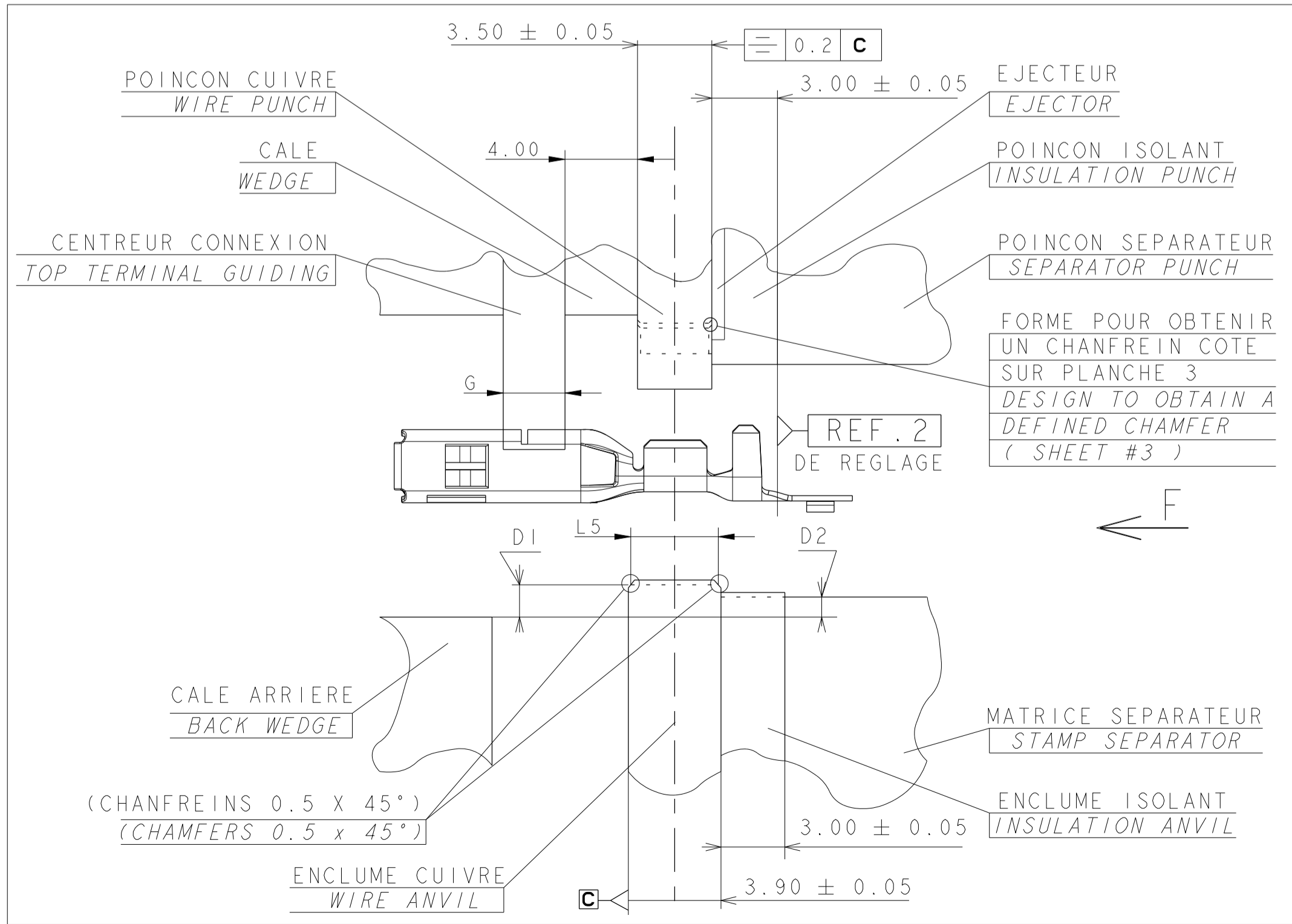
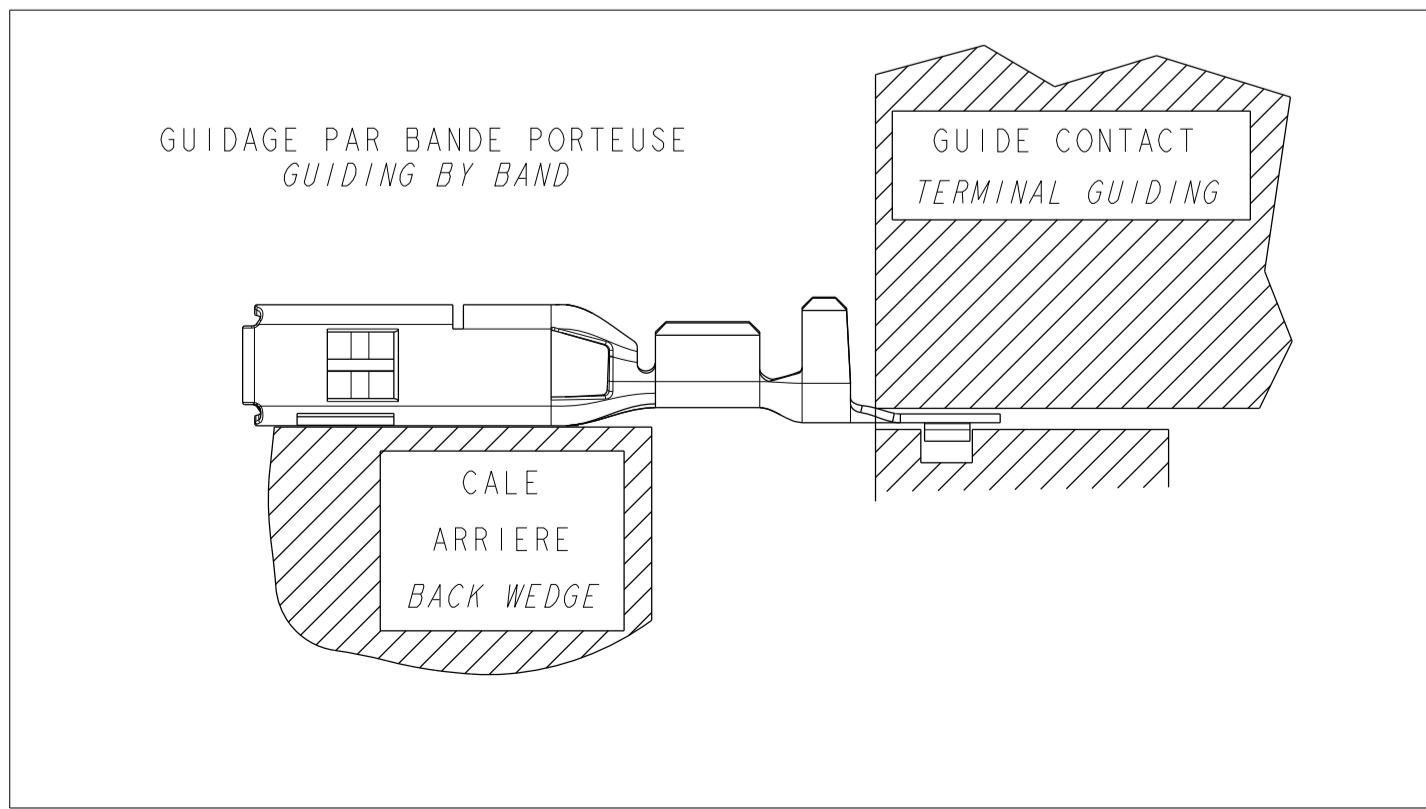
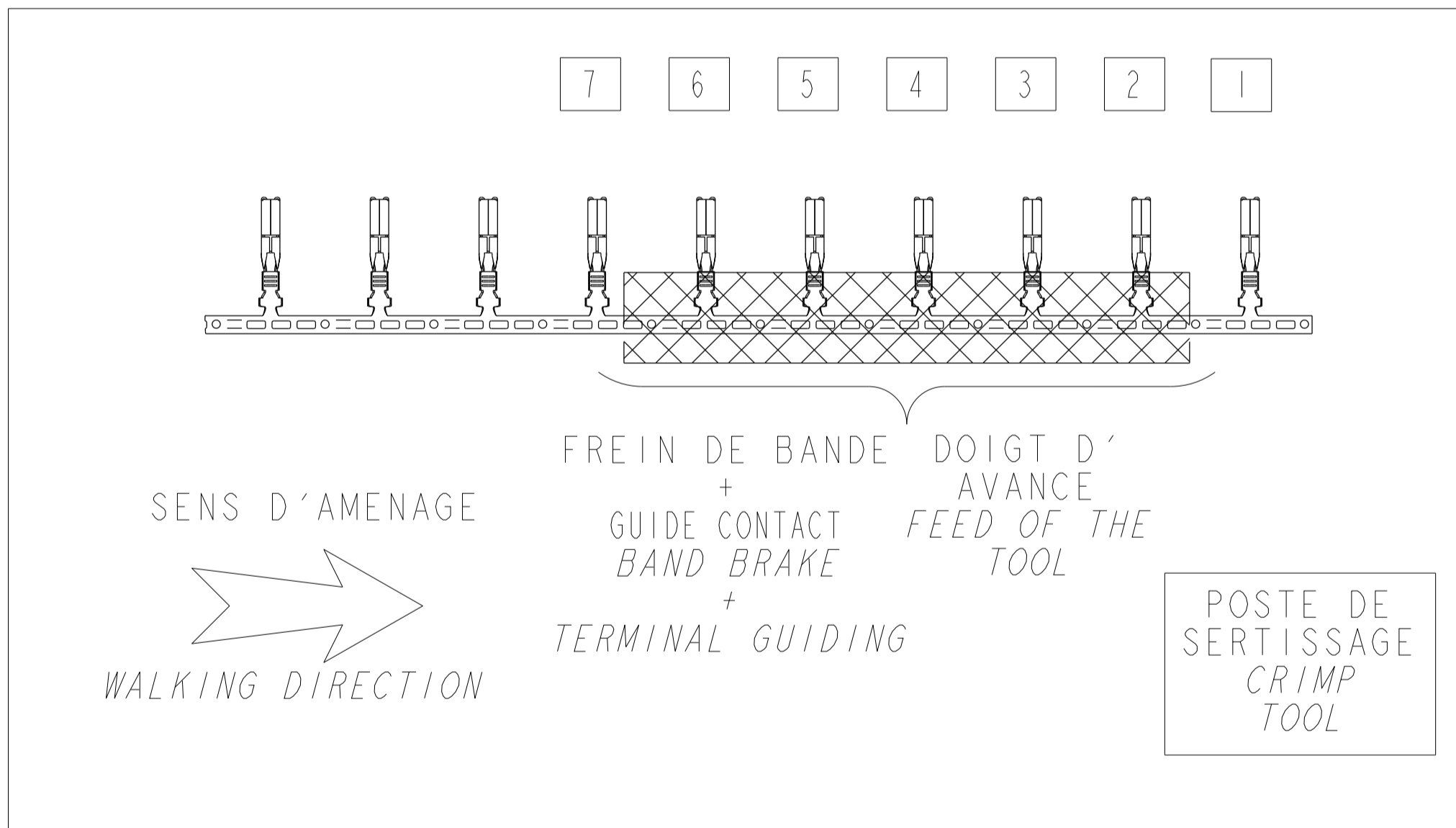
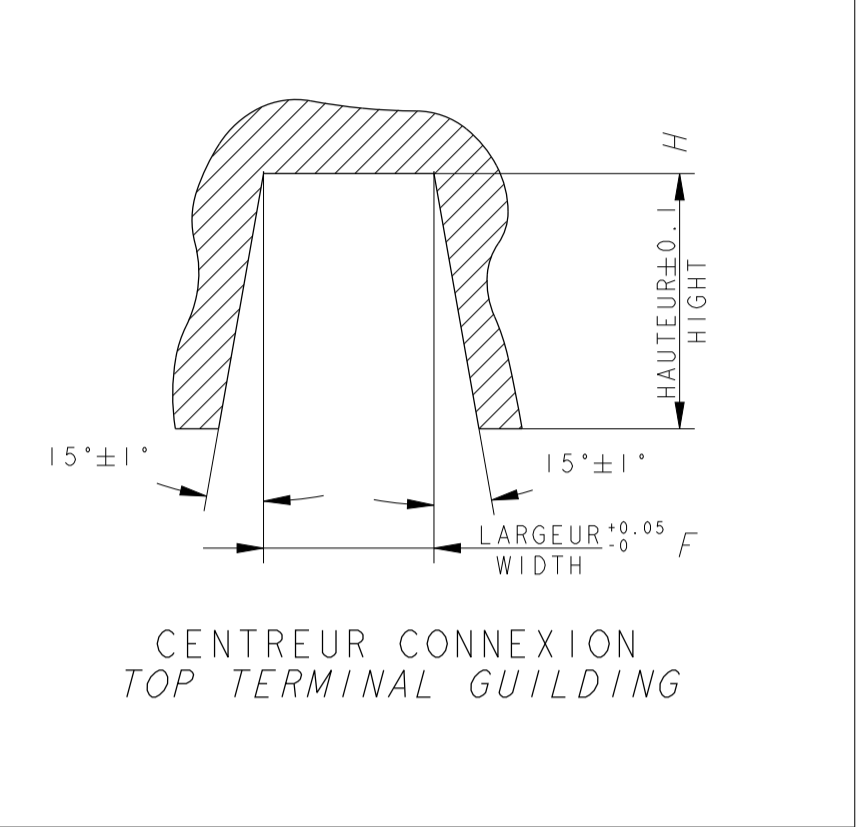
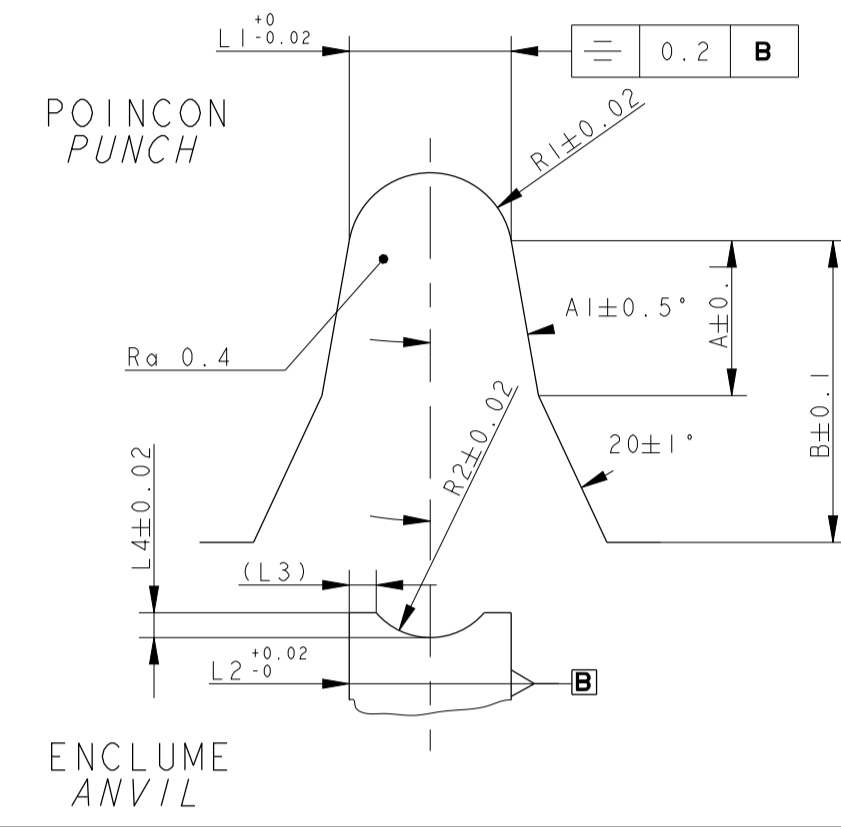
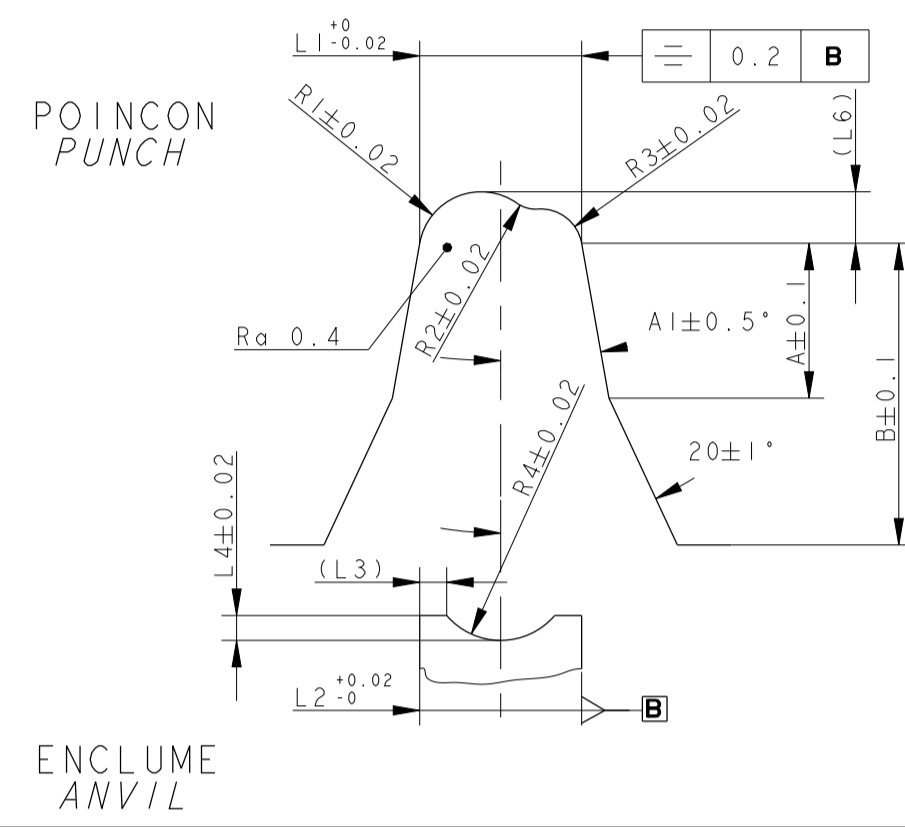
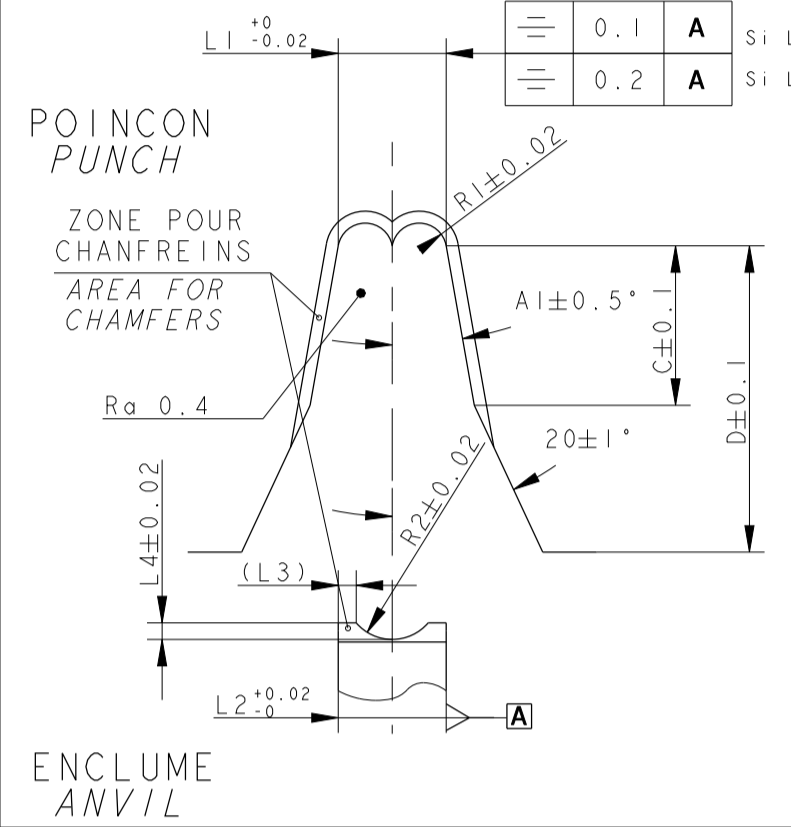

14-01621	DELPHI P/N ADDED		
ECN-NO. NUMERO ECH	POSITION	CHANGE DESCRIPTION	MODIFICATION
PROJECT SPEC. SPECIF. PRODUIT	PACKAGING SPEC. SPECIF. EMBALLAGE	APPLICATION SPEC. SPECIF. APPLICATION	COPYRIGHT DELPHI CORPORATION AND/OR ITS AFFILIATES. ALL RIGHTS RESERVED. REVISED THIS DRAWING IS THE PROPERTY OF DELPHI CORPORATION AND CONTAINS DELPHI CONFIDENTIAL INFORMATION. THE REPRODUCTION, DISTRIBUTION AND SALE OF THIS DOCUMENT OR ITS CONTENTS WITHOUT THE WRITTEN PERMISSION OF DELPHI CORPORATION IS PROHIBITED. LE PRESENT DOCUMENT EST LA PROPRIETE DE DELPHI CORPORATION ET CONTIEN DES INFORMATIONS CONFIDENTIELLES. LA REPRODUCTION, LA DISTRIBUTION ET LA VENTE DE CE DOCUMENT OU DE SES CONTENU SANS L'AUTORISATION ECRITE DE DELPHI CORPORATION EST INTERDITE.
TOLERANCES TOLERANCES	±0.2 ±0.2	MATERIAL MATIERE	SEE TABLE
CONTRACT N. CONTRAT N°	20140400	COLOR COULEUR	
DO NOT REASURE DRAWING NE PAS REASSER LE DROUING		ECO LEX CODE	FE
DATE	20140400	TITLE DESIGNATION	28 x 08 FEMALE TERMINAL
CREATED BY	LDOMINGUE	PROJECT	
APPROVED BY	F FALLAHE	ESR NO. NUMERO ESR	FBA-0332
FILE NAME	211FT0437	NUMERO CAP.	
		NO MODIFICATION ALLOWED OUTSIDE PAS DE MODIFICATION EN DEHORS	

\* (VALEUR) UNIQUEMENT POUR INFORMATION (VALUE) FOR INFORMATION ONLY

**NOUVELLES GAMMES DE SERTISSAGE  
NEW RANGE OF CRIMPING**

1 PARAMETRES DE SERTISSAGE CRIMP PARAMETERS		FILS SUIVANT SPECIF PSA N°: 96 095 032 99 (1R) ET 96 347 082 99 (1D) WIRES ACCORDING TO PSA SPEC N°: 96 095 032 99 (1R) ET 96 347 082 99 (1D)									
CONTACT FEMALE TERMINAL		SERTISSAGE CUIVRE WIRE BARREL				FRETTEGE ISOLANT INSULATION BARREL					
SECTION GAUGE	DAC MAXI DAI MAXI LNC ± 0.25 LNI ± 0.25 DCS ± 0.10 DIS ± 0.10 DISJ ± 0.10	SECTION SECTION (mm²)		(LARGEUR) (WIDTH)	HAUTEUR (HEIGHT)	Ø EQU. (EQU. DIA.)	PAR RECouvreMENT WITH OVERLAPPING		AVEC JOINT UNITAIRE WITH SINGLE SEAL		TYPE FIL WIRE
		THEORIQUE THEORETIC	REELLE REAL	(LARGEUR) (WIDTH)	(HAUTEUR) (HEIGHT)	(LARGEUR) (WIDTH)	(HAUTEUR) (HEIGHT)	(LARGEUR) (WIDTH)	(HAUTEUR) (HEIGHT)		
0.35 to 0.70	0.25 0.25 2.40 3.40 / 4.00 0.85 0.75 0	0.35	0.32	(1.65)	1.09	1.30	(2.52)	(2.02)			1R
		0.50	0.49	(1.65)	1.17	1.50	(2.53)	(2.05)	(3.31)	(3.13)	ID
		0.35 + 0.35	0.68	(1.65)	1.25	2.03	(2.59)	(2.31)			ID
		0.75	0.72	(1.90)	1.31	1.86	(3.00)	(2.20)	(3.85)	(3.22)	ID
0.75 to 1.30	0.25 0.25 2.40 3.40 / 4.00 1.00 0.50 0.75 0	0.85	0.86	(1.91)	1.40	1.80	(3.05)	(2.23)	(3.49)	(2.97)	ID
		1.00	0.93	(1.91)	1.40	1.90	(3.02)	(2.41)	(3.87)	(3.41)	ID
		1.25	1.25	(1.92)	1.56	2.15	(3.10)	(2.56)	(3.66)	(3.17)	
		0.35 + 0.5	0.83	(1.91)	1.39	2.11	(3.09)	(2.52)			
1.35 to 2.50	0.25 0.25 2.40 3.40 / 4.00 1.00 0.20 0.90 - 0.10	0.35 + 0.75	1.06	(1.91)	1.48	2.31	(3.11)	(2.65)			ID
		0.35 + 1	1.27	(1.92)	1.57	2.43	(3.11)	(2.65)			ID
		0.50 + 0.50	0.98	(1.91)	1.45	2.19	(3.10)	(2.60)			
		0.50 + 0.75	1.21	(1.92)	1.54	2.38	(3.11)	(2.65)			
		1.4	1.33	(2.85)	1.42	2.30	(3.90)	(2.80)			
		1.5	1.53	(2.87)	1.47	2.20	(3.90)	(2.72)	(3.91)	(3.58)	
		2	1.82	(2.88)	1.55	2.60	(3.91)	(3.05)	(4.05)	(4.06)	
		2	1.73	(2.88)	1.53	2.10	(3.89)	(2.65)	(3.88)	(3.47)	T6
		2.5	2.62	(2.93)	1.77	2.80	(3.92)	(3.23)	(4.10)	(4.20)	
		0.35 + 1	1.27	(2.85)	1.40	2.43	(3.91)	(2.91)			ID
		0.50 + 1.50	2.02	(2.90)	1.61	2.19	(3.92)	(3.22)			IR
		3.00 to 4.00	0.25 0.25 2.40 3.40 / 4.00 1.00 0.20 0.90 - 0.10	0.60 + 1	1.52	(2.87)	1.47	2.75	(3.92)	(3.18)	
0.60 + 1.40	1.92			(2.89)	1.58	3.10	(3.94)	(3.53)			IR
0.75 + 0.75	1.44			(2.86)	1.45	2.56	(3.91)	(3.01)			ID
0.75 + 1.5	2.25			(2.91)	1.67	2.96	(3.93)	(3.38)			IR
1 + 1	1.86	(2.89)	1.56	2.79	(3.92)	(3.22)			ID		
3	2.97	(3.28)	1.98	3.05	(4.20)	(3.66)					
4	3.70	(3.30)	2.06	3.50	(4.27)	(3.93)					

(VALEUR): UNIQUEMENT POUR INFORMATION  
(VALUE): FOR INFORMATION ONLY

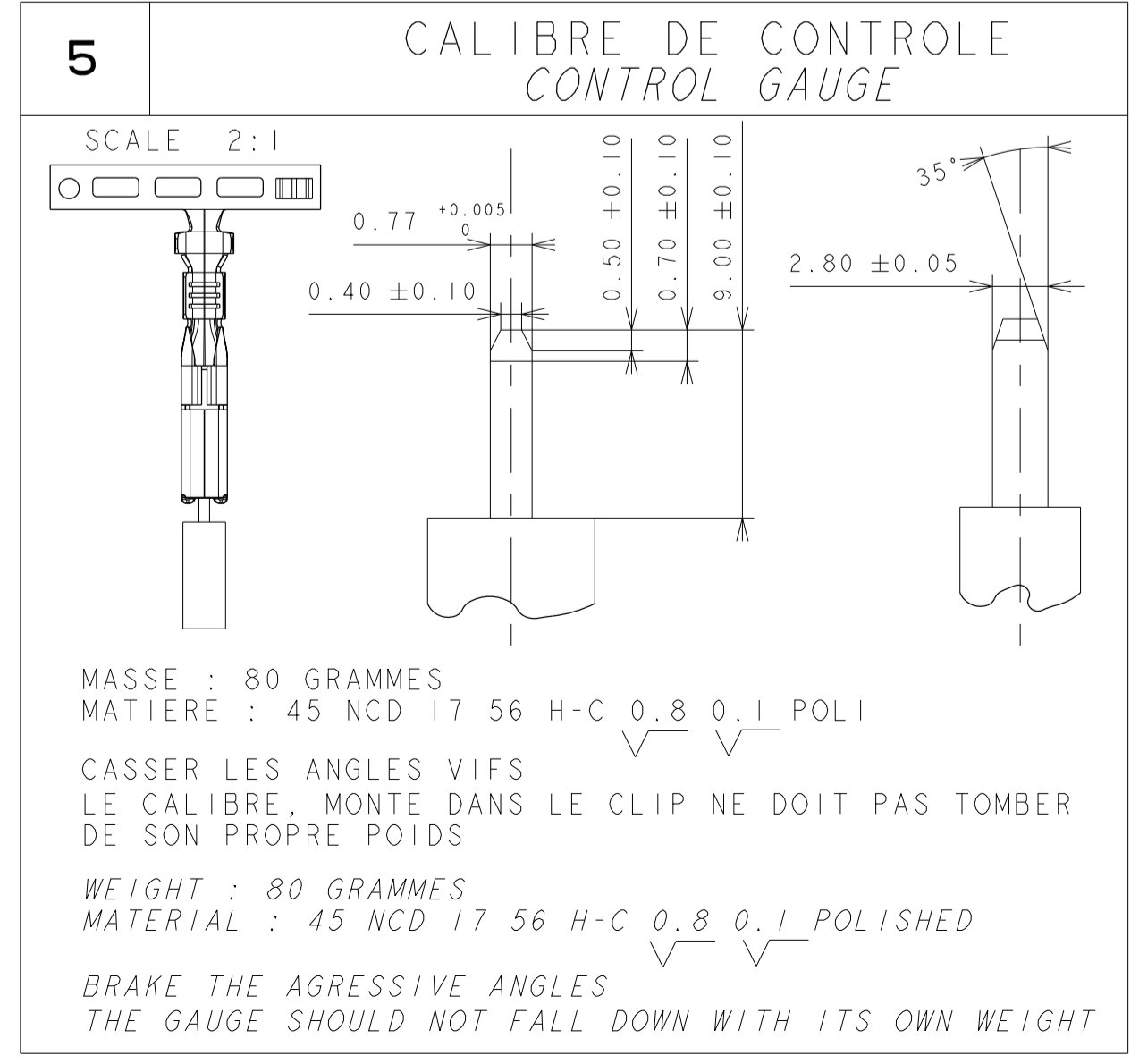
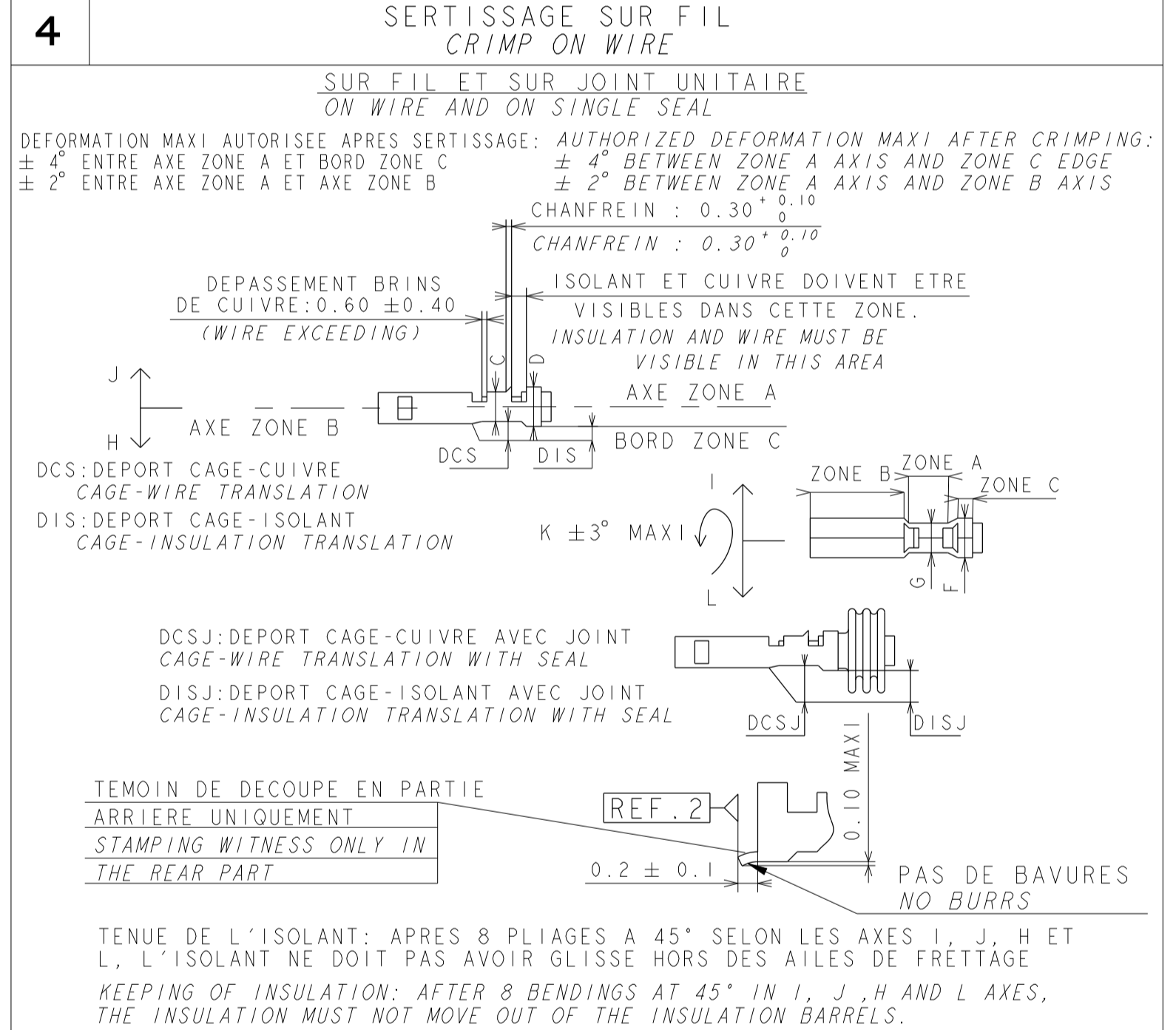
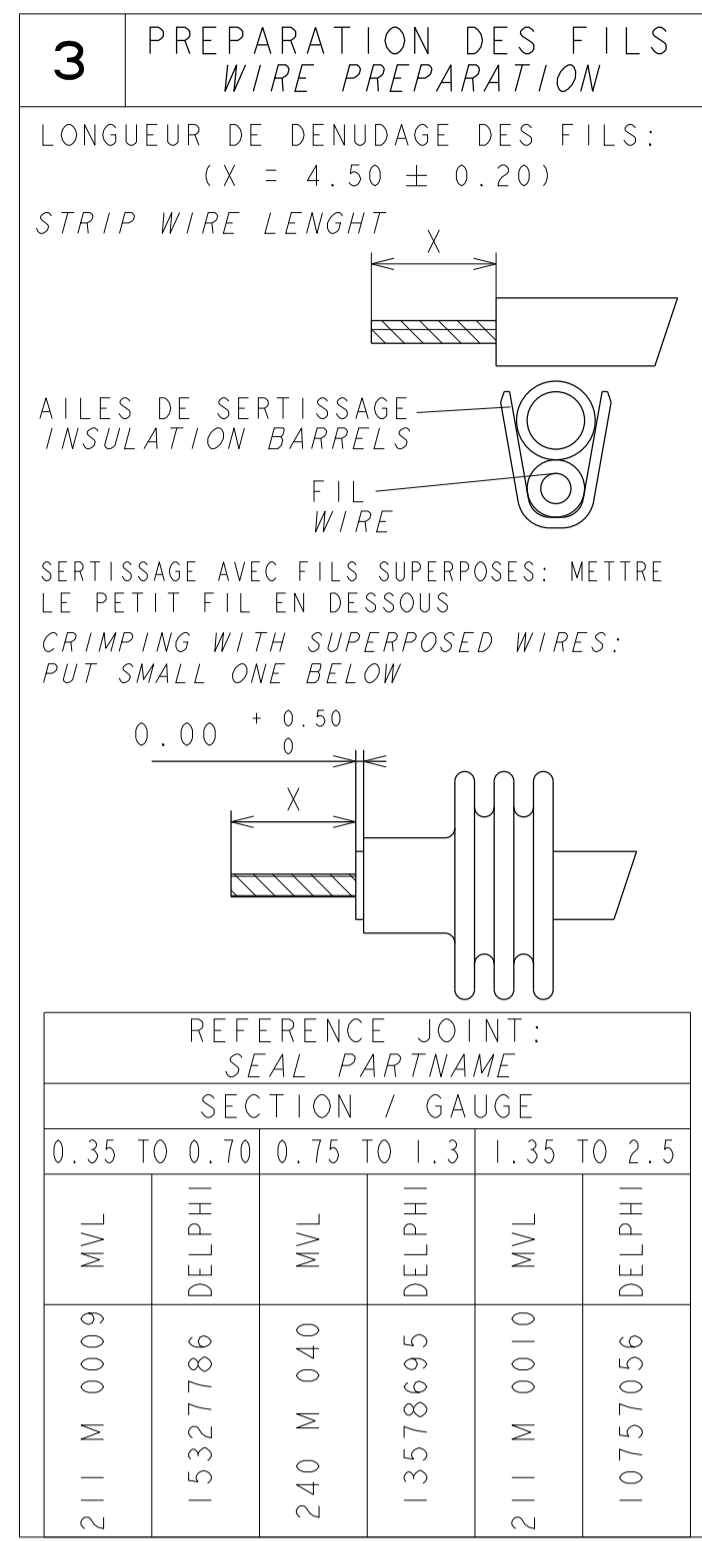
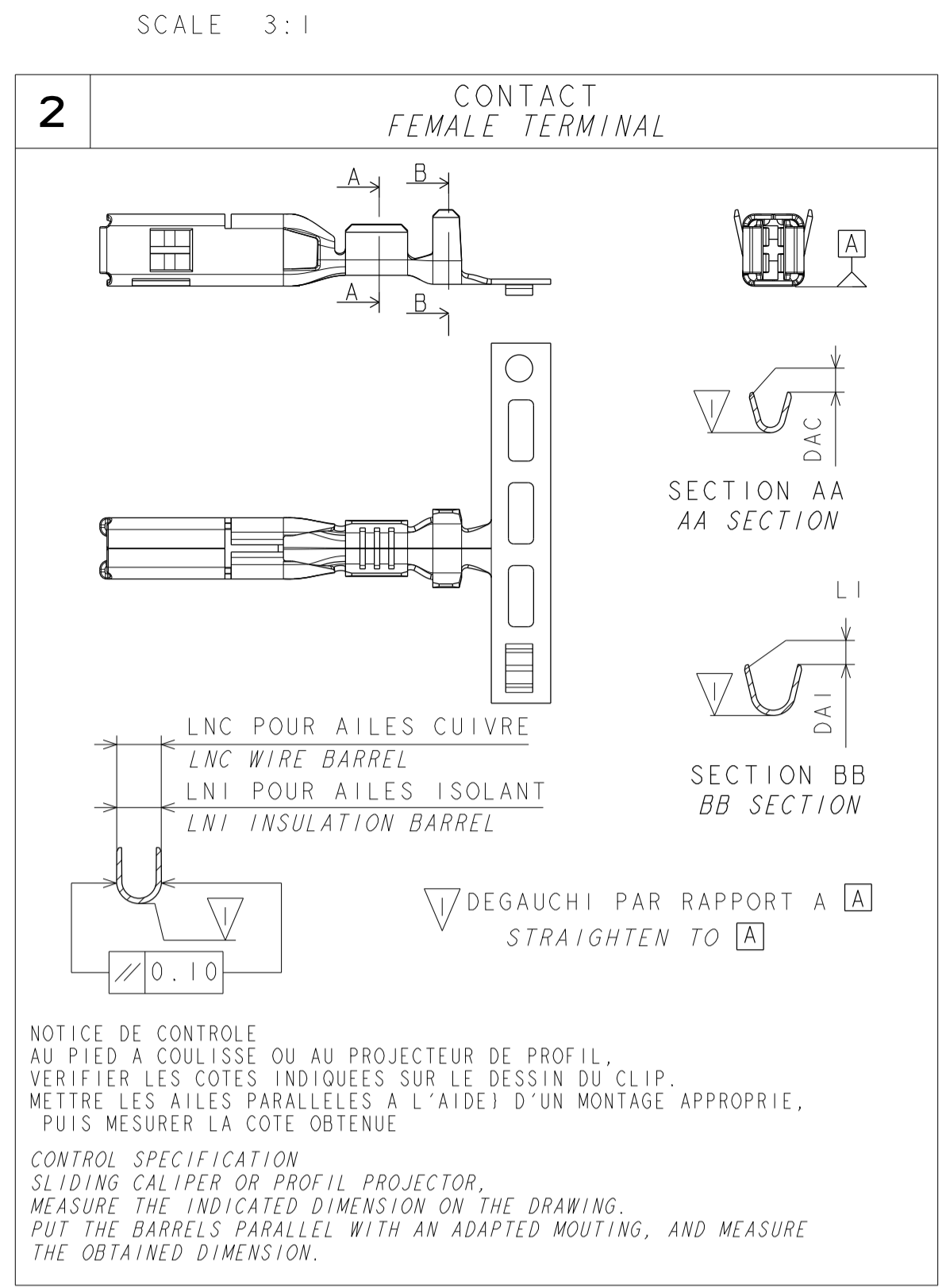

**6 CONDITIONNEMENT PACKAGING**

CONDITIONNEMENT SUIVANT NORME GALIA  
PACKAGING ACCORDING TO GALIA SPECIFICATION

Suivant PU N°064  
Following PU N° 064

14-01621	DELPHI P/N ADDED	
ECN-NO. NUMERO ECN	POSITION POSITION	CHANGE DESCRIPTION MODIFICATION
PROJECT SPEC. SPECIF. PRODUIT	PACKAGING SPEC. SPECIF. ENSEMBLE	APPLICATION SPEC. SPECIF. APPLICATION
<p>DELPHI CORPORATION AND/OR ITS AFFILIATES. ALL RIGHTS RESERVED. REVISED THIS DRAWING IS THE PROPERTY OF DELPHI CORPORATION AND CONTAINS DELPHI CONFIDENTIAL INFORMATION. THE REPRODUCTION, DISTRIBUTION AND RELEASE OF THIS DOCUMENT OR ITS CONTENTS WITHOUT THE WRITTEN PERMISSION OF DELPHI CORPORATION IS PROHIBITED. LE PLAN EST LA PROPRIETE DE DELPHI CORPORATION ET CONTIEN DES INFORMATIONS CONFIDENTIELLES. LA REPRODUCTION, LA DISTRIBUTION ET LA DIFFUSION DE CE DOCUMENT OU DE SES CONTENU SANS L'AUTORISATION ECRITE DE DELPHI CORPORATION EST INTERDITE.</p>		
TOLERANCES TOLERANCES	±0.2 ±0.2	MATERIAL: SEE TABLE
CONTROL NO. NUMERO CONTR. N°		COLOUR: COULEUR
DO NOT MEASURE DRAWING NE PAS MESURER LE DRESSAGE		ECO EXP: 664 FE
DATE DATE	NAME NOM	TITLE TITRE
CREATED BY CREE PAR	20140409	TECHNIEN
MODIFIED BY MODIFIE PAR	20140409	L DOMERGUE
APPROVED BY APPR. PAR	20140409	F FAURIE
FILE NAME NOM DE FICHER	211FT0437	
DRAWING NUMBER REF. PLAN		28 x 08 FEMALE TERMINAL
STATE ETAT		SICMA 3
PART NUMBER REF. ARTICLE		
DRAWING NUMBER REF. PLAN		211FT0437
STATE ETAT		SERIAL RELEASED
PART NUMBER REF. ARTICLE		
DRAWING NUMBER REF. PLAN		See Table