

LOC	DIST	REVISIONS				
		P	LTR	DESCRIPTION	DATE	DWN APVD
E	B		B1	REVISED PER ECO-11-005033	01APR11	RK HMR

NOTES:

- 1 PACK IN ACCORDANCE WITH AMP SPEC 107-3275
- 2 100 TRAY PACK IN ACCORDANCE WITH AMP SPEC 107-3275
- 3 Ag PLATING
- 4 ELECTRICAL CHARACTERISTICS  
FREQUENCY RANGE: DC - 4 GHz  
NOMINAL IMPEDANCE: 50 Ohm  
INSULATION RESISTANCE: 5000 MOhm  
WORKING VOLTAGE: 500 Volts RMS at Sea Level  
DIELECTRIC WITHSTAND VOLTAGE: 1500 Volts RMS Max  
CONTACT RESISTANCE:  
CENTRE CONTACT: 1.50 mOhm Max  
OUTER CONTACT: 0.20 mOhm Max  
VSWR @ xGHz: N/A  
INSERTION LOSS xdb: N/A
- 5 MECHANICAL CHARATERISTICS  
COUPLING RETENTION FORCE: N/A  
CABLE RETENETION FORCE: N/A  
DURABILITY: 500 Cycles Min
- 6 ENVIRONMENTAL CHARACTERISTICS  
OPERATING TEMPERATURE: -65 to +165 DegC
- 7 FOR TECHNICAL DATA REFER TO YOUR LOCAL TE CONNECTIVITY SALES OFFICE
- 8 ALL DIMENSIONS ARE NOMINAL FOR REFERENCE ONLY UNLESS OTHERWISE STATED

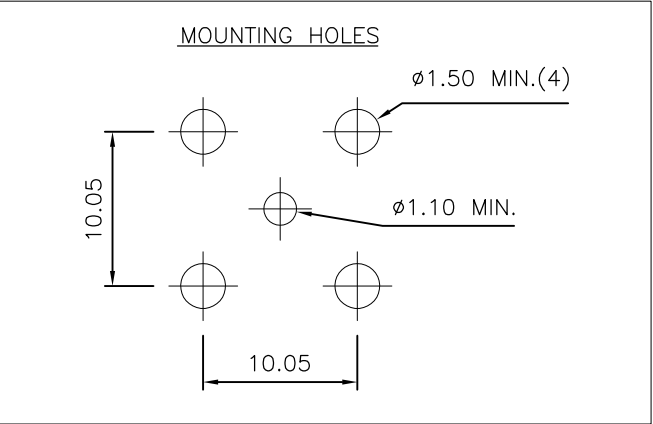
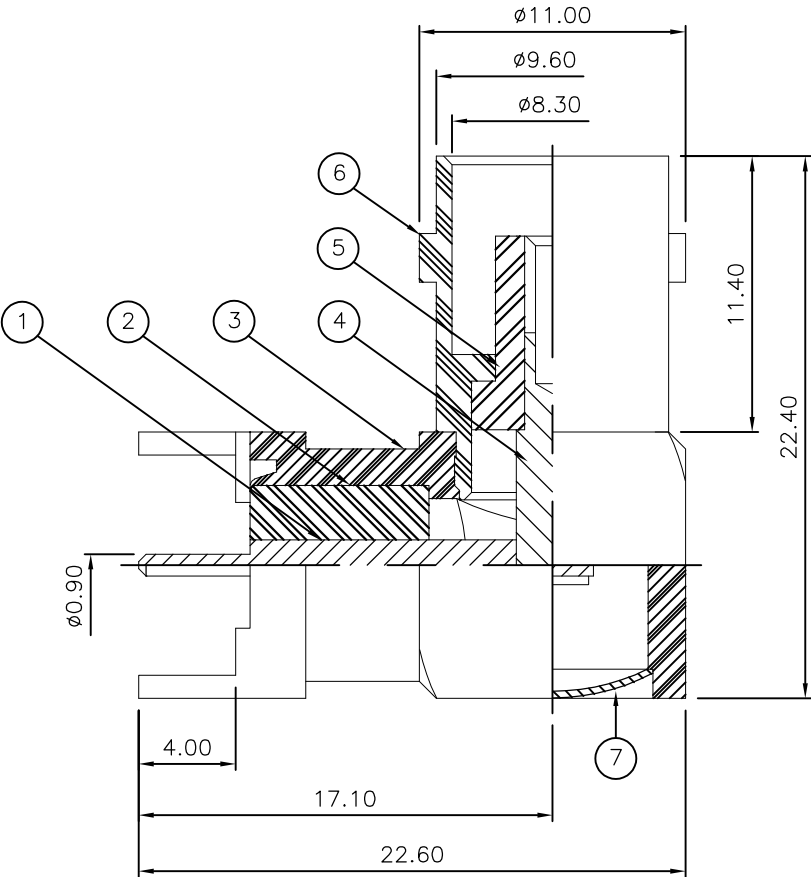

		1	1	BRASS	3	CAP	7
		1	1	BRASS	3	BODY 2	6
		1	1	PTFE		INSULATION	5
		1	1	BRASS	3	CONTACT 2	4
		1	1	BRASS	3	BODY 1	3
		1	1	PTFE		INSULATION	2
		1	1	BRASS	3	CONTACT 1	1
		6--0	1--0	MATERIAL		DESCRIPTION	ITEM
		2	1				
QUANTITY PER ASSY				PARTS LIST			

THIS DRAWING IS A CONTROLLED DOCUMENT.		DWN J.SANDWELL 13JUN06	<div>TE Connectivity</div> <div>BNC ELBOW PCB SOCKET SILVER PLT 50 OHM</div>				
DIMENSIONS: mm		CHK S.PARLOW 13JUN06					
		APVD F.WHEELER-KING 13JUN06	NAME				
		PRODUCT SPEC					
		APPLICATION SPEC					
MATERIAL SEE TABLE		WEIGHT -	SIZE A3	CAGE CODE 00779	DRAWING NO C-1478035	RESTRICTED TO -	
CUSTOMER DRAWING			SCALE NTS	SHEET 1 OF 1	REV B1		

# Mouser Electronics

Authorized Distributor

Click to View Pricing, Inventory, Delivery & Lifecycle Information:

[TE Connectivity:](#)

[6-1478035-0](#)