

# INTERCONNECTS

## SERIES 310, 330, 351 • 2,54 GRID (0,46 DIA. PINS), SURFACE MOUNT HEADERS AND SOCKETS • SINGLE ROW STRIPS

### Mates with Series 310...023 Surface Mount Z-Bend Socket (See Fig. 3)

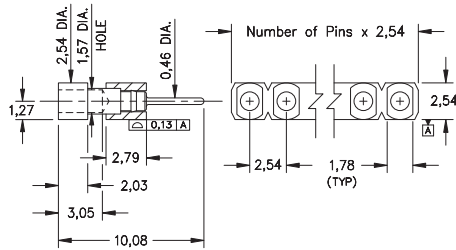

Coplanarity 0,13. For pin counts >10 positions, consult Technical Support.

**FIG. 1**

### Mates with Series 310...023 Surface Mount Z-Bend Socket (See Fig. 3)

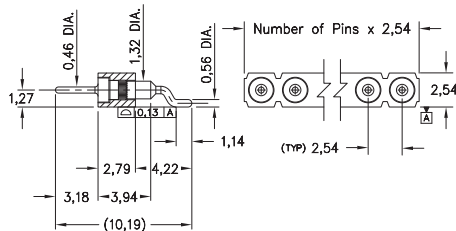

Coplanarity 0,13. For pin counts >10 positions, consult Technical Support.

**FIG. 2**

### Mates with Series 351...002 and 330...027 Surface Mount Header (See Fig. 1 & 2)

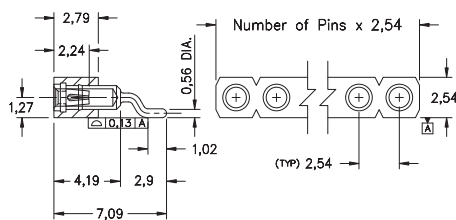

Coplanarity 0,13. For pin counts >10 positions, consult Technical Support.

**FIG. 3**

- Series 351 horizontal surface mount headers are available with 0,46 dia. pluggable pins (MM #5102). Series 330 horizontal surface mount z-bend headers use MM #3027 pins. See page 224 for details
- Series 310 horizontal surface mount Z-Bend sockets uses MM #1023 receptacles that accept pin diameters from 0,38 - 0,64. See pages 171 for details
- Insulators are high temperature thermoplastic, suitable for all soldering operations
- Ideal for daisy chaining parallel boards

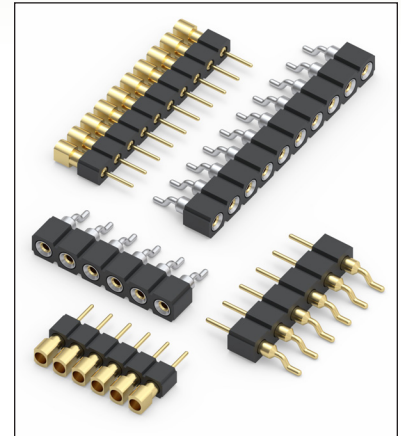

## ORDERING INFORMATION

<b>FIG. 1</b>	<b>Series 351...002</b>	<b>0,46 Dia. Surface Mount Header</b>		
		351-10-1	-40-002000	
	<b>Specify number of pins</b>	02-10		
<b>FIG. 2</b>	<b>Series 330...027</b>	<b>0,46 Dia. Surface Mount Z-Bend Header</b>		
		330-XX-1	-40-027000	
	<b>Specify number of pins</b>	02-10		
<b>SPECIFY PLATING CODE XX=</b>		10	40	
Pin Plating		0,25µm Au	5,08µm Sn	

<b>FIG. 3</b>	<b>Series 310...023</b>	<b>0,46 Dia. Surface Mount Z-Bend Socket</b>					
		310-XX-1	-40-023000				
	<b>Specify number of pins</b>	02-10					
<b>SPECIFY PLATING CODE XX=</b>		91	93	99	41	43	44
Sleeve (Pin)		5,08µm Sn/Pb	5,08µm Sn/Pb	5,08µm Sn/Pb	5,08µm Sn	5,08µm Sn	5,08µm Sn
Contact (Clip)		0,25µm Au	0,76µm Au	2,54µm Sn/Pb	0,25µm Au	0,76µm Au	2,54µm Sn



# Mouser Electronics

Authorized Distributor

Click to View Pricing, Inventory, Delivery & Lifecycle Information:

## Mill-Max:

[310-43-110-40-023000](#) [310-43-105-40-023000](#) [310-43-102-40-023000](#) [310-43-108-40-023000](#) [310-43-104-40-023000](#) [310-43-106-40-023000](#) [330-10-105-40-027000](#) [330-10-103-40-027000](#)