

THIS DRAWING IS UNPUBLISHED. RELEASED FOR PUBLICATION  
 © COPYRIGHT - By - ALL RIGHTS RESERVED.

| REVISIONS |     |                           |           |         |
|-----------|-----|---------------------------|-----------|---------|
| P         | LTR | DESCRIPTION               | DATE      | APVD    |
| F2        |     | REVISED PER ECR-17-014071 | 30DEC2017 | W.H D.Z |

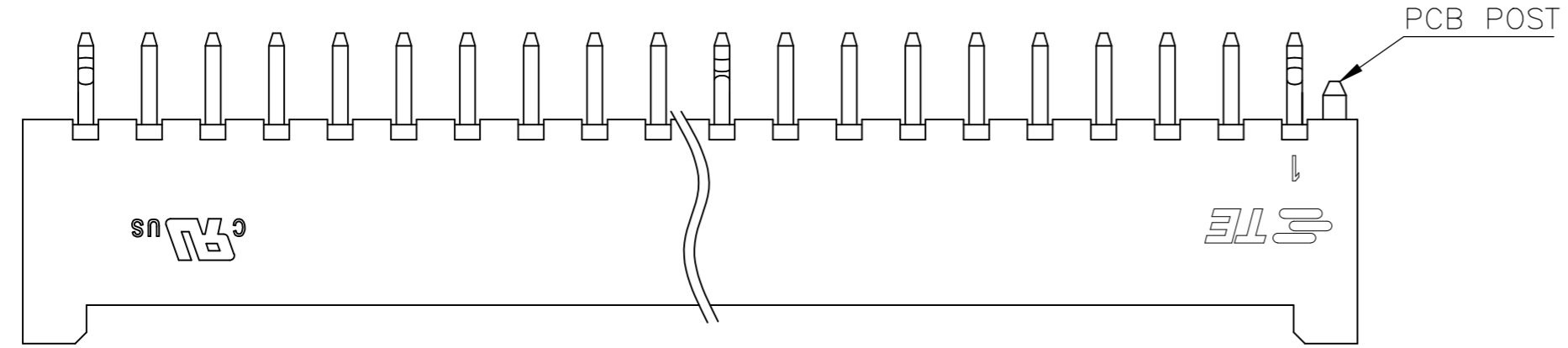

- 1 MATERIAL: HIGH PERFORMANCE RESIN, UL94 V0, COLOR: NATURAL.
- 2 CONTACT RETENTION: 12 NEWTON [2.7 lbf] MIN.
- 3 CONTACT SOLDERTAIL KINK DIRECTION SEE BELOW TABLE.

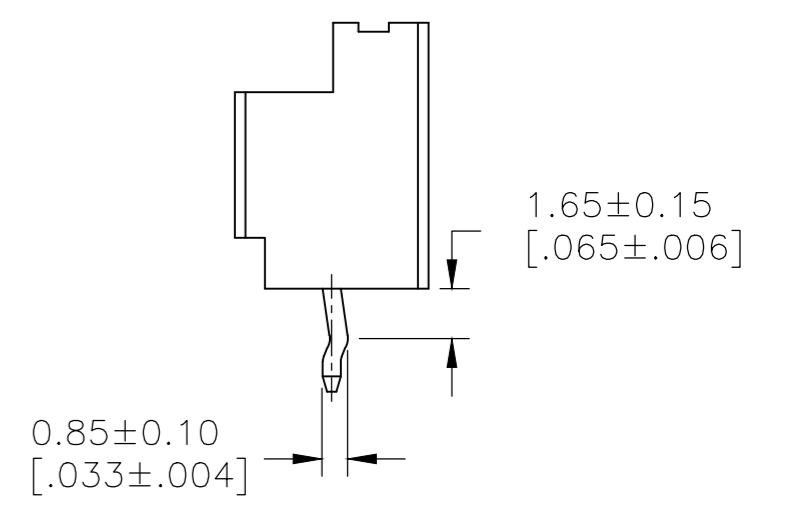
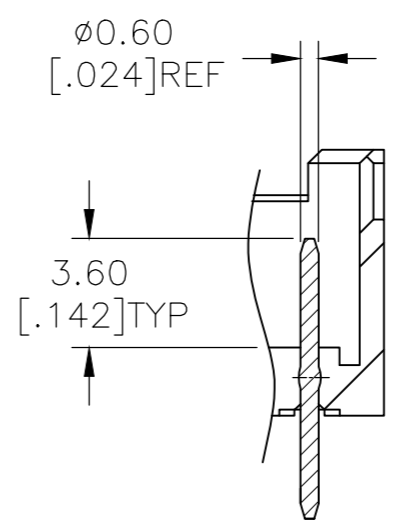
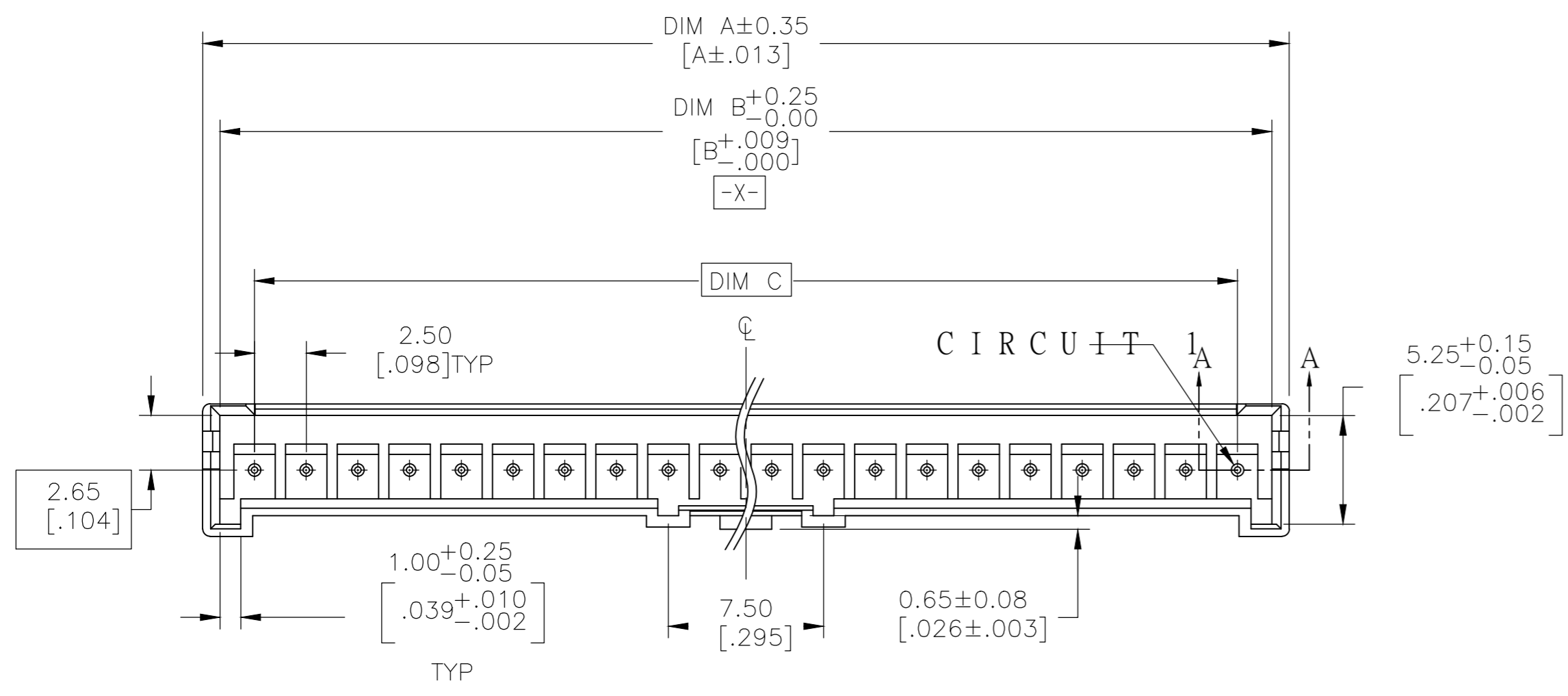

SECTION A - A

MIDDLE

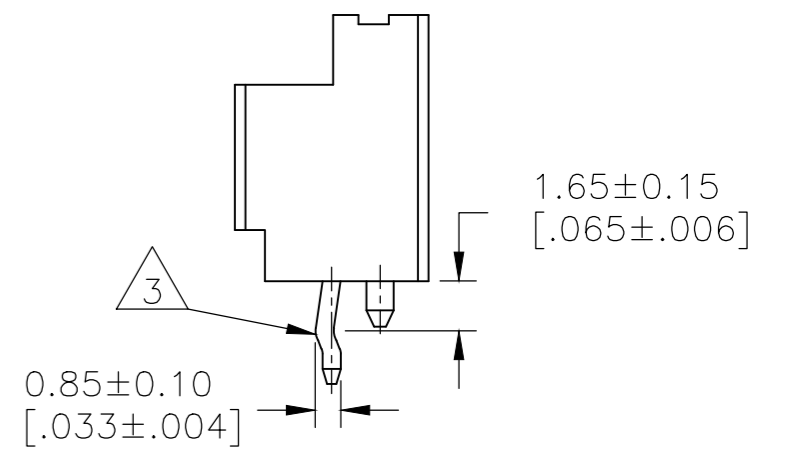
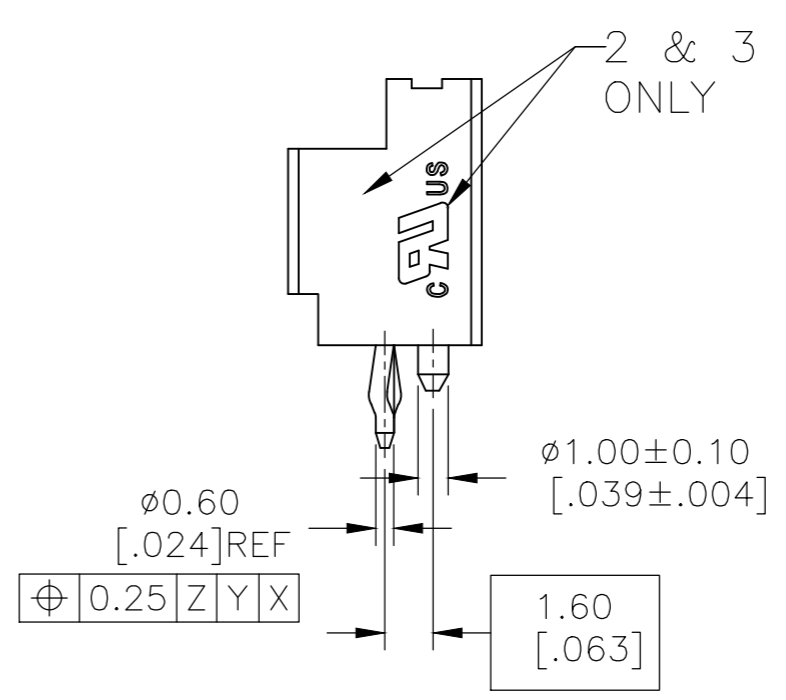
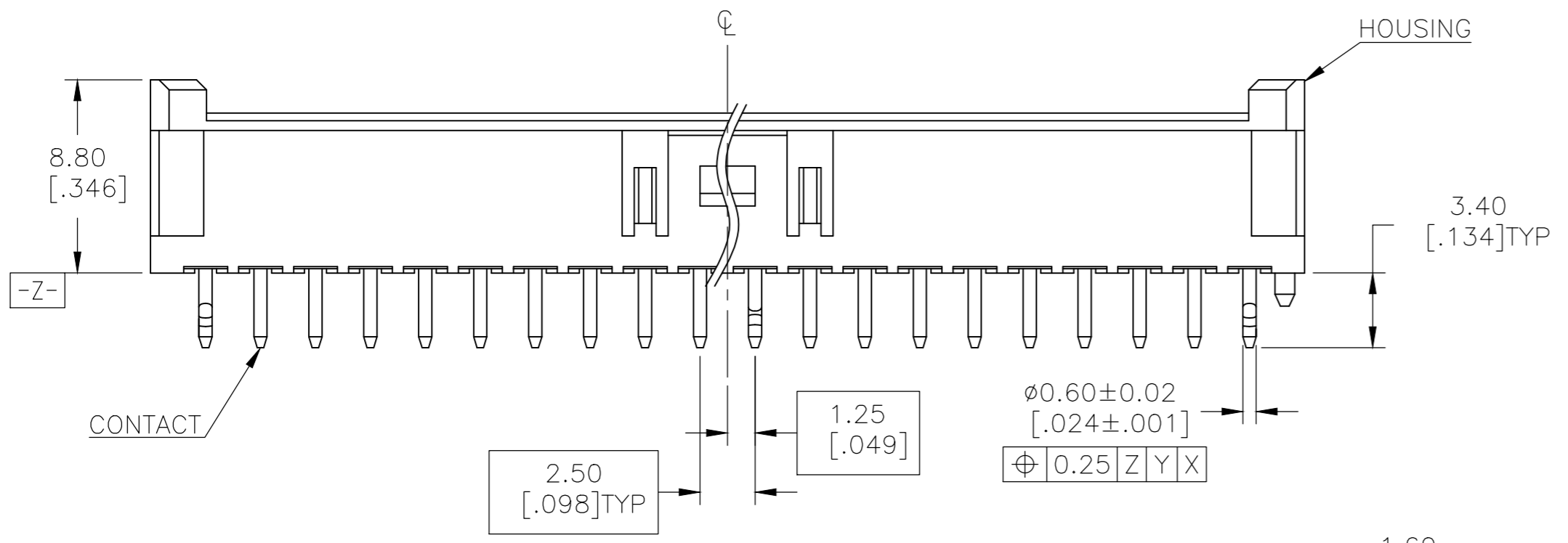

SIDE

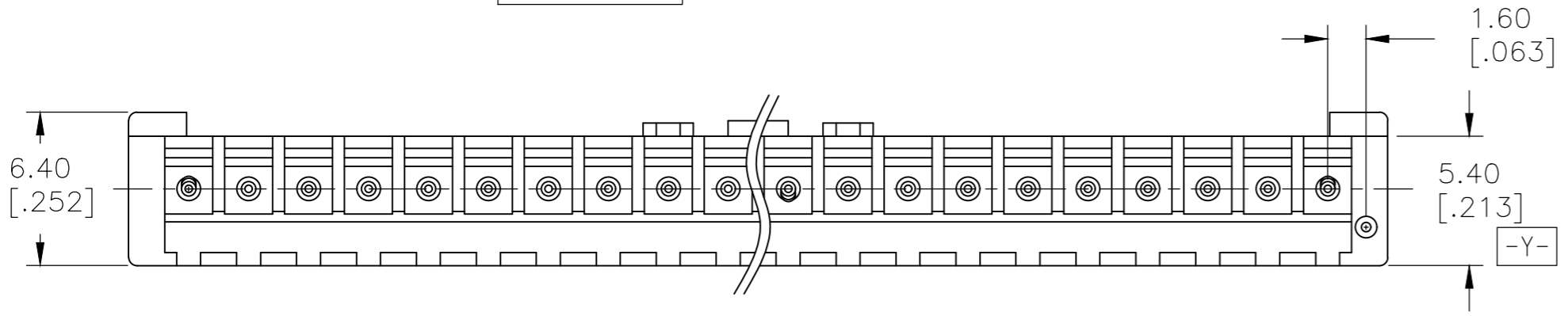

|  |              |                          |                      |                 |
|--|--------------|--------------------------|----------------------|-----------------|
| THIS DRAWING IS A CONTROLLED DOCUMENT. |              | DWN RAGHAVENDRA 06JAN11  |                      |                 |
| DIMENSIONS: mm [INCHES]                |              | CHK MACE SAMUEL 06JAN11  |                      |                 |
| TOLERANCES UNLESS OTHERWISE SPECIFIED: |              | APVD MACE SAMUEL 06JAN11 | NAME                 |                 |
| 0 PLC ± 0.50                           | 1 PLC ± 0.30 | PRODUCT SPEC             | 108-2418 2           |                 |
| 2 PLC ± 0.20                           | 3 PLC ± 0.10 | APPLICATION SPEC         | 114-13315            |                 |
| 4 PLC ± -                              | ANGLES ± 3°  | WEIGHT 0                 | SIZE A2              | CAGE CODE 00779 |
| MATERIAL -                             | FINISH -     | CUSTOMER DRAWING         | DRAWING NO C=2132230 | RESTRICTED TO - |
|  |              |                          | SCALE 1:1            | SHEET 1 OF 2    |
|  |              |                          | REV F2               |                 |

THIS DRAWING IS UNPUBLISHED. RELEASED FOR PUBLICATION  
 © COPYRIGHT - By - ALL RIGHTS RESERVED.

| REVISIONS |     |             |      |     |      |
|-----------|-----|-------------|------|-----|------|
| P         | LTR | DESCRIPTION | DATE | DWN | APVD |
| -         | -   | SEE SHEET 1 | -    | -   | -    |

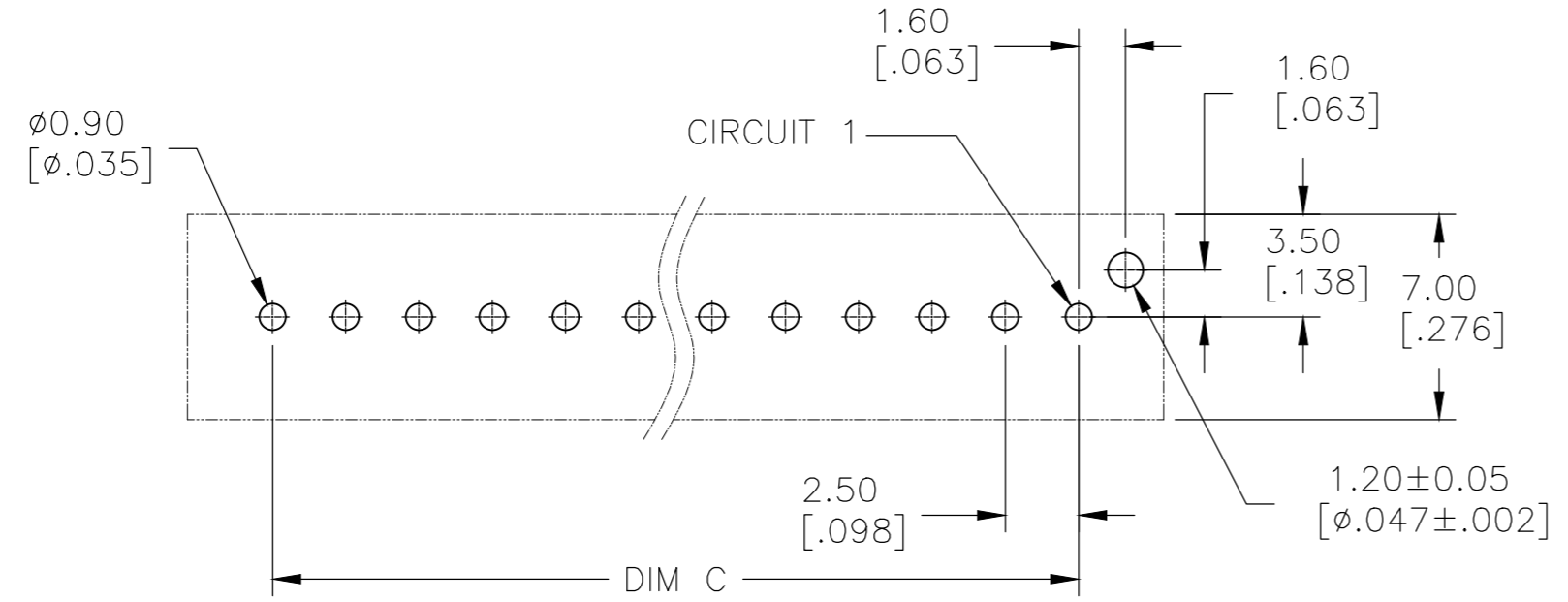
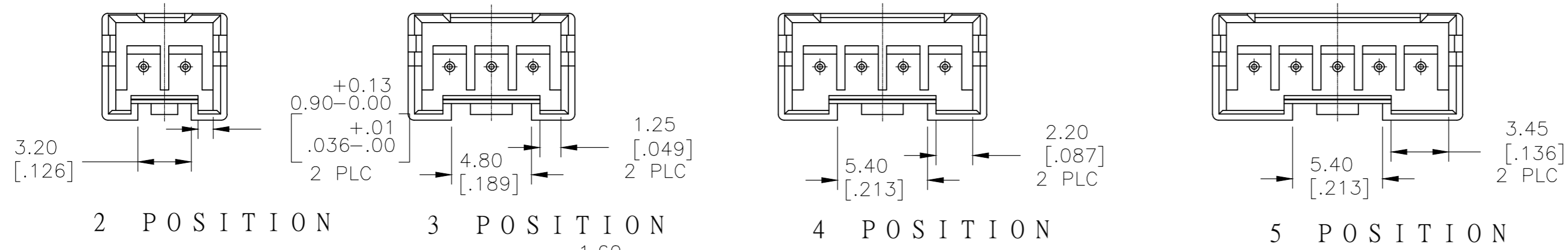

RECOMMENDED PCB LAYOUT

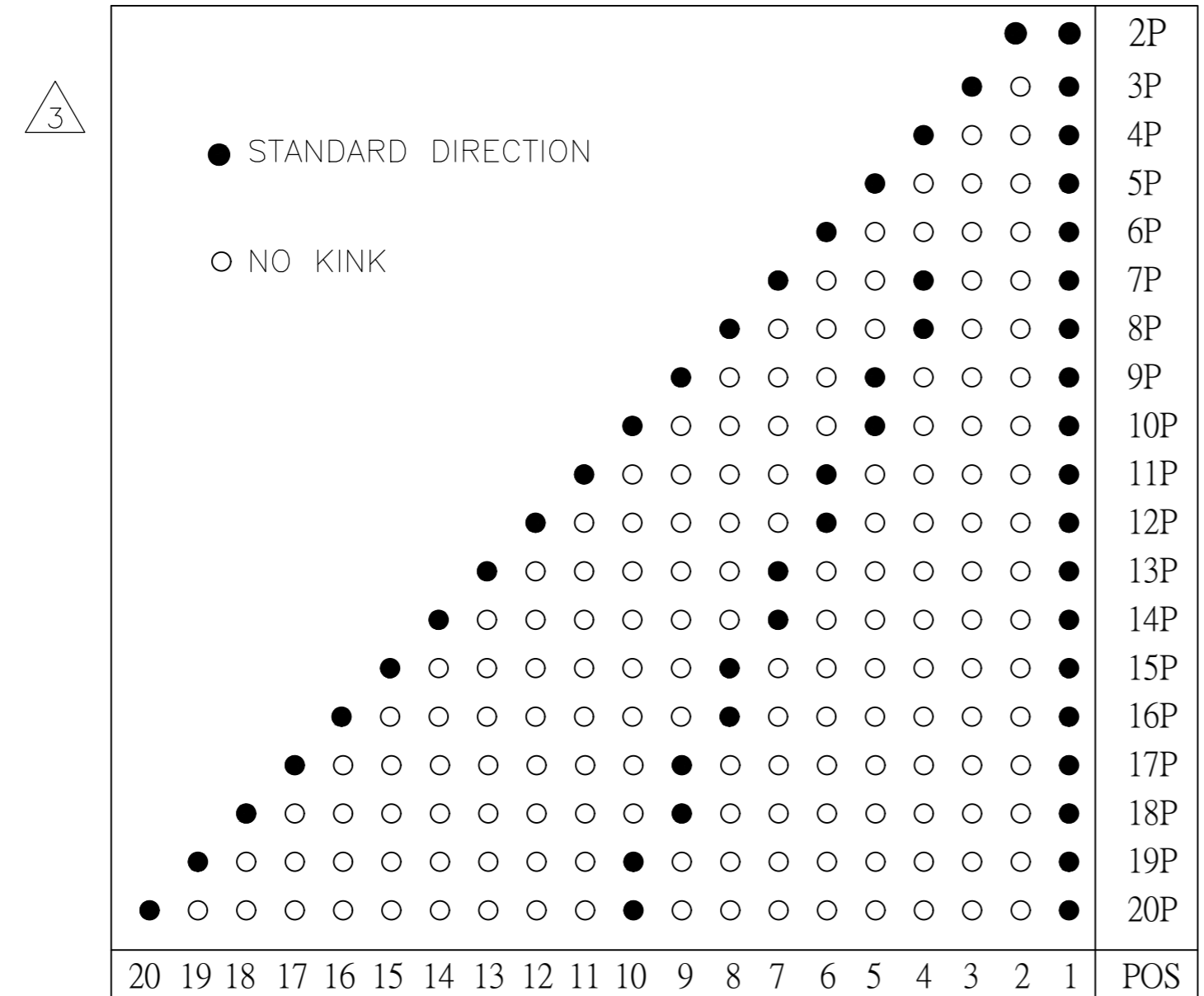

| DIM C        | DIM B         | DIM A        | POS | PART NO     |
|--------------|---------------|--------------|-----|-------------|
| 47.5 [1.870] | 50.83 [2.001] | 52.5 [2.067] | 20  | 2-2132230-0 |
| 45.0 [1.772] | 48.33 [1.903] | 50.0 [1.968] | 19  | 1-2132230-9 |
| 42.5 [1.673] | 45.83 [1.804] | 47.5 [1.870] | 18  | 1-2132230-8 |
| 40.0 [1.575] | 43.33 [1.706] | 45.0 [1.772] | 17  | 1-2132230-7 |
| 37.5 [1.476] | 40.83 [1.607] | 42.5 [1.673] | 16  | 1-2132230-6 |
| 35.0 [1.378] | 38.33 [1.510] | 40.0 [1.575] | 15  | 1-2132230-5 |
| 32.5 [1.280] | 35.83 [1.411] | 37.5 [1.476] | 14  | 1-2132230-4 |
| 30.0 [1.181] | 33.33 [1.312] | 35.0 [1.378] | 13  | 1-2132230-3 |
| 27.5 [1.083] | 30.83 [.214]  | 32.5 [1.280] | 12  | 1-2132230-2 |
| 25.0 [.984]  | 28.33 [.115]  | 30.0 [1.181] | 11  | 1-2132230-1 |
| 22.5 [.886]  | 25.83 [.167]  | 27.5 [1.083] | 10  | 1-2132230-0 |
| 20.0 [.787]  | 23.33 [.919]  | 25.0 [.984]  | 9   | 2132230-9   |
| 17.5 [.689]  | 20.83 [.820]  | 22.5 [.886]  | 8   | 2132230-8   |
| 15.0 [.591]  | 18.33 [.722]  | 20.0 [.787]  | 7   | 2132230-7   |
| 12.5 [.492]  | 15.83 [.623]  | 17.5 [.689]  | 6   | 2132230-6   |
| 10.0 [.394]  | 13.33 [.525]  | 15.0 [.591]  | 5   | 2132230-5   |
| 7.5 [.295]   | 10.83 [.426]  | 12.5 [.492]  | 4   | 2132230-4   |
| 5.0 [.197]   | 8.33 [.328]   | 10.0 [.394]  | 3   | 2132230-3   |
| 2.5 [.098]   | 5.83 [.229]   | 7.5 [.295]   | 2   | 2132230-2   |
| DIM C        | DIM B         | DIM A        | POS | PART NO     |

|  |  |                                |   |                         |
|--|--|--------------------------------|---|-------------------------|
| THIS DRAWING IS A CONTROLLED DOCUMENT.   |  | DWN<br>RAGHAVENDRA<br>06JAN11  | TE Connectivity   |                         |
| DIMENSIONS:<br>mm [INCHES]   |  | CHK<br>MACE SAMUEL<br>06JAN11  |   |                         |
| TOLERANCES UNLESS OTHERWISE SPECIFIED:   |  | APVD<br>MACE SAMUEL<br>06JAN11 | NAME<br>HEADER ASSEMBLY, VERTICAL, ECONOMY POWER,<br>2.5mm CENTERLINE |                         |
| 0 PLC ± 0.50<br>1 PLC ± 0.30<br>2 PLC ± 0.20<br>3 PLC ± 0.10<br>4 PLC ± .<br>ANGLES ± 3° |  | PRODUCT SPEC<br>108-2418       | SIZE<br>A2  |                         |
| MATERIAL   |  | APPLICATION SPEC<br>114-13315  | CAGE CODE<br>00779  | DRAWING NO<br>C=2132230 |
| FINISH   |  | WEIGHT                         | RESTRICTED TO   |                         |
|  |  | CUSTOMER DRAWING               | SCALE<br>1:1  | SHEET<br>2 OF 2         |
|  |  |                                | REV<br>F1   |                         |

# Mouser Electronics

Authorized Distributor

Click to View Pricing, Inventory, Delivery & Lifecycle Information:

[TE Connectivity:](#)

[2132230-6](#)