

LOC		DIST		REVISIONS			
P	LTR	DESCRIPTION	DATE	DWN	APVD		
H2		REVISED PER ECR-17-018200	09JAN2018	BDA	SG		

- 1 MATERIAL: CONNECTOR - NYLON UL94-V2 (ORANGE).
 CONTACTS - 0.30[.012] THICK COPPER ALLOY
 (BRIGHT TIN-LEAD 0.00203[.000080] MIN. THICK
 FOR CONTACTS 641522-2 THRU 2-641522-4).
 (MATTE TIN PLATE 0.00203[.000080] MIN. THICK
 FOR CONTACTS 3-641522-2 THRU 5-641522-4).
- 2 CONTACTS ACCEPT #18 AWG SOLID, FUSED STRANDED OR
 STRANDED (7 STRANDS) WIRE WITH 2.41 [.095] MAX
 INSULATION DIA.
- 3 BOW, IN ANY DIRECTION, NOT TO EXCEED 0.15 [.006] PER IN.
- 4 HOUSING FEATURES: FEED-THRU.
- 5 DIMENSIONS IN BRACKETS ARE IN INCHES.
- 6 OBSOLETE PARTS: OBSOLETE CIS STREAMLINING PER D.RENAUD/D.SINISI
- 7 OBSOLETE PARTS

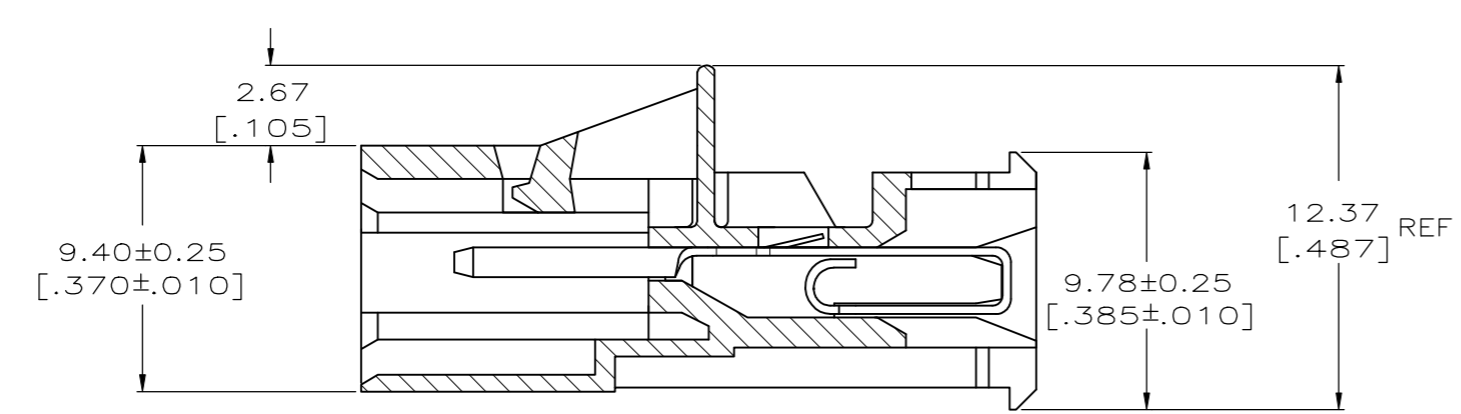
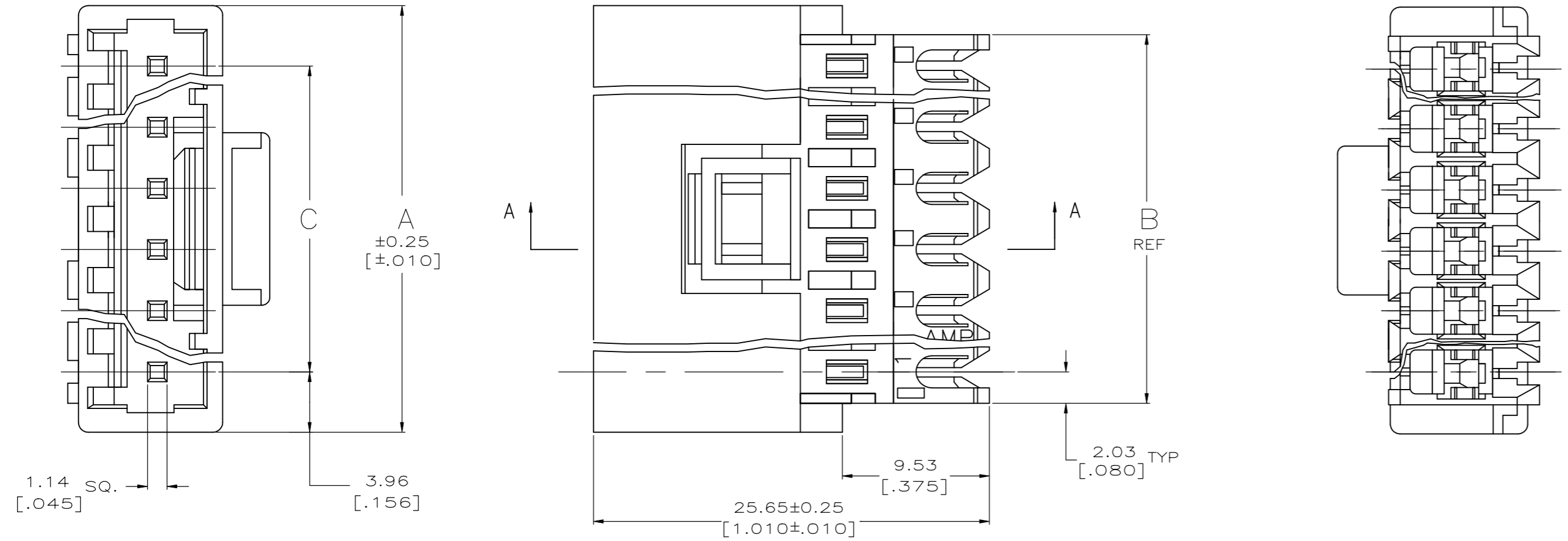

FINISH	C	B	A	NO. OF CIRCUITS	PART NO.
TIN	91.14 [3.588]	95.20 [3.748]	99.06 [3.900]	24	5-641522-4
	55.47 [2.184]	59.54 [2.344]	63.40 [2.496]	15	4-641522-5
	43.59 [1.716]	47.65 [1.876]	51.51 [2.028]	12	4-641522-2
	31.70 [1.248]	35.76 [1.408]	39.62 [1.560]	9	3-641522-9
	19.81 [.780]	23.88 [.940]	27.74 [1.092]	6	3-641522-6
	11.89 [.468]	15.95 [.628]	19.81 [.780]	4	3-641522-4
	7.92 [.312]	11.99 [.472]	15.85 [.624]	3	3-641522-3
	3.96 [.156]	8.03 [.316]	11.89 [.468]	2	3-641522-2
6 SUPERSEDED	91.14 [3.588]	95.20 [3.748]	99.06 [3.900]	24	2-641522-4
6 SUPERSEDED	55.47 [2.184]	59.54 [2.344]	63.40 [2.496]	15	1-641522-5
6 SUPERSEDED	43.59 [1.716]	47.65 [1.876]	51.51 [2.028]	12	1-641522-2
6 SUPERSEDED	31.70 [1.248]	35.76 [1.408]	39.62 [1.560]	9	-641522-9
6 SUPERSEDED	19.81 [.780]	23.88 [.940]	27.74 [1.092]	6	-641522-6
6 SUPERSEDED	11.89 [.468]	15.95 [.628]	19.81 [.780]	4	-641522-4
6 SUPERSEDED	7.92 [.312]	11.99 [.472]	15.85 [.624]	3	-641522-3
6 SUPERSEDED	3.96 [.156]	8.03 [.316]	11.89 [.468]	2	-641522-2
TIN-LEAD	91.14 [3.588]	95.20 [3.748]	99.06 [3.900]	24	5-641522-4
	55.47 [2.184]	59.54 [2.344]	63.40 [2.496]	15	4-641522-5
	43.59 [1.716]	47.65 [1.876]	51.51 [2.028]	12	4-641522-2
	31.70 [1.248]	35.76 [1.408]	39.62 [1.560]	9	3-641522-9
	19.81 [.780]	23.88 [.940]	27.74 [1.092]	6	3-641522-6
	11.89 [.468]	15.95 [.628]	19.81 [.780]	4	3-641522-4
	7.92 [.312]	11.99 [.472]	15.85 [.624]	3	3-641522-3
	3.96 [.156]	8.03 [.316]	11.89 [.468]	2	3-641522-2

THIS DRAWING IS A CONTROLLED DOCUMENT.

DIMENSIONS: mm [INCHES]

TOLERANCES UNLESS OTHERWISE SPECIFIED:

0 PLC	± -
1 PLC	± -
2 PLC	± 0.13 [005]
3 PLC	± -
4 PLC	± -
ANGLES	± 0°30'

MATERIAL: - FINISH: -

TE Connectivity
 MTA-156,
 POSTED CONNECTOR ASSEMBLY,
 18 AWG

SIZE: A1 CAGE CODE: 00779 DRAWING NO: 641522

CUSTOMER DRAWING SCALE: 5:1 SHEET 1 OF 1 REV: H2

Mouser Electronics

Authorized Distributor

Click to View Pricing, Inventory, Delivery & Lifecycle Information:

[TE Connectivity:](#)

[641522-2](#)