

SECTION A-A

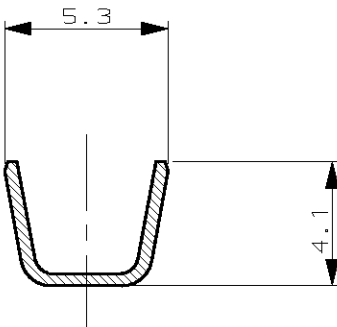

SECTION B-B

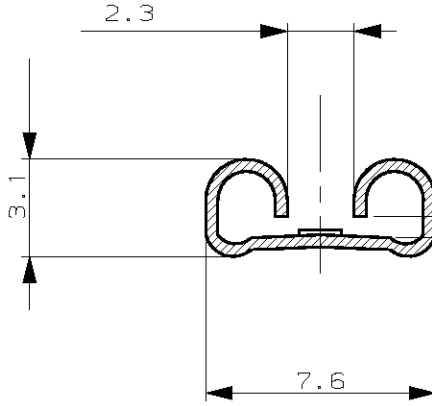

SECTION C-C

ADATTO PER LINGUETTA SPESS. 0.8
(FIT FOR TAB THK 0.8)

- 1 NON DISPONIBILE DALL' AMP ITALIA
(NOT AVAILABLE FROM AMP ITALIA)
- 2 ADATTO PER AMP-O-MATOR
(REVERSE REELED FOR MINI APPLICATOR)
- 3 BOBINA IN CARTONE CON CARTA INTERPOSTA
QUANTITA' PER BOBINA: 3000
(CARTON REEL WITH INTERPOSED PAPER STRIP
Q.TY PER REEL: 3000)
- 4 CON SPECIALE RIVESTIMENTO IN CARTA
(WITH SPECIAL PAPER COVER)
- 5 BOBINA IN CARTONE CON CARTA INTERPOSTA
QUANTITA' PER BOBINA: 2500
(CARTON REEL WITH INTERPOSED PAPER STRIP
Q.TY PER REEL: 2500)
- 6 OBSOLETE
- 7 BOBINA IN CARTONE
QUANTITA' PER BOBINA: 7000
(CARTON REEL
Q.TY PER REEL: 7000)

1	ST. (TIN PLTD)	BR. F. (PH. BR.)	4-280050-7	BC
1	- (UNPLTD)	BR. F. (PH. BR.)	4-280050-4	BC
1	ST. (TIN PLTD)	OTTONE (BRASS)	4-280050-2	BC
1	- (UNPLTD)	OTTONE (BRASS)	4-280050-1	BC
1	- (UNPLTD)	BR. F. (PH. BR.)	2-280050-4	BB
1	NICKELATO (NICKEL PLTD)	ACCIAIO (STEEL)	2-280050-3	BB
1	ST. (TIN PLTD)	OTTONE (BRASS)	2-280050-2	BB
1	- (UNPLTD)	OTTONE (BRASS)	2-280050-1	BB
1	NICKELATO (NICKEL PLTD)	ACCIAIO (STEEL)	1-280050-3	BB
1	ST. (TIN PLTD)	OTTONE (BRASS)	1-280050-2	BB
1	ST. (TIN PLTD)	BR. F. (PH. BR.)	280050-7	BB
1	- (UNPLTD)	BR. F. (PH. BR.)	280050-4	BB
1	NICKELATO (NICKEL PLTD)	ACCIAIO (STEEL)	280050-3	BB
1	ST. (TIN PLTD)	OTTONE (BRASS)	280050-2	BB
1	- (UNPLTD)	OTTONE (BRASS)	280050-1	BB
1	ST. (TIN PLTD)	BR. F. (PH. BR.)	180388-5	BB
1	ST. (TIN PLTD)	OTTONE (BRASS)	180388-2	BB
1	- (UNPLTD)	OTTONE (BRASS)	180388-1	BB
NOTE	FINITURA (FINISH)	MATERIALE (MATERIAL)	NUMERO (P/N)	REV

				CUSTOMER DWG. FOR REFERENCE ONLY		DISEGNO PER CLIENTE SOLO PER RIFERIMENTO		
				THIS DRAWING IS UNPUBLISHED		RELEASE FOR PUBLICATION		19
				© COPYRIGHT 19 BY AMP INCORPORATED, HARRISBURG, PA. ALL INTERNATIONAL RIGHT RESERVED. AMP PRODUCTS MAY BE COVERED BY U.S. AND FOREIGN PATENT AND/OR PATENT PENDING				
BD	UNIFY CUST. TO PROD. DWG REV ET00-0039-04	H. Y.	24 FEB 2004	TOLLERANZE: SE NON DIVERSAMENTE SPECIFICATO		DIAM. ISOLANTE (INS. DIA. RANGE)	RANGO FILO (WIRE RANGE)	SCALA (SCALE)
BC1	ADDED NEW P/N.s ET00-0207-02	H. Y.	08 OCT 2002	(TOLERANCES: UNLESS OTHERWISE SPECIFIED)		2.3-3.3	0.5-1.5	-
BC	OBSOLETE P/N 2-280050-2 ET00-0172-00	H. Y.	02 JUN 2000	± 0.3		<div>AMP</div> <div>AMP ITALIA S.p.A. Corso F.lli Cervi, 15 COLLEGNO (TORINO)</div>		
BB1	ADDED NOTE 5 ON PART 1-280050-2 ET00-0142-00	H. Y.	02 JUN 2000	ANGOLI (ANGLES)				
BB	OBSOLETE PARTS FOR ET00-0301-99	R. F.	08 MAR 2000	DIS. 28 APR 97 (DR.)		.250 SERIES FLAG FASTON REC.		
BA	P/N 2-280050-3 ADDED FOR ET00-0052-99	H. Y.	05 FEB 1999	A. FROLA				
AV	REDRAWN AND REVISED FOR ET00-0107-97	A. F.	07 FEB 1997	CONT. 29 APR 97 (CHK)		LOC. SIZE NUMERO (DWG NO)		
H	REVISED FOR ET00-0101-94	M. P.	28-3-94	G. TURCO				
REV. (REV. LTR.)	REVISIONI (REVISION RECORD)	DIS. (DR)	DATA (DATE)	APP. - (APP.)		I A3	C-180388	BD 1 01 (OF) 1

DISTRIBUZIONE
(PRINT DIST.)

Mouser Electronics

Authorized Distributor

Click to View Pricing, Inventory, Delivery & Lifecycle Information:

[TE Connectivity:](#)

[4-280050-2](#) [2-280050-1](#) [4-280050-1](#)