

2N3054  
2N3054A

SILICON  
NPN POWER TRANSISTORS



TO-66 CASE



www.centrasemi.com

**DESCRIPTION:**

The CENTRAL SEMICONDUCTOR 2N3054, 2N3054A devices are silicon NPN power transistors manufactured by the epitaxial base process, mounted in a hermetically sealed metal case, designed for general purpose amplifier and switching applications.

**MARKING: FULL PART NUMBER**

**MAXIMUM RATINGS:** ( $T_C=25^\circ\text{C}$ )

Collector-Base Voltage
Collector-Emitter Voltage
Collector-Emitter Voltage
Collector-Emitter Voltage
Emitter-Base Voltage
Continuous Collector Current
Continuous Base Current
Power Dissipation (2N3054)
Power Dissipation (2N3054A)
Operating and Storage Junction Temperature
Thermal Resistance (2N3054)
Thermal Resistance (2N3054A)

SYMBOL		UNITS
$V_{CBO}$	90	V
$V_{CEV}$	90	V
$V_{CER}$	60	V
$V_{CEO}$	55	V
$V_{EBO}$	7.0	V
$I_C$	4.0	A
$I_B$	2.0	A
$P_D$	25	W
$P_D$	75	W
$T_J, T_{stg}$	-65 to +200	$^\circ\text{C}$
$\theta_{JC}$	7.0	$^\circ\text{C/W}$
$\theta_{JC}$	2.33	$^\circ\text{C/W}$

**ELECTRICAL CHARACTERISTICS:** ( $T_C=25^\circ\text{C}$  unless otherwise noted)

SYMBOL	TEST CONDITIONS	MIN	MAX	UNITS
$I_{CEV}$	$V_{CE}=90\text{V}, V_{EB}=1.5\text{V}$		1.0	mA
$I_{CEV}$	$V_{CE}=90\text{V}, V_{EB}=1.5\text{V}, T_C=150^\circ\text{C}$		6.0	mA
$I_{CEO}$	$V_{CE}=30\text{V}$		500	$\mu\text{A}$
$I_{EBO}$	$V_{EB}=7.0\text{V}$		1.0	mA
$BV_{CEO}$	$I_C=100\text{mA}$	55		V
$BV_{CER}$	$I_C=100\text{mA}, R_{BE}=100\Omega$	60		V
$V_{CE(SAT)}$	$I_C=500\text{mA}, I_B=50\text{mA}$		1.0	V
$V_{CE(SAT)}$	$I_C=3.0\text{A}, I_B=1.0\text{A}$		6.0	V
$V_{BE(ON)}$	$V_{CE}=4.0\text{V}, I_C=500\text{mA}$		1.7	V
$h_{FE}$	$V_{CE}=4.0\text{V}, I_C=500\text{mA}$	25	150	
$h_{FE}$	$V_{CE}=4.0\text{V}, I_C=3.0\text{A}$	5.0		
$h_{fe}$	$V_{CE}=4.0\text{V}, I_C=100\text{mA}, f=1.0\text{kHz}$	25	180	
$f_T$	$V_{CE}=10\text{V}, I_C=200\text{mA}, f=1.0\text{MHz}$	3.0		MHz
$f_{hfe}$	$V_{CE}=4.0\text{V}, I_C=100\text{mA}$	30		kHz

R2 (2-September 2014)

**2N3054**  
**2N3054A**  
  
**SILICON**  
**NPN POWER TRANSISTORS**



**TO-66 CASE - MECHANICAL OUTLINE**

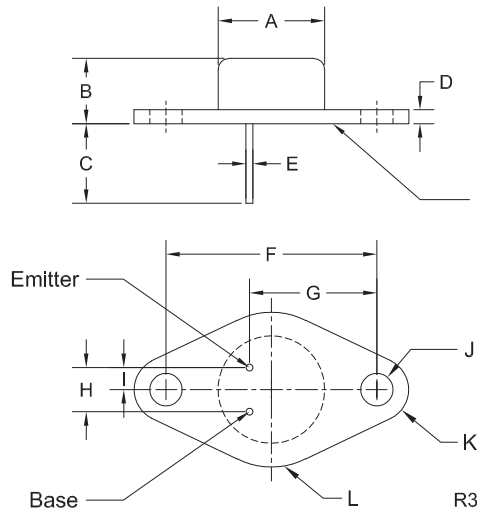

Seating Plane:  
 The seating plane must be within 0.001" concave to 0.004" convex within 0.600" diameter from the center of the device.

**MARKING:**  
**FULL PART NUMBER**

<b>DIMENSIONS</b>				
SYMBOL	INCHES		MILLIMETERS	
	MIN	MAX	MIN	MAX
A (DIA)	0.470	0.500	11.94	12.70
B	0.250	0.340	6.35	8.64
C	0.360	-	9.14	-
D	0.050	0.075	1.27	1.91
E (DIA)	0.028	0.034	0.71	0.86
F	0.956	0.964	24.28	24.48
G	0.570	0.590	14.48	14.99
H	0.190	0.210	4.83	5.33
I	0.093	0.107	2.36	2.72
J (DIA)	0.142	0.152	3.61	3.86
K (RAD)	0.141		3.58	
L (RAD)	0.345		8.76	

TO-66 (REV:R3)

R2 (2-September 2014)

## OUTSTANDING SUPPORT AND SUPERIOR SERVICES



---

### PRODUCT SUPPORT

Central's operations team provides the highest level of support to insure product is delivered on-time.

- Supply management (Customer portals)
- Inventory bonding
- Consolidated shipping options
- Custom bar coding for shipments
- Custom product packing

---

### DESIGNER SUPPORT/SERVICES

Central's applications engineering team is ready to discuss your design challenges. Just ask.

- Free quick ship samples (2<sup>nd</sup> day air)
- Online technical data and parametric search
- SPICE models
- Custom electrical curves
- Environmental regulation compliance
- Customer specific screening
- Up-screening capabilities
- Special wafer diffusions
- PbSn plating options
- Package details
- Application notes
- Application and design sample kits
- Custom product and package development

---

### REQUESTING PRODUCT PLATING

1. If requesting Tin/Lead plated devices, add the suffix " TIN/LEAD" to the part number when ordering (example: 2N2222A TIN/LEAD).
2. If requesting Lead (Pb) Free plated devices, add the suffix " PBFREE" to the part number when ordering (example: 2N2222A PBFREE).

---

### CONTACT US

#### Corporate Headquarters & Customer Support Team

Central Semiconductor Corp.  
145 Adams Avenue  
Hauppauge, NY 11788 USA  
Main Tel: (631) 435-1110  
Main Fax: (631) 435-1824  
Support Team Fax: (631) 435-3388  
[www.centrasemi.com](http://www.centrasemi.com)

**Worldwide Field Representatives:**  
[www.centrasemi.com/wwreps](http://www.centrasemi.com/wwreps)

**Worldwide Distributors:**  
[www.centrasemi.com/wwdistributors](http://www.centrasemi.com/wwdistributors)

---

For the latest version of Central Semiconductor's **LIMITATIONS AND DAMAGES DISCLAIMER**, which is part of Central's Standard Terms and Conditions of sale, visit: [www.centrasemi.com/terms](http://www.centrasemi.com/terms)

# Mouser Electronics

Authorized Distributor

Click to View Pricing, Inventory, Delivery & Lifecycle Information:

[Central Semiconductor:](#)

[2N3054](#) [2N3054A](#)