



# AP Series Industrial Pushbutton Switch

Pushbutton A

## Features/Benefits

- IP67 sealed
- 1,000,000 life cycle
- Illumination / non-illumination
- Multiple colored caps
- Threaded or snap-in mounting
- Caps available separately
- RoHS compliant

## Typical Applications

- Harsh environments
- Off-Road
- Industrial
- Medical
- Transportation
- Joystick control modules
- Gaming
- Military



## Specifications

FUNCTION: SPST Momentary  
 CONTACT ARRANGEMENT: N.O.  
 MOUNTING TYPE:  
 Snap-in (no panel seal)  
 Threaded body (hex nut, lock washer, and panel seal gasket provided)  
 Torque spec for threaded body: Do not exceed 8-9 in-lbs (0.9-1.0 N.m)

## Mechanical

OPERATING LIFE: 1,000,000 cycles  
 TOTAL TRAVEL: 2.1 ± 0.2 mm  
 OPERATING POINT 1.55 ± 0.25 mm  
 OVER TRAVEL: 0.6 min.  
 OPERATING FORCE: 4N ± 1N standard configuration; other force option 2N ± 0.5N  
 VIBRATION: 10-500 Hz 10g Max  
 SHOCK: 60g 11ms sawtooth wave

## Electrical

CONTACT RATING:  
 200mA @ 24 V DC resistive (500,000 cycles)  
 100mA @ 50 V DC resistive (500,000 cycles)  
 400mA @ 32 V AC resistive (500,000 cycles)  
 125mA @ 125 V AC resistive (1,000,000 cycles)  
 DIELECTRIC STRENGTH: 1000 V AC min.  
 INSULATION RESISTANCE: 1 G Ω @ 500 VDC  
 INITIAL CONTACT RESISTANCE 50 mΩ max (without wire leads)  
 BOUNCE TIME: <5 ms

## Materials

HOUSING: PBT  
 BASE: PBT  
 CAP: PBT  
 ACTUATOR:  
 Illuminated: Clear polycarbonate  
 Non-illuminated: PBT  
 INTERNAL SEAL: Silicone rubber  
 TERMINALS: Copper alloy, gold over silver plating  
 MOVABLE CONTACT: Copper alloy, gold over silver plating  
 TERMINAL SEAL: Epoxy  
 WIRE LEADS: UL1569 Black 22 AWG

## Operating Environment

OPERATING TEMPERATURE: -40°C to 85°C (+105°C non-illuminated)  
 ESD PROTECTION: 20 KV min.

## Process Environment

SEALING: IP67 for threaded body  
 IP65 for snap-in version (no panel seal)

**NOTE:** Specifications and materials listed above are for switches with standard options. For information on specific and custom switches, please contact Customer Service.

## Build-A-Switch

To order, simply select desired option from each category and place in the appropriate box.

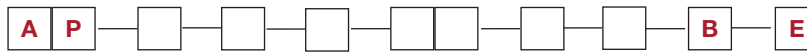

Designation \_\_\_\_\_

**AP** AP Series

Operating Force \_\_\_\_\_

**2** 2 Newtons  
**4** 4 Newtons

Actuator Style \_\_\_\_\_

**D** Dome / Convex  
**C** Concave  
**E** Extended Dome  
**N** None

Actuator Color \_\_\_\_\_

**0** No Cap  
**2** Black  
**3** Red  
**4** Orange  
**5** Yellow  
**6** Green  
**7** Blue  
**9** Gray

Illumination \_\_\_\_\_

**00** No LED\*  
**01** Super White  
**02** Bi-color; Red (Green)  
**03** Red  
**05** Amber  
**06** Green  
**07** Super Blue  
**08** Bi-color; Amber (Green)

Terminal Seal \_\_\_\_\_

**E** Epoxy  
 All models are epoxy sealed

Contact Material \_\_\_\_\_

**B** Gold

Termination \_\_\_\_\_

**Z** Solder Lug  
**W** 12" Wire Leads 22 AWG  
**C\*\*\*** PC Terminals

Bushing Style\*\* \_\_\_\_\_

**S\*\*** Snap-in plastic  
**T** Threaded plastic

\*\* No panel seal option

\*\*\* PC terminals not available with illumination

Contact Customer Service for additional hardware options.

Please contact Customer Service for additional colors and paint / laser etched button options.

\* No LED available in short body only



Specifications and dimensions subject to change

# AP Series Industrial Pushbutton Switch



A Pushbutton

## STANDARD VIEW

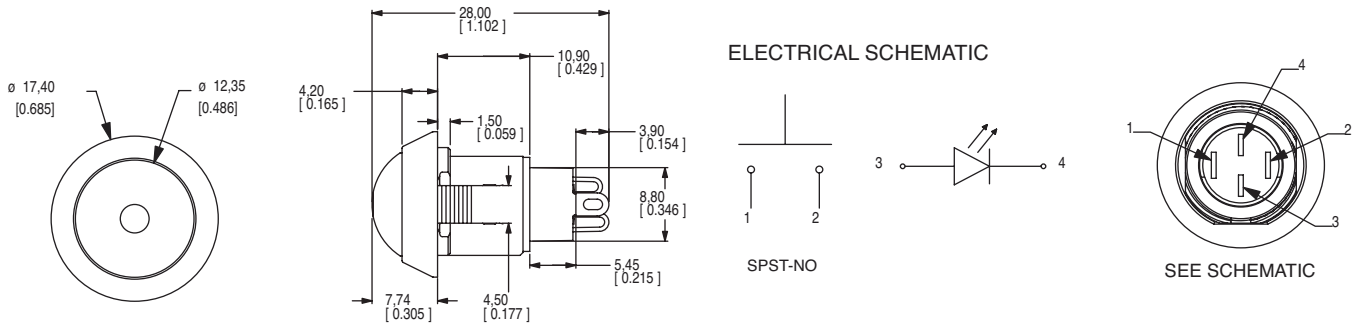

## OPERATING FORCE

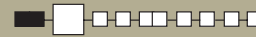

OPTION CODE	OPERATING FORCE
<b>2</b>	2 N, 200 g
<b>4</b>	4 N, 400 g

## ACTUATOR STYLE

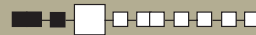

### D DOME / CONVEX

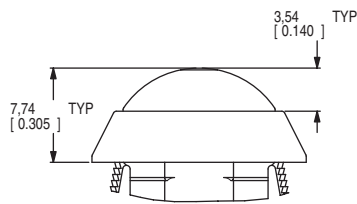

### E EXTENDED DOME

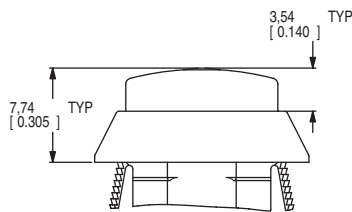

### C CONCAVE

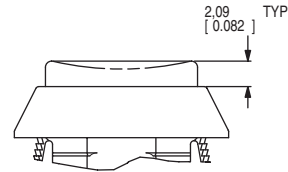
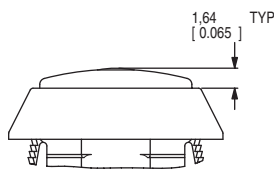
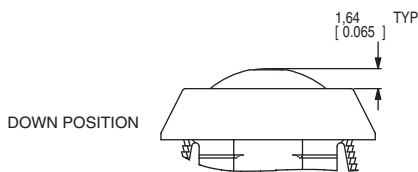
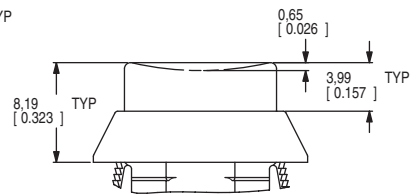

## ACTUATOR COLOR



OPTION CODE	ACTUATOR COLOR
<b>0</b>	No Cap
<b>2</b>	Black
<b>3</b>	Red
<b>4</b>	Orange
<b>5</b>	Yellow
<b>6</b>	Green
<b>7</b>	Blue
<b>9</b>	Gray

For additional colors please contact Customer Service.

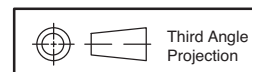



# AP Series Industrial Pushbutton Switch

A

Pushbutton

## ILLUMINATION

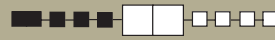

OPTION CODE	ILLUMINATION TYPE	TYPICAL INTENSITY*		PEAK WAVELENGTH	Vf Forward Voltage
		MIN	MAX		
		(mcd)		(nm)	
00	Model without illumination	N/A		N/A	
01	LED Super White	4,000	5,000	N/A	3.5
02	LED Bi-Color – Red (Green)	10	20	635/565	2.0
03	LED Red	4	8	700	2.0
05	LED Amber	35	50	610	2.0
06	LED Green	35	50	565	2.0
07	LED Super Blue	800	1,500	470	3.8
08	LED Bi-Color – Amber (Green)	10	10	585/565	2.0

\*LED FORWARD CURRENT: 20 mA  
 LED FORWARD VOLTAGE: see chart above  
 LED REVERSE VOLTAGE: 5.0 V MAX

\* For information on specific and custom LED, please contact Customer Service.

NOTE:

For bi-color LED's the polarity must be reversed to alternate the color

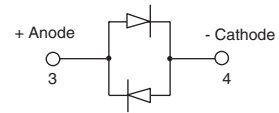

## BUSHING STYLE



### S SNAP-IN

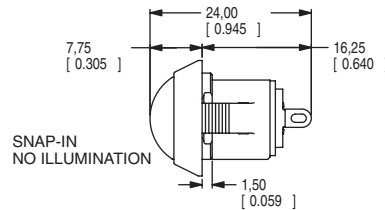
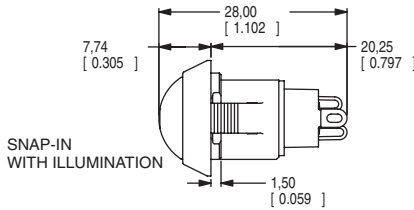

### T THREADED PLASTIC

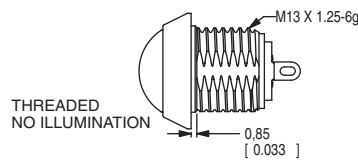
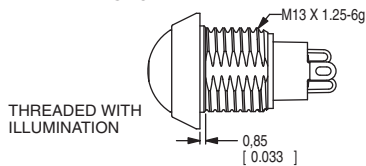

### PANEL CUTOUT

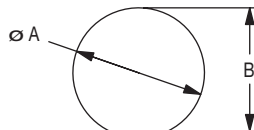

PANEL THICKNESS	DIM A (± 0.05 mm)	DIM B (± 0.05 mm)
1 mm [0.039 in]	13.70 mm [0.539 in]	13.00 mm [0.512 in]
2 mm [0.079 in]	13.80 mm [0.539 in]	13.00 mm [0.512 in]
3 mm [0.118 in]	13.90 mm [0.547 in]	13.10 mm [0.516 in]
THREADED BODY MIN PANEL THICKNESS 1 mm	13.70 mm [0.539 in]	13.00 mm [0.512 in]



A 0.1mm min. chamfer on the leading edge of the mounting hole is recommended for snap-in version.

are shown: mm (inches)  
 sions subject to change

ckswitches.com



### TERMINATION



#### Z SOLDER LUG

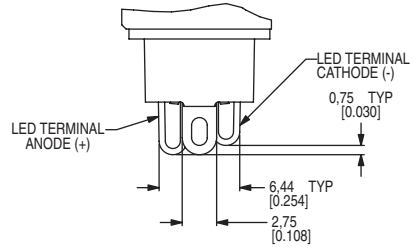
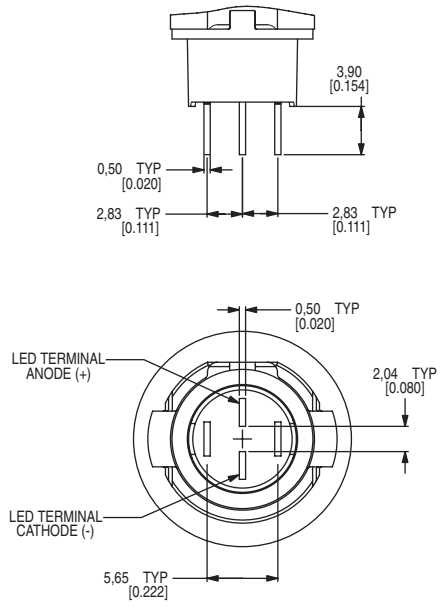

\* Switching terminals are gold and LED terminals are silver

#### C PC TERMINALS

\*\*\* Illumination not available with PC Terminals

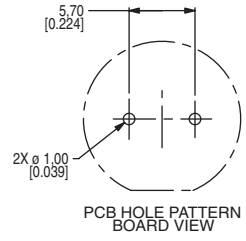
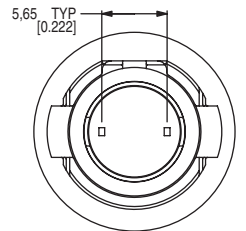
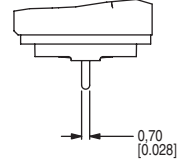
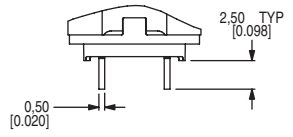

#### W 12" WIRE LEADS 22 AWG

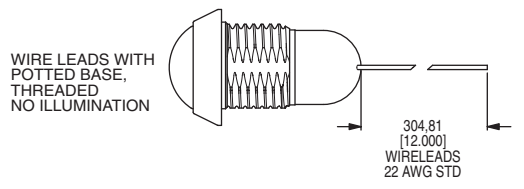
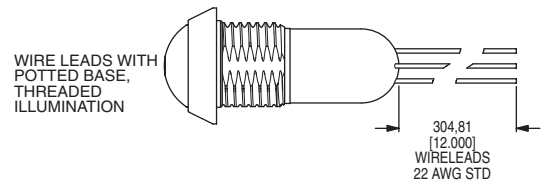
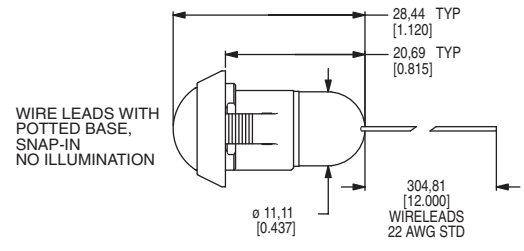
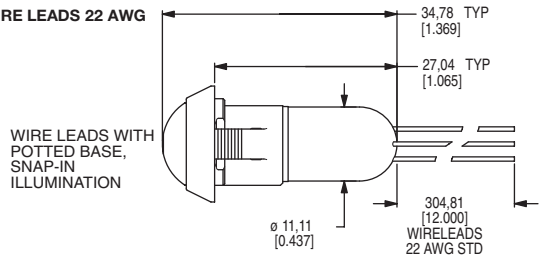

Wires: Black wires - Terminals  
 Red wires - LED (+) Positive  
 White wire - LED (-) Negative

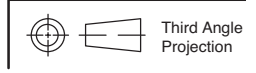

Dimensions are shown: mm (inches)  
 Specifications and dimensions subject to change



# AP Series Industrial Pushbutton Switch

Pushbutton  
A

## CONTACT MATERIAL



**B** GOLD

OPTION CODE	CONTACT MATERIAL
<b>B</b>	Gold

## TERMINAL SEAL



**E** EPOXY

All models are epoxy sealed

## HARDWARE

### LOCK WASHER

Part Number 647D00000

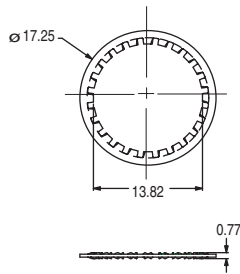

### HEX NUT

Part number 515D00000

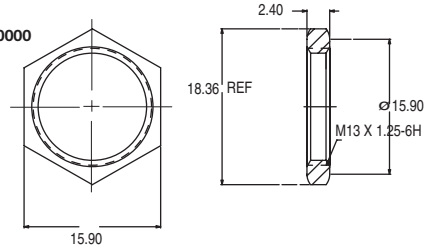

### PANEL SEAL

Part Number 655D00000

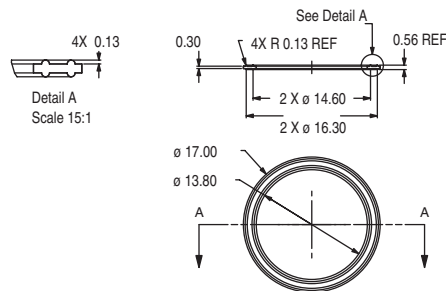

Caps available on next page



Third Angle  
Projection



### AVAILABLE CAPS

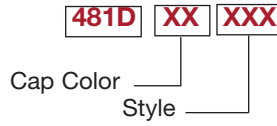

OPTION	CAP COLOR
01	WHITE
02	BLACK
03	RED
04	ORANGE
05	YELLOW
06	GREEN
07	BLUE
08	BROWN
09	GRAY

PART NUMBER	HOLE	STYLE
481DXX000	NO	DOME
481DXX001	YES	DOME
481DXX002	NO	EXTENDED DOME
481DXX003	YES	EXTENDED DOME
481DXX004	NO	CONCAVE
481DXX005	YES	CONCAVE

#### DOME

481DXX000 = NO HOLE  
481DXX001 = HOLE

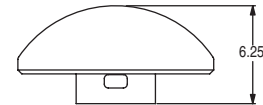
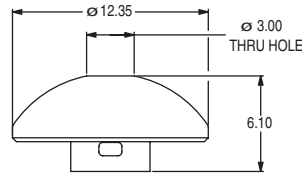

#### EXTENDED DOME

481DXX002 = NO HOLE  
481DXX003 = HOLE

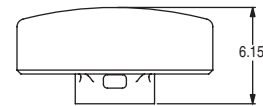
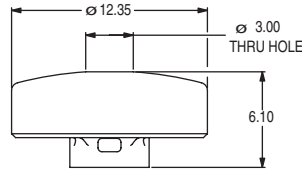

#### CONCAVE

481DXX004 = NO HOLE  
481DXX005 = HOLE

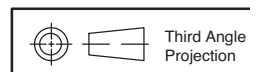
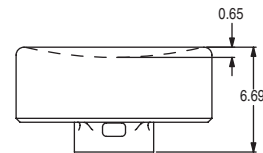
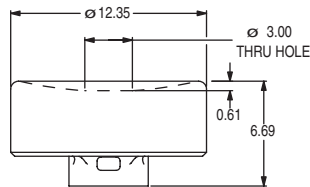

Dimensions are shown: mm (inches)  
Specifications and dimensions subject to change

# Mouser Electronics

Authorized Distributor

Click to View Pricing, Inventory, Delivery & Lifecycle Information:

## C&K Switches:

[AP4D200SZBE](#) [AP4D207SZBE](#) [AP4N007SZBE](#) [AP4D200SWBE](#) [AP4N000SWBE](#) [AP4D300SZBE](#) [AP4E300SZBE](#)  
[AP4C300SZBE](#) [AP4D202SZBE](#) [AP4E202SZBE](#) [AP4N002SZBE](#) [AP4N003SZBE](#) [AP4N006SZBE](#) [AP4D200TZBE](#)  
[AP4D207TZBE](#) [AP4N007TZBE](#) [AP4D200TWBE](#) [AP4N000TWBE](#) [AP4D300TZBE](#) [AP4E300TZBE](#) [AP4C300TZBE](#)  
[AP4D202TZBE](#) [AP4E202TZBE](#) [AP4N002TZBE](#) [AP4N003TZBE](#) [AP4N006TZBE](#) [AP2D200SZBE](#) [AP2D207SZBE](#)  
[AP2N007SZBE](#) [AP2D200SWBE](#) [AP2D200TZBE](#) [AP2D207TZBE](#) [AP2N007TZBE](#) [AP2D200TWBE](#) [AP4E200SZBE](#)  
[AP4E207SZBE](#) [AP4N007SWBE](#) [AP4E200SWBE](#) [AP4N000SZBE](#) [AP4E200TZBE](#) [AP4E207TZBE](#) [AP4E200TWBE](#)  
[AP4N000TZBE](#) [AP2E200SZBE](#) [AP2E207SZBE](#) [AP2E200SWBE](#) [AP2D300SZBE](#) [AP2E300SZBE](#) [AP2C300SZBE](#)  
[AP2D202SZBE](#) [AP2E202SZBE](#) [AP2N002SZBE](#) [AP2N003SZBE](#) [AP2N006SZBE](#) [AP2E200TZBE](#) [AP2E207TZBE](#)  
[AP2E200TWBE](#) [AP2D300TZBE](#) [AP2E300TZBE](#) [AP2C300TZBE](#) [AP2D202TZBE](#) [AP2E202TZBE](#) [AP2N002TZBE](#)  
[AP2N003TZBE](#) [AP2N006TZBE](#) [481D02000](#) [481D03000](#) [481D04000](#) [481D05000](#) [481D06000](#) [481D02001](#)  
[481D03001](#) [481D04001](#) [481D05001](#) [481D06001](#) [481D02002](#) [481D03002](#) [481D04002](#) [481D05002](#) [481D06002](#)  
[481D02003](#) [481E03001](#) [481D04003](#) [481E05001](#) [481E06001](#) [481C02000](#) [481C03000](#) [481D04004](#) [481C05000](#)  
[481D06004](#) [481C02001](#) [481C03001](#) [481C04001](#) [481D05005](#) [481D06005](#) [AP2D203SZBE](#) [AP2D203TZBE](#)  
[AP2D206SZBE](#) [AP2D206TZBE](#) [AP4D203SZBE](#)