

REVISIONS				
SYM	ZONE	DESCRIPTION	DATE	APPRD.
C		PROPOSAL	NOV.22/06	L.CHAN

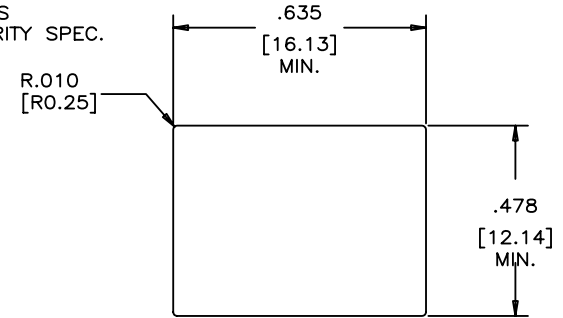

RECOMMENDED PANEL CUTOUT

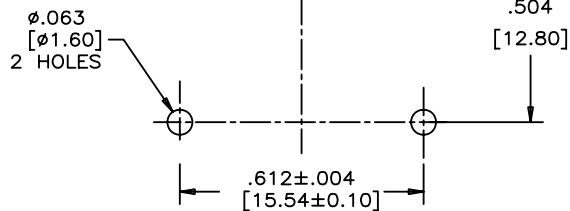
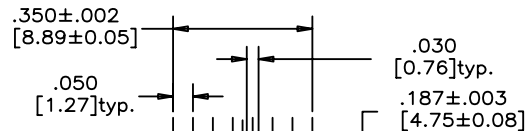
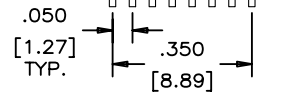
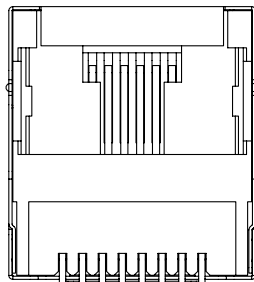

RECOMMENDED P.C.B. LAYOUT
(COMPONENT SIDE OF BOARD)



NOTES:

1. MATERIALS:

HOUSING: HIGH TEMPERATURE THERMOPLASTIC.
FLAMMABILITY RATING UL 94V-0
COLOUR: BLACK

CONTACTS: PHOSPHOR BRONZE
PLATING: GOLD PLATING (REFER TO PART NUMBER FOR THICKNESS)
ON MATING SURFACES.
50 μ" [1.27 MICRONS] MIN. NICKEL UNDERPLATE.
100 μ" [2.54 MICRONS] MIN. MATTE TIN ON CONTACT TAILS.

SHIELD: COPPER ALLOY, NICKEL PLATED

2. COPLANARITY SPECIFICATION:
THE MAXIMUM GAP BETWEEN ALL TERMINAL TAILS IS .004 [0.10].

3. RECOMMENDED SOLDERING TEMPERATURE:
WAVE OR REFLOW SOLDERING AT 260°C MAXIMUM FOR 5 SEC MAXIMUM.

AMPHENOL PART NO.: RJLSE-4X381-01

- GOLD PLATING
- 0 - GOLD FLASH
 - 1 - 15 MICRO" GOLD
 - 2 - 30 MICRO" GOLD
 - 3 - 50 MICRO" GOLD

DRAWN	Chigow	DATE	SEP15,06
DESIGNED			
CHECKED	LCHAN	DATE	SEP15,06
I. E. APPRD.			
Q. A. APPRD.			
DWG. APPRD.			
ENG. REL. NO.			
REF.			
DIMENSIONS ARE IN		CODE ID. NO.	
INCHES [mm]		03554	

Amphenol Canada Corp.

TITLE SURFACE MOUNT MODULAR JACK
8 POSITION, 8 CONTACTS, WITH SHIELDED,
TRAY PACKAGE- RoHS COMPLIANT

DWG	DRAWING NO.	REV.
	P-RJLSE-4X381-01	C
SCALE	WT. -----	SURF. -----
		SHEET 1 OF 1

THIS DOCUMENT CONTAINS PROPRIETARY INFORMATION AND SUCH INFORMATION
MAY NOT BE DISCLOSED TO OTHERS FOR ANY PURPOSE OR USED FOR MANUFACTURING
PURPOSES WITHOUT WRITTEN PERMISSION FROM AMPHENOL CANADA CORP.

Mouser Electronics

Authorized Distributor

Click to View Pricing, Inventory, Delivery & Lifecycle Information:

Amphenol:

[RJLSE4208101](#) [RJLSE-62361-01T](#) [RJLSE-62061-01T](#) [RJLSE6016101](#) [RJLSE6306101T](#) [RJLSE6336101T](#)
[RJLSE6306101](#) [RJLSE4038101T](#) [RJLSE6116101T](#) [RJLSE6216101](#) [RJLSE6036101T](#) [RJLSE6106101](#)
[RJLSE4138101](#) [RJLSE4138101T](#) [RJLSE6116101](#) [RJLSE6136101T](#) [RJLSE4238101](#) [RJLSE6016101T](#)
[RJLSE6316101T](#) [RJLSE4338101](#) [RJLSE6136101](#) [RJLSE6236101](#) [RJLSE4038101](#) [RJLSE6006101](#)
[RJLSE6106101T](#) [RJLSE6036101](#) [RJLSE4338101T](#) [RJLSE6006101T](#) [RJLSE6336101](#)