



precidip

WWW.PRECIDIP.COM TEL +41 32 421 04 00 SALES@PRECIDIP.COM

DUAL-IN-LINE SOCKETS

OPEN FRAME / SURFACE MOUNT PICK AND PLACE

Specially designed for reflow soldering including vapor phase with unique self-aligning floating contacts.

TECHNICAL SPECIFICATIONS (FOR GENERAL SPECS, SEE PAGE 127)

INSULATOR	Black glass filled polyester PCT-GF30-FR
FLAMMABILITY	UL 94V-0
SLEEVE	Brass CuZn36Pb3 (C36000)
CONTACT CLIP (4 FINGER)	Beryllium copper (C17200)
ACCEPTED PIN Ø	0.40 to 0.56 mm
FORCES	2 N typ. insertion 1 N typ. withdrawal (polished steel gauge Ø 0.43 mm)
MECHANICAL LIFE	Min. 100 cycles
RATED CURRENT	1 A
CONTACT RESISTANCE	Max. 10 mΩ
DIELECTRIC STRENGTH	Min. 1'000 VRMS
COPLANARITY	
SMD TERMINATIONS	Max. 0.10 mm

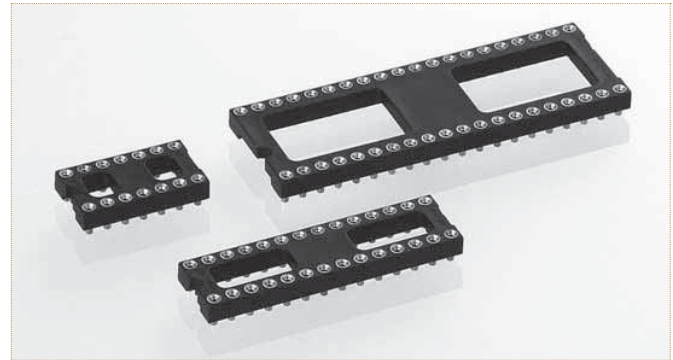

ORDERING INFORMATION ROHS COMPLIANT PARTS

PP PLATING CODE	SLEEVE	CLIP
87	Tin	Flash gold
83	Tin	0.75 µm gold

Other plating on request (see page 178 for plating specs).

Tape & Reel packaging:

replace 161 by suffix 191 to part number. Other pin counts please consult. Please consult www.precidip.com for availability size of tape, size of reel, number of components per reel, packing units and part numbers.

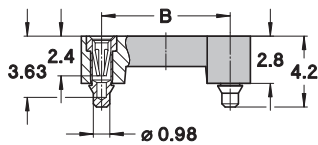

NO. OF POLES	A	B	C	E	ORDER CODES
6	7.6	7.62	10.1	7.6	114-PP-306-41-134161
8	10.1	7.62	10.1	10.1	114-PP-308-41-134161
10	12.6	7.62	10.1	12.6	114-PP-310-41-134161
12	15.2	7.62	10.1	5.3	114-PP-312-41-134161
14	17.8	7.62	10.1	5.3	114-PP-314-41-134161
16	20.3	7.62	10.1	5.3	114-PP-316-41-134161
18	22.9	7.62	10.1	5.3	114-PP-318-41-134161
20	25.4	7.62	10.1	8.3	114-PP-320-41-134161
24	30.4	7.62	10.1	8.3	114-PP-324-41-134161
28	35.6	7.62	10.1	8.3	114-PP-328-41-134161
28	35.5	15.24	17.7	10.0	114-PP-628-41-134161
32	40.6	15.24	17.7	10.0	114-PP-632-41-134161
40	50.8	15.24	17.7	10.0	114-PP-640-41-134161
42	53.4	15.24	17.7	10.0	114-PP-642-41-134161

DIL SOCKETS

INSULATOR

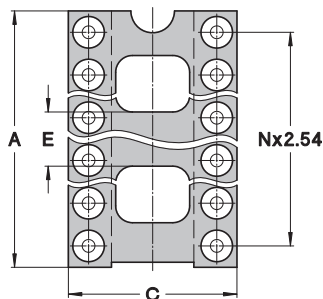

PCB LAYOUT

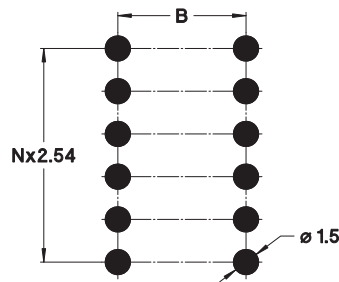

Mouser Electronics

Authorized Distributor

Click to View Pricing, Inventory, Delivery & Lifecycle Information:

Preci-dip:

[114-87-324-41-134161](#) [114-87-642-41-134161](#) [114-87-640-41-134161](#) [114-87-628-41-134161](#) [114-87-320-41-134161](#) [114-87-624-41-134161](#) [114-83-316-41-134161](#) [114-83-632-41-134161](#) [114-83-640-41-134161](#) [114-83-642-41-134161](#) [114-87-306-41-134161](#) [114-87-310-41-134161](#) [114-87-312-41-134161](#) [114-83-314-41-134161](#) [114-83-318-41-134161](#) [114-83-324-41-134161](#) [114-83-328-41-134161](#) [114-83-624-41-134161](#) [114-83-628-41-134161](#) [114-87-314-41-134161](#) [114-83-320-41-134161](#) [114-83-306-41-134161](#) [114-83-308-41-134161](#) [114-83-310-41-134161](#) [114-83-312-41-134161](#) [114-87-328-41-134161](#) [114-87-318-41-134161](#) [114-87-316-41-134161](#) [114-87-632-41-134161](#) [114-87-320-41-134191](#) [114-87-632-41-134191](#) [114-87-324-41-134191](#) [114-87-318-41-134191](#) [114-87-328-41-134191](#) [114-83-306-41-134191](#) [114-83-308-41-134191](#) [114-83-310-41-134191](#) [114-83-314-41-134191](#) [114-83-316-41-134191](#) [114-83-318-41-134191](#) [114-87-628-41-134191](#) [114-83-320-41-134191](#) [114-83-324-41-134191](#) [114-83-328-41-134191](#) [114-83-628-41-134191](#) [114-83-632-41-134191](#) [114-87-306-41-134191](#) [114-87-308-41-134191](#) [114-87-310-41-134191](#) [114-87-314-41-134191](#) [114-87-316-41-134191](#) [114-87-312-41-134191](#) [114-83-312-41-134191](#)