

PC TERMINALS : 0.040x0.012

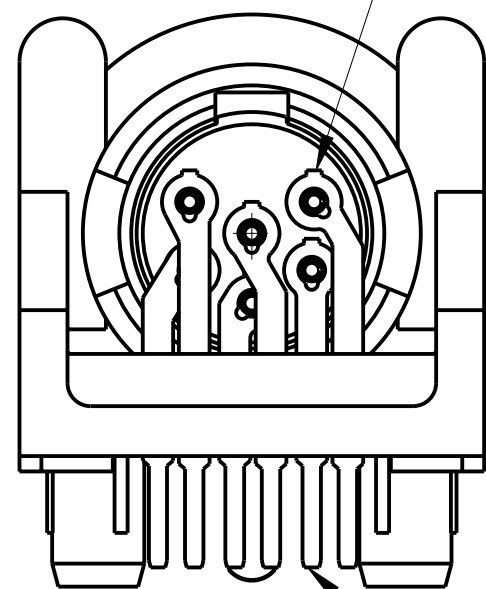

PC TERMINALS : 0.023x0.012

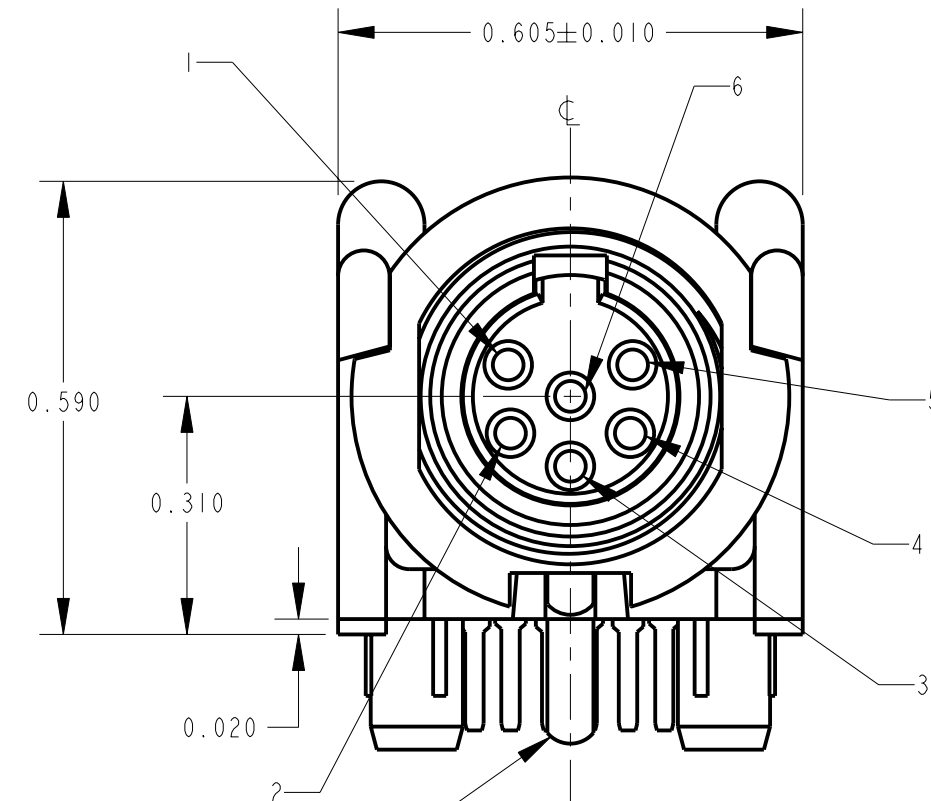
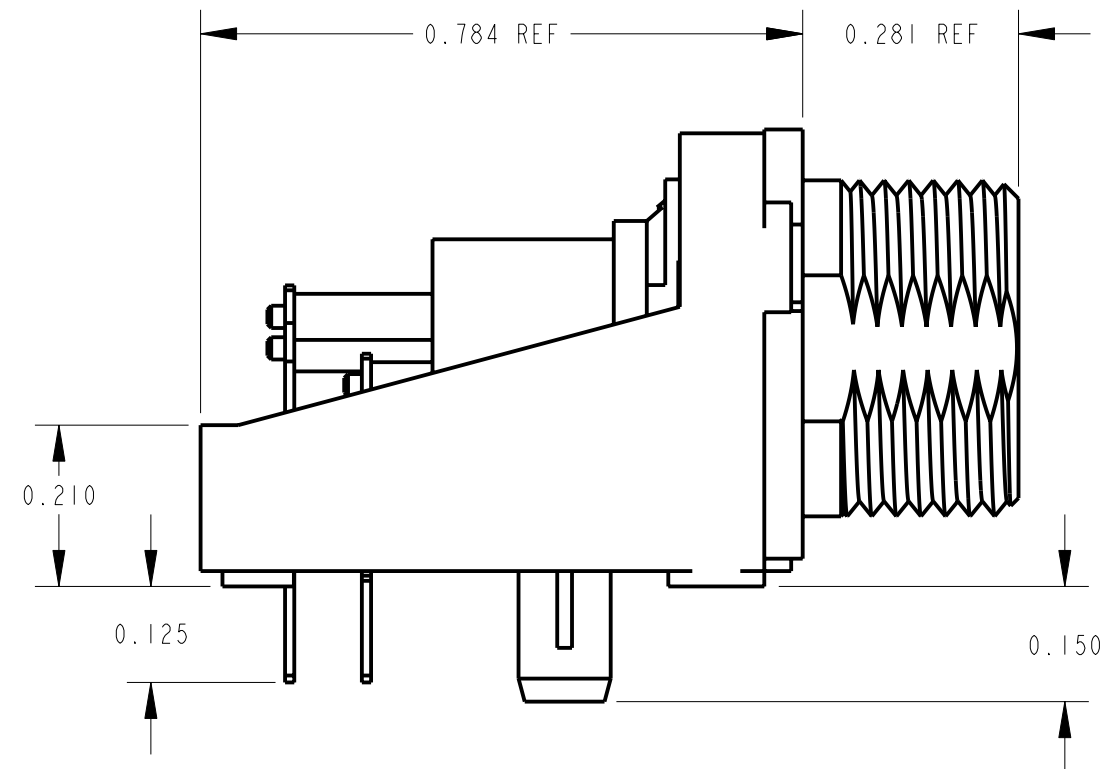

GROUND TERMINAL : 0.060x0.008

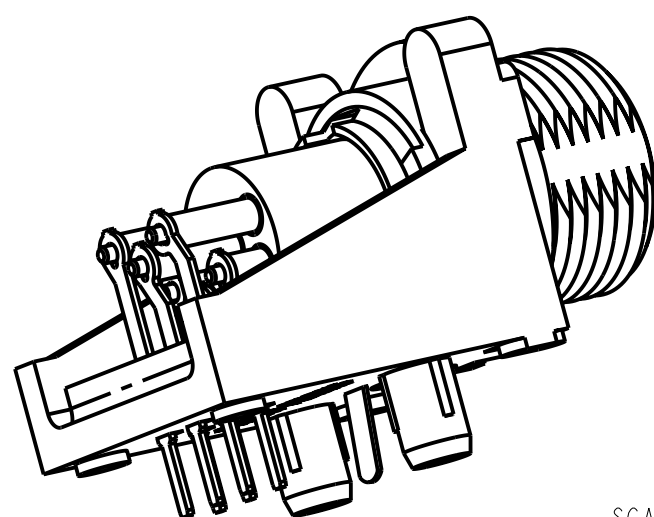

SCALE 3:1

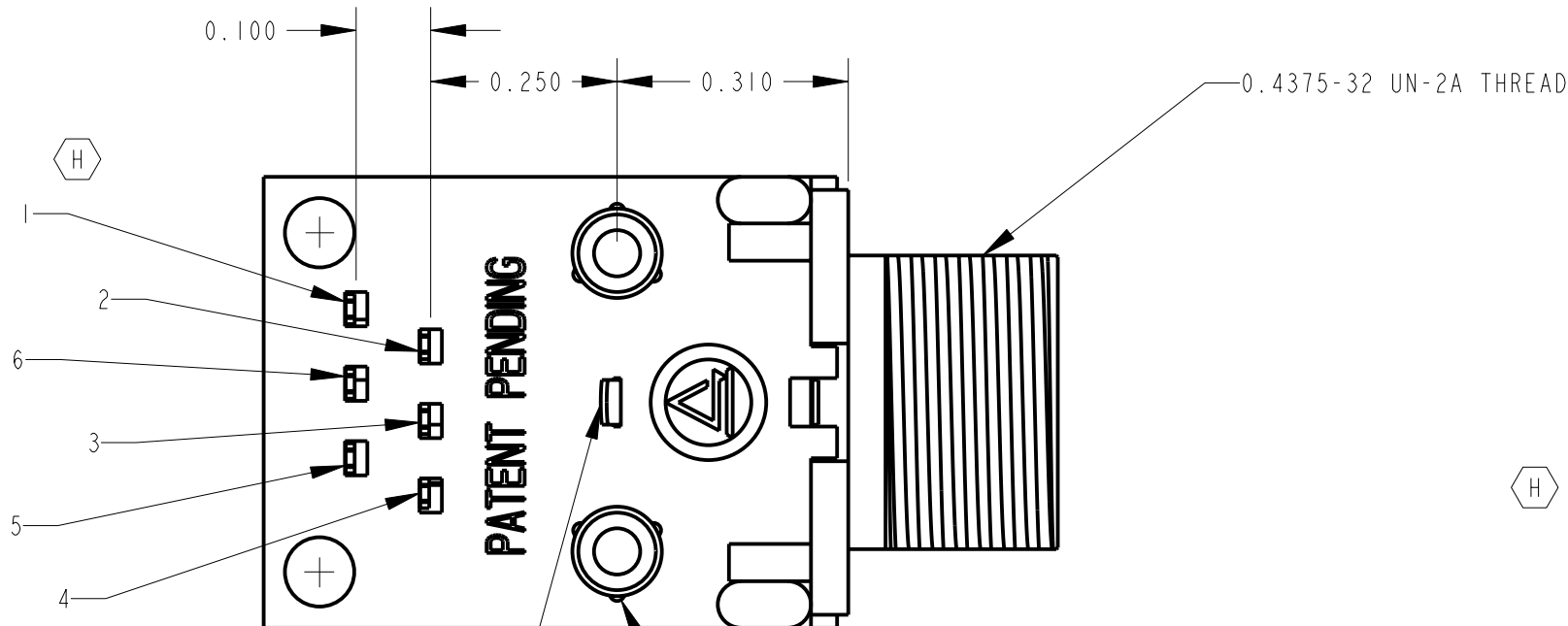

NOTES:

1. 0.00 DECIMALS ARE ± 0.010 .

2. ALL DIMENSIONS ARE REFERENCE.

3. MATERIALS:
HOUSING: THERMOPLASTIC
CONTACTS: BRASS, TIN PLATED
HARDWARE: BRASS, NICKEL PLATED
BUSHING: ZINC DIE CAST, NICKEL PLATED

4. ELECTRICAL SPECIFICATIONS:
CURRENT RATING: 1.5 A
CONTACT RESISTANCE: 0.010 OHM MAX
INSULATION RESISTANCE: 100 MEGA OHMS MIN
DIELECTRIC WITHSTANDING VOLTAGE: 250 VAC
MECHANICAL LIFE: 2000 CYCLES

5. THIS PRODUCT IS RoHS COMPLIANT.

RECOMMENDED PC MOUNTING
COMPONENT SIDE

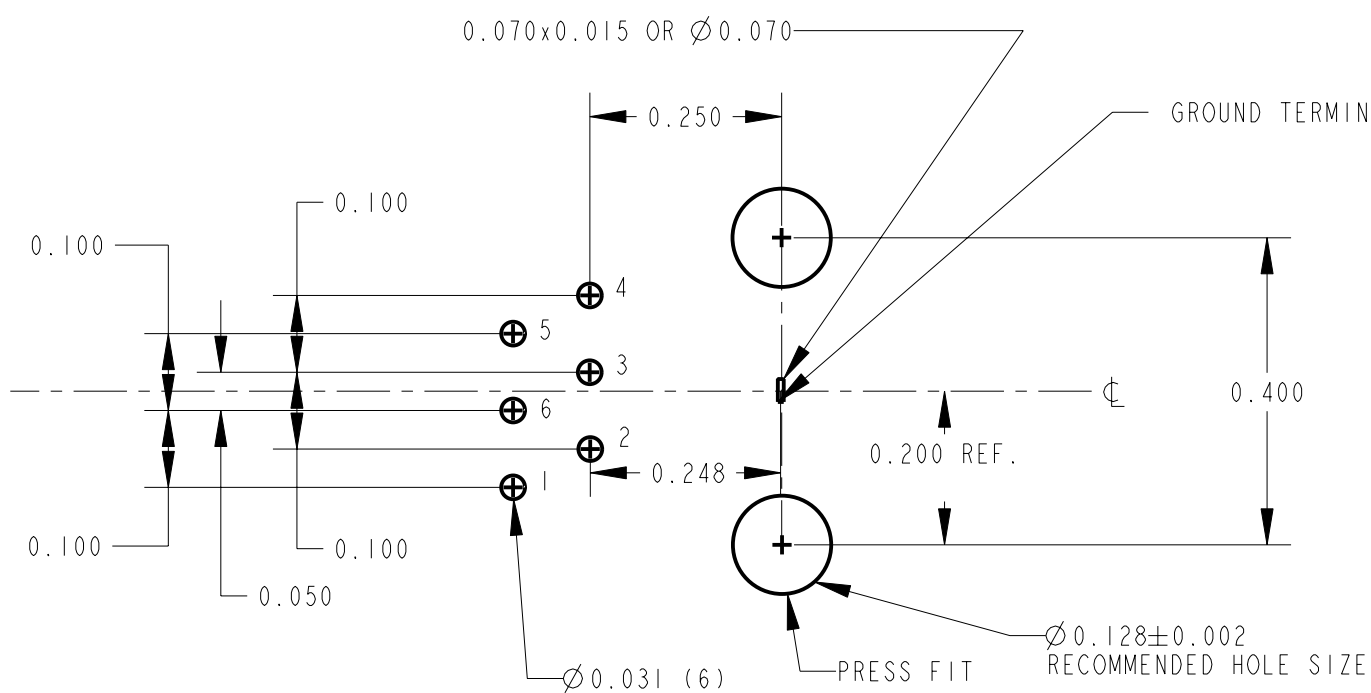

CUSTOMER DRAWING

					★ STAR SYMBOL DENOTES CRITICAL DIMENSION	THIS DRAWING DESCRIBES A DESIGN CONSIDERED PROPRIETARY IN NATURE, DEVELOPED AND MANUFACTURED BY SWITCHCRAFT INC. AND IS RELEASED ON A CONFIDENTIAL BASIS FOR IDENTIFICATION PURPOSES ONLY.				
					UNLESS OTHERWISE SPECIFIED	SIZE	WIDTH	MULT	LBS/M	TEMPER
					1. ALL DIMENSIONS IN INCHES - TWO PLACE DECIMALS ± 0.01 - THREE PLACE DECIMALS ± 0.005 - ANGLES $\pm 1^\circ$ - ALL DIA. CONCENTRIC WITHIN 0.005 T.I.R.	FINISH SPEC No.		MATERIAL SPEC No.		
					2. FEATURES ON THE SAME CENTERLINE MUST BE ALIGNED WITHIN ± 0.002	FIRST USED ON		SCALE 4:1		Switchcraft®
					3. REMOVE ALL BURRS	DATE DRAWN	BY	CHKD	APVD	
					DO NOT SCALE DRAWING	4-26-96	RC	RB 4-26-96	DG 12-2-98	
						TINI O-G MALE RECEPTOR R.A.P.C. 6 PIN, RoHS				PART No.
										TRA6M
										REV H

Mouser Electronics

Authorized Distributor

Click to View Pricing, Inventory, Delivery & Lifecycle Information:

[Switchcraft:](#)

[TRA6M](#)