

ITEM	Q'TY	PART NUMBER	PART DESCRIPTION
1	1	PM5	LED HOLDER, PANEL MOUNT, PRESS FIT, (5mm)
2	1	CC	HEADER CONNECTOR, .100" [2.54] PITCH
3	1	5SYT	T-1 3/4 (5mm) LED
4	1	BWS24-1007-RD	24AWG WIRE LEAD U.L. 1007, RED
5	1	BWS24-1007-BK	24AWG WIRE LEAD U.L. 1007, BLACK

REV	DESCRIPTION	DATE	APPROVED
A	ENGINEERING RELEASE.	08/15/03	MC

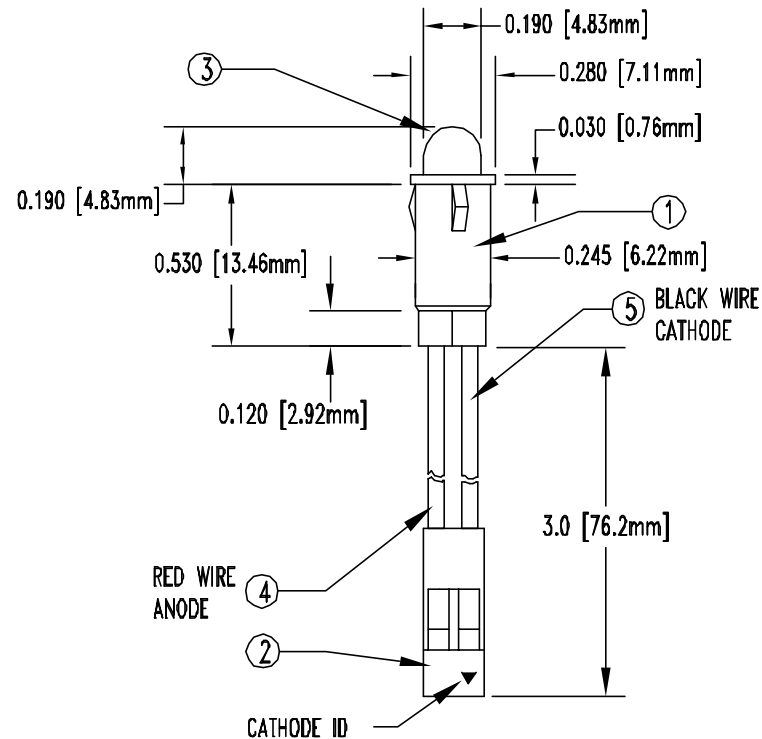
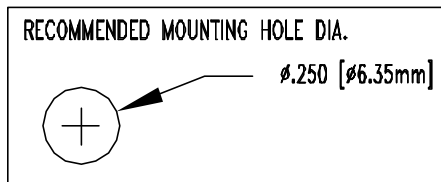

LED Part No.	Chip			Lens Appearance	Absolute Maximum Ratings				Electro-Optical Data @ 20mA			Viewing Angle (Deg.)
	Material	Emitted Color	Peak Wave Length $\lambda_P$ (nm)		$\Delta\lambda$	Pd	If (Typ)	Peak (If)	Vf(V)		Iv(mcd)	
					(nm)	(mW)	(mA)	(mA)	Typ.	Max.	Typ.	
5SYT	GaAsP/GaP	SUPER YELLOW	585	TINTED	15	100	30	150	2.0	2.6	150.0	20

## ABSOLUTE MAXIMUM RATINGS ( $T_a=25^\circ\text{C}$ )

REVERSE VOLTAGE \_\_\_\_\_ 5V

REVERSE CURRENT ( $I_R=5V$ ) \_\_\_\_\_ 100 $\mu$ A

OPERATING TEMPERATURE RANGE \_\_\_\_\_  $-25^\circ\text{C} \sim 85^\circ\text{C}$

STORAGE TEMPERATURE \_\_\_\_\_  $-30^\circ\text{C} \sim 100^\circ\text{C}$

LEAD SOLDERING TEMPERATURE(1/16" FROM BODY) \_\_\_\_\_  $260^\circ\text{C}$  FOR 5 SECONDS

UNLESS OTHERWISE SPECIFIED: DIMENSIONS ARE IN INCHES		TOLERANCES			
DECIMALS	ANGULAR				
.X $\pm .05$	X' $\pm 1^\circ$			<b>4 THOMAS, IRVINE, CA.92618</b> <b>TEL: (949) 961-8808 FAX: (949) 961-3974</b>	
.XX $\pm .02$					
.XXX $\pm .010$					
DESIGNER <b>DAVID GREEN</b>	DATE <b>08/15/03</b>	PART NAME: <b>T-1 (5mm) PANEL MOUNT ASSEMBLY</b>		<b>PM5SYTW3-CC</b>	
CHECKER <b>M CHEN</b>	DATE <b>08/15/03</b>	SIZE <b>A</b>	DWG NAME		
SCALE 1=1		CAGE CODE 32559		SHEET 1 OF 1	

# Mouser Electronics

Authorized Distributor

Click to View Pricing, Inventory, Delivery & Lifecycle Information:

BIVAR:

PM5SYTW3-CC