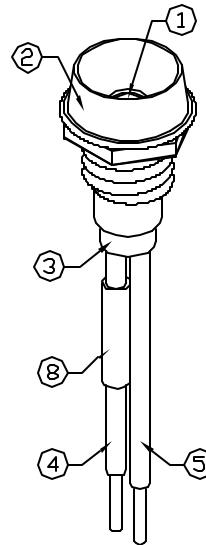
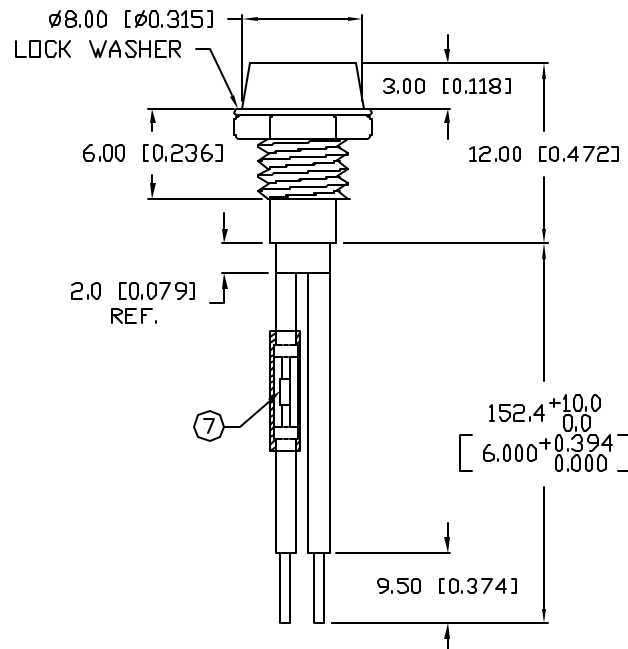

UNCONTROLLED DOCUMENT

| | | |
|--------------------|-------------------------------------|----------|
| PART NUMBER | | REV. |
| SSI-LXR1612ID24V15 | | A |
| REV. | E.C.N. NUMBER AND REVISION COMMENTS | DATE |
| A | E.C.N. #10BRDR. & REDRAWN. | 10.18.01 |

ELECTRO-OPTICAL CHARACTERISTICS $T_A=25^\circ\text{C}$ $V_f=24\text{V}$

| PARAMETER | MIN | TYP | MAX | UNITS | TEST COND |
|--------------------|--------------|-----|-----|----------|----------------------|
| PEAK WAVELENGTH | | 635 | | nm | |
| FORWARD VOLTAGE | | 24 | 28 | V_f | |
| REVERSE VOLTAGE | 5.0 | | | V_r | $I_r=100\mu\text{A}$ |
| AXIAL INTENSITY | | 30 | | mcd | $V_f=24\text{V}$ |
| VIEWING ANGLE | | 60 | | 2x theta | |
| EMITTED COLOR: | RED | | | | |
| EPOXY LENS FINISH: | RED DIFFUSED | | | | |

LIMITS OF SAFE OPERATION AT 25°C

| PARAMETER | MAX | UNITS |
|--------------------------------|------------|----------------------|
| PEAK FORWARD VOLTAGE | 28 | V |
| STEADY CURRENT | 22 | mA |
| POWER DISSIPATION | 310 | mW |
| DERATE FROM 25°C | -1.6 | mW/ $^\circ\text{C}$ |
| OPERATING, STORAGE TEMP. | -40 TO +85 | $^\circ\text{C}$ |

NOTES:

- SSL-LX3054ID, RED LED. TRIM LED LEADS TO 5mm.
- SSI-LXR1612 CHROME HOUSING.
- SSH-LXH1612BSG, BUSHING, INSERT AND CRIMP.
- ANODE LEAD: LXP-WST26RDT, 26 AWG, STRANDED, RED INSULATION. CUT 45mm LONG, STRIP BOTH ENDS 2mm. CUT 103mm LONG, STRIP 2mm AND 9.5mm.
- CATHODE LEAD: LXP-WST26BLT, 26 AWG, STRANDED, BLACK INSULATION. CUT 157mm LONG, STRIP END 2mm AND 9.5mm.
- SOLDER LEAD WIRES TO LED LEADS.
- LXP-RES 1000 1/2W, 1K OHM 1/2 WATT RESISTOR. TRIM LEADS OF RESISTOR 18mm END TO END.
- INSULATE RESISTOR AND CRIMPS WITH HEATSHRINK. (1/8" x 1" LONG).

PANEL CUTOUT

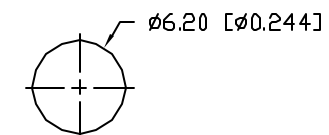

UNCONTROLLED DOCUMENT

*UNLESS OTHERWISE SPECIFIED TOLERANCES PER DECIMAL PRECISION ARE: X=±1 (±0.039), X.X=±0.5 (±0.020), X.XX=±0.25 (±0.010), X.XXX=±0.127 (±0.005). LEAD SIZE=±0.05 (±0.002), LEAD LENGTH=±0.75 (±0.030). MIN.=+DECIMAL PRECISION -0.00 MAX.=+0.00 -DECIMAL PRECISION

| | | | | | | | |
|---|--------------------|---|--|-------------------------|--|--------------------------|--|
| REV. | PART NUMBER | CONFIDENTIAL INFORMATION | | LUMEX | | 290 E. HELEN ROAD | |
| A | SSI-LXR1612ID24V15 | THE INFORMATION CONTAINED IN THIS DOCUMENT IS THE PROPERTY OF LUMEX INC. EXCEPT AS SPECIFICALLY AUTHORIZED IN WRITING BY LUMEX INC, THE HOLDER OF THIS DOCUMENT SHALL KEEP ALL INFORMATION CONTAINED HEREIN CONFIDENTIAL AND SHALL PROTECT SAME IN WHOLE OR IN PART FROM DISCLOSURE AND DISSEMINATION TO ALL THIRD PARTIES. | | PALATINE, IL 60067-6976 | | PHONE: +1.847.359.2790 | |
| T-3mm (T-1) LED PANEL INDICATOR, 635nm RED LED, RED DIFFUSED LENS, 24 VOLT OPERATION, WITH 6" WIRE LEADS. | | RELIABILITY NOTE OUR MANY YEARS OF EXPERIENCE DATA ACCUMULATION INDICATE THAT SOLDER HEAT IS A MAJOR CAUSE OF EARLY AND FUTURE FAILURE. PLEASE PAY ATTENTION TO YOUR SOLDERING PROCESS. | | US WEB: www.lumex.com | | TW WEB: www.lumex.com.tw | |
| | | DRAWN BY: BC | | CHECKED BY: | | APPROVED BY: | |
| | | | | | | DATE: 7.8.99 | |
| | | | | | | PAGE: 1 OF 1 | |
| | | | | | | SCALE: N/A | |

Mouser Electronics

Authorized Distributor

Click to View Pricing, Inventory, Delivery & Lifecycle Information:

Lumex:

[SSI-LXR1612ID24V15](#)