



FCIconnect.com

Copyright FCI

## LOADING PATTERN MATING SIDE

f													0	0	0	0	0	0	0	0	0	0	0
e													4	4	4	4	4	4	4	4	4	4	4
d													4	4	4	4	4	4	4	4	4	4	4
c													4	4	4	4	4	4	4	4	4	4	4
b													4	4	4	4	4	4	4	4	4	4	4
a													4	4	4	4	4	4	4	4	4	4	4
z													0	0	0	0	0	0	0	0	0	0	0
POS	01												05										
													10										
													15										
													20										
													25										

## LOADED CONNECTOR ASSEMBLY (FOR EXAMPLE)

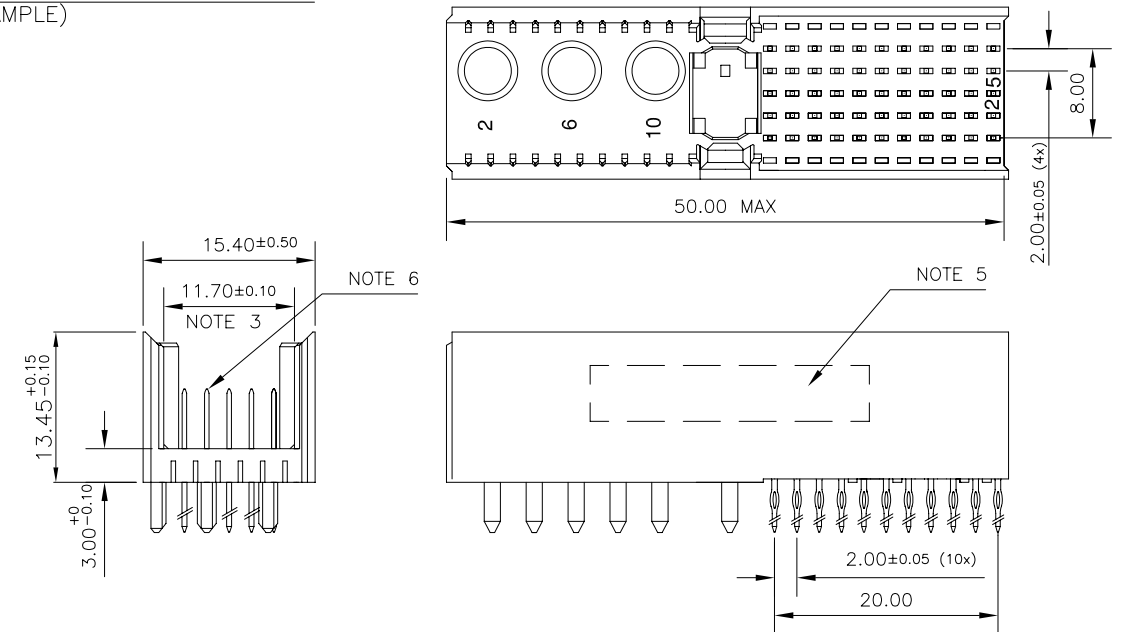

## CONTACT OVERVIEW

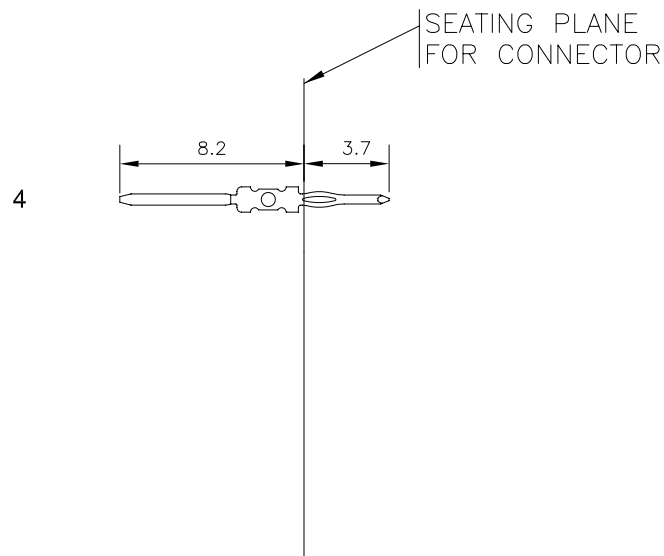

HM2P11PA5110---  
LEAD FREE INDICATOR : LF = LEAD FREE  
(DIGIT 15 & 16)  
PLATING CODE (DIGIT 13 AND 14)

## PLATING TABLE

CODE	PLATING	CONTACT AREA	TYPE OF TERMINAL	PERFORMANCE LEVEL
AA	0.75µ Au	GOLD OVER NICKEL PLATING.	SHORT TERMINAL EON PRESSFIT CONTACTS	IEC PERFORMANCE LEVEL 2 (250 mating cycles) or TELCORDIA CO
AB	1.25µ Au	GOLD OVER NICKEL PLATING.	SHORT TERMINAL EON PRESSFIT CONTACTS	TELCORDIA UE

## LAY-OUT PCB - HOLE

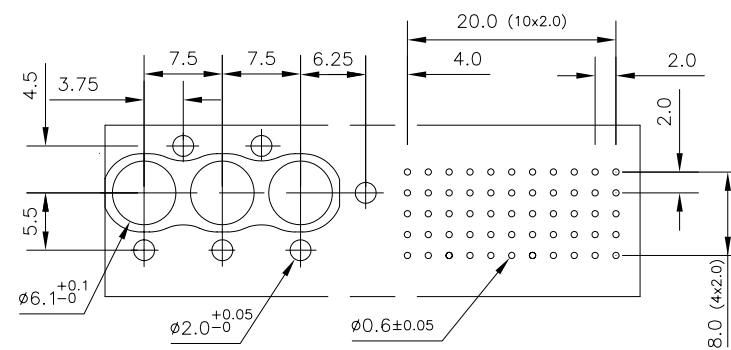

## NOTES

- THIS PRODUCT IS CSA APPROVED.
- THIS PRODUCT IS UL RECOGNIZED.
- MEASURED AT THE BOTTOM.
- MATERIAL CONTACT: PHOSPHOR BRONZE  
HOUSING : CREAM WHITE GLASS FILLED POLYESTER UL-94V0
- CONNECTOR PRINTED WITH P/N AND DATE CODE.
- FOR ACTUAL CONTACT LOADINGS, SEE LOADING PATTERN MATING SIDE.
- SHAPE OF CONNECTOR HOUSING CAN ALTER DEPENDING ON PRODUCTION LOCATION
- THE PRODUCT (LF) MEETS EUROPEAN UNION DIRECTIVES AND OTHER COUNTRY REGULATIONS AS DESCRIBED IN GS-22-008
- FOR RECOMMENDED PTH DIMENSIONS REFER DRAWING : BS, A , 201572 , 001

CATALOG NO: HM2P11PA5110----

mat'l. code SEE NOTE 4				surface ISO 1302 ✓	tolerance ISO 406 ISO 1101	projection MM	product family MILLIPACS			
ltr	ecn no	dr	date	tolerances unless otherwise specified		MM	title MPACS 5+2R STR HDR PF CONN TYPE M			
A	I09-0210	MINI	2009-10-06	angles	linear					
B	I09-0290	AB	2009-12-29							
C	I10-0018	MINI	2010-01-13	0°±1°		scale —				
				dr	MINI K VANDANATH	2009-10-06	FCI		dwg no	sheet 1 of 1
				enr	ALEX BABU	2009-10-06			size	
				chr	ALEX BABU	2009-10-06				
				appd	ALEX BABU	2009-10-06				
sheet index	revision sheet	c	1				type		Product	Customer
							Drawing			

# Mouser Electronics

Authorized Distributor

Click to View Pricing, Inventory, Delivery & Lifecycle Information:

[FCI / Amphenol:](#)

[HM2P11PA5110AALF](#)