

UNCONTROLLED DOCUMENT

PART NUMBER IFL-LX906		REV. A
REV.	E.C.N. NUMBER AND REVISION COMMENTS	DATE
A	E.C.N. #11148.	772

ELECTRO-OPTICAL SPECIFICATIONS

DESIGN VOLTAGE:	13 V
OPERATING CURRENT:	0.89 AMPS @13V
INTENSITY:	61.0 MSCP
OPERATING LIFE:	1000 HRS @13VAC
BASE TYPE:	ALL GLASS WEDGE

MECHANICAL SPECIFICATIONS

BULB SIZE AND SHAPE:	T 15 TUBULAR
BULB GLASS TYPE:	KH 395
BASE OR LEAD FINISH:	NI FINISH
FLAMELET SHAPE:	C-2F
L.C.L. F APPLICABLE:	20.6mm
MANUFACTURING PPS:	112 Kc 488

ENVIRONMENTAL SPECIFICATIONS

VIATION TESTING:	ML-E-5400N, GRAFH IV
SHOCK TEST :	ML-STD-883 METHOD 2002 TEST CON A
OPERATING TEMPERATURE:	-55 TO +100 °C
STORAGE TEMPERATURE:	-55 TO +100 °C
SOLDERABILITY OF LEADS:	NOT APPLICABLE

NOTES:

- LAMP TO BE ARGON FILLED.
- LAMP TO BE MARKED WITH VOLTAGE AND WATTAGE ONLY.

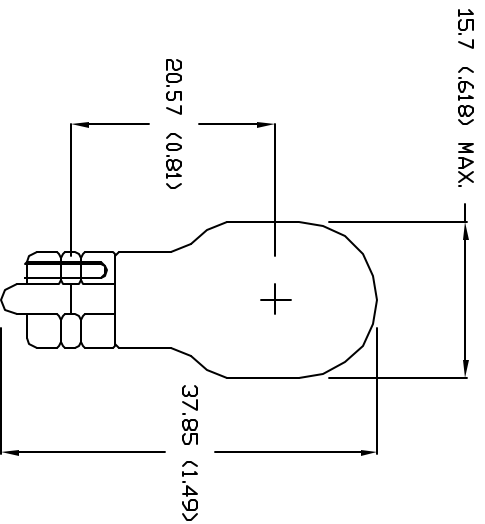

UNLESS OTHERWISE SPECIFIED TOLERANCES FOR DIMENSIONS ARE: X=±.1 (MILS), XX=±.015 (MILS), XXX=±.012 (MILS), XXXX=±.0112 (MILS), LEAD SIZE=±.005 (MILS), LEAD LENGTH=±.025 (MILS), MIN. THERMAL RESISTANCE MAX. TYPICAL PRESSURE

UNCONTROLLED DOCUMENT

REV. A	PART NUMBER IFL-LX906	CONSTRUCTION INFORMATION THE INFORMATION CONTAINED IN THIS DOCUMENT IS THE PROPERTY OF LUMEX INC. EXCEPT AS SPECIFICALLY AUTHORIZED IN WRITING BY LUMEX INC. IT IS TO BE KEPT UNCLASSIFIED AND SHALL PROTECT SAME IN WHOLE OR IN PART FROM DISSEMINATE AND REPRODUCTION TO ALL THIRD PARTIES. OUR MANY YEARS OF EXPERIENCE WITH COMMUNICATION INDUSTRY THAT SPOKE HOTS IS A MAJOR CAUSE OF EARLY AND RARE FAILURE. PLEASE PAY ATTENTION TO YOUR SOLDERING PROCESS.
T-15mm ANSI NO. 906, INCANDESCENT LAMP, ALL GLASS WEDGE.		

DRAWN BY: JC	CHECKED BY:	APPROVED BY:	DATE:
			8.21.85
290 E. HELEN ROAD PALATINE, IL 60067-8978 PHONE: +1.847.359.2790 US WEB: www.lumex.com TW WEB: www.lumex.com.tw			PAGE: 1 OF 1 SCALE: N/A

# Mouser Electronics

Authorized Distributor

Click to View Pricing, Inventory, Delivery & Lifecycle Information:

[Lumex:](#)

[IFL-LX906](#)