

ITEM	COMPONENT	QTY	MATERIAL
1	HOUSING	1	LCP E130I, 30% GLASS FILL, UL-94 V-0 COLOUR BLACK
2	TERMINAL	1	0.15 PHOSPHOR BRONZE Au OVER Pd/Ni IN CONTACT AREA

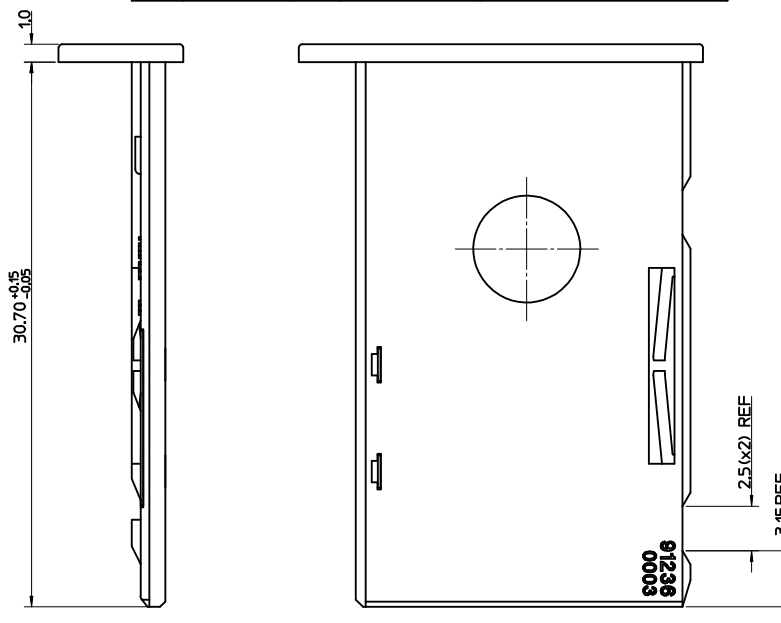

- NOTES:
1. POLISHED SURFACE FINISH IN SHADED AREA
 2. PACKAGING: LOOSE IN BAG
 3. FOR ALL UNSPECIFIED DIMENSIONS AND NOTES SEE SHEET 1

ADDED GATE ECN NO: E2002-0530 DRWN: FDUGGAN 2001/12/11 CHKD: APPR:	QUALITY SYMBOLS ▽ - 0 ▽ - 0	GENERAL TOLERANCES (UNLESS SPECIFIED) 4 PLACES ± --- ± --- 3 PLACES ± --- ± --- 2 PLACES ± 0.05 ± --- 1 PLACE ± 0.10 ± --- ANGULAR ± 2 ° DRAFT WHERE APPLICABLE MUST REMAIN WITHIN DIMENSIONS	SCALE 5:1	DESIGN UNITS METRIC	THIRD ANGLE PROJECTION	REVISE ON CAD ONLY
			DIMENSION STYLE MM ONLY		TITLE CARD HOLDER	
			DRAWN BY MINDORAK	DATE 00/05/31	MOLEX INCORPORATED MATERIAL NO. 912360003 DOCUMENT NO. SDA-91236 SHEET NO. 3 OF 6	
			CHECKED BY DHANNON	DATE 00/07/13		
J	REV		APPROVED BY MWILHITE	DATE 00/07/13	THIS DRAWING CONTAINS INFORMATION THAT IS PROPRIETARY TO MOLEX INCORPORATED AND SHOULD NOT BE USED WITHOUT WRITTEN PERMISSION	
					A2	

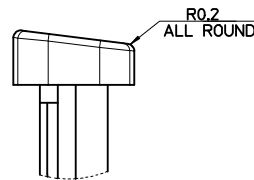
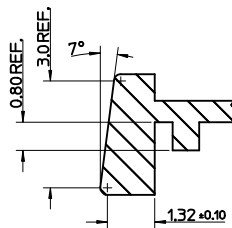
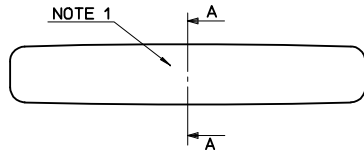

ITEM	COMPONENT	QTY	MATERIAL
▽	HOUSING	1	POLYSTER (PBT), 45% GLASS FILL, UL94 V-0 COLOUR BLACK
▽	TERMINAL	1	0.15 PHOSPHOR BRONZE Au OVER Pb/Ni IN CONTACT AREA

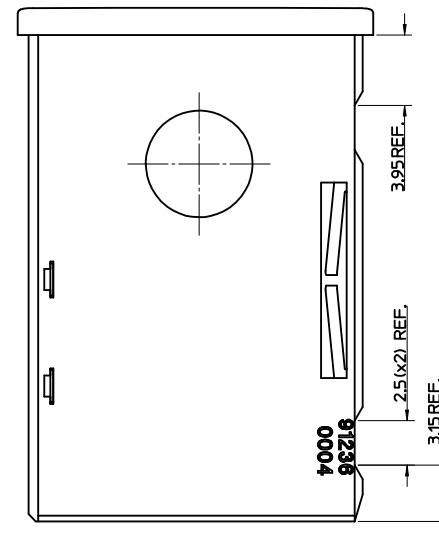
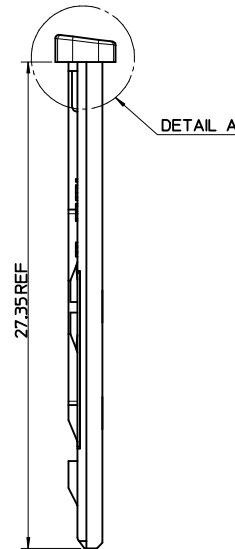
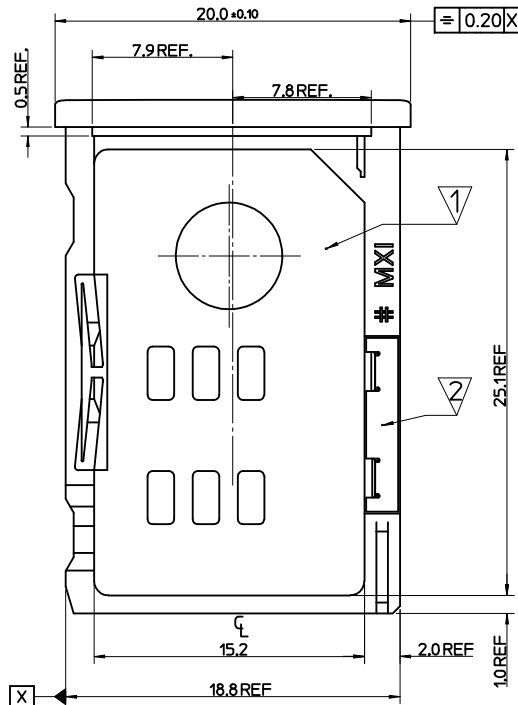

- NOTES:
- VDI 3400 NO. 27 SURFACE FINISH
 - PACKAGING: LOOSE IN BAG
 - FOR ALL UNSPECIFIED DIMENSIONS AND NOTES SEE SHEET 1

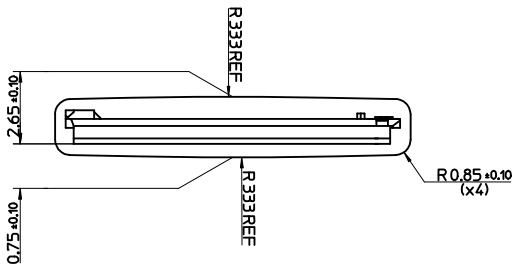

SEE SHEET 1	EC NO: G DRWN:FDUGGAN 2001/12/11 CHKD: 2002/01/04 APPR: BWAGUIRE 2002/01/04	QUALITY SYMBOLS	DESCRIPTION	GENERAL TOLERANCES (UNLESS SPECIFIED)		SCALE 5:1	DESIGN UNITS METRIC	THIRD ANGLE PROJECTION		REVISE ON CAD ONLY			
						DIMENSION STYLE		TITLE CARD HOLDER					
						MM ONLY							
				▽ - 0	4 PLACES	± ---	± ---	DRAWN BY	DATE	molex MOLEX INCORPORATED			
					3 PLACES	± ---	± ---	MINDORAK	00/05/31				
					2 PLACES	± 0.05	± ---	CHECKED BY	DATE				
					1 PLACE	± 0.10	± ---	DHANNON	00/07/13				
▽C - 0	ANGULAR ± 2 °		APPROVED BY	DATE	MATERIAL NO.	DOCUMENT NO.	SHEET NO.						
	DRAFT WHERE APPLICABLE MUST REMAIN WITHIN DIMENSIONS		MWILHITE	00/07/13	912360004	SDA-91236	4 OF 6						
			THIS DRAWING CONTAINS INFORMATION THAT IS PROPRIETARY TO MOLEX INCORPORATED AND SHOULD NOT BE USED WITHOUT WRITTEN PERMISSION				A2						

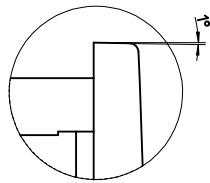
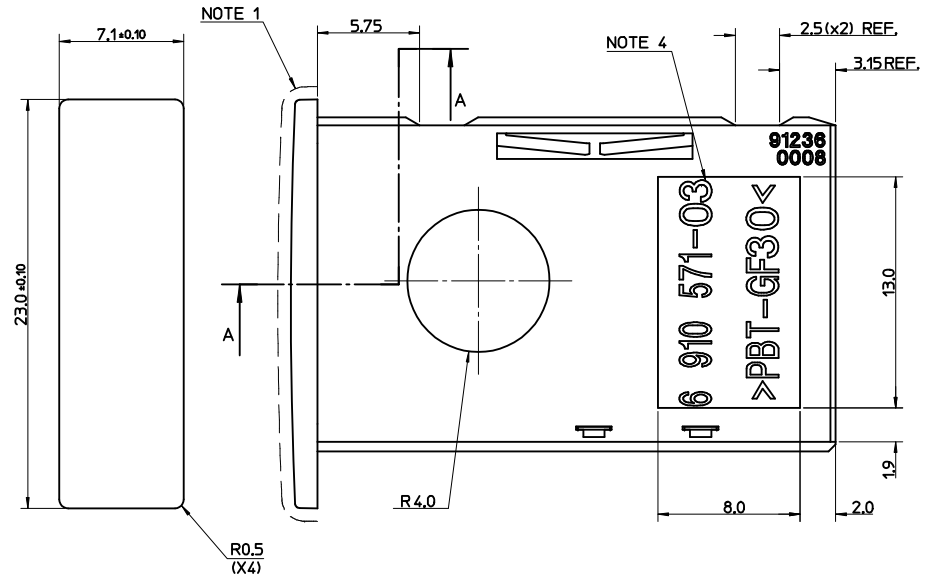
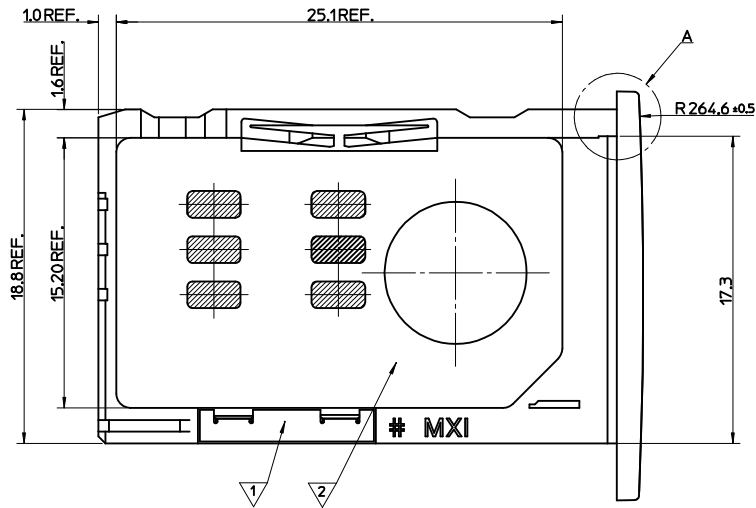
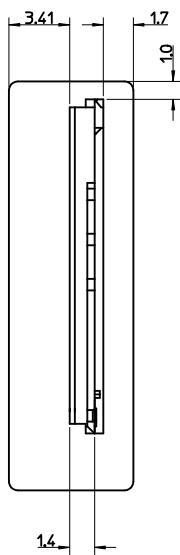

DETAIL A
(SCALE 10:1)

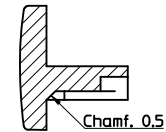
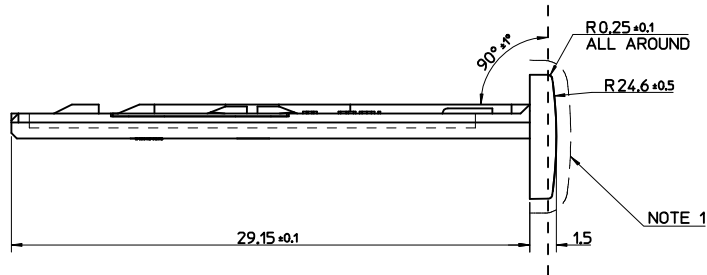

A-A

NOTES:

1. VISIBLE AREA: NO PARTING LINES PERMISSIBLE IN THIS AREA
FEINNAERBE K (ÄTZSTRUKTUR) SURFACE FINISH
2. SEE PRODUCT SPECIFICATION: TBD
3. PACKAGING: LOOSE IN BAG
4. EXCHANGEABLE INSERT AREA 0.1 RECESSED, LETTERING 0.1 RAISED
5. FOR ALL UNSPECIFIED DIMENSIONS AND NOTES SEE SHEET 1

ITEM	COMPONENT	QTY	MATERIAL
▽	TERMINAL	1	0.15 PHOSPHOR BRONZE 0.1um MIN Au OVER Pd/Ni IN CONTACT AREA
▽	HOUSING	1	GF PBT, BLACK

REV	DESCRIPTION
1	EC NO: 0001/12/11 DRWN: FUGGAN 2001/12/11 CHKD: 2002/01/04 APPR: BMAGUIRE 2002/01/04

QUALITY SYMBOLS	GENERAL TOLERANCES (UNLESS SPECIFIED)
▽ - 0	4 PLACES ± --- ± ---
▽ - 0	3 PLACES ± --- ± ---
▽ - 0	2 PLACES ± 0.05 ± ---
▽ - 0	1 PLACE ± 0.10 ± ---
▽ - 0	ANGULAR ± 2 °
▽ - 0	DRAFT WHERE APPLICABLE
▽ - 0	MUST REMAIN WITHIN DIMENSIONS

SCALE	DESIGN UNITS
5:1	METRIC
DIMENSION STYLE	
MM ONLY	
DRAWN BY	DATE
MINDORAK	00/05/31
CHECKED BY	DATE
DHANNON	00/07/13
APPROVED BY	DATE
MWILHITE	00/07/13

TITLE	THIRD ANGLE PROJECTION	REVISE ON CAD ONLY
CARD HOLDER		
MOLLEX INCORPORATED		
MATERIAL NO.	DOCUMENT NO.	SHEET NO.
912360008	SDA-91236	5 OF 6
THIS DRAWING CONTAINS INFORMATION THAT IS PROPRIETARY TO MOLEX INCORPORATED AND SHOULD NOT BE USED WITHOUT WRITTEN PERMISSION		

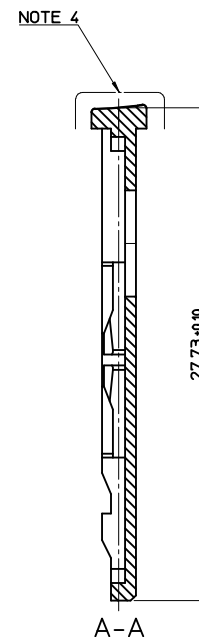
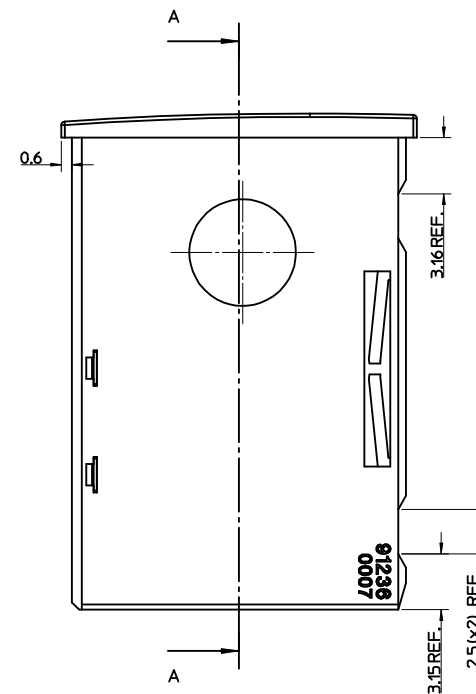
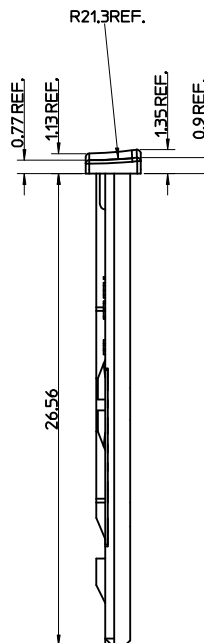
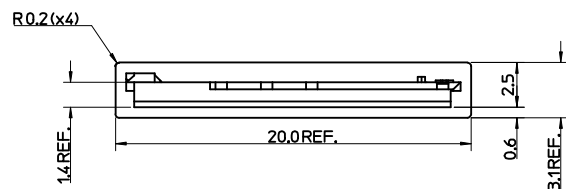
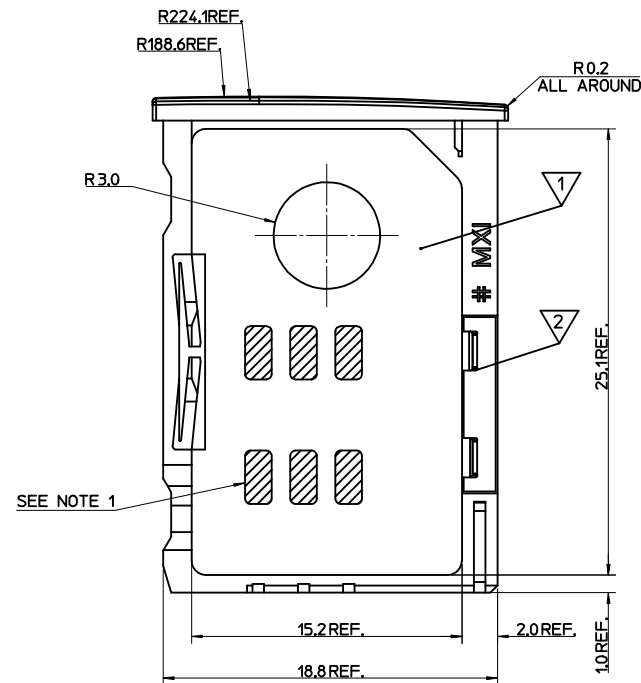
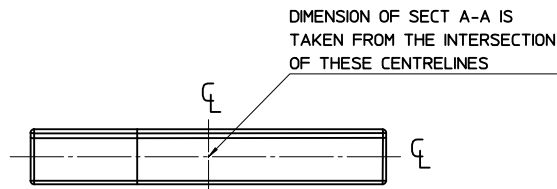

NOTES:

1. POLISHED SURFACE FINISH IN SHADED AREA.
2. PACKAGING: LOOSE IN BAG.
3. FOR ALL UNSPECIFIED DIMENSIONS AND NOTES SEE SHEET 1.
4. MOLDTECH 11010 SURFACE FINISH.

ITEM	COMPONENT	QTY	MATERIAL
1	HOUSING	1	POLYESTER (PBT), 30% GLASS FILL, UL-94 V-0 COLOUR BLACK
2	TERMINAL	1	0.15 PHOSPHOR BRONZE Au IN CONTACT AREA

SEE SHEET 1	EC NO: K DRWN: FUGGAN CHKD: APP:	DESCRIPTION	QUALITY SYMBOLS	GENERAL TOLERANCES (UNLESS SPECIFIED)		SCALE 5:1	DESIGN UNITS METRIC		THIRD ANGLE PROJECTION	REVISE ON CAD ONLY		
						DIMENSION STYLE		TITLE CARD HOLDER				
						MM ONLY						
				4 PLACES ± --- ± ---		DRAWN BY	DATE	MOLEX MOLEX INCORPORATED				
				3 PLACES ± --- ± ---		MINDORAK	00/05/31					
				2 PLACES ± 0.05 ± ---		CHECKED BY	DATE	MATERIAL NO. DOCUMENT NO. SHEET NO.				
				1 PLACE ± 0.10 ± ---		DHANNON	00/07/13					
				ANGULAR ± 2 °		APPROVED BY	DATE	912360007		SDA-91236		6 OF 6
				DRAFT WHERE APPLICABLE		MWILHITE	00/07/13					
				MUST REMAIN WITHIN DIMENSIONS		THIS DRAWING CONTAINS INFORMATION THAT IS PROPRIETARY TO MOLEX INCORPORATED AND SHOULD NOT BE USED WITHOUT WRITTEN PERMISSION						A2

Mouser Electronics

Authorized Distributor

Click to View Pricing, Inventory, Delivery & Lifecycle Information:

Molex:

91236-0003