

EN-Zone für durchkontaktierte Löcher $\varnothing 0.6 \pm 0.05$
 compliant zone for through hole $\varnothing 0.6 \pm 0.05$

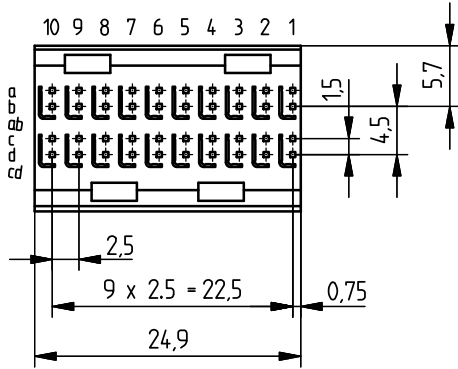

Kontaktversion, Messerkontakt
 Contact Option, Male Contact

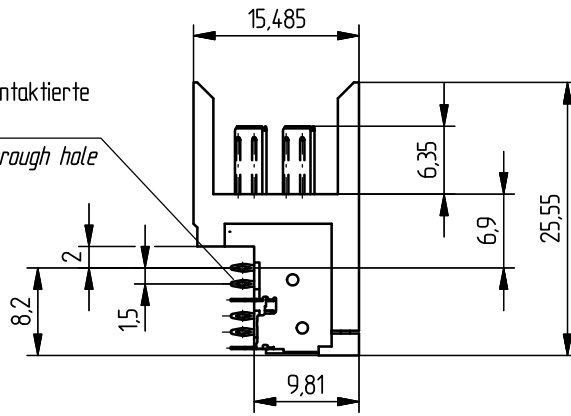
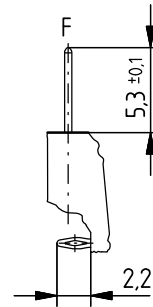

Bestückungsplan - contact layout

Kontaktversion, Schirmmesser
 Contact Option, Shielding Contact

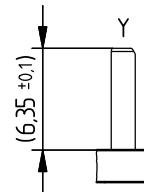
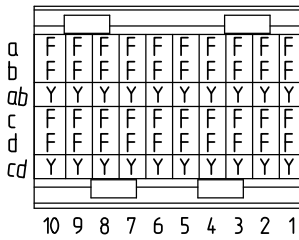

Lochbild für Leiterplatte Board hole pattern
 (Bestückungsseite) (Component mounting side)

- 1) $\varnothing 0.6 \pm 0.05$ Durchmesser des metallisierten Loches
 $\varnothing 0.6 \pm 0.05$ Diameter of finished plated-through hole
- $\varnothing 0.7 \pm 0.02$ Bohrungsdurchmesser des Loches
 $\varnothing 0.7 \pm 0.02$ Diameter of drilled hole

Schichtaufbau im metallisierten Loch
 siehe Zeichnung 114406

Metal plating of plated-through hole
 see drawing 114406

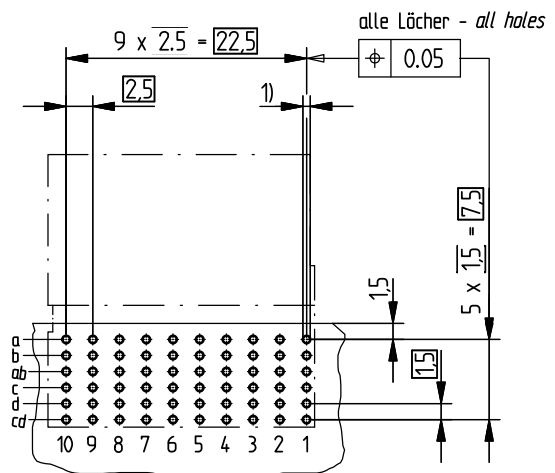

Consider protection memo from DIN 34

Information: F + Y
 siehe Bestückungsplan /
 see contact layout
 Anforderungsstufe 2 / class 2

Tolerances



Scale 2:1

All rights reserved.
 Only for information.
 To insure that this is the latest
 version of this drawing, please
 contact one of the ERNI companies
 before using.

Subject to modification without
 prior notice.
 Drawing will not be updated.

Designation

ERmetZD Messerleiste abg. 2-10
 ERmetZD Male Con. angle 2-10

ERNI www.ERNI.com

204780

1

b 30.01.2012
 Index Date

H:00057739.SZA

ERMZD

Mouser Electronics

Authorized Distributor

Click to View Pricing, Inventory, Delivery & Lifecycle Information:

[ERNI Electronics:](#)

[204780](#)