

TABLE 1		TABLE 2				
DASH NO	DESCRIPTION	DASH NO	ØA	ØB	C DIM	D DIM
-1	NO CHAIN	-D2	.630	.750	1.066	.450
-2	2.5 BRASS CHAIN	-D3	.505	.625	.941	.388
-3	2.5 NYLON CHAIN	-D4	.439	.562	.878	.355
-4	3.0 BRASS CHAIN	-D5	.380	.500	.816	.325
-5	3.0 NYLON CHAIN	-D6	.317	.437	.753	.295
-6	6.0 BRASS CHAIN	-D7	.281	.406	.722	.278
-7	6.0 NYLON CHAIN	-D8	.610	.750	1.066	.450
-8	4.0 BRASS CHAIN	-D9	.567	.687	1.003	.419
-9	4.0 NYLON CHAIN	-D10	.192	.312	.628	.231
-10	10.0 BRASS CHAIN	-DD8	.330	.450	.766	.300
-11	10.0 NYLON CHAIN					
-12	2.5 SST ROPE					
-13	3.0 SST ROPE					
-14	6.0 SST ROPE					
-15	4.0 SST ROPE					
-16	7.0 SST ROPE					
-17	4.5 SST ROPE					
-18	12.0 SST ROPE					
-19	18.0 SST ROPE					

DATA CONTAINED IN THIS DOCUMENT IS PROPRIETARY TO TROMPETER ELECTRONICS INC. AND SHALL NOT BE DISCLOSED, COPIED OR USED FOR PROCUREMENT OR MANUFACTURE WITHOUT EXPRESS WRITTEN PERMISSION.

REVISIONS

REV	DESCRIPTIONS	DATE	APPROVED
U	REVISED PER ECO # 16769	10/14/08	ORmos

TABLE 3				
KEYING LETTER	E DEGREES	F DEGREES	G DEGREES	COLOR BAND
NONE	120°	120°	120°	NONE
T	100°	150°	110°	RED
U	120°	130°	110°	ORANGE
V	115°	130°	115°	YELLOW
W	125°	110°	125°	GREEN
X	130°	100°	130°	BLUE
Y	110°	140°	110°	VIOLET
Z	100°	160°	100°	GRAY
S	135°	135°	90°	WHITE

TABLE 4	
MODEL NUMBER	
RF175	3-LUG
RF175FL	4-LUG

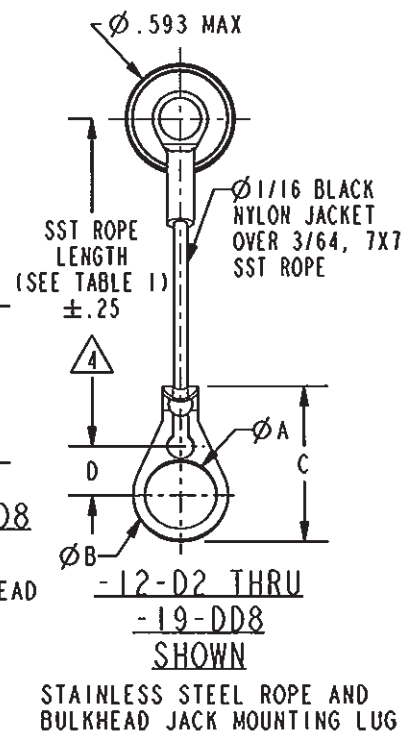
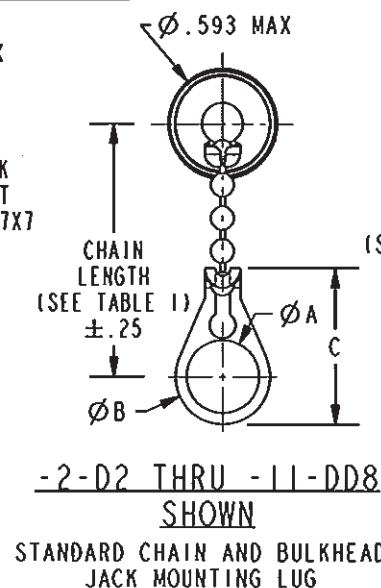
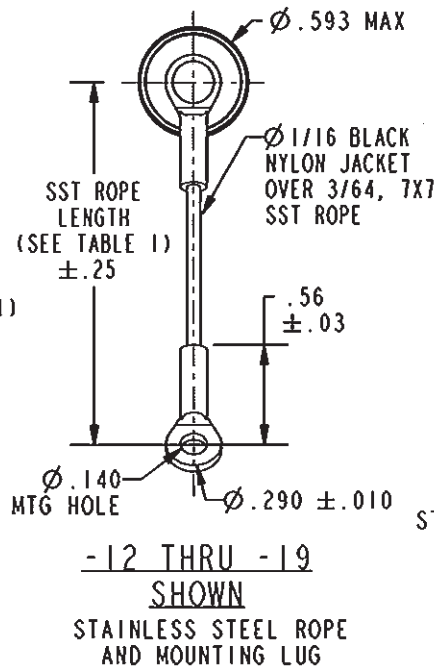
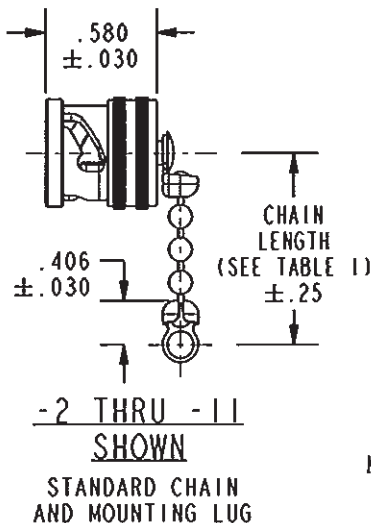
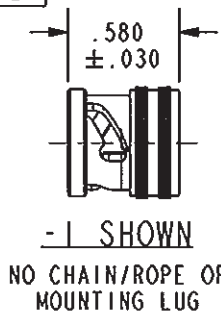
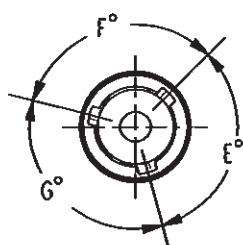

3. EXAMPLE OF COMPLETE MODEL NUMBER:

MODEL NO (SEE TABLE 4) RF175 I -3 -D3
 POLORIZATION LETTER NOT REQ'D FOR STD POLORIZATION (SEE TABLE 3)
 BULKHEAD JACK MOUNTING LUG (OPTIONAL) ONLY AVAILABLE WITH BRASS OR NYLON CHAIN (SEE TABLE 2)
 CHAIN/ROPE MAT'L AND LENGTH (SEE TABLE 1)

2. FINISH: TFS-1A (NICKEL)

1. 3 AND 4 LUG BNC/TRB DUST CAP WITH CHAIN/ROPE OR MOUNTING LUG OPTIONS

RED INDICATES ORIGINAL

NOTES: UNLESS OTHERWISE SPECIFIED.

NOTE THAT LENGTH FOR SST ROPE WITH MOUNTING LUG OPTION IS NOT MEASURED TO CENTER OF BULKHEAD MOUNTING LUG

INTERPRET DRAWING PER MIL-STD-100. DIMENSIONS ARE IN INCHES AND INCLUDE FINISH THICKNESS UNLESS OTHERWISE SPECIFIED.

TOL: UNLESS SPECIFIED.
 .XX ± .02
 .XXX ± .010
 ANGLE ± 1°

TROMPETER
 RF connectivity
 a cinch connectivity solutions brand

DATE: 09-12-08
 MATERIAL:
 FINISH:
 SCALE: 2/1

TITLE: RF175/RF175FL T/U/V/W/X/Y/Z/S
 SIZE: A
 CAGE CODE: 14949
 DRAWING NO.: 305-0001
 REV.: U
 DATE: 10-4-67
 SHEET: 1C

Mouser Electronics

Authorized Distributor

Click to View Pricing, Inventory, Delivery & Lifecycle Information:

[Cinch Connectivity Solutions:](#)

[RFI75-2](#)