

# DA Series Miniature Single Pole Rocker Switches

## Features/Benefits

- Nice actuator styling with multiple options
- Guards to prevent accidental actuation
- Momentary and maintained functions
- IP65 splash proof rubber boot option
- RoHS compliant

## Typical Applications

- Small appliances
- Computers and peripherals
- Medical instrumentation



**UL** US **UL 61058-1**

## Specifications

### CONTACT RATING:

- 16 AMPS @ 125 VAC, 1/3 HP;
- 10 AMPS @ 250 VAC, 1/2 HP.
- 10 AMPS @ 125 VAC, 6 AMPS @ 250 VAC.

ELECTRICAL LIFE: 10,000 make and break cycles at full load.

INSULATION RESISTANCE:  $10^8 \Omega$  min.

DIELECTRIC STRENGTH: 1,500 VRMS @ sea level.

OPERATING TEMPERATURE: -20°C to +85°C

## Materials

HOUSING AND ACTUATOR: 6/6 nylon (UL94V-2), black, matte finish.

ILLUMINATED ACTUATOR: Polycarbonate, matte finish.

CENTER CONTACTS: Silver plated, copper alloy.

END CONTACTS: Silver plated.

ALL TERMINALS: Silver plated, copper alloy.

**NOTE:** Specifications and materials listed above are for switches with standard options. For information on specific and custom switches, consult Customer Service Center.

## Build-A-Switch

To order, simply select desired option from each category and place in the appropriate box. Available options are shown and described on pages G-57 through G-59. For additional options not shown in catalog, consult Customer Service Center.

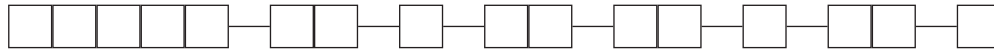

### Switch Function

- DA101** SPDT On-None-On
- DA102** SPST On-None-Off
- DA103** SPDT On-Off-On

### Actuator

- J1** Rocker
- J2** Two-tone rocker
- \*, \*\*J3** Illuminated rocker
- \*\* J4** Circle, illuminated rocker
- \*\* J5** Oval, illuminated rocker

### Actuator Color

- 1-5** See Chart on Page G-59
- \*R** Red, illuminated
- \*A** Amber, illuminated
- \*G** Green, illuminated

\* Actuator "J3" illuminated switches are not available with actuator markings

\*\* Actuator "J3", "J4" and "J5" are not available with Termination option "17" solder lug

### Mounting Style/Color

- S2** Snap-in, black
- S1** Snap-in, white
- B2** Recessed snap-in bracket, black
- G2** Guard, black

### Termination

- 15** .187" quick connect
- 17** Solder lug
- 02** Thru-hole
- A** Right angle

### Actuator Marking

- (NONE)** No marking
- D** ON-OFF
- H** "O I" - international ON-OFF
- N** Large dot
- P** "O -" international ON-OFF

### Contact Rating

- QF** Silver

### Lamp Rating

- (NONE)** No lamp
- 6** LED
- 7** 125 VAC neon
- 8** 250 VAC neon



Dimensions are shown: Inches (mm)  
Specifications and dimensions subject to change



# DA Series Miniature Single Pole Rocker Switches

## SWITCH FUNCTION

NO. POLES	MODEL NO.	SWITCH FUNCTION			CONNECTED TERMINALS			SCHEMATIC
		C&K marking on opposite side			C&K marking on opposite side			
SP	<b>DA101</b>	ON	NONE	ON	2-3	N/A	2-1	
	<b>DA102</b>	ON	NONE	OFF				 For 7 & 8 Illuminated Versions Only
	<b>DA103</b>	ON	OFF	ON				 For 6 Illuminated Versions Only

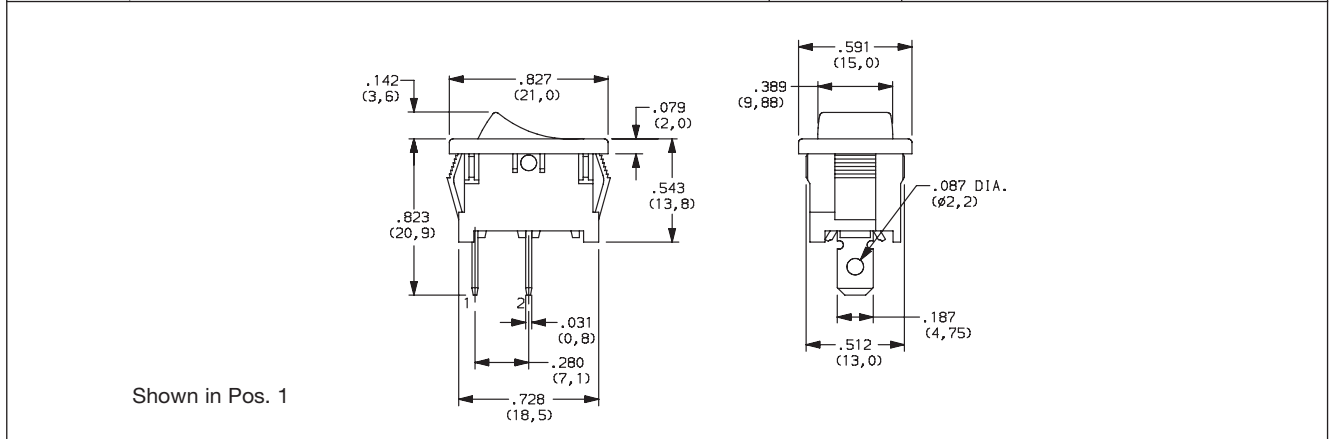

## ACTUATOR

- J1** ROCKER
- \*J3** ILLUMINATED ROCKER

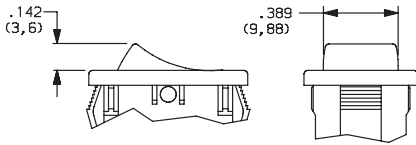

**NOTE:** J3 actuator available with DA102 switch functions, 7&8 lamp ratings and not available with O2 and A termination options.

\* J3 actuator not available with markings or Termination option "17" solder lug

- J2** TWO-TONE ROCKER

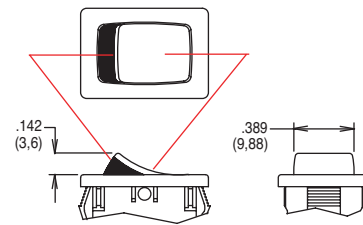

**NOTE:**

1. Available with DA102 switch function only.
2. Available with None or P actuator marking options only.

Rocker

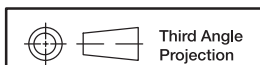

Dimensions are shown: Inches (mm)  
Specifications and dimensions subject to change



# DA Series Miniature Single Pole Rocker Switches

## ACTUATOR

### J4 CIRCLE, ILLUMINATED ROCKER

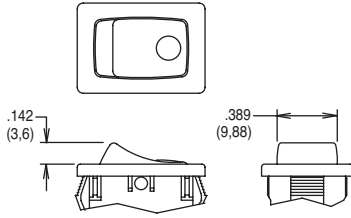

**NOTE:** Available with DA102 switch function and 7 & 8 lamp ratings combinations only. Not available with O2 and A termination options. \* J4 actuator not available with Termination option "17" solder lug

### J5 OVAL, ILLUMINATED ROCKER

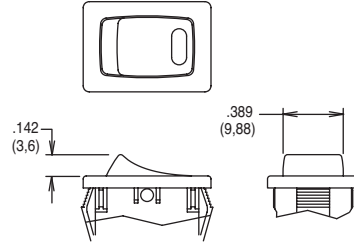

**NOTE:** Available with DA102 switch function and 6 lamp rating combinations only. Not available with O2 and A termination options. \* J5 actuator not available with Termination option "17" solder lug

## ACTUATOR COLOR

J1 only	OPTION CODE	ACTUATOR COLOR
		BLACK
	<b>1</b>	WHITE
	<b>3</b>	RED

J3, J4, J5 only	OPTION CODE	ACTUATOR COLOR
	<b>R</b>	RED, ILLUMINATED
	<b>A</b>	AMBER, ILLUMINATED
	<b>G</b>	GREEN, ILLUMINATED

J2 only	OPTION CODE	ACTUATOR COLOR	
		TOP	BOTTOM
	<b>1</b>	WHITE	RED
	<b>2</b>	WHITE	BLACK
	<b>3</b>	RED	WHITE
	<b>4</b>	BLACK	WHITE
<b>5</b>	BLACK	RED	

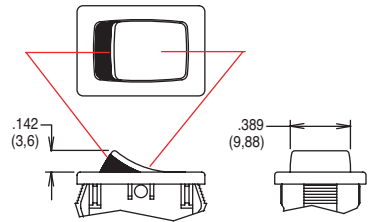

## MOUNTING STYLE/COLOR

### S2 SNAP-IN, BLACK

### S1 SNAP-IN, WHITE

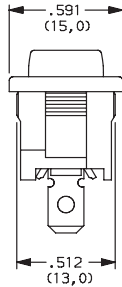
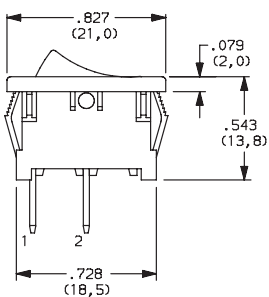

### G2 GUARD, BLACK

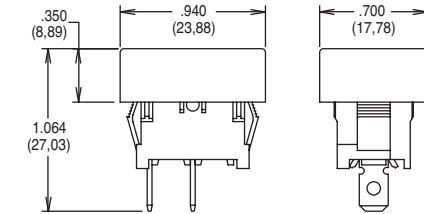

**NOTE:** Available with DA10X switch functions only.

### S2, S1 & G2 PANEL MOUNTING

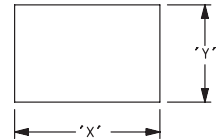

PANEL THICKNESS	"X"	"Y"
0.030-0.049 (0,75-1,25)	0.756-.004 (19,2-0,1)	0.512+.004 (13,0+0,1)
0.049-0.079 (1,25-2,0)	0.764-.004 (19,4-0,1)	0.512+.004 (13,0+0,1)
0.079-0.118 (2,0-3,0)	0.779-.004 (19,8-0,1)	0.512+.004 (13,0+0,1)

Actuator shown in Pos. 1

### B2 RECESSED SNAP-IN BRACKET, BLACK

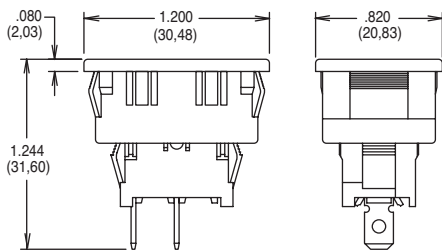

**NOTE:** Available with DA10X switch functions only.

### B2 PANEL MOUNTING

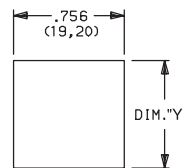

PANEL THICKNESS	"Y"
0.030-0.049 (0,75-0,25)	1.068 (27,13)
0.049-0.079 (1,25-2,0)	1.076 (27,33)
0.079-0.118 (2,0-3,0)	1.092 (27,74)



Dimensions are shown: Inches (mm)  
Specifications and dimensions subject to change



# DA Series Miniature Single Pole Rocker Switches

## TERMINATION

### 15 .187" QUICK CONNECT

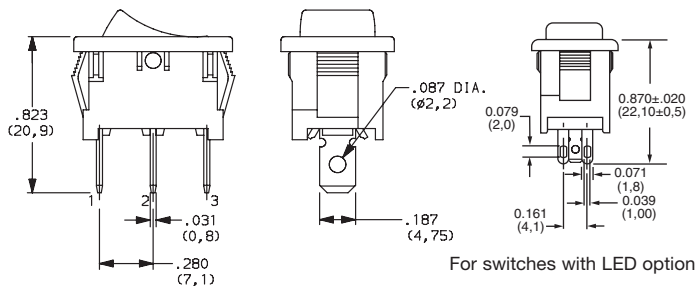

### 17 SOLDER LUG

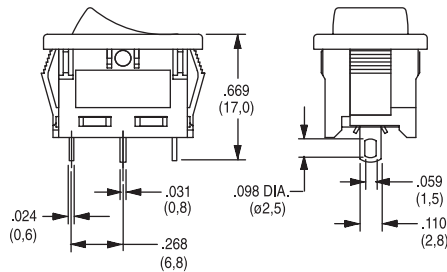

### 02\* THRU-HOLE

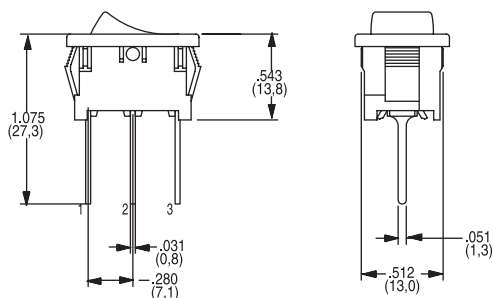

### A\* RIGHT ANGLE

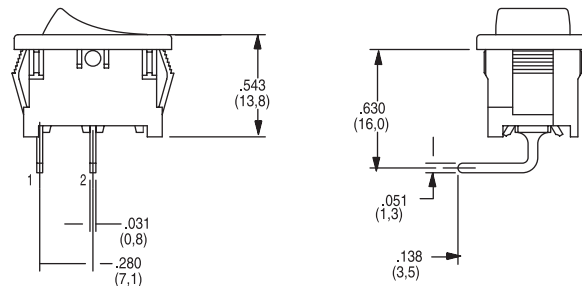

\* NOTE - O2 and A termination options not offered with J3, J4 or J5 actuator options.

## ACTUATOR MARKING

### NONE NO MARKING

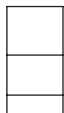

### D ON-OFF

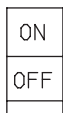

### H O I

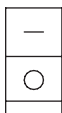

### N LARGE DOT



### P O -

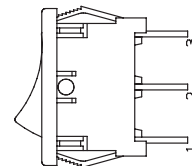

All models shown in Pos. 1  
Markings not available with J3 actuator

NOTE: Orientation of actuator marking and terminals.

## CONTACT MATERIAL

OPTION CODE	CONTACT AND TERMINAL MATERIAL	RATINGS	
QF	SILVER	POWER	16 AMPS @ 125 VAC; 1/3 HP; 10 AMPS @ 250 VAC; 1/2 10 AMPS @ 125 VAC, 6 AMPS @ 250 VAC

\* Note: See Technical Data section of this catalog for RoHS compliant and compatible definitions and specifications.

## LAMP RATING

- (NONE) NO LAMP
- 6 LED RATING @ 10 mA  $V_f=1.85V$
- 7 125 VAC 33kΩ NEON
- 8 250 VAC 150kΩ NEON

## ACCESSORIES

### 216C00000 IP65 SPLASH PROOF RUBBER BOOT

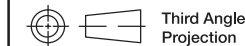
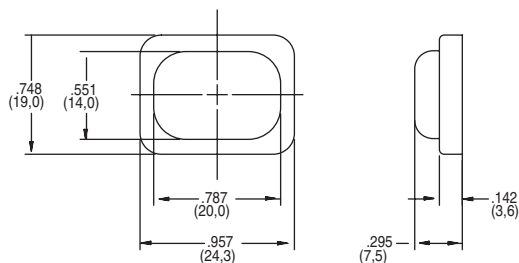

Dimensions are shown: Inches (mm)  
Specifications and dimensions subject to change

# Mouser Electronics

Authorized Distributor

Click to View Pricing, Inventory, Delivery & Lifecycle Information:

## C&K Switches:

[DA101J12S217QF](#) [DA101J12S215QF](#) [DA101J11S115QF](#) [DA101J11S215QF](#) [DA102J12S217QF](#)  
[DA102J12S215PQF](#) [DA102J5RS215QF6](#) [DA102J12S215HQF](#) [DA102J3GS215QF8](#) [DA102J3RS215QF7](#)  
[DA102J3RS215QF8](#) [DA102J11S215PQF](#) [DA102J3GS215QF7](#) [DA102J11S215QF](#) [DA102J12S215DQF](#)  
[DA102J3AS215QF7](#) [DA102J21S215PQF](#) [DA102J12S215QF](#) [DA102J23S215PQF](#) [DA102J4RS215QF7](#)  
[DA102J3AS215QF8](#) [DA102J12B215QF](#) [DA102J22S215PQF](#) [DA101J11B215PQF](#) [DA101J11S117QF](#)  
[DA102J11S115QF](#) [DA102J11S117PQF](#) [DA102J12G215DQF](#) [DA102J12S217PQF](#) [DA102J5GG215QF6](#)  
[DA103J12S215HQF](#) [DA103J12S215QF](#) [DA103J12S217QF](#) [DA12J3GB215PQF7](#) [DA12J3GS215HQF6](#)  
[DA12J3RS215PQF6](#) [DA102J12B215DQF](#) [DA101J12B215PQF](#) [DA102J12S217HQF](#) [DA102J5GS215QF6](#)  
[DA102J13S215DQF](#)