

THIS DRAWING IS UNPUBLISHED. RELEASED FOR PUBLICATION  
 © COPYRIGHT - By - ALL RIGHTS RESERVED.

| LOC | DIST | REVISIONS |     |                           |         |     |      |
|-----|------|-----------|-----|---------------------------|---------|-----|------|
| G   | 14   | P         | LTR | DESCRIPTION               | DATE    | DWN | APVD |
|     |      | J2        |     | REVISED PER ECO-11-004820 | 11MAR11 | RK  | HMR  |

|                                |                                |                                |
|--------------------------------|--------------------------------|--------------------------------|
| <b>AMP</b><br>WIRE RANGE       | Listed<br>FILE E13288          | LR7189<br>Certified            |
| 16-14 AWG<br>SOLID OR STRANDED | 16-14 AWG<br>SOLID OR STRANDED | 16-14 AWG<br>SOLID OR STRANDED |

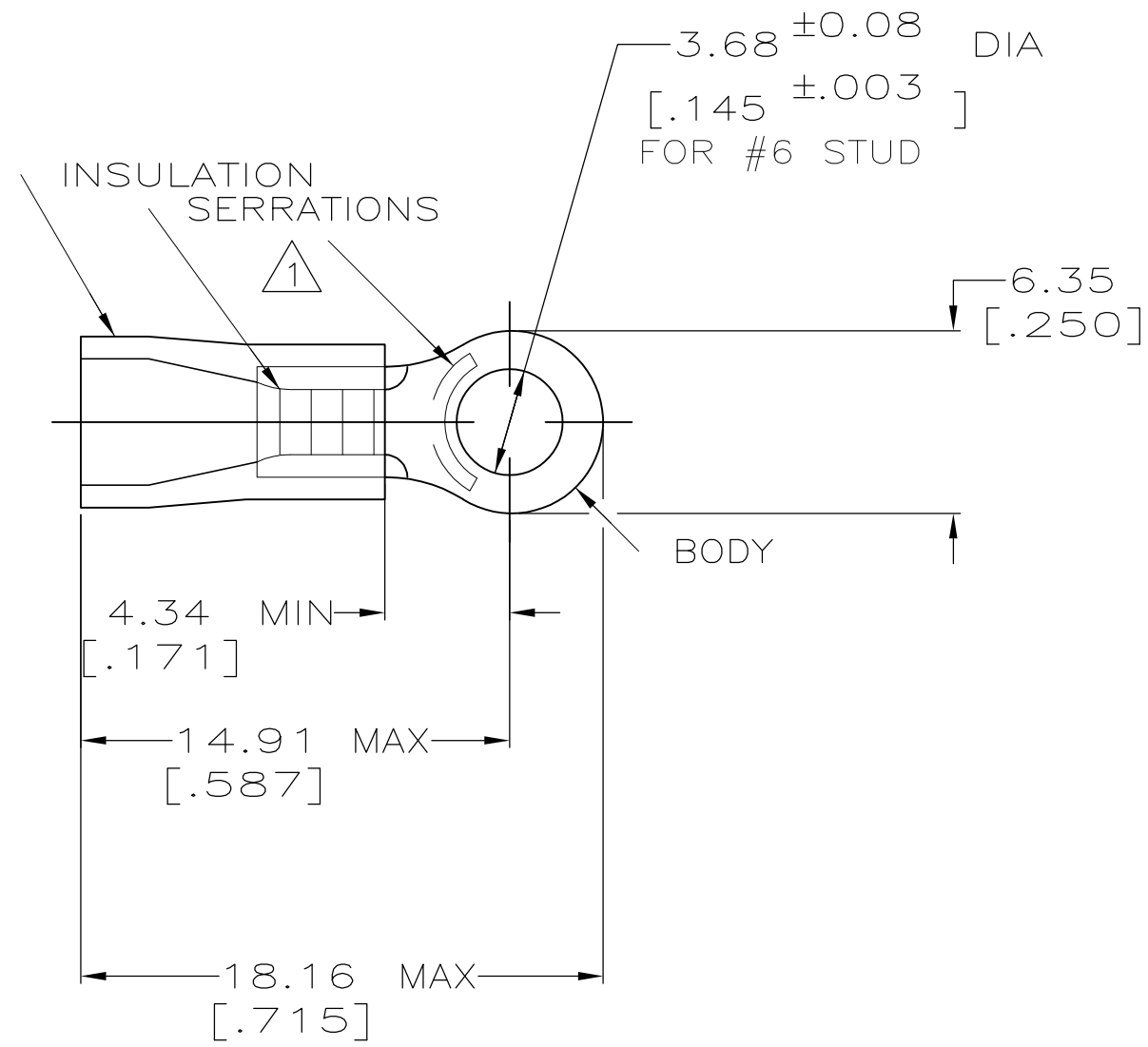

- △1 STAMP AMP 16-14\* APPROX AS SHOWN
- 2 WIRE INSULATION DIA: 3.00-4.90 [.118-.193]
- 3 TONGUE MATERIAL THK: 0.79<sup>±0.05</sup> [.031<sup>±0.002</sup>]
- △4 SUPERSEDED BY 8-34158-1
- △5 MATERIAL: BODY - CU PER ASTM B152  
SLEEVE - PVC, COLOR - BLUE

|      |               |              |
|------|---------------|--------------|
| 50   | LOOSE PC,BAG  | 8-34158-5 △4 |
| 100  | LOOSE PC,BOX  | 8-34158-1    |
| 5000 | ON TAPE, REEL | 2-34158-1    |
| -    | LOOSE PIECE   | 34158        |
| QTY  | PACKAGE TYPE  | PART NO.     |

|  |  |   |  |  |                                   |                          |                    |                       |                    |
|--|--|---|--|--|-----------------------------------|--------------------------|--------------------|-----------------------|--------------------|
| <b>AMP INCORPORATED<br/>CUSTOMER SERVICE SYSTEMS</b>                             |  | MAX RECOMMENDED OPERATING TEMPERATURE:<br>105°C [221° F]                          | THIS DRAWING IS A CONTROLLED DOCUMENT. |  | DWN<br>DK SCHRUM 08/06/92         | TE Connectivity          |                    |                       |                    |
| FOR ADDITIONAL PRODUCT INFORMATION OR COPIES OF DRAWINGS AND TECHNICAL DOCUMENTS | PRODUCT INFORMATION CENTER<br>1-800-522-6752 | VOLTAGE RATING:<br>N/A  | DIMENSIONS:<br>MM [INCHES]             | TOLERANCES UNLESS OTHERWISE SPECIFIED:   | CHK<br>RE HERSEY 11/10/92         |                          |                    |                       | NAME<br>M BARNABA  |
| FOR APPLICATION TOOLING INFORMATION  | TOOLING ASSISTANCE CENTER<br>1-800-722-1111  | CIRCULAR MIL AREA:<br>1.04-2.62mm <sup>2</sup> [2,050-5,180]<br>SOLID OR STRANDED |  | 0 PLC ± -<br>1 PLC ± -<br>2 PLC ± 0.20[.008]<br>3 PLC ± -<br>4 PLC ± -<br>ANGLES ± - | APVD<br>M BARNABA 11/10/92        | PRODUCT SPEC<br>108-1034 |                    |                       |                    |
| FOR ORDER ENTRY  | 1-800-526-5142                               |   | MATERIAL<br>- △5                       | FINISH<br>TIN PER ASTM B545  | APPLICATION SPEC<br>NOT AVAILABLE | SIZE<br>A3               | CAGE CODE<br>00779 | DRAWING NO<br>C-34158 | RESTRICTED TO<br>- |
|  |  |   |  |  | CUSTOMER DRAWING                  | SCALE<br>4:1             | SHEET<br>1 OF 1    | REV<br>J2             |                    |

# Mouser Electronics

Authorized Distributor

Click to View Pricing, Inventory, Delivery & Lifecycle Information:

[TE Connectivity:](#)

[8-34158-1](#)