

REV.	DATE	DESCRIPTION
A	11/26/03	UPDATE DRAWING FORMAT

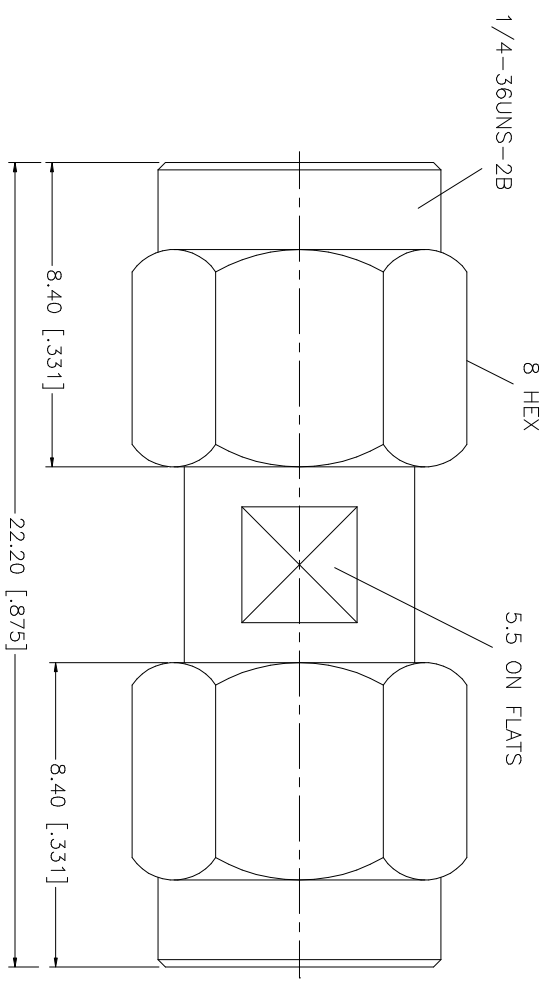

QTY	FINISH	MATERIAL	DESCRIPTION
1	GOLD	BER.COPPER	CONTACT PIN
1	NATURAL	TEFLON	INSULATOR
1	GOLD	BRASS	BODY

UNLESS OTHERWISE SPECIFIED DIMENSIONS ARE IN INCHES AND FOR CUSTOMER REFERENCE ONLY.	UNLESS OTHERWISE SPECIFIED TOLERANCES FOR MILLING ARE:	UNLESS OTHERWISE SPECIFIED DIMENSIONS ARE IN MILLIMETERS AND FOR CUSTOMER REFERENCE ONLY.
	0.5 - 8mm ± 0.20mm	
	8 - 30mm ± 0.40mm	
	30 - 120mm ± 0.50mm	
	UNLESS OTHERWISE SPECIFIED TOLERANCES FOR INCHES ARE:	
	.020 - .315 = ± 0.007"	
	.315 - 1.180 = ± 0.015"	
	1.180 - 4.724 = ± 0.020"	

APPROVALS	DATE
DRAWN G.R.S.	11/26/03
CHECKED	
ISSUED	
SHEET 1 OF 1	

CAD FILE	DWG. NO.	REV.	SIZE	SCALE
C:/132/132168.DWG	132168.DWG	A	A	NA

PART DESCRIPTION	PART NO.
Amphenol Connex	132168
SMA PLUG ADAPTER	

Mouser Electronics

Authorized Distributor

Click to View Pricing, Inventory, Delivery & Lifecycle Information:

[Amphenol:](#)

[132168](#)