

BI-COLOR LEADS
OPERATING CHARACTERISTICS AT $T_A = 25^\circ\text{C}$

ABSOLUTE MAXIMUM RATINGS @ 25 °C		SYMBOL	PARAMETER	COLOR	MIN	TYP	MAX	UNITS	TEST COND.
CONTINUOUS FORWARD CURRENT	30 mA	V_f	FORWARD VOLTAGE	RED	2.0	2.6	2.6	V	$I_f = 10\text{ mA}$
OPERATING TEMPERATURE	-55 TO +100 °C		GREEN	2.0	2.6				
STORAGE TEMPERATURE	-55 TO +100 °C								
REFLOW TEMPERATURE: CONVECTION IR	235°C PEAK, ABOVE 185°C FOR 90 SEC.	λ_{DOM}	DOMINANT WAVELENGTH	RED	628			nm	
VAPOR PHASE	215°C FOR 3 MIN.		GREEN	570					
		I_v	LUMINOUS INTENSITY	RED	6.5			mcd	$I_f = 20\text{ mA}$
			GREEN	8.0					

REV.	ECN NO.	REVISIONS	DRN.	CKD.	APP.	DATE
D		REDRAWN WITH CHANGES, NEW LENS AND HOUSING DESIGN. ADDED NOTE 6, 7; DOMINANT WAVELENGTH VALUE WAS PEAK WAVELENGTH VALUE.	YY		N.O.	3-8-94
E		REVERSED LED DIAGRAM TO MATCH WITH LAND PATTERN. ADDED IR REFLOW TEMPERATURE PROFILE.	YY		MC	11-4-98
F		ADDED NOTE 9	YIS			

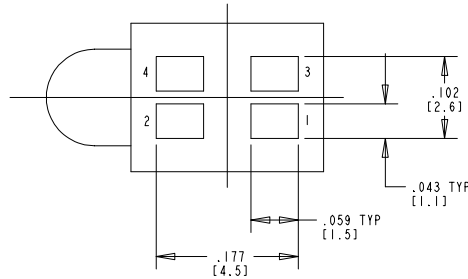
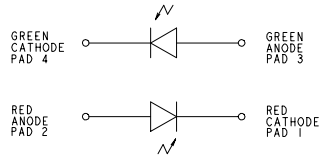

COMPONENT SIDE
RECOMMENDED PC BOARD LAND PATTERN
(DIM'S ±.004)
0.1MM

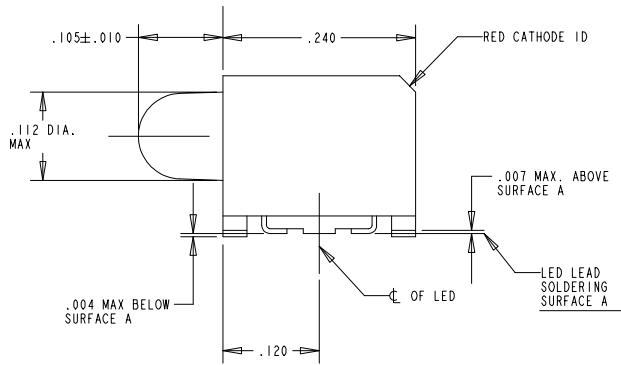
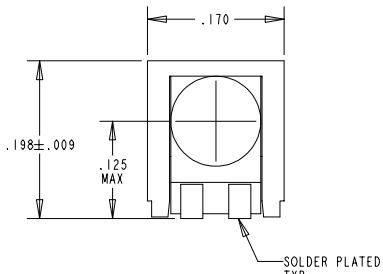
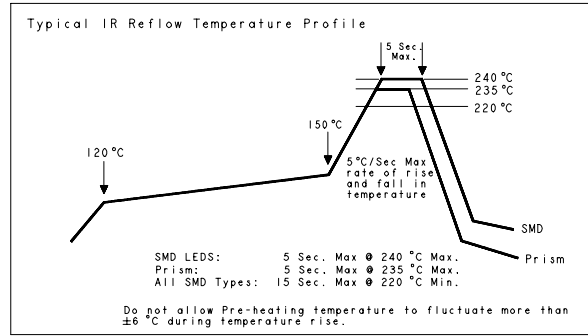

NOTES:

- MILLIMETER DIMENSIONS SHOWN FOR REFERENCE ONLY.
- PAD NUMBERS FOR REFERENCE ONLY, DESIGNATION NON-EXISTENT ON PART.
- STORAGE CONDITIONS FOR TAPED PRODUCT: RE-TAPING MAY BE NECESSARY FOR PRODUCT STORED MORE THAN TWELVE MONTHS.
- ORDER QUANTITY IS LED ASSEMBLIES, NOT REELS.
- 001 SUFFIX MEANS PARTS ARE PACKED IN A BAG, 100 PCS PER BAG.
-002 SUFFIX MEANS PARTS ARE PACKED ON A 20 PCS SAMPLE STRIP.
-007 SUFFIX MEANS PARTS ARE PACKED ON A 7 INCH REEL, 400 PCS/REEL.
-013 SUFFIX MEANS PARTS ARE PACKED ON A 13 INCH REEL, 1600 PCS/REEL.
- LENS MOVEMENT IN RELATIONSHIP TO THE HOUSING IS:
.009" T.I.R. VERTICALLY.
.007" T.I.R. HORIZONTALLY.
- FRONT AND REAR TERMINALS OF ASSEMBLY TO BE WITHIN .005 COPLANARITY.
- DIALIGHT PART NUMBER: 591-3001-001, 591-3001-002
591-3001-007, 591-3001-013
- DEVICE HAS A MOISTURE SENSITIVITY LEVEL "2" CAUTION LABEL APPLIED AS PER JEDEC STD. 033

TAPING SPECIFICATION

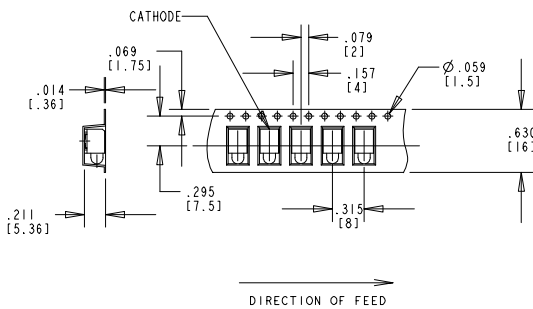

TOLERANCE: .004 UNLESS OTHERWISE SPECIFIED.
MILLIMETER DIMENSIONS SHOWN FOR REFERENCE ONLY.

REEL SPECIFICATION

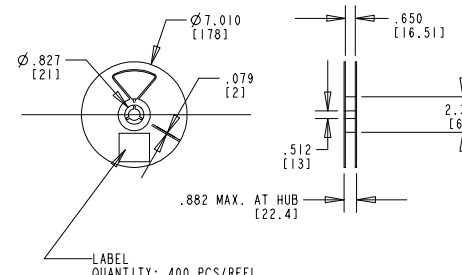
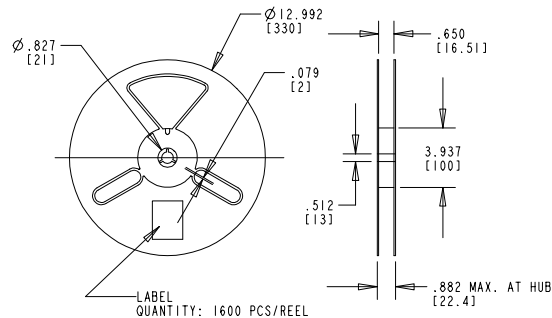

THIS DRAWING AND THE CONTENTS HEREIN ARE CONFIDENTIAL AND THE SOLE PROPERTY OF DIALIGHT. REPRODUCTION OF THIS DRAWING OR CONSTRUCTION OF ANY PARTS WITHIN THIS DRAWING ARE FORBIDDEN WITHOUT THE WRITTEN CONSENT OF DIALIGHT.		
SCALE 8:1	DRAWING NUMBER	REV
ALL DIM'S IN: INCHES	C-15739	F
TOLERANCES: UNLESS OTHERWISE SPECIFIED	TITLE	
FRACTIONS: ±1/64	MATERIAL	
DECIMALS (.XX): ±.020	FINISH:	
DECIMALS (.XXX): ±.005	Dialight	
ANGLES: ±3°	1501 ROUTE 34 SOUTH FARMINGDALE, NJ 07727	
FSCM 83330	SHEET OF	FAMILY TABLES: