

- NOTE-1: NORMINATIVE REF = IEC-61076-4-104  
NOTE-2: ONE CENTER PEG FOR HOLD DOWN FORCE  
NOTE-3: CODING RECESS FOR 8MM EXTENDED KEYS  
NOTE-4: PRODUCT MARKING = PRODUCT NUMBER + BATCH CODE + FCI  
FOR 1 MODULE SIZE,END OF PART NUMBER ONLY  
NOTE-6: CENTRAL WALL WITH END REAR SUPPORT  
NOTE-7: PACKAGING IN TRAY + COVER  
IF SUFFIX "P" IS ADDED IN P/N PACKAGING IS IN TRAYS  
BUT CONNECTOR MARKING IS WITHOUT "P"  
EXAMPLE: HM1XXXXXXXXXH6P, MARKED HM1XXXXXXXXXH6

GENERAL CHARACTERISTICS AND ROHS INFORMATIONS:  
SEE PRODUCT SPECIFICATION GS-12-446

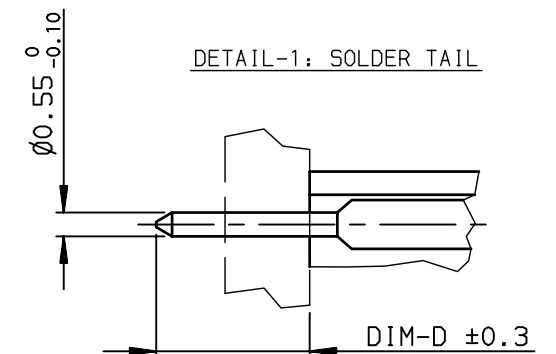
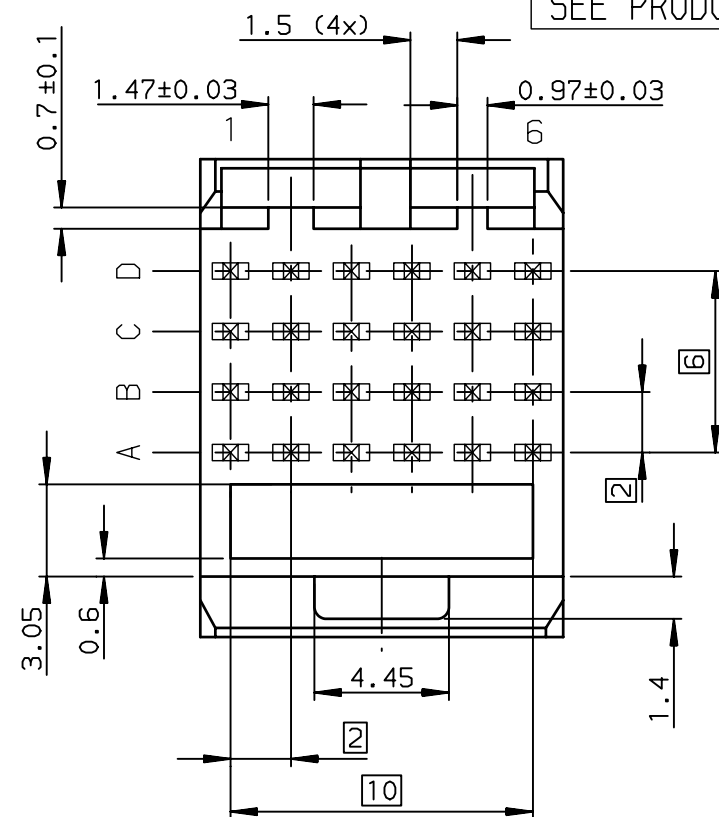

OTHERS INFORMATIONS,SEE DRW C-8626-0154-2

European Views

rev	ecn no	dr	date
G	-	CHA	2003/06/26
H	LS05-001	MRA	2005/01/19
J	LS05-0056	LGO	2005/07/06
K	LS06-0097	LGO	2006/07/12
L	LS07-0184	MLE	2007/07/24
-	-	-	-
-	-	-	-

www.fciconnect.com			surface ISO 1302			tolerance std ISO 406 ISO 1101		projection 	
			TOLERANCES UNLESS OTHERWISE SPECIFIED						
Dr	CHAMPION	1994/04/06	ANGULAR  LINEAR		0.X	±0.1	size  A3	Scale  4	
Eng	LENOIR	1994/04/06			0.XX	±0.1			
Chr	LEGARE	1994/04/06		0.XX* ±2*	0.XXX	±0.1			
Appr	LEGARE	1994/04/06	Product family METRAL				ECN LS07-0184		Spec ref -
			title METRAL RA HEADER WB CONVE 4x6 CTS - STB - PUSH PEG				dwg no C-8626-0154-1		Rev. L
catalog no			-				CUSTOMER	sheet 1 of 2	



# Mouser Electronics

Authorized Distributor

Click to View Pricing, Inventory, Delivery & Lifecycle Information:

[FCI / Amphenol:](#)

[HM1L41DAP000H6PLF](#) [HM1L41LAP000H6PLF](#) [HM1L41AAP000H6PLF](#)