

# SMD Power Inductor CDRR94

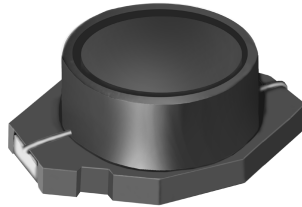

## Description

- Ferrite drum core construction.
- Magnetically shielded.
- L × W × H: 12.9 × 9.4 × 5.0mm Max.
- Product weight: 0.85g(Ref.)
- Moisture Sensitivity Level: 1
- RoHS compliance.

## Environmental Data

- Operating temperature range: -40°C~+100°C (including coil's self temperature rise)
- Storage temperature range: -40°C~+100°C
- Solder reflow temperature: 260 °C peak.

## Packaging

- Carrier tape and reel packaging.
- 12.9" diameter reel
- 500pcs per reel

## Applications

- Ideally used in Portable Computers, Video Recorder, DSC/DVC, etc as DC-DC Converter inductors.

## Dimension - [mm]

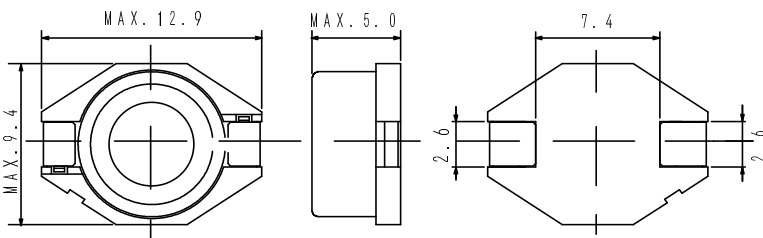

## Land pattern and Schematics - [mm]

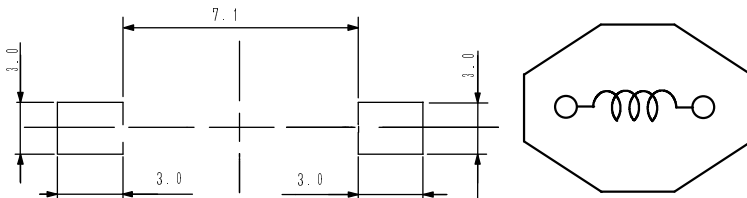

# SMD Power Inductor CDRR94



## Electrical Characteristics

Part Name	Stamp	Inductance ( $\mu$ H) [ within ] ※1	D.C.R. (m $\Omega$ ) Max. (Typ.) (at 20°C)	Saturation Current (A) ※2	Temperature Rise Current (A) ※3
CDRR94NP-1R0MC	1R0	1.0 $\pm$ 20%	15.3(12.2)	10.8	5.0
CDRR94NP-1R5MC	1R5	1.5 $\pm$ 20%	16.9(13.5)	9.6	4.5
CDRR94NP-2R2MC	2R2	2.2 $\pm$ 20%	27.5(22.0)	7.2	3.4
CDRR94NP-3R3MC	3R3	3.3 $\pm$ 20%	38.8(31.0)	6.2	2.7
CDRR94NP-4R7MC	4R7	4.7 $\pm$ 20%	50.6(40.5)	5.4	2.5
CDRR94NP-6R8MC	6R8	6.8 $\pm$ 20%	70.6(56.5)	4.4	2.1
CDRR94NP-100MC	100	10 $\pm$ 20%	91.3(73.0)	3.0	1.9
CDRR94NP-120MC	120	12 $\pm$ 20%	112.5(90)	3.2	1.6
CDRR94NP-150MC	150	15 $\pm$ 20%	150.0(120)	2.8	1.3
CDRR94NP-180MC	180	18 $\pm$ 20%	182.5(146)	2.6	1.2
CDRR94NP-220MC	220	22 $\pm$ 20%	197.5(158)	2.4	1.1
CDRR94NP-270MC	270	27 $\pm$ 20%	269.0(215)	2.1	0.95
CDRR94NP-330MC	330	33 $\pm$ 20%	298.0(238)	1.9	0.90
CDRR94NP-390MC	390	39 $\pm$ 20%	397.0(317)	1.7	0.75
CDRR94NP-470MC	470	47 $\pm$ 20%	435.0(348)	1.6	0.70
CDRR94NP-680MC	680	68 $\pm$ 20%	670.0(536)	1.3	0.55
CDRR94NP-820MC	820	82 $\pm$ 20%	898.0(718)	1.2	0.45
CDRR94NP-101MC	101	100 $\pm$ 20%	1063.0(850)	1.0	0.40

※1. Inductance measuring condition: at 100 kHz.

※2. Saturation current: The value of D.C. current when the inductance decreases to 90% of it's nominal value.

※3. Temperature rise current: The value of D.C. current when the temperature rise is  $\Delta t=40^{\circ}\text{C}$  ( $T_a=20^{\circ}\text{C}$ ).

# SMD Power Inductor CDRR94



## Saturation Current & Temperature Rise Graph

— L (20°C)    —  $\Delta T$

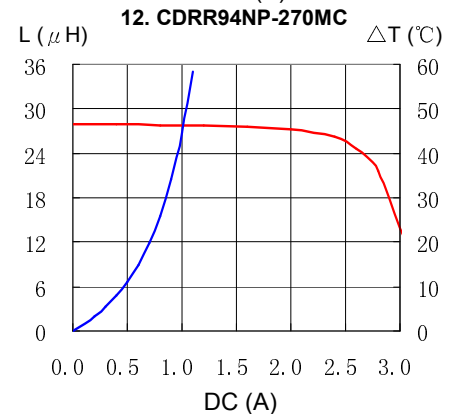
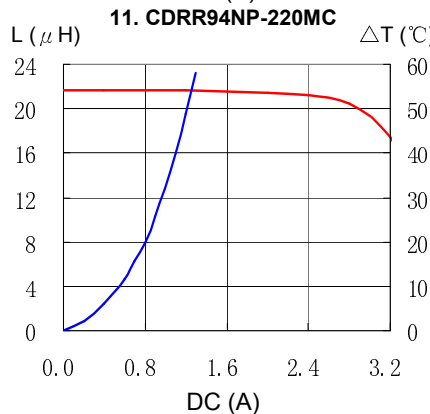
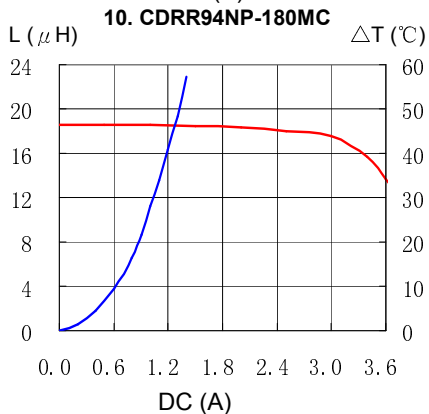
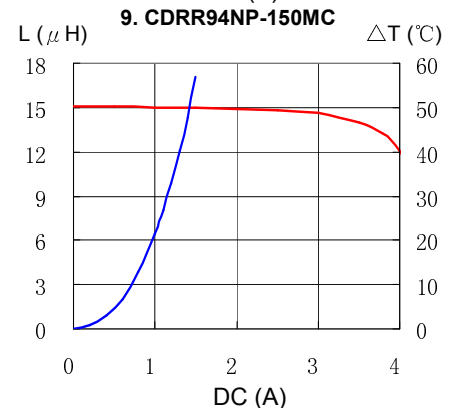
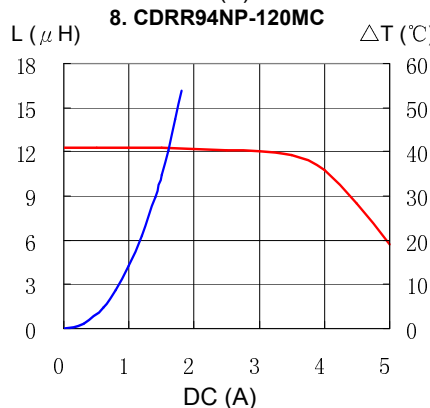
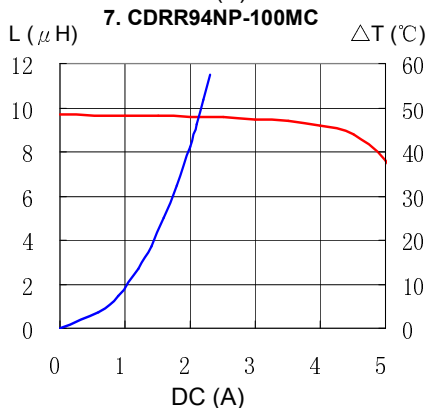
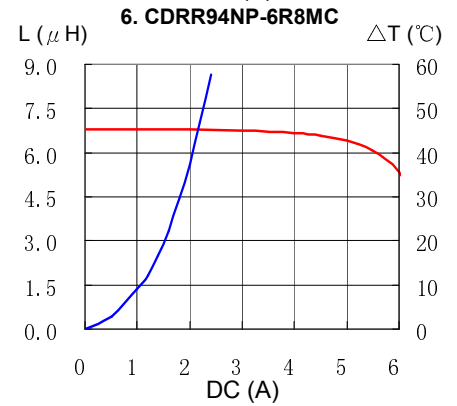
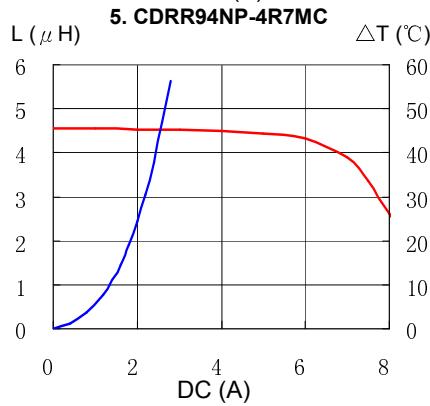
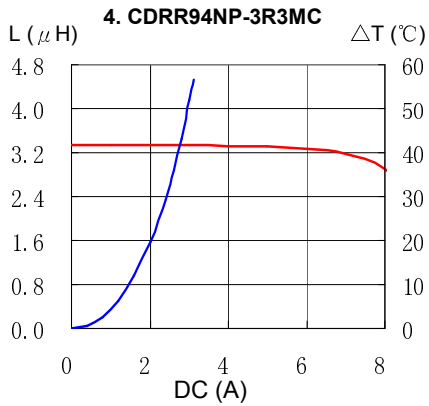
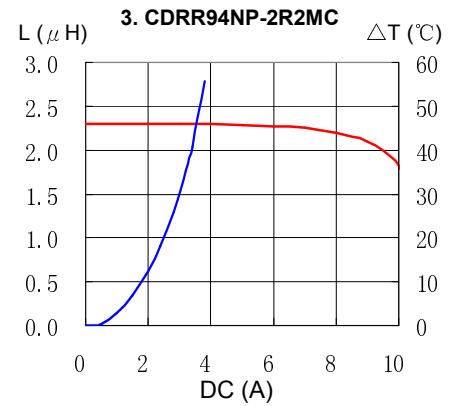
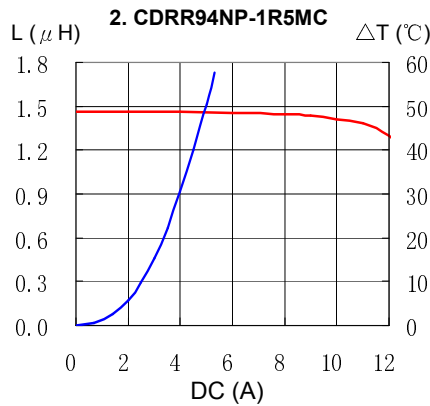
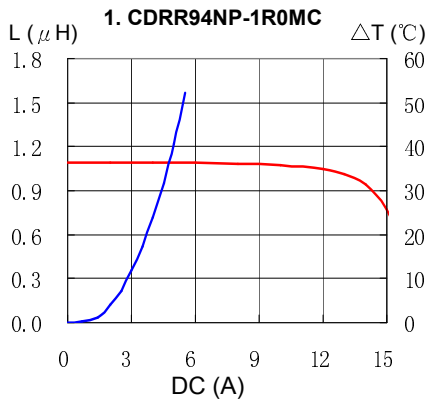

# SMD Power Inductor CDRR94



## Saturation Current & Temperature Rise Graph

— L (20°C)    —  $\Delta T$

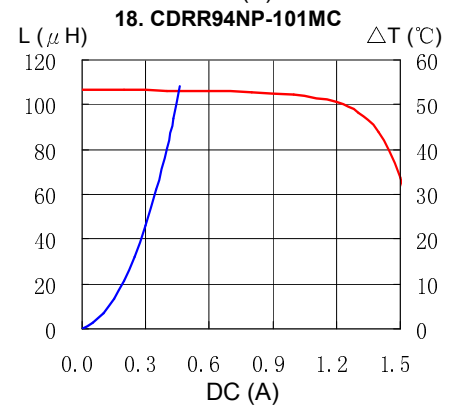
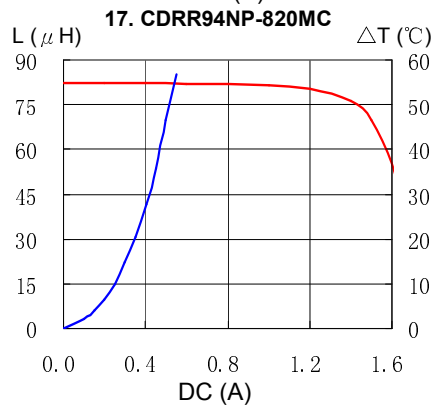
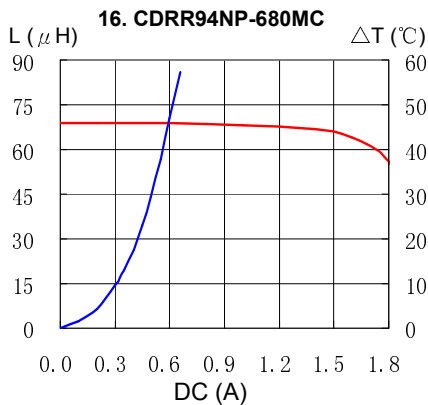
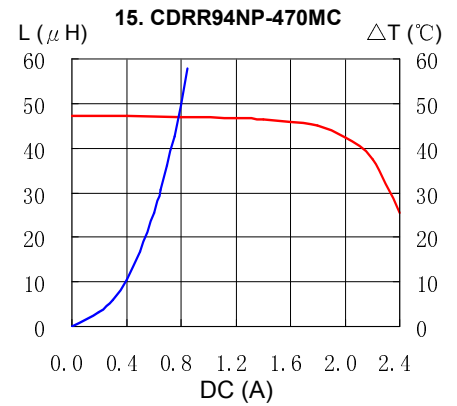
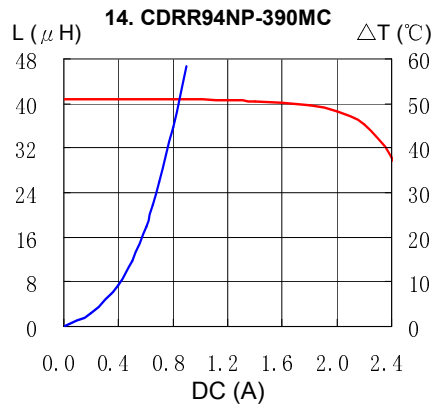
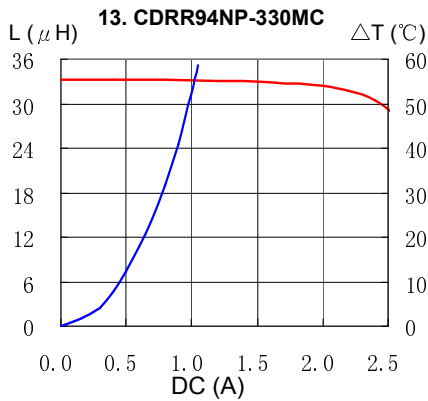

## Solder Reflow Condition

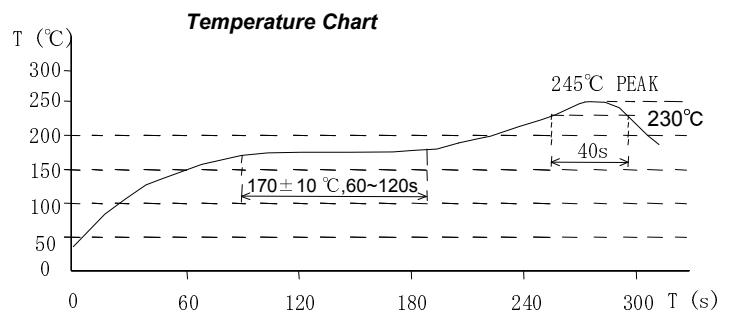
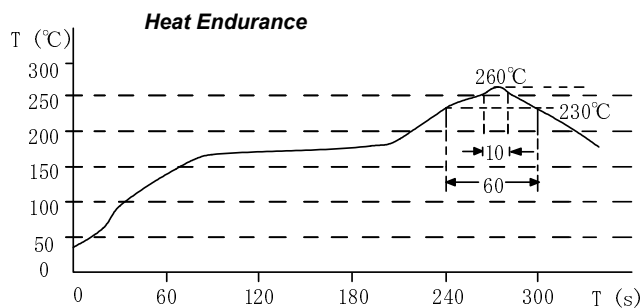

Please refer to the sales offices on our website - <http://www.sumida.com>

**Hong Kong**  
Tel.+852-2880-6781  
FAX.+852-2565-9600  
[sales@hk.sumida.com](mailto:sales@hk.sumida.com)  
**Saitama(Japan)**  
Tel.+81-48-691-7300  
FAX.+81-48-691-7340  
[sales@jp.sumida.com](mailto:sales@jp.sumida.com)  
**Chicago**  
Tel.+1-847-545-6700  
FAX. +1-847-545-6720  
[sales@us.sumida.com](mailto:sales@us.sumida.com)

**Shanghai**  
Tel.+86-21-5836-3299  
FAX.+86-21-5836-3266  
[shanghai.sales@cn.sumida.com](mailto:shanghai.sales@cn.sumida.com)  
**Seoul**  
Tel.+82-2-6237-0777  
FAX.+82-2-6237-0778  
[sales@kr.sumida.com](mailto:sales@kr.sumida.com)  
**Oberzell**  
Tel.+49-8591-937-0  
FAX. +49-8591-937-103  
[contact@eu.sumida.com](mailto:contact@eu.sumida.com)

**Shenzhen**  
Tel.+86-755-8291-0228  
FAX.+86-755-8291-0338  
[shenzhen.sales@cn.sumida.com](mailto:shenzhen.sales@cn.sumida.com)  
**Singapore**  
Tel.+65-6296-3388  
FAX.+65-6841-4426  
[sales@sg.sumida.com](mailto:sales@sg.sumida.com)  
**Neumarkt**  
Tel.+49-9181-4509-110  
FAX. +49-9181-4509-310  
[infocomp@eu.sumida.com](mailto:infocomp@eu.sumida.com)

**Taipei**  
Tel.+886-2-8751-2737  
FAX.+886-2-8751-2738  
[sales@tw.sumida.com](mailto:sales@tw.sumida.com)  
**San Jose**  
Tel.+1-408-321-9660  
FAX.+1-408-321-9308  
[sales@us.sumida.com](mailto:sales@us.sumida.com)

# Mouser Electronics

Authorized Distributor

Click to View Pricing, Inventory, Delivery & Lifecycle Information:

## Sumida:

[CDRR94NP-330MC](#) [CDRR94NP-680MC](#) [CDRR94NP-1R5MC](#) [CDRR94NP-820MC](#) [CDRR94NP-150MC](#)  
[CDRR94NP-270MC](#) [CDRR94NP-470MC](#) [CDRR94NP-1R0MC](#) [CDRR94NP-4R7MC](#) [CDRR94NP-101MC](#)  
[CDRR94NP-220MC](#) [CDRR94NP-120MC](#) [CDRR94NP-390MC](#) [CDRR94NP-180MC](#) [CDRR94NP-3R3MC](#) [CDRR94NP-](#)  
[100MC](#) [CDRR94NP-2R2MC](#) [CDRR94NP-6R8MC](#)